

600-604 CONGRESS STREET

10/12/72

CITY OF PORTLAND, MAINE

SUMMARY OF ZONING REQUIREMENTS FOR OFF-STREET PARKING AREAS

A. Parking for Six or Less Vehicles in a Residence Zone.

1. Parking may not be located closer to a street line than the depth of the front yard or that of the side yard on side street required in the zone where located.
2. Parking may not be located closer than 5 feet to a lot line if located closer than 50 feet to any street line.

B. Parking for More Than Six Vehicles in a Residence Zone.

1. If accessory to a non-residential use, it may not be located closer than 25 feet to any residential structures on the adjoining lot.
2. If parking is to be within the area otherwise required to be kept open and unoccupied for front, side and rear yards, the following requirements shall be met:
  - a. Either a continuous guard curb at least six inches in height shall be provided at least five feet from the street and lot lines involved or else a continuous bumper guard not less than twenty inches in height shall be provided inside street or lot lines so that no part of bumpers can project beyond the street or lot lines involved.
  - b. Where parking abuts a lot used for residential purposes or an unoccupied lot in a Residence Zone, a chain link, picket or sapling fence not less than 48 inches high shall be provided along lot lines involved.

C. Parking for More Than Six Vehicles in Business Zones.

1. Where vehicles are to be parked within ten feet of any street line either a continuous guard curb at least six inches high shall be provided at least five feet from street line or else a continuous bumper guard at least 20 inches high shall be provided in such a location that bumpers of vehicles cannot project beyond the street line.
2. Where parking abuts a lot in a Residence Zone or a lot used for residential purposes a chain link, picket or sapling fence not less than 48 inches high shall be provided along lot lines involved.

D. Parking for More Than Six Vehicles in Any Zone.

1. Driveways from streets or alleys, location and width of which must be approved by the Traffic Engineer, as well as maneuvering areas, shall be provided. If access to parking area is to be available from more than one street, ingress and egress to and from lot shall have the approval of the Planning Board.
2. Surface of driveways, maneuvering areas and parking areas shall be uniformly graded to a depth of at least six inches with gravel or equivalent materials so as to have a wearing surface equivalent in qualities of compaction and durability to fine gravel.
3. A system of drainage shall be provided so that water will not run over or across any public sidewalk or street.
4. If artificial lighting is provided, it must be shaded or screened so that no light source is visible from outside the area and its access driveways.

TOY STORE DOOR

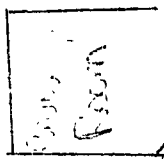
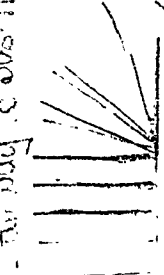

Exit to outside

11 feet

1 foot

Entrance

1st floor  
101. Longwood St

10 feet

Ex - Long Salon work area

RECEIVED  
MAR 22 1932  
DEPT. OF BLDG. INSP  
CITY OF PORTLAND

CITY OF PORTLAND, MAINE

SUMMARY OF ZONING REQUIREMENTS FOR OFF-STREET PARKING AREAS

- A. Parking for Six or Less Vehicles in a Residence Zone.
  - 1. Parking may not be located closer to a street line than the depth of the front yard or that of the side yard on side street required in the zone where located.
  - 2. Parking may not be located closer than 5 feet to a lot line if located closer than 50 feet to any street line.
- B. Parking for More Than Six Vehicles in a Residence Zone.
  - 1. If accessory to a non-residential use, it may not be located closer than 25 feet to any residential structures on the adjoining lot.
  - 2. If parking is to be within the area otherwise required to be kept open and unoccupied for front, side and rear yards, the following requirements shall be met:
    - a. Either a continuous guard curb at least six inches in height shall be provided at least five feet from the street and lot lines involved or else a continuous bumper guard not less than twenty inches in height shall be provided inside street or lot lines so that no part of bumpers can project beyond the street or lot lines involved.
    - b. Where parking abuts a lot used for residential purposes or an unoccupied lot in a Residence Zone, a chain link, picket or sapling fence not less than 48 inches high shall be provided along lot lines involved.
- C. Parking for More Than Six Vehicles in Business Zones.
  - 1. Where vehicles are to be parked within ten feet of any street line, either a continuous guard curb at least six inches high shall be provided at least five feet from street line or else a continuous bumper guard at least 20 inches high shall be provided in such a location that bumpers of vehicles cannot project beyond the street line.
  - 2. Where parking abuts a lot in a Residence Zone or a lot used for residential purposes, a chain link, picket or sapling fence not less than 48 inches high shall be provided along lot lines involved.
- D. Parking for More Than Six Vehicles in Any Zone.
  - 1. Driveways from streets or alleys, location and width of which must be approved by the Traffic Engineer, as well as maneuvering areas, shall be provided. If access to parking area is to be available from more than one street, ingress and egress to and from lot shall have the approval of the Planning Board.
  - 2. Surface of driveways, maneuvering areas and parking areas shall be uniformly graded to a depth of at least six inches with gravel or equivalent materials so as to have a wearing surface equivalent in qualities of compaction and durability to fine gravel.
  - 3. A system of drainage shall be provided so that water will not run over or across any public sidewalk or street.
  - 4. If artificial lighting is provided, it must be shaded or screened so that no light source is visible from outside the area and its access driveways.

APPLICATION FOR PERMIT  
B.O.C.A. USE GROUP .....  
B.O.C.A. TYPE OF CONSTRUCTION ..... 00035  
ZONING LOCATION B-3 ..... PORTLAND, MAINE Dec. 22, 1981

PERMIT ISSUED

FEB 18 1982

CITY of PORTLAND

To the CHIEF OF BUILDING & INSPECTION SERVICES, PORTLAND, MAINE

The undersigned hereby applies for a permit to erect, alter, repair, demolish, move or install the following building, structure, equipment or change use in accordance with the Laws of the State of Maine, the Portland B.O.C.A. Building Code and Zoning Ordinance of the City of Portland with plans and specifications, if any, submitted herewith and the following specifications:

LOCATION 604 Congress St. Fire District #1 ☐ #2 ☐  
1. Owner's name and address Jeffrey Rice Telephone .....  
2. Lessee's name and address Albert Kirchner D.B.A. Cut above Telephone .....  
3. Contractor's name and address Richard & Rice Bldgs. Inc. Telephone 846-3254  
Box 532 Yarmouth  
Proposed use of building beauty shop No. of sheets .....  
Last use be " " No. families .....  
Material ..... No. stories ..... Heat ..... Style of roof ..... Roofing .....  
Oth buildings on same lot .....  
Estimated contractual cost \$ 10,000.  
FIELD INSPECTOR - MC Schmachtel, Irving Appeal Fees \$ 88.  
@ 775-5451 Base Fee .....  
Late Fee .....  
To renovate basement area - replace walls, etc. TOTAL \$ 60.  
as per plan

Stamp of Special Conditions  
PERMIT ISSUED  
WITH LETTER

NOTE TO APPLICANT: Separate permits are required by the installers and subcontractors of heating, plumbing, electrical and mechanicals.

#### DETAILS OF NEW WORK

Is any plumbing involved in this work? ..... Is any electrical work involved in this work? .....  
Is connection to be made to public sewer? ..... If not, what is proposed for sewage? .....  
Has septic tank notice been sent? ..... Form notice sent? .....  
Height average grade to top of plate ..... Height average grade to highest point of roof .....  
Size, front ..... depth ..... No. stories ..... solid or filled land? ..... earth or rock? .....  
Material of foundation ..... Thickness, top ..... bottom ..... cellar .....  
Kind of roof ..... Rise per foot ..... Roof covering .....  
No. of chimneys ..... Material of chimneys ..... of lining ..... Kind of heat ..... fuel .....  
Framing Lumber—Kind ..... Dressed or full size? ..... Corner posts ..... Sills .....  
Size Girder ..... Columns under girders ..... Size ..... Max. or centers .....  
Studs (outside walls and carrying partitions) 2x4-16" O. C. Bridging in every floor and flat roof span over 8 feet.  
Joists and rafter: 1st floor ..... 2nd ..... 3rd ..... roof .....  
On centers 1st floor ..... 2nd ..... 3rd ..... roof .....  
Maximum span 1st floor ..... 2nd ..... 3rd ..... roof .....  
If one story building with masonry wall, thickness of walls? ..... height? .....

#### IF A GARAGE

No. cars now accommodated on same lot ..... to be accommodated ..... number commercial cars to be accommodated .....  
Will automobile repairing be done other than minor repairs to cars habitually stored in the proposed building? .....

APPROVALS BY: DATE  
BUILDING INSPECTION—PLAN EXAMINER .....  
ZONING: D.K. M.J.T. ....  
BUILDING CODE: P.S. J. ....  
Fire Dept.: .....  
Health Dept.: .....  
Others: .....

MISCELLANEOUS  
Will work require disturbing of any tree on a public street? ...  
Will there be in charge of the above work a person competent to see that the State and City requirements pertaining thereto are observed? .....

Signature of Applicant R.M.B. Quinn Phone # .....  
Type Name of above ..... 1 ☐ 2 ☐ 3 ☐ 4 ☐

PERMIT ISSUED  
WITH LETTER

Other .....  
and Address .....

FIELD INSPECTOR'S COPY

APPLICANT'S COPY

OFFICE FILE COPY

#  
X Schmachtel, Irving

NOTES

13/11/82.  
 Tenant said he has  
 given up on renovation -  
 cost too high etc etc. #11

Permit No. 82/085  
 Location 604 Congress St.  
 Owner Jeffrey Davis  
 Date of permit 12-22-82  
 Approved 2-18-83  
 Dwelling Beauty Shop  
 Garage  
 Alteration Renovation

OK'd

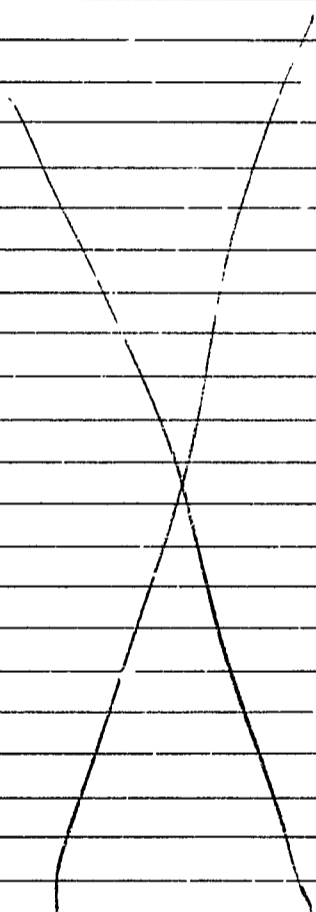



APPLICATION FOR PERMIT  
DEPARTMENT OF BUILDING INSPECTIONS SERVICES  
ELECTRICAL INSTALLATIONS

Date Oct. 2, 19 79  
Receipt and Permit number A 34811

To the CHIEF ELECTRICAL INSPECTOR, Portland, Maine:

The undersigned hereby applies for a permit to make electrical installations in accordance with the laws of Maine, the Portland Electrical Ordinance, the National Electrical Code and the following specifications:

LOCATION OF WORK: 602 Congress St.

OWNER'S NAME: Geoffrey I. Rice ADDRESS: 655 Congress Street

	FEES
OUTLETS:	
Receptacles	
Switches	
Plugmold	
ft. TOTAL	
FIXTURES: (number of)	
Incandescent	
Flourescent	
(not strip) TOTAL	
Strip Flourescent	
ft.	
SERVICES:	
Overhead	
Underground	
Temporary	
TOTAL amperes	
METERS: (number of)	
MOTORS: (number of)	
Fractional	
1 HP or over	
RESIDENTIAL HEATING:	
Oil or Gas (number of units)	
Electric (number of rooms)	
COMMERCIAL OR INDUSTRIAL HEATING:	
Oil or Gas (by a main boiler)	
Oil or Gas (by separate units)	
Electric Under 20 kws	
Over 20 kws	
APPLIANCES: (number of)	
Ranges	
Cook Tops	
Wall Ovens	
Dryers	
Fans	
Water Heaters	
Disposals	
Dishwashers	
Compactors	
Others (denote)	
TOTAL	
MISCELLANEOUS: (number of)	
Branch Panels	
Transformers	
Air Conditioners Central Unit	
Separate Units (windows)	
Signs 20 sq. ft. and under	
Over 20 sq.	
Swimming Pools Above Ground	
In Ground	
Fire/Burglar Alarms Residential	
Commercial	
Heavy Duty Outlets, 220 Volt (such as welders) 30 amps and under	
over 30 amps	
Circus, Fairs, etc.	
Alterations to wires <u>xx</u>	<u>2.00</u>
Repairs after fire	
Emergency Lights, battery	
Emergency Generators	

INSTALLATION FEE DUE:  
FOR ADDITIONAL WORK NOT ON ORIGINAL PERMIT ..... DOUBLE FEE DUE:  
FOR REMOVAL OF A "STOP ORDER" (304-16.b) .....

TOTAL AMOUNT DUE: 3.00

INSPECTION:

Will be ready on \_\_\_\_\_, 19 \_\_\_\_; or Will Call xx

CONTRACTOR'S NAME: Eger-McGuire

ADDRESS: 241 Oxford St.

TEL.: 774-2825

MASTER LICENSE NO.: 3967

LIMITED LICENSE NO.: \_\_\_\_\_

SIGNATURE OF CONTRACTOR:

James I. McGuire

INSPECTOR'S COPY — WHITE

OFFICE COPY — CANARY

CONTRACTOR'S COPY — GREEN



Existing balcony extends from back of building for (13) thirteen feet. We are extending the balcony seven more feet for a total of 20 feet. We are changing the stairway from the back to the front of this balcony. The stairway will extend an additional eleven feet. The width of this balcony will remain at 12 feet.

Existing Balcony		New Addition	
13'	+	7'	= 20'

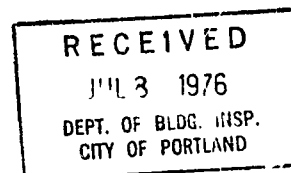

July 9, 1976

Albert Kirchner  
426 Ocean St.  
So. Portland, Me.

cc to: Harry Schwartz  
604 Congress St.  
Portland, Me.

RE: 604 Congress St.

Dear Mr. Kirchner,

This office is unable to issue a permit to change the use of the above building from bookstore to beauty salon with alterations to the balcony as per plans until such time that you have submitted a structural plan of the balcony showing how it is to be constructed and how it is to be supported. We need to know the size of the sills and the floor timbers as well as how the new addition is to be supported on the building.

When this information has been provided, we will then be in a position to issue a permit.

Very truly yours,

Earle S. Smith  
Plan Examiner

FSS:mes

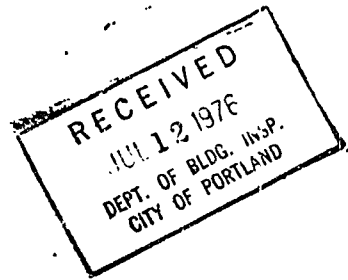

Balcony Extension Plan  
Cut Above  
604 Congress St.  
774-7450

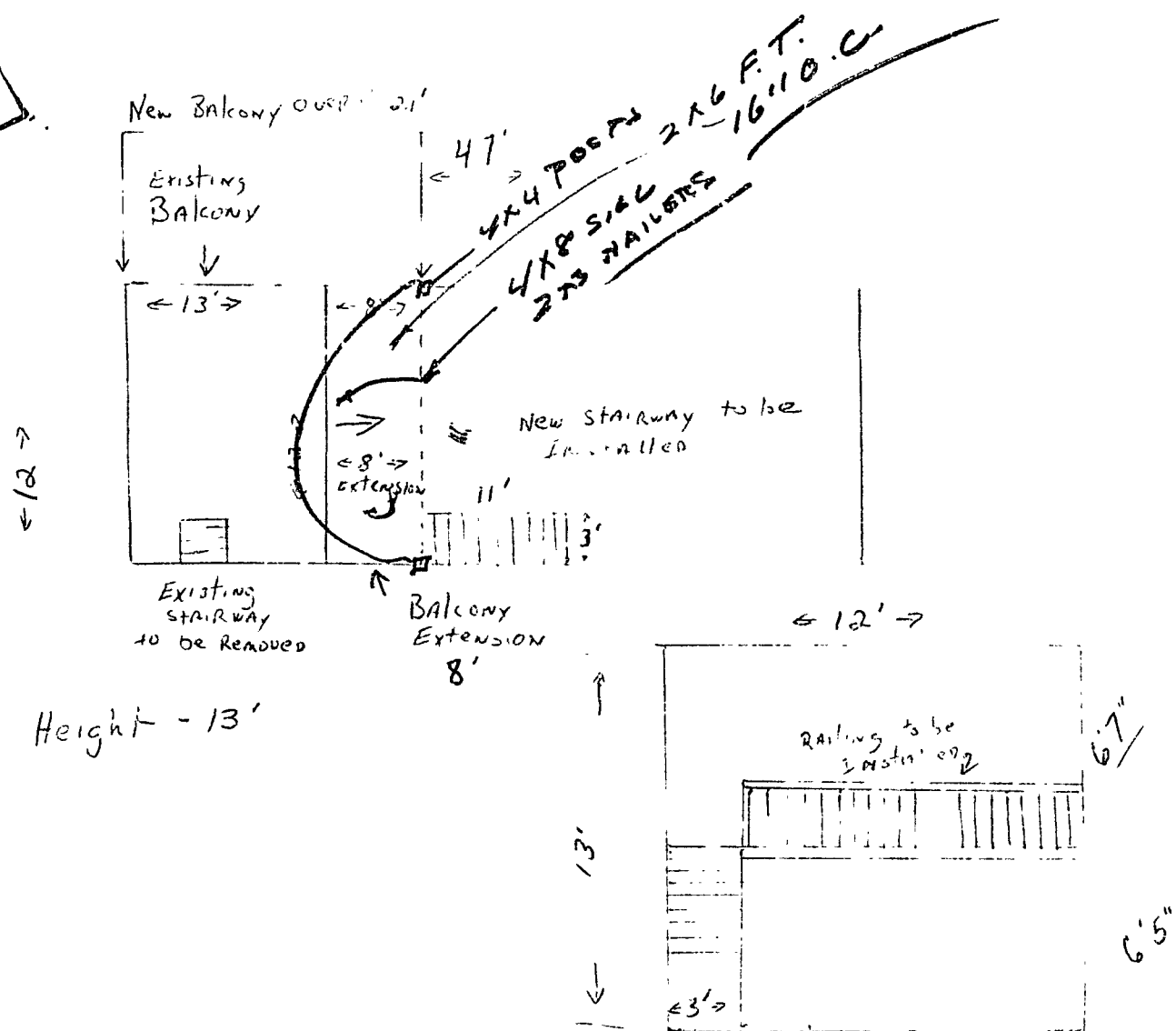



## APPLICATION FOR PERMIT

B.O.C.A. USE GROUP .....  
B.O.C.A. TYPE OF CONSTRUCTION .....  
ZONING LOCATION B-3 PORTLAND, MAINE, July 8, 1976

PERMIT 15988  
JUL  
CITY of PORTLAND

To the DIRECTOR OF BUILDING & INSPECTION SERVICES, PORTLAND, MAINE

The undersigned hereby applies for a permit to erect, alter, repair, demolish, move or install the following building, structure, equipment or change use in accordance with the Laws of the State of Maine, the Portland B.O.C.A. Building Code and Zoning Ordinance of the City of Portland with plans and specifications, if any, submitted herewith and the following specifications:

LOCATION ~~XXX~~ 604 Congress St. .... Fire District #1 ☐ #2 ☐  
1. Owner's name and address Harry Schwartz .... Congress St. .... Telephone .....  
2. Lessee's name and address Albert Kirchner .... 426 Ocean St. S.E. P.J. Telephone 767-3787..  
3. Contractor's name and address John Ambriano .... C.E. .... Telephone .....  
4. Architect ..... Specifications ..... Plans ..... No. of sheets .....  
Proposed use of building beauty salon ..... No. families .....  
Last use book ~~XXXX~~ store ..... No. families .....  
Material ..... No. stories ..... Heat ..... Style of roof ..... Roofing .....  
Other buildings on same lot .....  
Estimated contractual cost \$ .500. .... Fee \$ . . . . 5.00 ..

FIELD INSPECTOR—Mr. Marge ..... GENERAL DESCRIPTION

This application is for: @ 775-5451  
Plumbing ..... Ext. 234  
Garage .....  
Masonry Bldg. ....  
Metal Bldg. ....  
Alterations .....  
Demolitions .....  
Change of Use .....  
Other ..

To change the use from book store to beauty salon with alterations to the balcony as per plans.

Stamp of Special Conditions

NOTE TO APPLICANT: Separate permits are required by the installers and subcontractors of heating, plumbing, electrical and mechanicals.

PERMIT IS TO BE ISSUED TO 1 ☐ 2 ☒ 3 ☐ 4 ☐

Other: .....

## DETAILS OF NEW WORK

Is any plumbing involved in this work? ..... Is any electrical work involved in this work? .....  
Is connection to be made to public sewer? ..... If not, what is proposed for sewage? .....  
Has septic tank notice been sent? ..... Form notice sent? .....  
Height average grade to top of plate ..... Height average grade to highest point of roof .....  
Size, front ..... depth ..... No. ori. .... solid or filled land? ..... earth or rock? .....  
Material of foundation ..... Thickness, top ..... bottom ..... cellar .....  
Kind of roof ..... Rise per foot ..... Roof covering .....  
No. of chimneys ..... Material of chimneys ..... of lining ..... Kind of heat ..... fuel .....  
Framing Lumber—Kind ..... Dressed or full size? ..... Corner posts ..... Sills .....  
Size Girder ..... Columns under girders ..... Size ..... Max. on centers .....  
Studs (outside walls and carrying partitions) 2x4-16" O. C. Bridging in every floor and flat roof span over 8 feet.  
Joists and rafters: 1st floor ..... 2nd ..... 3rd ..... roof .....  
On centers: 1st floor ..... 2nd ..... 3rd ..... roof .....  
Maximum span: 1st floor ..... 2nd ..... 3rd ..... roof .....  
If one story building with masonry walls, thickness of walls? ..... height? .....

## IF A GARAGE

No. cars now accommodated on same lot ...., to be accommodated ... number commercial cars to be accommodated ...  
Will automobile repairing be done other than minor repairs to cars habitually stored in the proposed building? .....

## APPROVALS BY:

## DATE

## MISCELLANEOUS

BUILDING INSPECTION—PLAN EXAMINER .....  
ZONING: OK M.C.W. 7/8/76 .....  
BUILDING CODE: .....  
Fire Dept.: .....  
Health Dept.: .....  
Others: .....

Will work require disturbing of any tree on a public street? ..

Will there be in charge of the above work a person competent to see that the State and City requirements pertaining thereto are observed? Yes...

Signature of Applicant Albert Kirchner ..... Phone # .....

Type Name of above Albert Kirchner ..... 1 ☐ 2 ☐ 3 ☐ 4 ☐

Other .....  
and Address .....

FIELD INSPECTOR'S COPY

7/12/06 11  
44 Congress St  
Leicester  
Mass 01545

LICENSE #2370  
CITY OF PORTLAND, MAINE  
Application for Permit to Install Wires

Permit No. 55302  
Issued 9/13/71  
Sept 13, 1971

Portland, Maine

To the City Electrician, Portland, Maine

The undersigned hereby applies for a permit to install wires for the purpose of conducting electric current, in accordance with the laws of Maine, the Electrical Ordinance of the City of Portland, and the following specifications.

(This form must be completely filled out - Minimum Fee \$1.00)

Owner's Name and Address John Donnelly + Sons  
Contractor's Name and Address " " Tel.  
Location 604 CONGRESS ST. of Building ROOF SIGN  
Number of Families Apartments Stories Number of Stories  
Description of Wiring New Work Additions Alterations

Pipe Cable Metal Molding BX Cable Plug Molding (No. of feet)  
No. Light Outlets Plugs Light Circuits Plug Circuits  
FIXTURES: No Fluor. or Strip Lighting (No. feet)  
SERVICE: Pipe Cable Underground No. of Wires Size  
METERS: Relocated Added Total No. Meters  
MOTORS: Number Phase H.P. Amps Volts Starter  
HEATING UNITS: Domestic (Oil) No. Motors Phase H.P.  
Commercial (Oil) No. Motors Phase H.P.  
Electric Heat (No. of Rooms)  
APPLIANCES: No. Ranges Watts Brand Freely (Size and No.)  
Elec. Heaters Watts  
Miscellaneous Watts Extra Cabinets or Panels  
Transformers Air Conditioners (No. Units) Signs (No. Units) ① - 6000 W.  
Will commence 19 Ready to cover in 19 Inspection 19  
Amount of Fee \$ 2.00

Signed

Charles J. Keller

DO NOT WRITE BELOW THIS LINE

SERVICE	METER	GROUND
VISITS: 1 2 3 4 5 6		
7 8 9 10 11 12		

REMARKS:

CS 203

INSPECTED BY

W. H. Hester  
(OVER)

LOCATION *Concy ST 406*  
 INSPECTION DATE *9/30/71*  
 WORK COMPLETED *9/30/71*  
 TOTAL NO. INSPECTIONS  
 REMARKS

**FEES FOR WIRING PERMITS EFFECTIVE JULY 31, 1963**

**WIRING**

1 to 30 Outlets \$ 2.00  
 31 to 60 Outlets 3.00  
 Over 60 Outlets, each Outlet .05  
 (Each twelve feet or fraction thereof of fluorescent lighting or any 1 pc of plug molding will be classed as one outlet).

**SERVICES**

Single Phase 3.00  
 Three Phase 4.00

**MOTORS**

Not exceeding 50 H.P. 2.00  
 Over 50 H.P. 4.00  
 .75

**HEATING UNITS**

Domestic (Oil) 1.50  
 Commercial (Oil)  
 Electric Heat (Each Room)

**APPLIANCES**

Ranges, Cooking Tops, Ovens, Water Heaters, Disposals, Built-in Dishwashers, Dryers, and any permanent built-in appliance -- each 1.00  
 unit 1.00

**MISCELLANEOUS**

Service, Single Phase 1.00  
 Service, Three Phase 1.00



## APPLICATION FOR PERMIT

Class of Building or Type of Structure

Portland, Maine,

Feb. 9, 1973

PERMIT DATED

FEB 12 1973

CITY OF PORTLAND

To the INSPECTOR OF BUILDINGS, PORTLAND, MAINE

The undersigned hereby applies for a permit to erect alter repair demolish install the following building structure equipment in accordance with the Laws of the State of Maine, the Building Code and Zoning Ordinance of the City of Portland, plans and specifications, if any, submitted herewith and the following specifications:

Location 604 Congress St. Within Fire Limits?        Dist. No.         
 Owner's name and address D. Schwartz & Sons, 40 Congress Square Telephone         
 Lessee's name and address        Telephone         
 Contractor's name and address F.P. & C. H. Murray, Box 2297, S. Portland Telephone         
 Architect        Specifications        Plans        No. of sheets         
 Proposed use of building store No families         
 Last use restaurant No families         
 Material        No. stories        Heat        Style of roof        Roofing         
 Other buildings on same lot         
 Estimated cost \$ 2,000. Fee \$ 6.00

## General Description of New Work

To make alteration on first floor only, as per plans.  
 Change of use from restaurant to store

It is understood that this permit does not include installation of heating apparatus which is to be taken out separately by and in the name of the heating contractor. PERMIT TO BE ISSUED TO        contractor

## Details of New Work

Is any plumbing involved in this work?        Is any electrical work involved in this work?         
 Is connection to be made to public sewer?        If not, what is proposed for sewage?         
 Has septic tank notice been sent?        Form notice sent?         
 Height average grade to top of plate        Height average grade to highest point of roof         
 Size, front        depth        No. stories        solid or filled land?        earth or rock?         
 Material of foundation        Thickness, top        bottom        cellar         
 Kind of roof        Rise per foot        Roof covering         
 No. of chimneys        Material of chimneys        of lining        Kind of heat        fuel         
 Framing Lumber—Kind        Dressed or full size?        Corner posts        Sills         
 Size Girder        Columns under girders        Size        Max on centers         
 Studs (outside walls and carrying partitions) 2x4-16" O. C Bridging in every floor and flat roof span over 8 feet.  
 Joists and rafters: 1st floor       , 2nd       , 3rd       , roof         
 On centers: 1st floor       , 2nd       , 3rd       , roof         
 Maximum span: 1st floor       , 2nd       , 3rd       , roof         
 If one story building with masonry walls, thickness of walls?        height?       

## If a Garage

No. cars now accommodated on same lot       , to be accommodated        number commercial cars to be accommodated         
 Will automobile repairing be done other than minor repairs to cars habitually stored in the proposed building?       

APPROVED:

R-13, 2/9/73

## Miscellaneous

Will work require disturbing of any tree on a public street?         
 Will there be in charge of the above work a person competent to see that the State and City requirements pertaining thereto are observed? yes  
 F.P. & C.H. Murray

CS 301

INSPECTION COPY

Signature of owner By: F.P. & C.H. Murray

## NOTES

2/16/23  
Contract at the last  
from parent  
and the work is  
about completed.

*[Signature]*

8/23/13  
completed

A large, bold, handwritten 'X' mark is drawn across the page. The 'X' is formed by two intersecting diagonal lines that cross in the center. The lines are dark and slightly irregular, suggesting they were drawn with a pen or marker. The background consists of horizontal blue lines on a white paper.

Permit No.	7-0-1
Location	East end of road up hill
Owner	H. H. Smith & Son
Date of permit	2/19/1908
Notif. closing-in	
Inspn. closing-in	
Firm Notif.	
Fine Inspn.	
Cert. of Occupancy issued	
Staking Out Notice	
Form Check Notice	

602 Congress Street

April 14, 1972

F. P. & C. H. Murray Company  
Ocean House Road  
Cape Elizabeth, Maine

CC to: Harry Shwartz  
10 Congress Square

Gentlemen:

Permit to remodel building at the above address is  
issued herewith subject to the following Building Code  
requirement.

Before new suspended ceiling is provided, be sure  
that all openings in the old ceiling are completely covered  
so as to prevent the passage of smoke or fire between the  
ceilings.

Very truly yours,

Earle S. Smith  
Plan Examiner

ESS:m



# APPLICATION FOR PERMIT

Class of Building or Type of Structure

Portland, Maine, April 23, 1972

PERMIT

0379

OFFICE of BUILDING

To the INSPECTOR OF BUILDINGS PORTLAND, MAINE

The undersigned hereby applies for a permit to erect, alter, repair, demolish or relocate, building structure equipment in accordance with the Laws of the State of Maine, the Building Code and Zoning Ordinance of the City of Portland, plans and specifications, if any, submitted herewith and the following specifications:

Location 602 Congress St. Within Fire Limits? Dist. No.  
 Owner's name and address Harry Schwartz, 10 Congress Square Telephone  
 Lessee's name and address Telephone  
 Contractor's name and address F.P. & C.H. Murray, Ocean House Rd., Cape Elizabeth Telephone  
 Architect Specifications Plans Yes No of sheets 1  
 Proposed use of building office No families  
 Last use office No families  
 Material No stories Heat Style of roof Roofing  
 Other buildings on same lot  
 Estimated cost \$ 3,000. Fee \$ 22.00  
 7.00

## General Description of New Work

To remodel new front entrance, new terrace floor and safety treads for stairs, wall paneling on hallway walls, also new suspended ceilings. 2 new ceiling lights.

No structural change

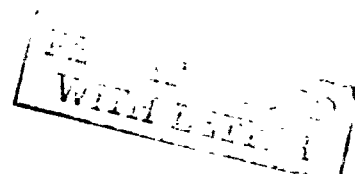

It is understood that this permit does not include installation of heating apparatus which is to be taken out separately by and in the name of the heating contractor. **PERMIT TO BE ISSUED TO Contractor**

## Details of New Work

Is any plumbing involved in this work? Is any electrical work involved in this work?  
 Is connection to be made to public sewer? If not, what is proposed for sewage?  
 Has septic tank notice been sent? Form notice sent?  
 Height average grade to top of plate Height average grade to highest point of roof  
 Size, front... depth... No stories... solid or filled land? earth or rock?  
 Material of foundation Thickness: top... bottom... cellar...  
 Kind of roof... Rise per foot... Roof covering...  
 No. of chimneys... Material of chimneys... of lining... Kind of heat... fuel...  
 Framing Lumber—Kind... Dressed or full size? Corner posts... Sills...  
 Size Girder... Columns under girders... Size... Max. on centers...  
 Studs (outside walls and carrying partitions) 2x4-16" O.C. Bridging in every floor and flat roof span over 8 feet.  
 Joists and rafters... 1st floor... 2nd... 3rd... roof...  
 On centers: 1st floor... 2nd... 3rd... roof...  
 Maximum span: 1st floor... 2nd... 3rd... roof...  
 If one story building with masonry walls, thickness of walls? height?

## If a Garage

No. cars now accommodated on same lot, to be accommodated number commercial cars to be accommodated  
 Will automobile repairing be done other than minor repairs to cars habitually stored in the proposed building?

APPROVED:

O.K. E.B. 4/11/72

## Miscellaneous

Will work require disturbing of any tree on a public street?  
 Will there be in charge of the above work a person competent to see that the State and City requirements pertaining thereto are observed? yes

CS 301

INSPECTION COPY

Signature of owner By:

F.P. & C.H. Murray

Paul C. Hatte Supr

NOTES

5-1-72 work started  
going as per plan.

5-18-72 work  
completed

Permit No. 21, 799  
Location 1st & 2nd Sts.  
Owner J. H. & W. A. Smith  
Date of permit 4/27/72  
North clearing in  
Payn closing on  
Paid cost  
Final Report  
Cert. of Occupancy issued  
Selling Out Notice  
Form Check Notice

ADDRESS

602 Congress ST

12/1/73

ROUTING SLIP

FROM

DEPARTMENT OF BUILDING AND INSPECTION SERVICES

FIRE DEPARTMENT ☒

PLANNING BOARD ☐

RENEWAL ☐

MAINE WAY ☐

OTHERS ☐

APPROVED

C. O. O'Neil

DISAPPROVED BY REASON OF

(quote section of pertinent ordinance or other governing factors)

SPECIAL COMMENTS

KEEP SECOND COPY AND RETURN ORIGINAL TO BUILDING AND INSPECTION SERVICES



# APPLICATION FOR PERMIT

Class of Building or Type of Structure Apartment House  
Portland, Maine October 1, 1973

PERMIT ISSUED

01141

OCT 3 1973

CITY of PORTLAND

To the INSPECTOR OF BUILDINGS, PORTLAND, MAINE

The undersigned hereby applies for a permit to erect alter repair demolish install the following building structure equipment in accordance with the Laws of the State of Maine, the Building Code and Zoning Ordinance of the City of Portland, plans and specifications, if any, submitted herewith and the following specifications:

Location 602 Congress St.  
 Owner's name and address Schwartz, same  
 Lessee's name and address \_\_\_\_\_  
 Contractor's name and address Richard Milton, 63 East Bridge St., Westbrook  
 Architect \_\_\_\_\_  
 Proposed use of building apts  
 Last use apts  
 Material br No. stories 3 Heat \_\_\_\_\_ Style of roof \_\_\_\_\_  
 Other buildings on same lot \_\_\_\_\_  
 Estimated cost \$ \_\_\_\_\_

Within Fire Limits? \_\_\_\_\_ Dist. No. \_\_\_\_\_  
 Telephone \_\_\_\_\_  
 Telephone \_\_\_\_\_  
 Telephone 854-9164  
 No. of sheets \_\_\_\_\_  
 No. families \_\_\_\_\_  
 No. families \_\_\_\_\_  
 Roofing \_\_\_\_\_

Fee \$ 5.00

## General Description of New Work

To install fire alarm system throughout. DEM ADAMCO heat detectors to be place at strategic locations, gongs to be located on each floor as per specifications. Ademco gongs and Ademco 508 panel.

Sent to Fire Dept 10/1/73  
 Rec'd from Fire Dept 10/2/73

It is understood that this permit does not include installation of heating apparatus which is to be taken out separately by and in the name of the heating contractor. **PERMIT TO BE ISSUED TO**

## Details of New Work

Is any plumbing involved in this work? \_\_\_\_\_ Is any electrical work involved in this work? \_\_\_\_\_  
 Is connection to be made to public sewer? \_\_\_\_\_ If not, what is proposed for sewage? \_\_\_\_\_  
 Has septic tank notice been sent? \_\_\_\_\_ Form notice sent? \_\_\_\_\_  
 Height average grade to top of plate \_\_\_\_\_ Height average grade to highest point of roof \_\_\_\_\_  
 Size, front \_\_\_\_\_ ceph \_\_\_\_\_ No. stories \_\_\_\_\_ solid or filled land? \_\_\_\_\_ earth or rock? \_\_\_\_\_  
 Material of foundation \_\_\_\_\_ Thickness, top \_\_\_\_\_ bottom \_\_\_\_\_ cellar \_\_\_\_\_  
 Kind of roof \_\_\_\_\_ Rise per foot \_\_\_\_\_ Roof covering \_\_\_\_\_ Kind of heat \_\_\_\_\_ fuel \_\_\_\_\_  
 No. of chimneys \_\_\_\_\_ Material of chimneys \_\_\_\_\_ of lining \_\_\_\_\_ Corner posts \_\_\_\_\_ Sills \_\_\_\_\_  
 Framing Lumber-Kind \_\_\_\_\_ Dressed or full size? \_\_\_\_\_ Size \_\_\_\_\_ Max. on centers \_\_\_\_\_  
 Size Girder \_\_\_\_\_ Columns under girders \_\_\_\_\_  
 Studs (outside walls and carrying partitions) 2x4-16" O. C. Bridging in ev. y floor and flat roof span over 8 feet.  
 Joists and rafters: 1st floor \_\_\_\_\_, 2nd \_\_\_\_\_, 3rd \_\_\_\_\_, roof \_\_\_\_\_  
 On centers: 1st floor \_\_\_\_\_, 2nd \_\_\_\_\_, 3rd \_\_\_\_\_, roof \_\_\_\_\_  
 Maximum span: 1st floor \_\_\_\_\_, 2nd \_\_\_\_\_, 3rd \_\_\_\_\_, height? \_\_\_\_\_  
 If one story building with masonry walls, thickness of walls? \_\_\_\_\_

## If a Garage

No. cars now accommodated on same lot \_\_\_\_\_, to be accommodated \_\_\_\_\_ number commercial cars to be accommodated.  
 Will automobile repairing be done other than minor repairs to cars habitually stored in the proposed building? \_\_\_\_\_

## Miscellaneous

Will work require disturbing of any tree on a public street? \_\_\_\_\_  
 Will there be in charge of the above work a person competent to see that the State and City requirements pertaining thereto are observed? yes

APPROVED:

Frederick O. Dodd 10-2-73  
OK 10-3-73 N.F.C.

CS 301

INSPECTION COPY

Signature of owner by:

Henry Jackson  
 SENTRY ALARM CO.

NOTES

Permit No. 73/1141  
Location 602 E. 1st St  
Owner Seaboard  
Date of permit 10/1/73  
Notif. closing in  
Inspr. closing in  
Final Notif.  
Final Insp.  
Cert. of Occupancy issued  
Sinking Out Notice  
Form Check Notice

*Wick*

11-6-73 Incomplete

B3 BUSINESS ZONE



# APPLICATION FOR PERMIT

Class of Building or Type of Structure  
Portland, Maine,

Second Class  
November 5 1969

PERMIT ISSUED  
NOV 5 1969  
CITY OF PORTLAND

To the INSPECTOR OF BUILDINGS, PORTLAND, MAINE

The undersigned hereby applies for a permit to erect alter repair demolish install the following building structure equipment in accordance with the Laws of the State of Maine, the Building Code and Zoning Ordinance of the City of Portland, plans and specifications, if any, submitted herewith and the following specifications:

Location 602 Congress St. Within Fire Limits?      Dist. No.       
Owner's name and address Shwartz Bros. Inc. (Harry M Shwartz, 10 Congress Square) Telephone       
Lessee's name and address Hearing Aids Institute of New England, 477 Congress Telephone       
Contractor's name and address Lave Roberts Construction, 311 County Road Telephone 774-4617  
Architect      Specifications      Plans yes No. of sheets 1  
Proposed use of building Apartment Beauty Shops-Offices-Hearing Aid Institute No. families       
Last use      " " " " No. families       
Material brick No. stories 5 Heat      Style of roof      Roofing       
Other buildings on same lot       
Estimated cost \$ 900.00 Fee \$ 5.00

## General Description of New Work

To make alterations, first floor as per plan.

It is understood that this permit does not include installation of heating apparatus which is to be taken out separately by and in the name of the heating contractor. **PERMIT TO BE ISSUED TO** contractor

## Details of New Work

Is any plumbing involved in this work?      Is any electrical work involved in this work?       
Is connection to be made to public sewer?      If not, what is proposed for sewage?       
Has septic tank notice been sent?      Form notice sent?       
Height average grade to top of plate      Height average grade to highest point of roof       
Size, front      depth      No. stories      solid or filled land?      earth or rock?       
Material of foundation      Thickness, top      bottom      cellar       
Kind of roof      Rise per foot      Roof covering       
No. of chimneys      Material of chimneys      of lining      Kind of heat      fuel       
Framing Lumber-Kind      Dressed or full size?      Corner posts      Sills       
Size Girder      Columns under girders      Size      Max. on centers       
Studs (outside walls and carrying partitions) 2x4-16" O. C. Bridging in every floor and flat roof span over 8 feet.  
Joists and rafters: 1st floor     , 2nd     , 3rd     , roof       
On centers: 1st floor     , 2nd     , 3rd     , roof       
Maximum span: 1st floor     , 2nd     , 3rd     , roof       
If one story building with masonry walls, thickness of walls?      height?     

## If a Garage

No. cars now accommodated on same lot     , to be accommodated      number commercial cars to be accommodated       
Will automobile repairing be done other than minor repairs to cars habitually stored in the proposed building?     

APPROVED:

OK. R.L.D. 11/5/69

## Miscellaneous

Will work require disturbing of any tree on a public street? no  
Will there be in charge of the above work a person competent to see that the State and City requirements pertaining thereto are observed? yes

Hearing Aids Institute of New England  
Dave Roberts Construction

CS 301

INSPECTION COPY

Signature of owner

by: David B. Roberts

7m

NOTES

12-9-64. Compl. to  
 Rear door barney  
 locked & double  
 locked - tenant  
 says only 3 people  
 in vehicle. *OK*

Permit No. 44-1119  
 Location 103 1/2 Ave. near 61st  
 Owner Wm. J. Smith  
 Date of permit 11/15/64  
 Notif. closing-in \_\_\_\_\_  
 Inp. closing-in \_\_\_\_\_  
 Final Notif \_\_\_\_\_  
 Inp. Inp. \_\_\_\_\_  
 Cert. of Occupancy issued \_\_\_\_\_  
 Sinking Out Notice \_\_\_\_\_  
 Form Check Notice \_\_\_\_\_

*OK*



FILL IN AND SIGN WITH INK

APPLICATION FOR PERMIT FOR  
HEATING, COOKING OR POWER EQUIPMENT

Portland, Maine, October 1, 1968

PERMIT ISSUED  
1020  
CITY OF PORTLAND

To the INSPECTOR OF BUILDINGS, PORTLAND, ME.

The undersigned hereby applies for a permit to install the following heating, cooking or power equipment in accordance with the Laws of Maine, the Building Code of the City of Portland, and the following specifications:

Location 221-1/2 Commercial St. Use of Building Office No. Stories 5 New Building Existing  
Name and address of owner of appliance Portland Optical Company Inc. P.O. Box 119 Portland, Me.  
Installer's name and address Fels Company Inc. 44 Union St. Telephone 774-1925

General Description of Work

To install (1) gas-fired floor furnace (in air duct) additional heat and air-conditioning system for portion of 1st floor (Office) only

IF HEATER, OR POWER BOILER

Location of appliance 1st floor Any burnable material in floor surface or beneath? none  
If so, how protected? None Kind of fuel? gas  
Minimum distance to burnable material, from top of appliance or casing top of furnace 1'  
From top of smoke pipe 2" with 1" clearance From front of appliance over 4' From sides or back of appliance over 4'  
Size of chimney flue 12" x 16" Other connections to same flue boiler  
If gas fired, how vented? into chimney Rated maximum demand per hour 150,000  
Will sufficient fresh air be supplied to the appliance to insure proper and safe combustion? yes

IF OIL BURNER

Name and type of burner Labelled by underwriters' laboratories?  
Will operator be always in attendance? Does oil supply line feed from top or bottom of tank?  
Type of floor beneath burner Size of vent pipe  
Location of oil storage Number and capacity of tanks  
Low water shut off Make No.  
Will all tanks be more than five feet from any flame? How many tanks enclosed?  
Total capacity of any existing storage tanks for furnace burners

IF COOKING APPLIANCE

Location of appliance Any burnable material in floor surface or beneath?  
If so, how protected? Height of Legs, if any  
Skirting at bottom of appliance? Distance to combustible material from top of appliance?  
From front of appliance From sides and back From top of smokepipe  
Size of chimney flue Other connections to same flue  
Is hood to be provided? If so, how vented? Forced or gravity?  
If gas fired, how vented? Rated maximum demand per hour

MISCELLANEOUS EQUIPMENT OR SPECIAL INFORMATION

Furnace is equipped with automatic shutoff.  
Amount of fee enclosed? 2.00 (\$2.00 for one heater, etc., \$1.00 additional for each additional heater, etc., in same building at same time.)

APPROVED:  
OK 10-1-68

Will there be in charge of the above work a person competent to see that the State and City requirements pertaining thereto are observed? yes  
Fels Company Inc.

CS 300  
Signature of Installer by: Donella Fels

INSPECTION COPY

NOTES

10-7-68 Completed *GR*

*X*

Permit No. *68/1022*  
Location *CCC Camp Ground*  
Owner *James L. Campbell*  
Date of permit *7/1/68*  
Approved \_\_\_\_\_

A.F.- 600-600A congress Street

August 30, 1968

Boatright Construction Company  
P.O. Box 6139, Dallas, Texas

cc to: Harry Schwartz, 10 Congress Square  
cc to: Pearle Optical Co., Inc., Box 6139,  
Dallas, Texas

Gentlemen:

Permit to change use of first floor from "typewriter shop" to optical office with alterations is being issued subject to the following requirements of the Building Code:

1. The new store front is limited to 600 Congress Street, and does not include the section on the corner of Congress and High Streets.
2. If the occupancy is to be over 20 persons in either section, then vestibule latch sets will be required on all entrance doors. The function of this lockset is such that a person can always get out from the inside of the building by turning the usual door knob or by pressing on a thumb latch without any other locking device on the door.
3. The brick veneer on the front of the building will need to be tied to the building by metal wall ties spaced not more than 16 inches on centers at every fifth course of brick. Ties shall be crimped or corrugated galvanized metal weighing 48 pounds per thousand for a 7/8 inch wide tie, 7 inches long or a 22 gauge tie of the same size. Use of two ties nested one on top of the other at each location is required. Single 16 gauge ties may be used.

Very truly yours,

A. Allan Koule  
Assistant Director of Building Inspection

AAS:m



# APPLICATION FOR PERMIT

Class of Building or Type of Structure

Portland, Maine,

PERMIT 13501  
889  
30 1969  
CITY OF PORTLAND

To the INSPECTOR OF BUILDINGS, PORTLAND, MAINE

The undersigned hereby applies for a permit to erect alter repair demolish install the following building structure equipment in accordance with the Laws of the State of Maine, the Building Code and Zoning Ordinance of the City of Portland, plans and specifications, if any, submitted herewith and the following specifications:

Location 600-600 Congress St. Within Fire Limits? Dist. No.  
Owner's name and address Harry Edwards, 100 Congress St. Telephone  
Lessee's name and address Pearle Optical Company, Inc., 600 Congress St. Telephone  
Contractor's name and address Footright Construction Co. Telephone 75-4101  
Architect Specifications Plans yes No. of sheets  
Proposed use of building Office No. families  
Last use Office No. families  
Material brick No. stories 5 Heat Style of roof Roofing  
Other buildings on same lot  
Estimated cost \$ 6000.00 Fee \$ 12.00

## General Description of New Work

Remove 1st floor of 600 Congress St. portion of building from "typewriter shop" to Office.  
To erect non-bearing partitions for office space, and remove out portion of store front from 600 Congress St. portion of building.

It is understood that this permit does not include installation of heating apparatus which is to be taken out separately by and in the name of the heating contractor. PERMIT TO BE ISSUED TO Footright Construction Co. with back permit. Will permit.

## Details of New Work

Is any plumbing involved in this work? Is any electrical work involved in this work?  
Is connection to be made to public sewer? If not, what is proposed for sewage?  
Has septic tank notice been sent? Form notice sent?  
Height average grade to top of plate Height average grade to highest point of roof  
Size, front depth No. stories solid or filled land? earth or rock?  
Material of foundation Thickness, top bottom cellar  
Kind of roof Rise per foot Roof covering  
No. of chimneys Material of chimneys of lining Kind of heat fuel  
Framing Lumber-Kind Dressed or full size? Corner posts Sills  
Size Girder Columns under girders Size Max. on centers  
Studs (outside walls and carrying partitions) 2x4-16" O. C. Bridging in every floor and flat roof span over 8 feet.  
Joists and rafters: 1st floor, 2nd, 3rd, roof  
On centers: 1st floor, 2nd, 3rd, roof  
Maximum span: 1st floor, 2nd, 3rd, roof  
If one story building with masonry walls, thickness of walls? height?

## If a Garage

No. cars now accommodated on same lot, to be accommodated number commercial cars to be accommodated  
Will automobile repairing be done other than minor repairs to cars habitually stored in the proposed building?

APPROVED:

## Miscellaneous

Will work require disturbing of any tree on a public street? no  
Will there be in charge of the above work a person competent to see that the State and City requirements pertaining thereto are observed? yes

Footright Construction Company

INSPECTION COPY

Signature of owner by:

Harry Edwards

FM

NOTES

8/20/68 Pl. - stair deck  
senses inside structure - All.

9-23-68 Framing  
underway with changes

10-7-68 Completed

X

Permit No. 68/889  
Location 600-6004 Ingram St.  
Owner Paula Capital Co.  
Date of permit 8/30/68  
Notif. closing-in  
Insp. closing-in  
Final Notif.  
Final Inspn.  
Cert. of Occupancy issued  
Staking Out Notice  
Form Check Notice

WRITTEN CONSENT AND AGREEMENT RELATING TO A CERTAIN SIGN PROPOSED  
TO BE ERECTED PROJECTING OVER A PUBLIC SIDEWALK FROM THE PREMISES  
AT 129 600 Congress St. IN PORTLAND, MAINE

D. Schwartz & Sons, Inc. being the owner of the  
premises at 600 Congress St. in Portland, Maine hereby gives  
consent to the erection of a certain sign owned by D. Schwartz & Sons, Inc.  
projecting over the public sidewalk from said premises as described in  
application to the Inspector of Buildings of Portland, Maine for a permit  
to cover erection of said sign;

And in consideration of the issuance of said permit \_\_\_\_\_  
D. Schwartz & Sons, Inc. owner of said premises, in event said sign  
shall cease to serve the purpose for which it was erected or shall become  
dangerous and in event the owner of said sign shall fail to remove said sign  
or make it permanently safe in case the sign still serves the purpose for  
which it was erected, hereby agrees for himself or itself, for his heirs, its  
successors, and his or its assigns, to completely remove said sign within ten  
days of notice from said Inspector of Buildings that said sign is in such  
condition and of order from him to remove it.

In Witness whereof the owner of said premises has signed this  
consent and agreement this 18th day of September 1968.

Beverly D. Wyman  
Witness

D. Schwartz & Sons, Inc.  
By Harry M. Schwartz, Pres.  
Owner

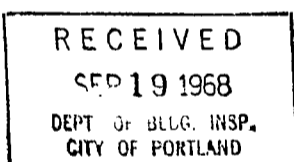



See plan for square feet. Plexiglass : Und. Label. B3 BUSINESS ZONE

APPLICATION FOR PERMIT TO ERECT  
SIGN OVER PUBLIC SIDEWALK OR STREET

PERMIT NO. 983  
SEP 23 1968  
CITY of PORTLAND

Portland, Maine, September 19, 1968 19

To the INSPECTOR OF BUILDINGS, PORTLAND, ME.

The undersigned hereby applies for a permit to erect the following described sign extending over a public sidewalk or street in accordance with the Building Code of the City of Portland, and the following specifications:

Location 600 Congress St. Within Fire Limits?            Dist. No.             
Owner of building to which sign is to be attached D. Schwartz & Sons, 10 Congress Square Bldg.  
Name and address of owner of sign Pearle Optical Company, 600 Congress St.  
Contractor's name and address Coyne Sign Company 195 St. John St. Telephone 772-4144  
When does contractor's bond expire? Dec. 31, 1968

Information Concerning Building Non-flashing lighting.

No. stories 4 Material of wall to which sign is to be attached brick

Details of Sign and Connections

Building owner's consent and agreement filed with application yes  
Electric? yes Vertical dimension after erection see plan Horizontal see plan  
Weight 1200 lbs., Will there be any hollow spaces? yes Any rigid frame? yes  
Material of frame angle iron No. advertising faces see plan Material plastic  
No. rigid connections see plan Are they fastened directly to frame of sign? yes  
No. through bolts see plan Size see plan Location, top or bottom see plan  
No. guys see plan Material angle iron Size 2x2x3/16  
Minimum clear height above sidewalk or street 10' plus  
Maximum projection into street 9' Fee \$ 2.00

Signature of contractor by J. H. Laguer

INSPECTION COPY

Permit No. 68/953  
Location 600 Engen St.  
Owner Pearle Opticians  
Date of permit 9/23/68  
Sign Contractor \_\_\_\_\_  
Final Inspn. \_\_\_\_\_

NOTES

10-1-68 Shop insp - made. JAD

10-7-68 Completed JAD

*[Handwritten signature]*

CITY OF PORTLAND, MAINE  
Application for Permit to Install Wires

Permit No. 59155

Issued Sept 10, 1968  
Portland, Maine

To the City Electrician, Portland, Maine:

The undersigned hereby applies for a permit to install wires for the purpose of conducting electric current, in accordance with the laws of Maine, the Electrical Ordinance of the City of Portland, and the following specifications:

(This form must be completely filled out — Minimum Fee, \$1.00)

Owner's Name and Address Pearl Optical Co. Tel. \_\_\_\_\_  
Contractor's Name and Address J. E. Edwards Tel. \_\_\_\_\_  
Location 600 Congress St. Use of Building \_\_\_\_\_  
Number of Families \_\_\_\_\_ Apartments \_\_\_\_\_ Stores \_\_\_\_\_ Number of Stories \_\_\_\_\_  
Description of Wiring: New Work ☒ Additions \_\_\_\_\_ Alterations \_\_\_\_\_

Pipe Cable Metal Molding BX Cable Plug Molding (No. of feet) 49.5-outlets  
No. Light Outlets 30 Plugs 10 Light Circuits 12 Plug Circuits \_\_\_\_\_  
FIXTURES: No. \_\_\_\_\_ Fluor. or Strip Lighting (No. feet) \_\_\_\_\_  
SERVICE: Pipe Cable Underground No. of Wires Size \_\_\_\_\_  
METERS: Relocated Added Total No. Meters \_\_\_\_\_  
MOTORS: Number Phase H. P. Amps Volts Starter \_\_\_\_\_  
HEATING UNITS: Domestic (Oil) No. Motors Phase H.P. \_\_\_\_\_  
Commercial (Oil) No. Motors Phase H.P. \_\_\_\_\_  
Electric Heat (No. of Rooms) \_\_\_\_\_  
APPLIANCES: No. Ranges Watts Brand Feeds (Size and No.) \_\_\_\_\_  
Elec. Heaters Watts \_\_\_\_\_  
Miscellaneous Watts Extra Cabinets or Panels \_\_\_\_\_  
Transformers Air Conditioners (No. Units) Signs (No. Units) \_\_\_\_\_  
Will commence 19 Ready to cover in 19 Inspection 19  
Amount of Fee \$ 3.00

Signed J. E. Edwards

DO NOT WRITE BELOW THIS LINE

SERVICE	METER	GROUND
VOLTS: 1 2 3 4 5 6		
7 8 9 10 11 12		

REMARKS:

INSPECTED BY J. H. Hutton (OVER)

LOCATION *Congress ST 600*  
INSPECTION DATE *9/12/68*  
WORK COMPLETED *9/12/68*  
TOTAL NO. INSPECTIONS *1*  
REMARKS:

FEEES FOR WIRING PERMITS EFFECTIVE JULY 31, 1963

WIRING

1 to 30 Outlets \$ 2.00  
31 to 60 Outlets 3.00  
Over 60 Outlets, each Outlet .05  
(Each twelve feet or fraction thereof of fluorescent lighting or any type of plug molding will be classed as one outlet).

SERVICES

Single Phase 2.00  
Three Phase 4.00

MOTORS

Not exceeding 50 H.P. 3.00  
Over 50 H.P. 4.00

HEATING UNITS

Domestic (Oil) 2.00  
Commercial (Oil) 4.00  
Electric Heat (Each Room) .75

APPLIANCES

Ranges, Cooking Tops, Ovens, Water Heaters, Disposals, Built-in Dishwashers, Dryers, and any permanent built-in appliance — each unit 1.50

MISCELLANEOUS

Temporary Service, Single Phase 1.00  
Temporary Service, Three Phase 2.00  
Circuits, Carnivals, Fairs, etc. 10.00  
Meters, relocate 1.00  
Distribution Cabinet or Panel, per unit 1.00  
Transformers, per unit 2.00  
Air Conditioners, per unit 2.00  
Signs, per unit 2.00

ADDITIONS



FILL IN AND SIGN WITH INK

APPLICATION FOR PERMIT FOR  
HEATING, COOKING OR POWER EQUIPMENT

Portland, Maine, May 31, 1968

PERMIT ISSUED

MAY 31 1968 528

CITY OF PORTLAND

To the INSPECTOR OF BUILDINGS, PORTLAND, ME.

The undersigned hereby applies for a permit to install the following heating, cooking or power equipment in accordance with the Laws of Maine, the Building Code of the City of Portland, and the following specifications:

Location 302 Congress Street Use of Building Stores & offices No. Stories 4 ☒ New Building  
Existing "☐  
Name and address of owner of appliance Harry Shwartz, 302 Congress St.  
Installer's name and address E.N. Cunningham Co., 363 Cumberland Ave. Telephone 773-9671

General Description of Work

To install oil-fired boiler for heating domestic hot water (replacement)  
(reinstalling oil-burner)

IF HEATER, OR POWER BOILER

Location of appliance basement Any burnable material in floor surface or beneath? No.  
If so, how protected? Kind of fuel? oil  
Minimum distance to burnable material, from top of appliance or casing top of furnace 4'  
From top of smoke pipe 3' From front of appliance 4' From sides or back of appliance 21"  
Size of chimney flue 15x16 Other connections to same flue boiler  
If gas fired, how vented? Rated maximum demand per hour  
Will sufficient fresh air be supplied to the appliance to insure proper and safe combustion? YES

IF OIL BURNER

Name and type of burner Labelled by underwriters' laboratories?  
Will operator be always in attendance? Does oil supply line feed from top or bottom of tank?  
Type of floor beneath burner Size of vent pipe  
Location of oil storage Number and capacity of tanks  
Low water shut off Make No.  
Will all tanks be more than five feet from any flame? How many tanks enclosed?  
Total capacity of any existing storage tanks for furnace burners

IF COOKING APPLIANCE

Location of appliance Any burnable material in floor surface or beneath?  
If so, how protected? Height of Legs, if any  
Skirting at bottom of appliance? Distance to combustible material from top of appliance?  
From front of appliance From sides and back From top of smokepipe  
Size of chimney flue Other connections to same flue  
Is hood to be provided? If so, how vented? Forced or gravity?  
If gas fired, how vented? Rated maximum demand per hour

MISCELLANEOUS EQUIPMENT OR SPECIAL INFORMATION

Amount of fee enclosed? 2.00 (\$2.00 for one heater, etc., \$1.00 additional for each additional heater, etc., in same building at same time.)

APPROVED:

O.K. 5-29-68 SD

Will there be in charge of the above work a person competent to see that the State and City requirements pertaining thereto are observed? YES

E.N. Cunningham Co.

Signature of Installer By: Kenneth T. Irish

CS 300

INSPECTION COPY

P.H.

NOTES

Family No.

68/528

100

6.3 (logics) Dr

inner &

224 *Altera*

Date of permit

11/5/31/68 D

Approved

1

CITY OF PORTLAND, MAINE  
Application for Permit to Install Wires

Permit No. 56787  
Issued 4/30/68  
Portland, Maine Apr 30, 1968

To the City Electrician, Portland, Maine:

The undersigned hereby applies for a permit to install wires for the purpose of conducting electric current, in accordance with the laws of Maine, the Electrical Ordinance of the City of Portland, and the following specifications:

(This form must be completely filled out — Minimum Fee, \$1.00)

Owner's Name and Address D. Shapley & Sons Tel. . . . .  
Contractor's Name and Address J. E. Edwards Tel. . . . .  
Location 600 Congress St Use of Building office  
Number of Families Apartments Stores Number of Stories  
Description of Wiring: New Work Additions Alterations

Pipe Cable Metal Molding BX Cable Plug Molding (No. of feet)  
No. Light Outlets 5 Plugs 7 Light Circuits Plug Circuits  
FIXTURES: No. Light Switches 2 Fluor. or Strip Lighting (No. feet) 8'  
SERVICE: Pipe Cable Underground No. of Wires Size  
METERS: Relocated Added Total No. Meters  
MOTORS: Number Phase H. P. Amps Volts Starter  
HEATING UNITS: Domestic (Oil) No. Motors Phase H.P.  
Commercial (Oil) No. Motors Phase H.P.  
Electric Heat (No. of Rooms)

APPLIANCES: No. Ranges Watts Brand Feds (Size and No.)  
Elec. Heaters Watts  
Miscellaneous Watts Extra Cabinets or Panels  
Transformers Air Conditioners (No. Units) Signs (No. Units)  
Will commence 19. . . Ready to cover in 19. . . Inspection 19. . .  
Amount of Fee \$ 2.00

Signed J. E. Edwards

DO NOT WRITE BELOW THIS LINE

SERVICE . . . . . METER . . . . . GROUND . . . . .  
VISITS: 1 . . . . . 2 . . . . . 3 . . . . . 4 . . . . . 5 . . . . . 6 . . . . .  
7 . . . . . 8 . . . . . 9 . . . . . 10 . . . . . 11 . . . . . 12 . . . . .  
REMARKS:

INSPECTED BY F. W. Hart  
(OVER)

LOCATION *Congress ST 600A*  
 INSPECTION DATE *4/30/68*  
 WORK COMPLETED *4/30/68*  
 TOTAL NO. INSPECTIONS *1*  
 REMARKS:

FEEs FOR WIRING PERMITS EFFECTIVE JULY 31, 1963

<b>WIRING</b>	
1 to 30 Outlets	(including switches) \$ 2.00
31 to 60 Outlets	(including switches) 3.00
Over 60 Outlets, each Outlet	(including switches) .05
(Each twelve feet or fraction thereof of fluorescent lighting or any type of plug molding will be classed as one outlet).	
<b>SERVICES</b>	
Single Phase	2.00
Three Phase	4.00
<b>MOTORS</b>	
Not exceeding 50 H.P.	3.00
Over 50 H.P.	4.00
<b>HEATING UNITS</b>	
Domestic (Oil)	2.00
Commercial (Oil)	4.00
Electric Heat (Each Room)	.75
<b>APPLIANCES</b>	
Ranges, Cooking Tops, Ovens, Water Heaters, Disposals, Dishwashers, etc. — Each Unit	1.50
<b>TEMPORARY WORK</b> (limited to 6 months from date of permit)	
Service, Single Phase	1.00
Service, Three Phase	2.00
Wiring, 1-50 Outlets	1.00
Wiring, each additional outlet over 50	.02
Circuits, Carnivals, Fairs, etc.	10.00
<b>MISCELLANEOUS</b>	
Distribution Cabinet or Panel, per unit	1.00
Transformers, per unit	2.00
Air Conditioning, per unit	2.00



BS BUSINESS ZONE  
48 sq.ft. (plastic face) lexiglass-Unit Label.

APPLICATION FOR PERMIT TO ERECT  
SIGN OVER PUBLIC SIDEWALK OR STREET

PERMIT ISSUED

MAY 14 1968

Portland, Maine, May 9 1968

To the INSPECTOR OF BUILDINGS, PORTLAND, ME.

The undersigned hereby applies for a permit to erect the following described sign extending over a public sidewalk or street in accordance with the Building Code of the City of Portland, and the following specifications:

Location 600 Congress St. (602) Within Fire Limits? Dist. No.

Owner of building to which sign is to be attached Harry Schwartz, 10 Congress Square Bldg.

Name and address of owner of sign Casco Opticians, 600 Congress St.

Contractor's name and address Coyne Sign Co. 195 St. John St. Telephone 772-4144

When does contractor's bond expire? Dec. 31, 1968

Information Concerning Building non-flashing, light brick  
No. stories 5 Material of wall to which sign is to be attached

Details of Sign and Connections  
Building owner's consent and agreement filed with application yes

Electric? yes Vertical dimension after erection 4' Horizontal 12'

Weight 150 lbs. Will there be any hollow spaces? yes Any rigid frame? yes

Material of frame extruded aluminum No. advertising faces 1 material plastic

No. rigid connections 6 Are they fastened directly to frame of sign? yes

No. through bolts 6 Size 1/2" Location, top or bottom bottom

No. guys - material Size

Minimum clear height above sidewalk or street 11'

Maximum projection into street 4" Fee \$ 2.00

Signature of contractor by: [Signature]

INSPECTION COPY

68/441

Permit No. 68/441  
Location 600 Congress St.  
Owner Carroll O'Brien  
Date of permit 5/14/68  
Sign Contractor  
Final Inspn.

NOTES

5/14/68 - Same location but  
larger sign that has been  
taken down - Allen  
5/16/68 - Shop jump  
made. P.S.R.  
7/8/68 - work done  
P.S.R.

X

WRITTEN CONSENT AND AGREEMENT RELATING TO A CERTAIN SIGN PROPOSED  
TO BE ERECTED PROJECTING OVER A PUBLIC SIDEWALK FROM THE PREMISES  
AT 602 Congress St. IN PORTLAND, MAINE

David Shwartz & Sons, Inc. being the owner of the  
premises at 602 Congress St. in Portland, Maine hereby gives  
consent to the erection of a certain sign owned by Casco Optitions  
projecting over the public sidewalk from said premises as described in  
application to the Inspector of Buildings of Portland, Maine for a permit  
to cover erection of said sign;

And in consideration of the issuance of said permit \_\_\_\_\_  
David Shwartz & Sons, Inc., owner of said premises, in event said sign  
shall cease to serve the purpose for which it was erected or shall become  
dangerous and in event the owner of said sign shall fail to remove said sign  
or make it permanently safe in case the sign still serves the purpose for  
which it was erected, hereby agrees for himself or itself, for his heirs, its  
successors, and his or its assigns, to completely remove said sign within ten  
days of notice from said Inspector of Buildings that said sign is in such  
condition and of order from him to remove it.

In Witness whereof the owner of said premises has signed this  
consent and agreement this 10th day of May 1968 .

Thomas H. Hackett  
Witness

DAVID SHWARTZ & SONS, INC.  
By Harry M. Shwartz President  
owner.

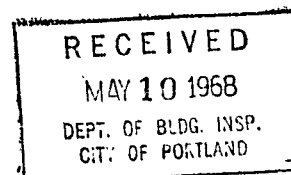

**CITY OF PORTLAND, MAINE**  
**Application for Permit to Install Wires**

Permit No. 57459  
 Issued 12/20/67  
 Portland, Maine Dec 20, 1967

To the City Electrician, Portland, Maine:

The undersigned hereby applies for a permit to install wires for the purpose of conducting electric current, in accordance with the laws of Maine, the Electrical Ordinance of the City of Portland, and the following specifications:

(This form must be completely filled out -- Minimum Fee, \$1.00)

Owner's Name and Address D. Sherry, 9 Davis Tel. \_\_\_\_\_  
 Contractor's Name and Address T. E. Edwards, Inc. Tel. \_\_\_\_\_  
 Location 600 Congress St Use of Building \_\_\_\_\_  
 Number of Families \_\_\_\_\_ Apartments \_\_\_\_\_ Stores \_\_\_\_\_ Number of Stories \_\_\_\_\_  
 Description of Wiring: New Work \_\_\_\_\_ Additions ☒ Alterations ☒  
 ..  
 Pipe \_\_\_\_\_ Cable \_\_\_\_\_ Metal Molding \_\_\_\_\_ BX Cable \_\_\_\_\_ Plug Molding (No. of feet) \_\_\_\_\_  
 No. Light Outlets 5 Plugs \_\_\_\_\_ Light Circuits 1 Plug Circuits \_\_\_\_\_  
 FIXTURES: No. \_\_\_\_\_ Light Switches 2 Fluor. or Strip Lighting (No. feet) \_\_\_\_\_  
 SERVICE: Pipe \_\_\_\_\_ Cable \_\_\_\_\_ Underground \_\_\_\_\_ No. of Wires \_\_\_\_\_ Size \_\_\_\_\_  
 METERS: Relocated 1 Added \_\_\_\_\_ Total No. Meters \_\_\_\_\_  
 MOTORS: Number \_\_\_\_\_ Phase \_\_\_\_\_ H. P. \_\_\_\_\_ Amps \_\_\_\_\_ Volts \_\_\_\_\_ Starter \_\_\_\_\_  
 HEATING UNITS: Domestic (Oil) \_\_\_\_\_ No. Motors \_\_\_\_\_ Phase \_\_\_\_\_ H.P. \_\_\_\_\_  
 Commercial (Oil) \_\_\_\_\_ No. Motors \_\_\_\_\_ Phase \_\_\_\_\_ H.P. \_\_\_\_\_  
 Electric Heat (No. of Rooms) \_\_\_\_\_  
 APPLIANCES: No Ranges \_\_\_\_\_ Watts \_\_\_\_\_ Brand Feeds (Size and No.) \_\_\_\_\_  
 Elec. Heaters \_\_\_\_\_ Watts \_\_\_\_\_  
 Miscellaneous \_\_\_\_\_ Watts \_\_\_\_\_ Extra Cabinets or Panels \_\_\_\_\_  
 Transformers \_\_\_\_\_ Air Conditioners (No. Units) \_\_\_\_\_ Units (No. Units) \_\_\_\_\_  
 Will commence 19 Ready to cover in 19 Inspection 19  
 Amount of Fee \$ 2.00

Signed T. E. Edwards

DO NOT WRITE BELOW THIS LINE

SERVICE	METER				GROUND	
VISITS: 1	2	3	4	5	6	
..... 7	8	9	10	11	12	
REMARKS:						

INSPECTED BY [Signature]  
 (OVER)

LOCATION *Congress ST 602*  
 INSPECTION DATE *12/21/67*  
 WORK COMPLETED *12/21/67*  
 TOTAL NO. INSPECTIONS *1*  
 REMARKS:

FEEES FOR WIRING PERMITS EFFECTIVE JULY 31, 1963

WIRING

1 to 30 Outlets	(including switches)	\$ 2.00
31 to 60 Outlets	(including switches)	3.00
Over 60 Outlets, each Outlet	(including switches)	.05
(Each twelve feet or fraction thereof of fluorescent lighting or any type of plug molding will be classed as one outlet).		

SERVICES

Single Phase	2.00
Three Phase	4.00

MOTORS

Not exceeding 50 H.P.	3.00
Over 50 H.P.	4.00

HEATING UNITS

Domestic (Oil)	2.00
Commercial (Oil)	4.00
Electric Heat (Each Room)	.75

APPLIANCES

Ranges, Cooking Tops, Ovens, Water Heaters, Disposals, Dishwashers, etc. -- Each Unit	1.50
---	------

TEMPORARY WORK (limited to 6 months from date of permit)

Service, Single Phase	1.00
Service, Three Phase	2.00
Wiring, 1-50 Outlets	1.00
Wiring, each additional outlet over 50	.02
Circuses, Carnivals, Fairs, etc.	10.00

MISCELLANEOUS

Distribution Cabinet or Panel, per unit	1.00
Transformers, per unit	2.00
Air Conditioners, per unit	2.00

CITY OF PORTLAND, MAINE  
Application for Permit to Install Wires

Permit No. ....  
Issued .....  
Portland, Maine *Sept. 28, 1967*

To the City Electrician, Portland, Maine:

The undersigned hereby applies for a permit to install wires for the purpose of conducting electric current, in accordance with the laws of Maine, the Electrical Ordinance of the City of Portland, and the following specifications:

(This form must be completely filled out — Minimum Fee, \$1.00)

Owner's Name and Address *Harry Stewart* Tel. ....  
Contractor's Name and Address *J. E. Edwards* Tel. ....  
Location *602 Congress St.* Use of Building .....  
Number of Families ..... Apartments ..... Stores ..... Number of Stories .....  
Description of Wiring: New Work ..... Additions ..... Alterations .....  
  
Pipe ..... Cable ..... Metal Molding ..... BX Cable ..... Plug Molding (No. of feet) .....  
No. Light Outlets ..... Plugs ..... Light Circuits ..... Plug Circuits .....  
FIXTURES: No. ..... Light Switches ..... Fluor. or Strip Lighting (No. feet) .....  
SERVICE: Pipe ..... Cable ..... Underground ..... No. of Wires ..... Size .....  
METERS: Relocated ..... Added *1* ..... Total No. Meters .....  
MOTORS: Number ..... Phase ..... H. P. ..... Amps ..... Volts ..... Starter .....  
HEATING UNITS: Domestic (Oil) ..... No. Motors ..... Phase ..... H.P. ....  
Commercial (Oil) ..... No. Motors ..... Phase ..... H.P. ....  
Electric Heat (No. of Rooms) .....  
APPLIANCES: No. Ranges ..... Watts ..... Brand Feeds (Size and No.) .....  
Elec. Heaters ..... Watts .....  
Miscellaneous ..... Watts ..... Extra Cabinets or Panels .....  
Transformers ..... Air Conditioners (No. Units) ..... Signs (No. Units) .....  
Will commence ..... 19 ... Ready to cover in ..... 19 ... Inspection ..... 19 ...  
Amount of Fee \$ ..... Signed *J. E. Edwards*

DO NOT WRITE BELOW THIS LINE

SERVICE <i>✓</i>	METER	GROUND <i>✓</i>
VISITS: 1 ..... 2 ..... 3 ..... 4 ..... 5 ..... 6 .....		
..... 7 ..... 8 ..... 9 ..... 10 ..... 11 ..... 12 .....		

REMARKS:

INSPECTED BY *Tw Hester*

(OVER)

LOCATION *Congress St 602*  
 INSPECTION DATE *9/28/67*  
 WORK COMPLETED *9/28/67*  
 TOTAL NO. INSPECTIONS *1*  
 REMARKS:

FEE FOR WIRING PERMITS EFFECTIVE JULY 31, 1963

WIRING		
1 to 30 Outlets	(including switches)	\$ 2.00
31 to 60 Outlets	(including switches)	3.00
Over 60 Outlets, each Outlet	(including switches)	.05
(Each twelve feet or fraction thereof of fluorescent lighting or any type of plug molding will be classed as one outlet).		
SERVICES		
Single Phase		3.00
Three Phase		4.00
MOTORS		
Not exceeding 50 H.P.		2.00
Over 50 H.P.		4.00
HEATING UNITS		
Domestic (Oil)		.75
Commercial (Oil)		
Electric Heat (Each Room)		1.50
APPLIANCES		
Ranges, Cooking Tops, Ovens, Water Heaters, Disposals, Dishwashers, etc. — Each Unit		1.00
TEMPORARY WORK (limited to 6 months from date of permit)		2.00
Service, Single Phase		1.00
Service, Three Phase		.02
Wiring, 1-50 Outlets		10.00
Wiring, each additional outlet over 50		
Circuses, Carnivals, Fairs, etc.		1.00
MISCELLANEOUS		
Distribution Cabinet or Panel, per unit		2.00
Transformers, per unit		2.00
Air Conditioners, per unit		2.00
Signs, per unit		1.00

# CITY OF PORTLAND, MAINE

## Application for Permit to Install Wires

Permit No. 53968  
 Issued July 21, 1967  
 Portland, Maine

To the City Electrician, Portland, Maine:

The undersigned hereby applies for a permit to install wires for the purpose of conducting electric current, in accordance with the laws of Maine, the Electrical Ordinance of the City of Portland, and the following specifications:

(This form must be completely filled out — Minimum Fee, \$1.00)

Owner's Name and Address David Schwartz & Son, 10 Congress Square, Portland  
 Contractor's Name and Address Ballard Oil, 135 Marginal Way Tel. Portland  
 Location 602 Congress Street Use of Building Office Building  
 Number of Families Apartments Stores Number of Stories  
 Description of Wiring: New Work X Additions Alterations  
 Wiring of high pressure gun type burner to code.  
 Pipe Cable Metal Molding BX Cable Plug Molding (No. of feet)  
 No. Light Outlets Plugs Light Circuits Fluor. or Strip Lighting (No. feet)  
 FIXTURES: No. Light Switches No. of Wires Size  
 SERVICE: Pipe Cable Underground Total No. Meters  
 METERS: Relocated Added H. P. 1/8 Amps 3.0 Volts 115 Starter  
 MOTORS: Number 1 Phase 1 No. Motors Phase H.P.  
 HEATING UNITS: Domestic (Oil) No. Motors Phase H.P.  
 Commercial (Oil) No. Motors Phase H.P.  
 Electric Heat (No. of Rooms) and Feeds (Size and No.)  
 APPLIANCES: No. Ranges Watts  
 Elec. Heaters Watts  
 Miscellaneous Watts  
 Transformers Air Conditioners (No. Units) Extra Cabinets or Panels  
 Will commence 8-10 1967 Ready to cover in 19 Inspection 8-15 19 67  
 Amount of Fee \$ 2.00  
 Signed L. W. Jordan Ballard Oil & Equipment Co.

DO NOT WRITE BELOW THIS LINE

		METER		GROUND	
SERVICE					
VISITS: 1	2	3	4	5	6
7	8	9	10	11	12
REMARKS:					

INSPECTED BY *JW H* (OVER)

LOCATION Congress St 602  
INSPECTION DATE 8/16/67  
WORK COMPLETED 8/16/67  
TOTAL NO. INSPECTIONS 1  
REMARKS:

FEEES FOR WIRING PERMITS EFFECTIVE JULY 31, 1963

WIRING		
1 to 30 Outlets	(including switches)	\$ 2.00
31 to 60 Outlets	(including switches)	3.00
Over 60 Outlets, each Outlet	(including switches)	.05
(Each twelve feet or fraction thereof of fluorescent lighting or any type of plug molding will be classed as one outlet).		
SERVICES		
Single Phase		2.00
Three Phase		4.00
MOTORS		
Not exceeding 50 H.P.		3.00
Over 50 H.P.		4.00
HEATING UNITS		
Domestic (oil)		2.00
Commercial (Oil,		4.00
Electric Heat (Each Room)		.75
APPLIANCES		
Ranger, Cooking Tops, Ovens, Water Heaters, Disposals, Dishwashers, etc. — Each Unit		1.50
TEMPORARY WORK (Limited to 6 months from date of permit)		
Service, Single Phase		1.00
Service, Three Phase		2.00
Wiring, 1-50 Outlets		1.00
Wiring, each additional outlet over 50		.02
Circuits, Carnivals, Fairs, etc.		10.00
MISCELLANEOUS		
Distribution Cabinet or Panel, per unit		1.00
Transformers, per unit		2.00
Air Conditioners, per unit		2.00
Signs, per unit		2.00
ADDITIONS		
5 Outlets, or less		1.00



FILL IN AND SIGN WITH INK

APPLICATION FOR PERMIT FOR  
HEATING, COOKING OR POWER EQUIPMENT

Portland, Maine, July 21, 1967

PERMIT ISSUED  
JUL 24 1967  
CITY OF PORTLAND

To the INSPECTOR OF BUILDINGS, PORTLAND, ME.

The undersigned hereby applies for a permit to install the following heating, cooking or power equipment in accordance with the Laws of Maine, the Building Code of the City of Portland, and the following specifications:

Location **602 Congress St.** Use of Building **Office Bldg.** No Stories ☒ New Building  
Name and address of owner of appliance **David Schwartz & Son, 10 Congress Square** Existing "☐  
Installer's name and address **Ballard Oil & Equipment Co. 135 Marginalway** Telephone

General Description of Work

To install **Oil burning equipment in connection with existing steam heat. (replacement)**

IF HEATER, OR POWER BOILER

Location of appliance Any burnable material in floor surface or beneath?  
If so, how protected? Kind of fuel?  
Minimum distance to burnable material, from top of appliance or casing top of furnace  
From top of smoke pipe From front of appliance From sides or back of appliance  
Size of chimney flue Other connections to same flue  
If gas fired, how vented? Rated maximum demand per hour  
Will sufficient fresh air be supplied to the appliance to insure proper and safe combustion?

IF OIL BURNER

Name and type of burner **Waltham-gunttype** Labelled by underwriters' laboratory? **yes**  
Will operator be always in attendance? Does oil supply line feed from top or bottom of tank? **bottom**  
Type of floor beneath burner **concrete** Size of vent pipe **1 1/2"-existing**  
Location of oil storage **outside underground existing** Number and capacity of tanks **2000 gals. existing**  
Low water shut off **yes** Make **McDonnell-Miller-** No. **47- existing**  
Will all tanks be more than five feet from any flame? **yes** How many tanks enclosed?  
Total capacity of any existing storage tanks for furnace burners

IF COOKING APPLIANCE

Location of appliance Any burnable material in floor surface or beneath?  
If so, how protected? Height of Legs, if any  
Skirting at bottom of appliance? Distance to burnable material from top of appliance?  
From front of appliance From side and back From top of smokepipe  
Size of chimney flue Other connections to same flue  
Is hood to be provided? If so, how vented? Forced or gravity?  
If gas fired, how vented? Rated maximum demand per hour

MISCELLANEOUS EQUIPMENT OR SPECIAL INFORMATION

Amount of fee enclosed? **2.00** (\$2.00 for one heater, etc.; \$1.00 additional for each additional heater, etc., in same building at same time.)

APPROVED:

**O.K. 7-21-67**

Will there be in charge of the above work a person competent to see that the State and City requirements pertaining thereto are observed? **yes**

CS 3-70

INSPECTION COPY

by:  
Signature of Installer

**Ernest H. Ballard**

**7/21**