

HEAD

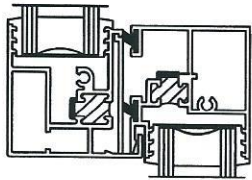

MEETING
RAIL

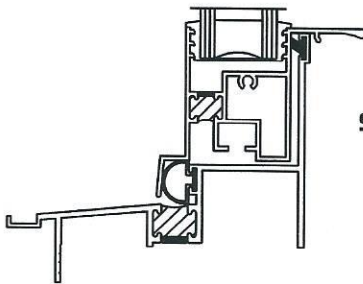

SILL

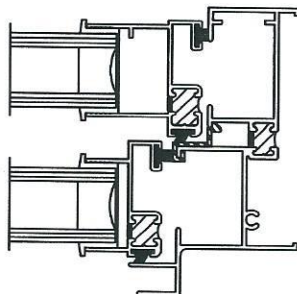

JAMB

UNIVERSAL WINDOW AND DOOR, LLC.

303 Mechanic Street,
Marlborough, MA 01752
800-633-0108 508-481-2850
www.universalwindow.com

SPECIFICATIONS

General: All aluminum windows furnished as shown in the plans shall conform to the specifications in ANSI/AAMA 101-93. They are furnished with all necessary hardware, trim and miscellaneous items as specified.

Material: Aluminum used is commercial quality 6063-T5 alloy with a minimum ultimate tensile strength of 22,000 psi, free of defects impairing strength and durability, and with standard wall tolerances as defined in the Architectural Aluminum Manufacturer's Association Master Specifications for Aluminum Windows. All members of the frame and sash shall be split and bridged with a continuous structural thermal break of high density, low conductivity urethane insulation cavity fill, with removal of the extrusion cavity bridging aluminum after curing.

Weatherstripping: Equal to Fin pile or Virgin Vinyl where called for.

Construction and Operation: Windows are assembled to perform as herein specified, to assure a neat appearance and weather tight construction. All sash and frame members are firmly joined with mechanical joints using stainless steel screws into integral screw ports. Each frame corner joint is secured with two screws. Sash corner joints are telescoped for rigidity and neatness. Meeting rails have mechanical interlocks, and the horizontal rails of the upper and lower sashes have extruded handles for operating the sashes. When windows are not being expressly used for ventilation, they must be fully closed and locked. Failure to do so may result in personal injury or damage to property. All sashes are tilt type for easy cleaning. Top sashes have "Anti-Creep" latch.

Glazing: Sashes are glazed with 1" sealed insulated glass, using "Float Glass" quality, and constructed to allow field replacement of glazing material. Glazing is "Marine" type wrap around vinyl gasket, without the use of removable beads or glazing compound.

All insulated glass conforms to, and is in compliance with, ASTM E 773-83 AN E 744-74A- Class CBA.

Finish: The exposed surfaces of all aluminum members shall be clean and free of serious blemishes, scratches or tool marks. Standard finish is electrostatically applied acrylic enamel with a 5-stage chromate under-coating conforming to AAMA 603.8 standard. Standard colors are white, black, bronze, green and beige (see color chart). Other architect specified finishes may be available at additional cost.

Hardware: All fasteners, screws and other miscellaneous fastening devices shall be of non-corrosive material compatible with aluminum. Balances of appropriate size and capacity to hold each sash stationary at open position are factory installed. They meet AAMA 902.2 specification, and are easily replaceable after the window is installed. Block and Tackle balances are standard. Ultra-lift balances are available at additional cost.

Screens: Optional half-screens shall have extruded aluminum frames securely joined at the corners, and finish will match that of the window frame. Screens are of fiberglass screen cloth 18x16 mesh held into the frame with a vinyl spline. Screens are re-wirable and easily removable by side compression of two springs. **WARNING:** Insect screens are intended to provide reasonable insect control, and are not intended to provide for the retention of objects or persons from the interior.

OPTIONS

Glass: Low-E, Soft-Coat, Solar Control, Argon, Tempered, Obscure, Wire, or Spandrel

Ultra Lift or Spiral Balances

Exterior Panning Systems (Square and Colonial Types)

Interior Trim System

Receptor Systems

Flange Frame

Special Finishes and Custom Architectural Finishes

Child Guard and Vandal Screens

Internal or External Grids and External Colonial Grids