

**FIRST FLOOR KEY PLAN**  
SCALE: 3/32" = 1'-0"

AREA OF WORK  
EXISTING WALLS

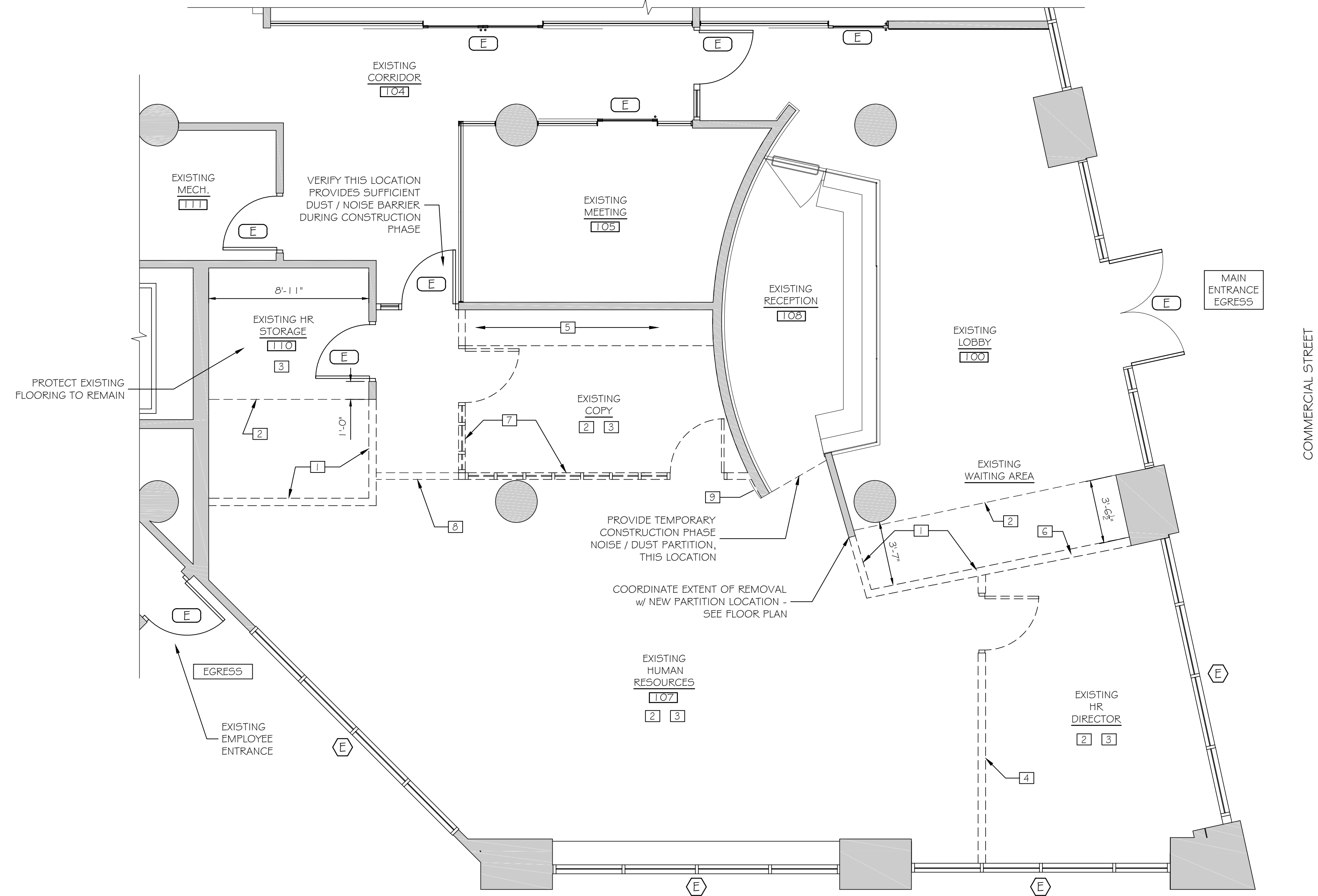

**DEMOLITION PLAN**  
SCALE: 1/4" = 1'-0"

**DEMOLITION NOTES**

- 1 REMOVE EXISTING PARTITION IN ITS ENTIRETY.
- 2 REMOVE EXISTING FLOORING IN ITS ENTIRETY.
- 3 REMOVE EXISTING SUSPENDED CEILING & LIGHTING, DETECTORS / NFPA DEVICES, SPEAKERS, ETC. IN THEIR ENTIRETY. SALVAGE ITEMS INCLUDING ALL DEVICES AND FIXTURES FOR REUSE. SEE SHEET A-2.
- 4 REMOVE EXISTING PARTITION, DOOR, AND FRAME IN ITS ENTIRETY. SALVAGE LOCKSET FOR OWNER.
- 5 REMOVE EXISTING WALL / BASE CABINETS & COUNTERS IN THEIR ENTIRETY.
- 6 REMOVE EXISTING SHEETROCK MECHANICAL SOFFIT AND LIGHTING. SALVAGE DIFFUSER GRILLES & LIGHT FIXTURES FOR REUSE IN NEW WORK. SEE MECHANICAL / ELECTRICAL DRAWINGS.
- 7 REMOVE ALUMINUM / GLASS STOREFRONT WALL, DOOR AND SOFFIT WALL ABOVE IN THEIR ENTIRETY. SALVAGE LOCKSET FOR OWNER.
- 8 REMOVE EXISTING SOFFIT IN ITS ENTIRETY.
- 9 REMOVE EXISTING WALL COVERING TO CORNER. PATCH EXISTING GWB & PREP FOR NEW FINISHES.

**GENERAL DEMOLITION NOTES**

1. COORDINATE ALL DEMOLITION ACTIVITIES AND SEQUENCE WITH OWNER PRIOR TO COMMENCEMENT OF THE WORK.
2. WAITING AREA PARTITION WORK SHALL BE PERFORMED DURING NON-MEMIC BUSINESS HOURS (7:00 AM TO 5 PM, M-F)
3. DO NOT USE MAIN ENTRANCE FOR ANY CONSTRUCTION ACTIVITIES EXCEPT AS NEEDED FOR NEW WAITING AREA PARTITION / MECHANICAL / ELECTRICAL WORK.

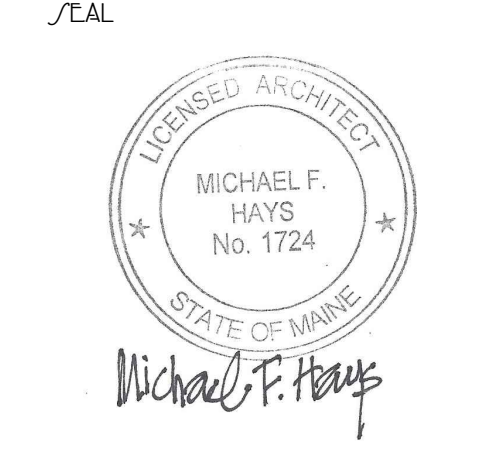

REVISIONS  
DRAWING NAME

**MEMIC RENOVATION TO HUMAN RESOURCES AT**  
261 COMMERCIAL ST. PORTLAND, MAINE 04101

**DEMOLITION PLAN**

DATE: 23 FEB 2017  
SCALE: AS NOTED  
DRAWN: MFH/mgk  
JOB NO. 170203

**AD-1**  
COPYRIGHT REPRODUCTION OR REV. OF THIS DOCUMENT WITHOUT WRITTEN PERM./NOT FROM GRANT HAYS ASSOCIATES IS PROHIBITED.