

4 | BAY WINDOW STREET LEVEL REFLECTED CEILING PLAN  
1/4" = 1'-0"

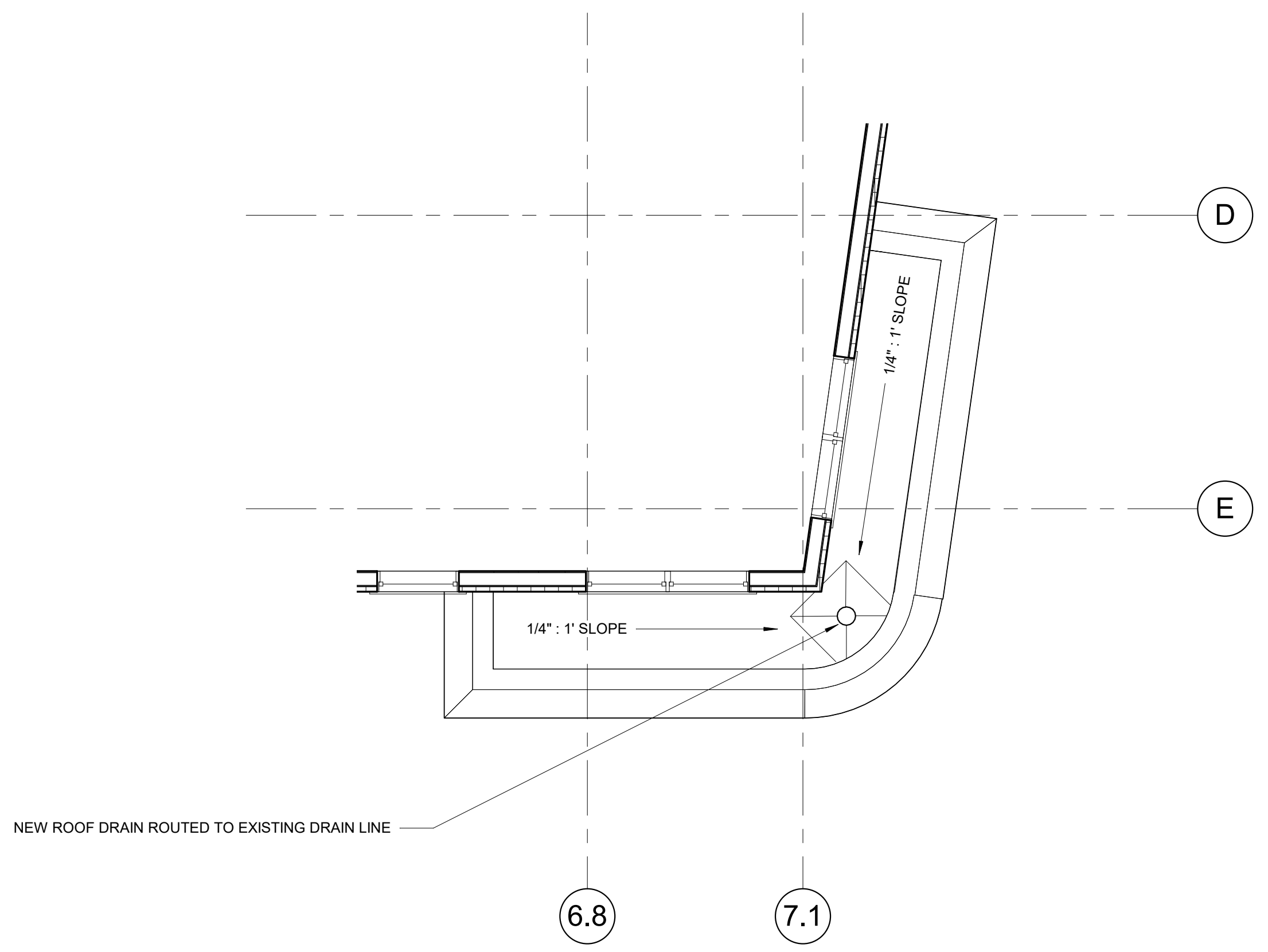

2 | BAY WINDOW ROOF PLAN  
1/4" = 1'-0"

**LEGEND:**

BUILDING SECTION	
WALL SECTION	
SECTION DETAIL	
PLAN DETAIL	
WALL TYPE	
FLOOR TYPE	

NEW WALL - STUD & GYP. BD.	
NEW CMU WALL	
NEW MASONRY INFILL	
EXISTING CMU WALL	
EXISTING STUD WALL OR FLOOR	
EXISTING MASONRY WALL	
DEMO AND REMOVE	
EXISTING BASEBOARD	
EXISTING WHITEBOARD & CHALKTRAY	
SEMI RECESSED FIRE EXTINGUISHER CABINET	
INTERNATIONAL SYMBOL OF ACCESSIBILITY	
INTERNATIONAL SYMBOL OF ACCESS FOR HEARING LOSS	
EXISTING DOOR	
NEW DOOR	
NEW FLOOR ON NEW FRAMING- SEE STRUCTURAL	
NEW CONCRETE FLOOR	

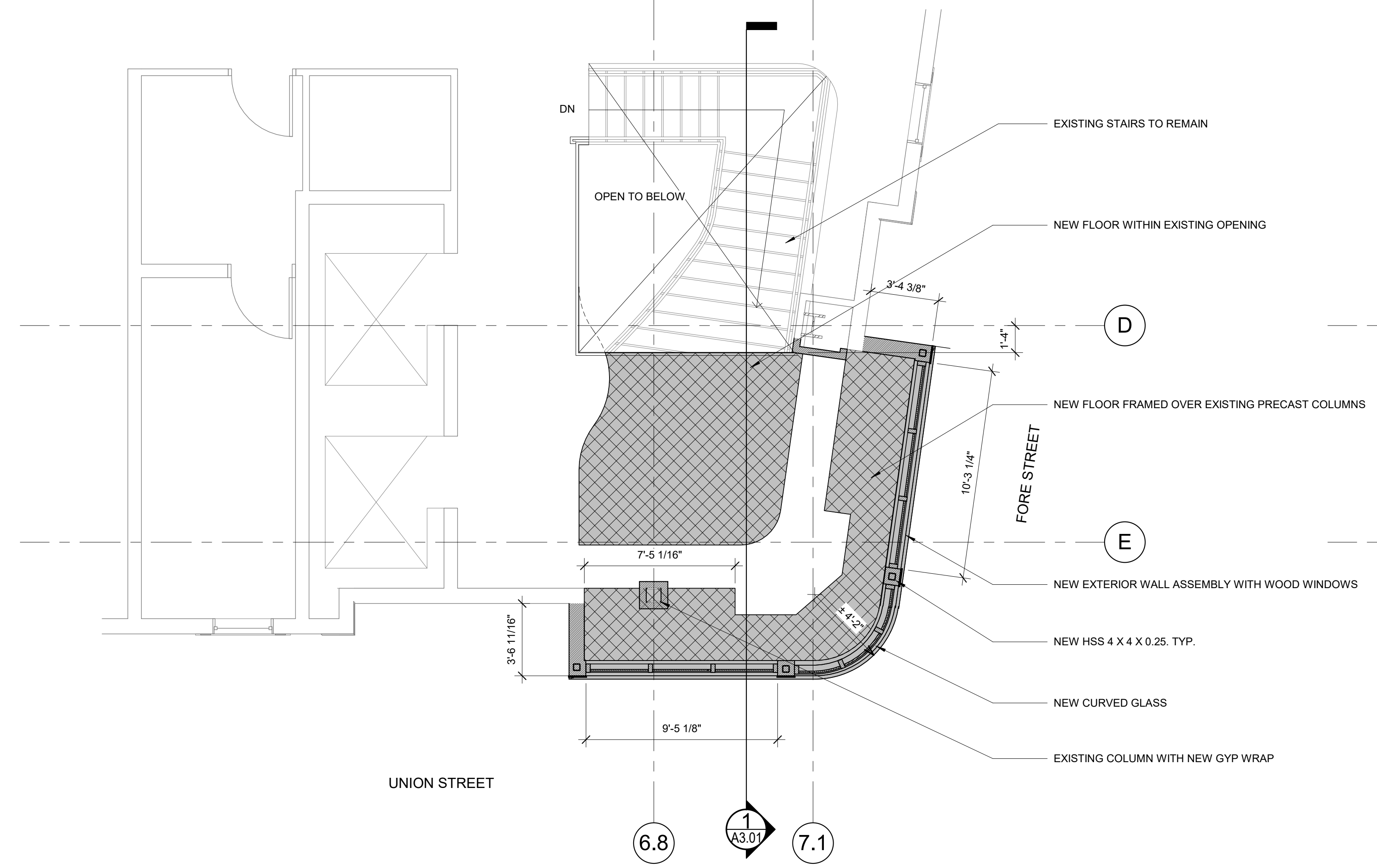

3 | 1ST FLOOR OF HOTEL - NEW BAY WINDOW  
1/4" = 1'-0"

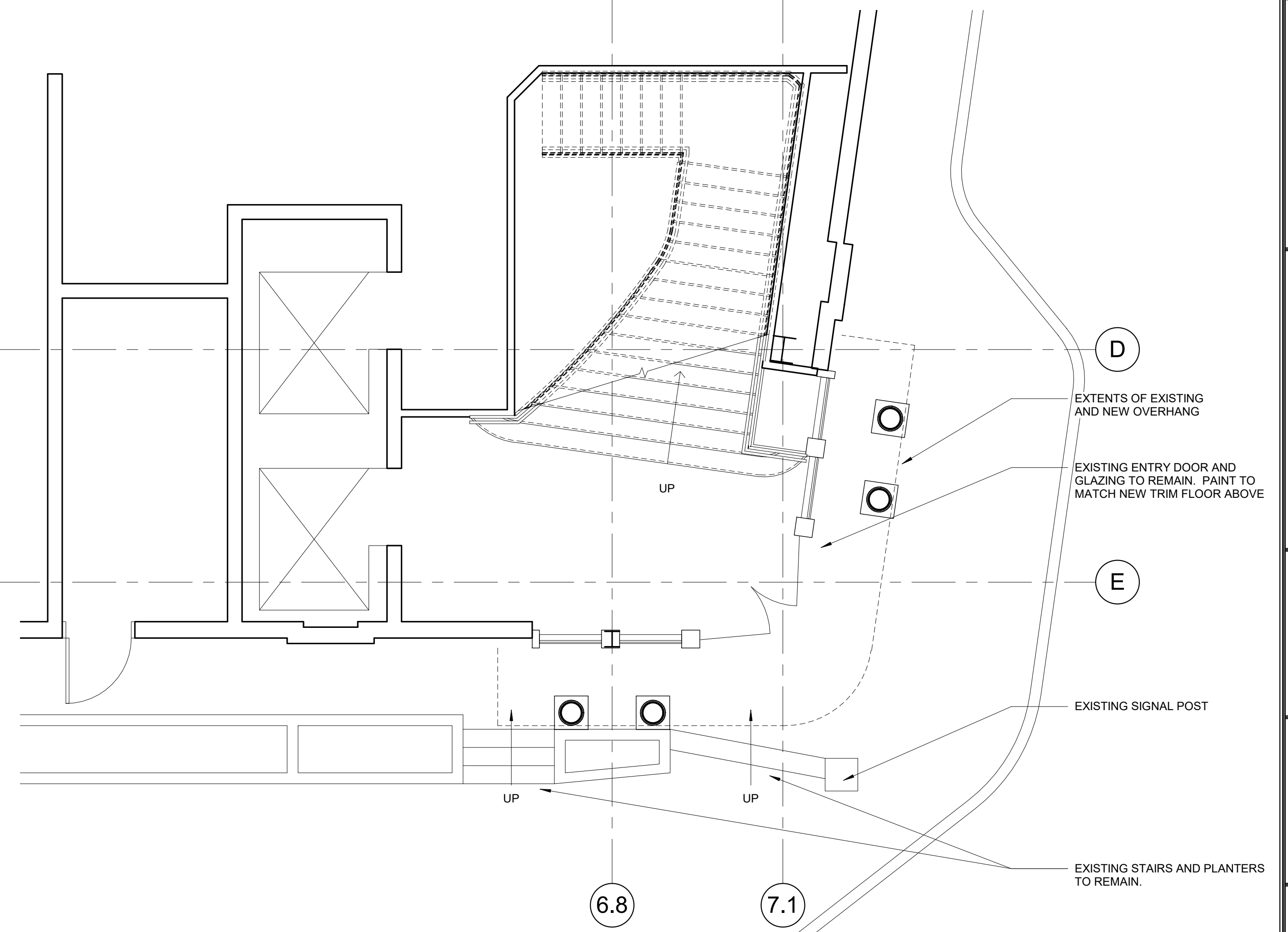

1 | LOBBY - STREET LEVEL  
1/4" = 1'-0"

LICENSED ARCHITECT  
DAVID LLOYD  
NO. 936  
STATE OF MAINE

Prepared For: **HARBOR PLAZA ASSOCIATES II**  
470 FORE ST. SUITE 400  
PORTLAND, ME 04101

Consultant: **ARCHETYPE architects**  
48 Union Wharf Portland, Maine 04101  
(207) 772-6022 ARCHETYPE@ARCHETYPEPA.COM

Project: **PORTLAND HARBOR HOTEL**  
468 Fore Street Portland, ME 04101

Date: 12 OCT 2016  
Scale: As indicated  
ENTRANCE, FIRST FLOOR, AND ROOF PLAN

A1.01