

City of Portland, Maine - Building or Use Permit Application
 389 Congress Street, 04101 Tel: (207) 874-8703, Fax: (207) 874-8716

PERMIT ISSUED		CBL:
Permit No: 01-1361	Issue Date: NOV 20 2001	038 F009002

Location of Construction: 259 Commercial St - 261	Owner Name: Dictar Associates Ii	Owner Address: Po Box 3572	Phone: 20-772-2992
Business Name: n/a	Contractor Name: Jellison Construction 570-9392	Contractor Address: 6 Marry Oaks Windham	Phone: 2078709392
Lessee/Buyer's Name: n/a	Phone: n/a	Permit Type: Alterations - Commercial	Zone: B-3

Past Use: Commercial / Office Space	Proposed Use: Commercial / Office Space; add 5 offices to vacant space. 5th floor	Permit Fee: \$144.00	Cost of Work: \$20,000.00	CEO District: 1
Proposed Project Description: Add 5 Offices Spaces		FIRE DEPT: <input checked="" type="checkbox"/> Approved <input type="checkbox"/> Denied	INSPECTION: Use Group: 8 Type:	
		Signature: <i>[Signature]</i>	Signature: <i>[Signature]</i>	
PEDESTRIAN ACTIVITIES DISTRICT (P.A.D.)				
Action: <input type="checkbox"/> Approved <input type="checkbox"/> Approved w/Conditions <input type="checkbox"/> Denied				
Signature: _____ Date: _____				

Permit Taken By: gg	Date Applied For: 11/02/2001	Zoning Approval		
-------------------------------	--	------------------------	--	--

1. This permit application does not preclude the Applicant(s) from meeting applicable State and Federal Rules. 2. Building permits do not include plumbing, septic or electrical work. 3. Building permits are void if work is not started within six (6) months of the date of issuance. False information may invalidate a building permit and stop all work..	Special Zone or Reviews <input type="checkbox"/> Shoreland <input type="checkbox"/> Wetland <input type="checkbox"/> Flood Zone <input type="checkbox"/> Subdivision <input type="checkbox"/> Site Plan Maj <input type="checkbox"/> Minor <input type="checkbox"/> MM <input type="checkbox"/> Date: 11/5/01	Zoning Appeal <input type="checkbox"/> Variance <input type="checkbox"/> Miscellaneous <input type="checkbox"/> Conditional Use <input type="checkbox"/> Interpretation <input type="checkbox"/> Approved <input type="checkbox"/> Denied Date: _____	Historic Preservation <input type="checkbox"/> Not in District or Landmark <input type="checkbox"/> Does Not Require Review <input type="checkbox"/> Requires Review <input type="checkbox"/> Approved <input type="checkbox"/> Approved w/Conditions any exterior work shall require a separate review <input type="checkbox"/> Denied Date: 11/5/01 Approved
--	---	---	---

CERTIFICATION

I hereby certify that I am the owner of record of the named property, or that the proposed work is authorized by the owner of record and that I have been authorized by the owner to make this application as his authorized agent and I agree to conform to all applicable laws of this jurisdiction. In addition, if a permit for work described in the application is issued, I certify that the code official's authorized representative shall have the authority to enter all areas covered by such permit at any reasonable hour to enforce the provision of the code(s) applicable to such permit.

SIGNATURE OF APPLICANT	ADDRESS	DATE	PHONE
RESPONSIBLE PERSON IN CHARGE OF WORK, TITLE		DATE	PHONE

New Walls
Office Partitions

\$20,000

26' Commercial St
Victor BSS. 772-2992

9' Ceiling Height

2x4 steel studs
1/2" floor joist
steel door frames

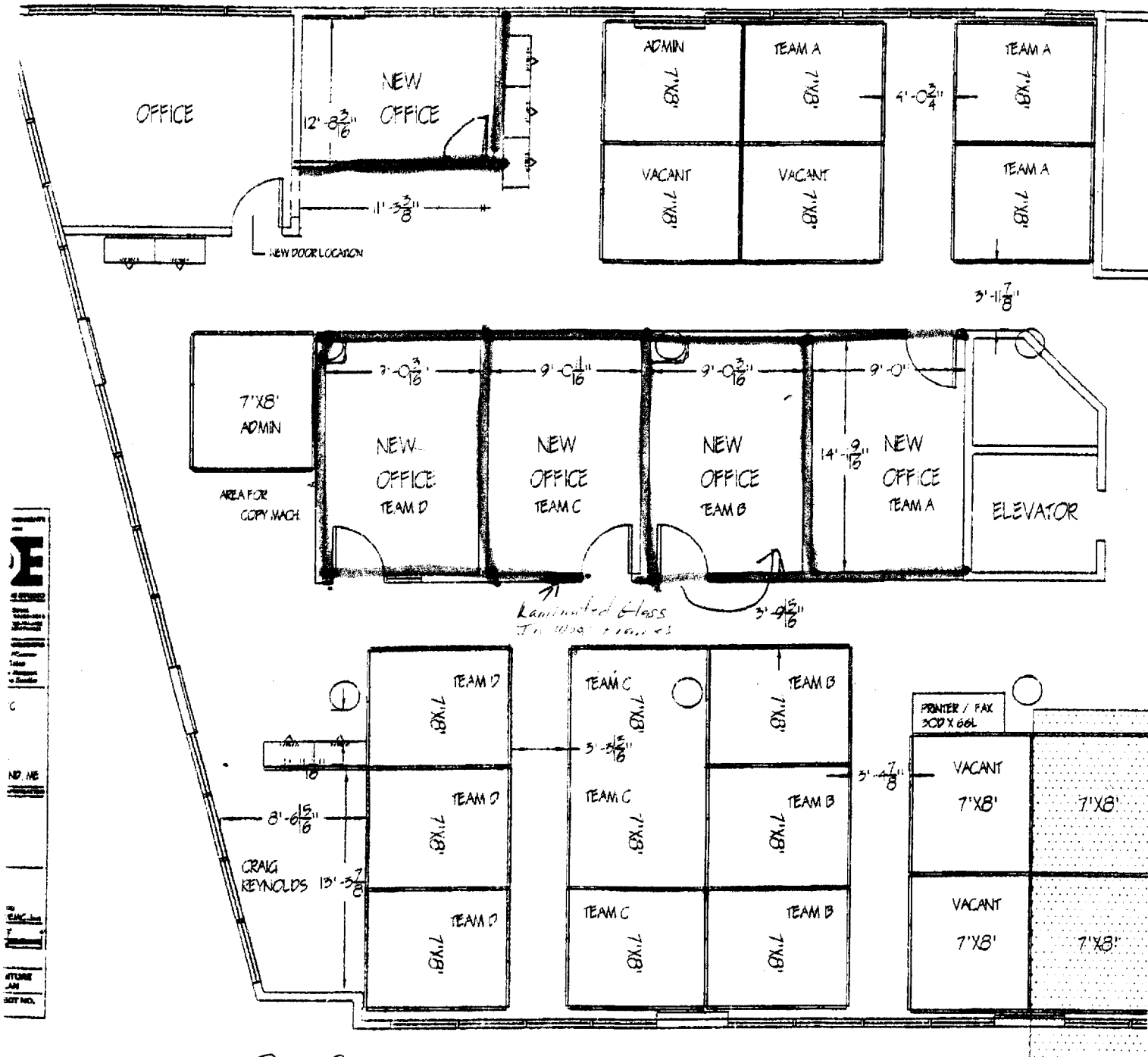

NO. 16
CRAIG REYNOLDS
ATTORNEY
AND
SAY NO.

5th floor per other plans

0 1361

All Purpose Building Permit Application

If you or the property owner owes real estate or personal property taxes or user charges on any property within the City, payment arrangements must be made before permits of any kind are accepted.

Location/Address of Construction: <u>261 Commercial St Portland ME</u>		
Total Square Footage of Proposed Structure <u>637</u>	Square Footage of Lot <u>50 ft</u>	
Tax Assessor's Chart, Block & Lot Chart# <u>38</u> Block# <u>2</u> Lot# <u>9</u>	Owner: <u>Docta - P.O. Box 3572, Ant</u>	Telephone: <u>722 0000</u>
Lessee/Buyer's Name (If Applicable) <u>Maine Employees Mutual</u>	Applicant name, address & telephone: <u>David Yellison 6 Mary Oaks Ln.</u>	cost Of Work: \$ <u>20,000</u> Fee: \$ <u>144 -</u>
<u>Office space</u>		
Project description: <u>ADD 5 OFFICES TO VACANT SPACE</u>		
Contractor's name, address & telephone: <u>David E. Yellison / Yellison Construction 6 Mary Oaks Ln Windham ME 04062</u>		
Who should we contact when the permit is ready: _____		
Mailing address: <u>MAIL when ready</u> Phone: <u>890-9823</u> <u>870-9392</u>		

IF THE REQUIRED INFORMATION IS NOT INCLUDED IN THE SUBMISSIONS THE PERMIT WILL BE AUTOMATICALLY DENIED AT THE DISCRETION OF THE BUILDING/PLANNING DEPARTMENT, WE MAY REQUIRE ADDITIONAL INFORMATION IN ORDER TO APPROVE THIS PERMIT.

I hereby certify that I am the Owner of record of the named property, or that the owner of record authorizes the proposed work and that I have been authorized by the owner to make this application as his/her authorized agent. I agree to conform to all applicable laws of this jurisdiction. In addition, if a permit for work described in this application is issued, I certify that the Code Official's authorized representative shall have the authority to enter all areas covered by this permit at any reasonable hour to enforce the provisions of the codes applicable to this permit.

Signature of applicant: <u>[Signature]</u>	Date: <u>11-2-01</u>
--	----------------------

This is not a permit, you may not commence ANY work until the permit is issued
NOV - 2001

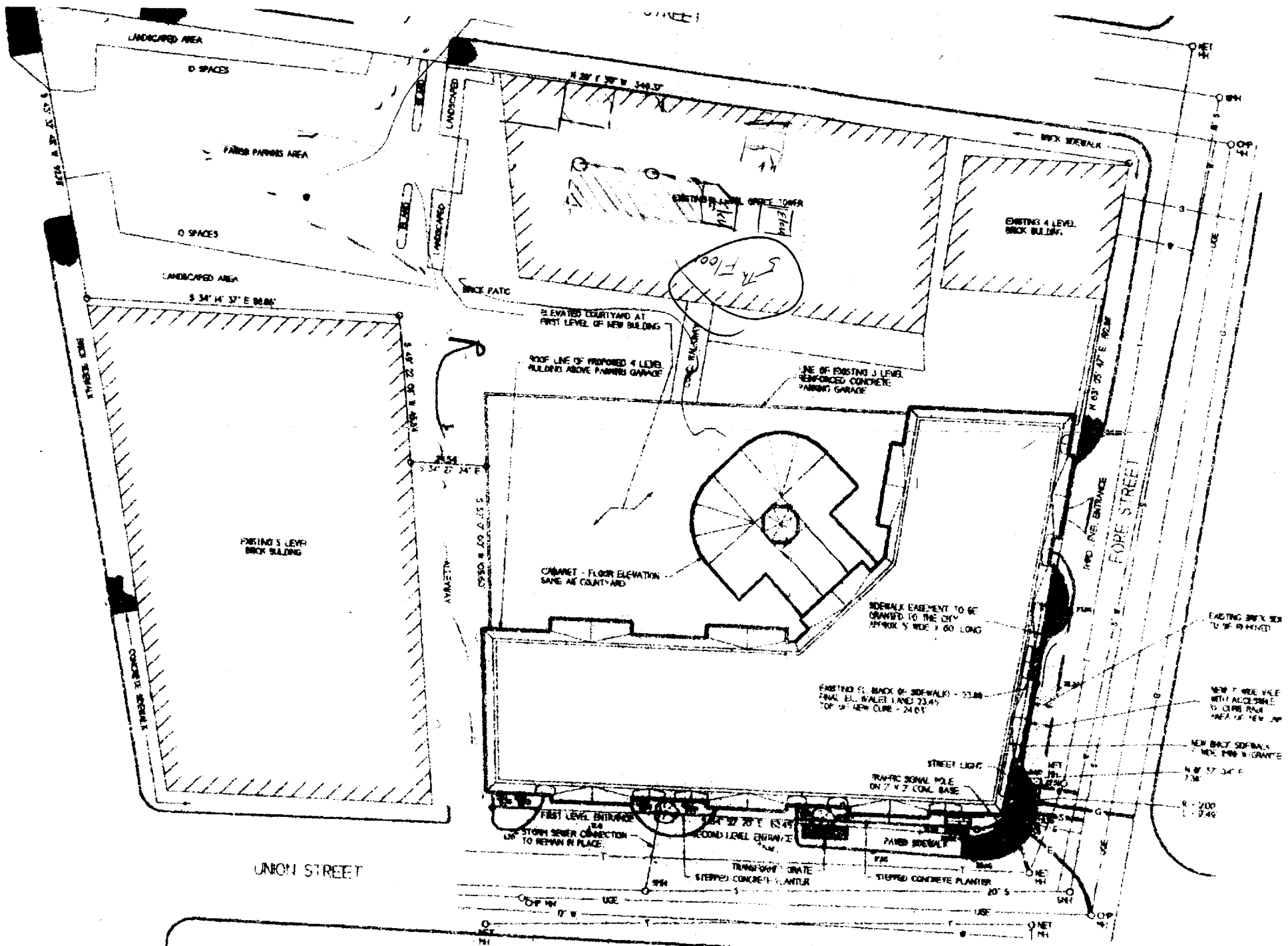

GRAPHIC SCALE