

GENERAL NOTES

1. PREPARE SUBSTRATES FOR NEW GRANITE STEPS AS INDICATED AND AS REQUIRED BY MANUFACTURER.
2. INSTALL A SINGLE COMPLETE RUN OF STEPS AT ONE LOCATION BEFORE MOVING ON TO THE SECOND LOCATION FOR EACH OF THE FIRST FLOOR TENANTS (MUSE & SALT EXCHANGE).
3. PHASE WORK AS INDICATED, MAINTAIN PUBLIC ACCESS AT EXISTING SIDEWALK AT ALL TIMES.

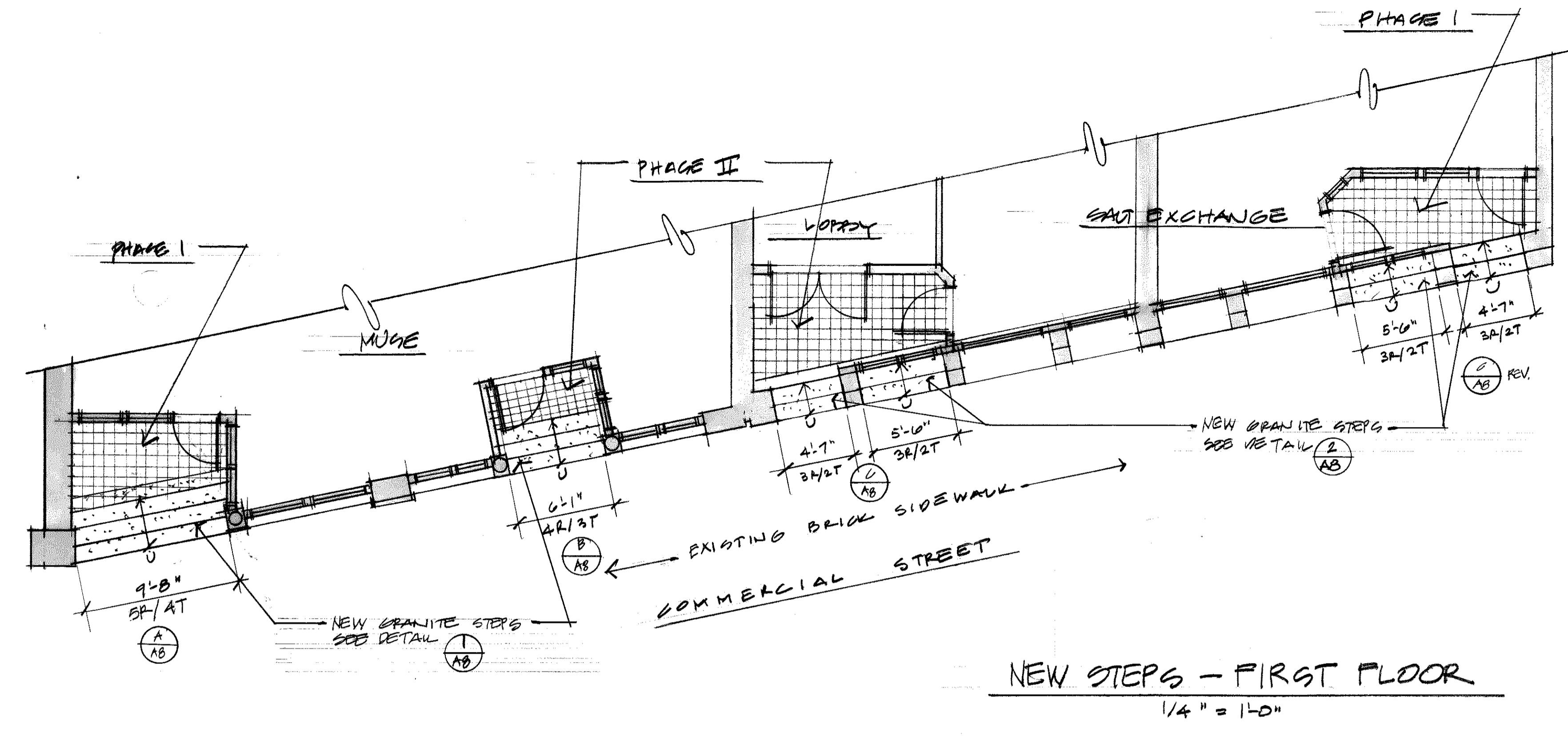

NEW STEPS - FIRST FLOOR
1/4" = 1'-0"

DEMOLITION NOTES

1. REMOVE EXISTING STAIRS AS INDICATED, REMOVE ANY EXISTING SUPPORTS / HARDWARE BACK TO EXISTING CRANITE / CONCRETE / STONE FOUNDATIONS.
2. PREPARE EXISTING STAIR AREA WAY FOR NEW GRANITE STEPS.
3. PROTECT EXISTING BRICK SIDEWALK DURING ALL WORK.
4. DISPOSE OF REMOVALS IN ACCORDANCE WITH ALL APPLICABLE CODES, LAWS, AND ORDINANCES.
5. MAINTAIN PUBLIC ACCESS TO EXISTING SIDEWALK THROUGHOUT DURATION OF WORK.
6. MAINTAIN ONE ACTIVE ENTRANCE FOR EACH FIRST FLOOR TENANT (MUSE & SALT EXCHANGE) AT ALL TIMES.
7. PHASE WORK AS INDICATED.

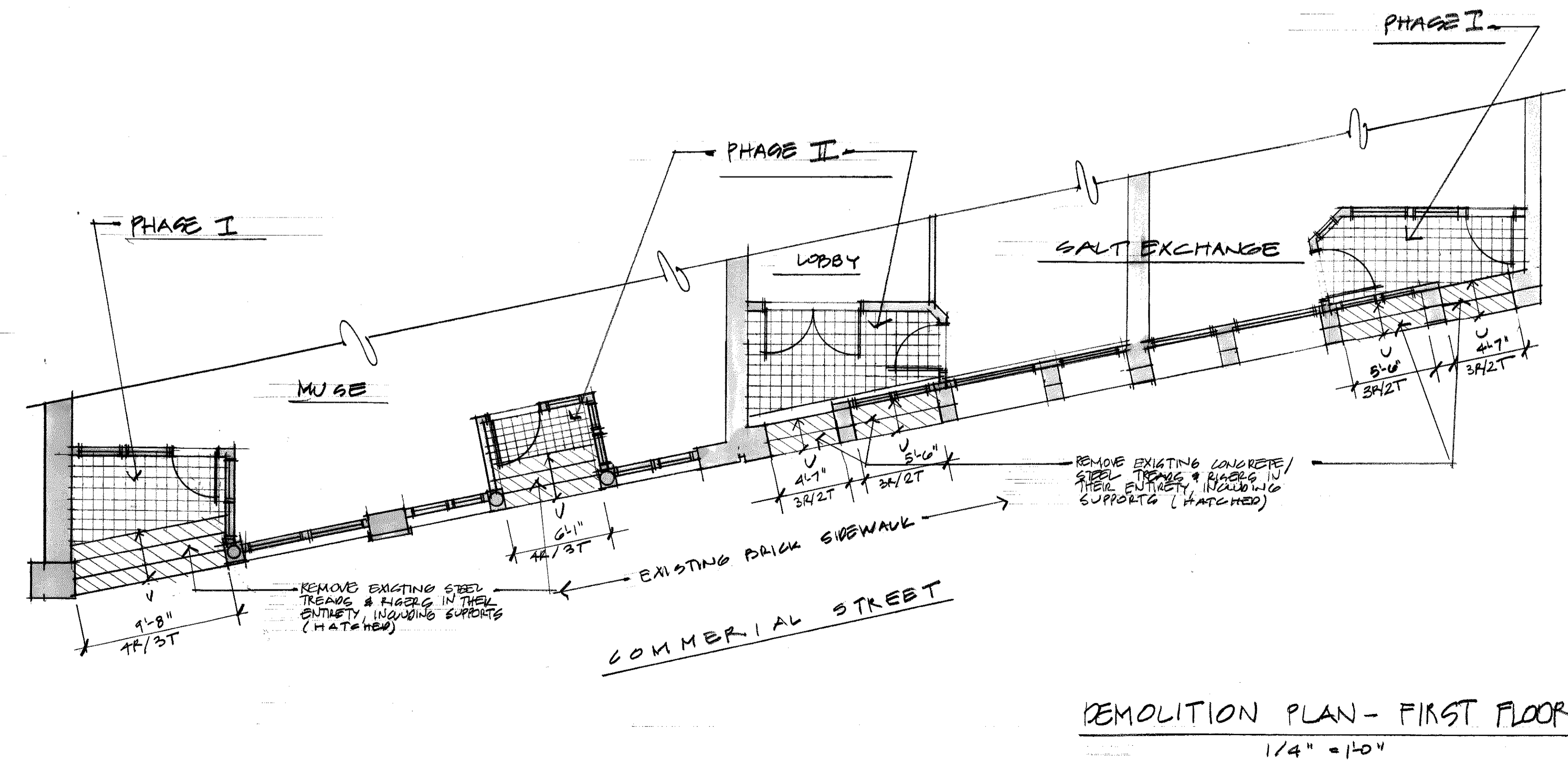

DEMOLITION PLAN - FIRST FLOOR
1/4" = 1'-0"