

(TYPICAL)  
COORDINATE POWER, AV AND DATA  
LOCATIONS WITH FURNITURE VENDOR  
AND OWNER PRIOR TO ROUGH-IN

COORDINATE POWER  
LOCATIONS WITH OWNER  
PRIOR TO ROUGH-IN

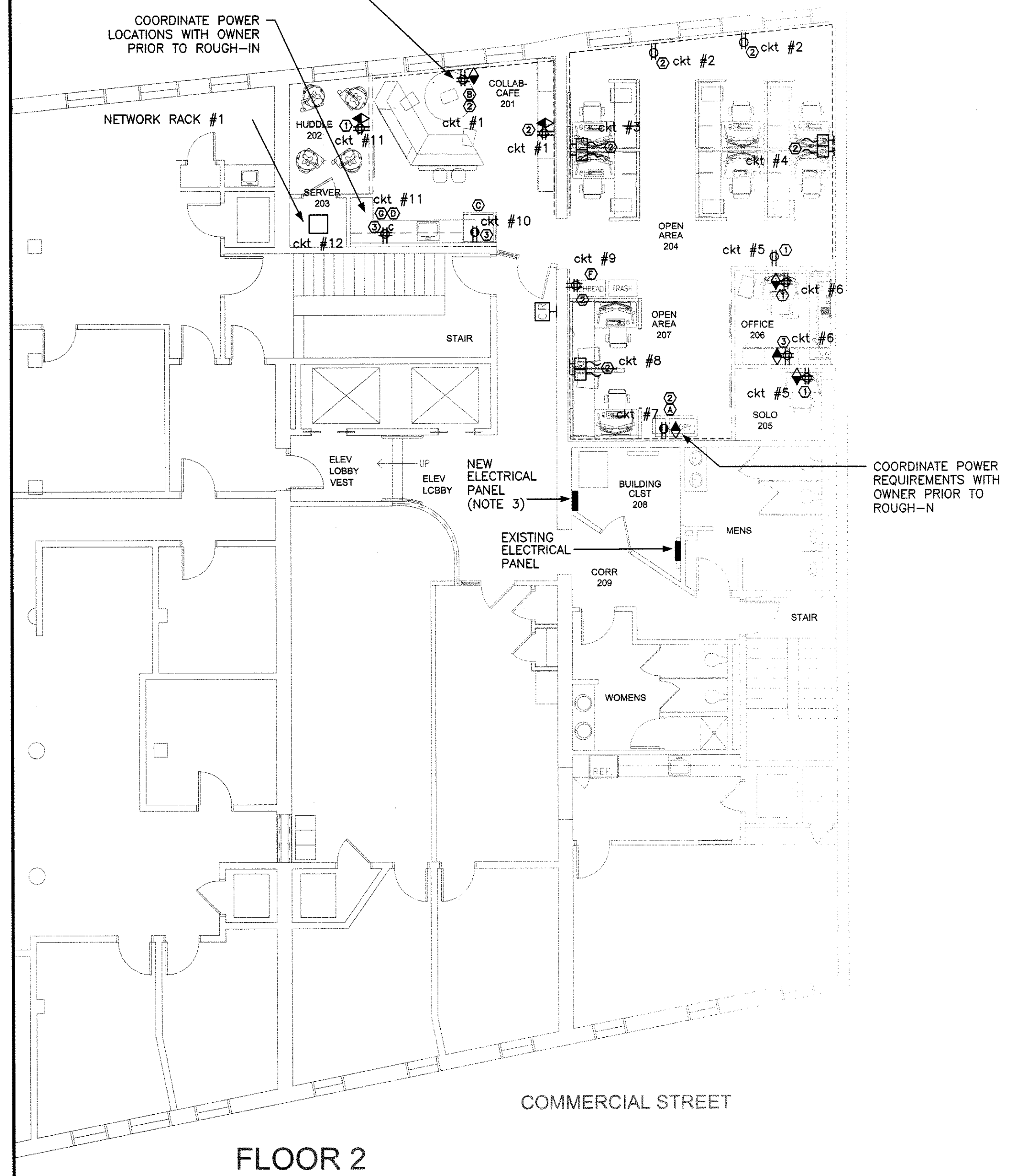

FLOOR 2

COORDINATE POWER  
REQUIREMENTS WITH  
OWNER PRIOR TO  
ROUGH-IN

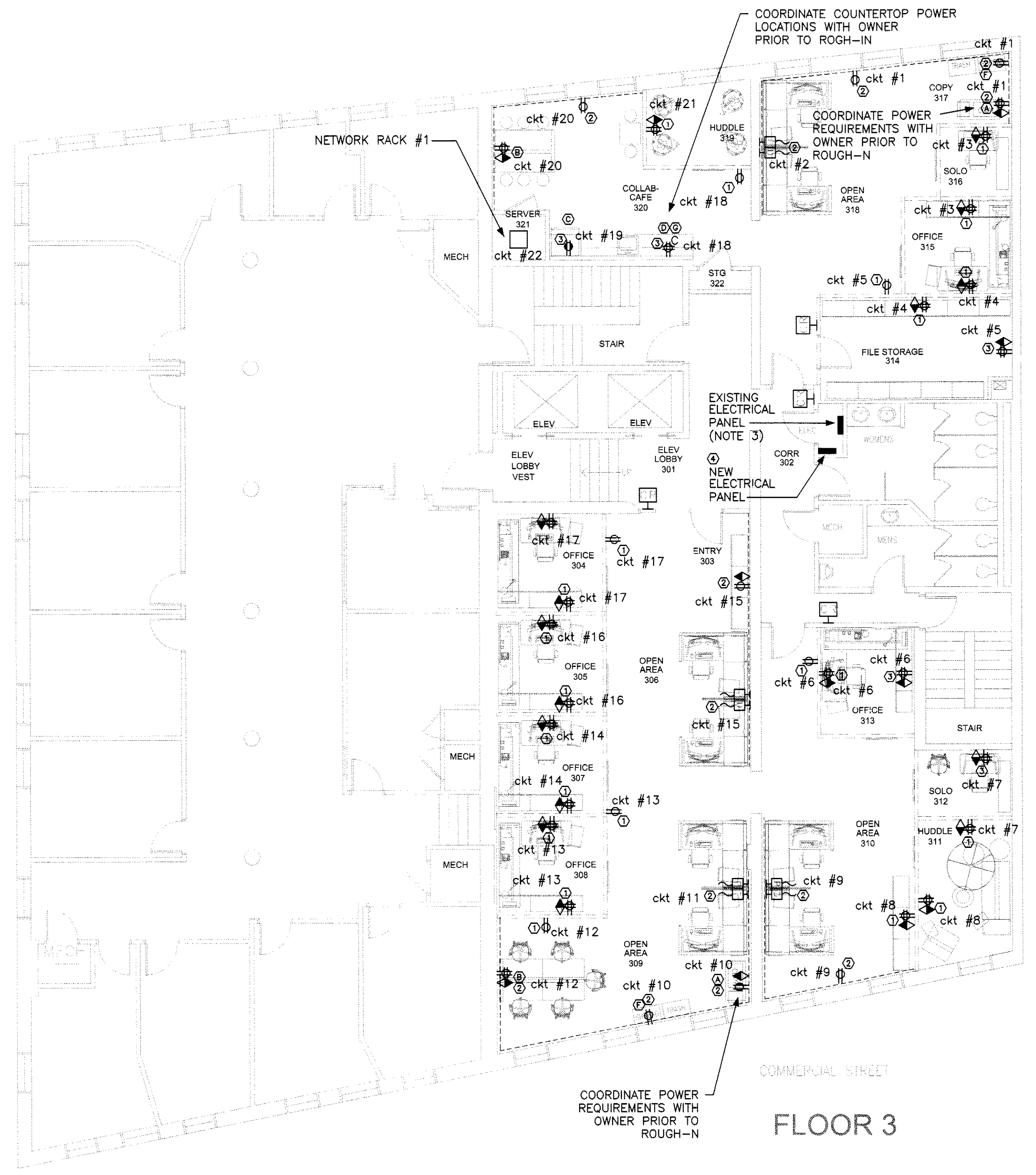

FLOOR 3

COORDINATE POWER  
REQUIREMENTS WITH  
OWNER PRIOR TO  
ROUGH-IN

**ELECTRIC/NETWORK NOTES:**

- SEE SHEET A-3 FOR ADDITIONAL ELECTRICAL/NETWORK NOTES.
- CIRCUIT NUMBERS REFER TO THE NEW PANELS BEING PROVIDED (SEE NOTE 3).
- ON THE SECOND AND THIRD FLOORS, PROVIDE A SQUARE D, SERIES NGOD PANEL (OR EQUAL). THE PANELS SHALL BE RATED 120/208 VOLTS, 3-PHASE, 100A. PROVIDE 20A/1P BRANCH CIRCUIT BREAKERS FOR THE RECEPTACLE CIRCUITS SHOWN. IN THE SECOND FLOOR NEW PANEL PROVIDE A 30A/1P CIRCUIT BREAKER FOR THE ERV, A 45A/2P CIRCUIT BREAKER FOR THE PHC, AND A 45A/2P CIRCUIT BREAKER FOR THE EDC. PROVIDE A 100A/3P CIRCUIT BREAKER IN THE ADJACENT EXISTING PANEL ON EACH FLOOR WITH A FEEDER FOR THE NEW PANEL CONSISTING OF 4 #2, 1 #8 GND, IN A 2" CONDUIT.
- COORDINATE THE EXACT LOCATION OF ALL OUTLETS WITH THE OWNER PRIOR TO ROUGH-IN.
- CONCEAL WIRING ABOVE SUSPENDED CEILINGS AND WITHIN PARTITIONS WHERE POSSIBLE. WHERE SURFACE WIRING IS NECESSARY, PROVIDE SURFACE METAL RACEWAY. REVIEW ROUTING OF ALL SURFACE WIRING WITH ARCHITECT PRIOR TO INSTALLATION.
- EXTEND EXISTING FIRE ALARM SYSTEM WITH COMPATIBLE DEVICES AND WIRING.
- EXTEND CAT6 CABLE FROM ALL SECOND FLOOR NETWORK OUTLETS TO EQUIPMENT RACK #2. EXTEND CAT6 CABLE FROM ALL THIRD FLOOR NETWORK OUTLETS TO EQUIPMENT RACK #1. DO NOT SPLICE UTP CABLE. EXTEND A 12-STRAND MULTI-MODE FIBER OPTIC BACKBONE BETWEEN RACKS.
- PROVIDE 120 VOLT, 20A CIRCUITS AS REQUIRED FOR ELECTRIC DOOR LOCKS.
- COORDINATE THE EXACT LOCATION FOR WORKSTATION AND PARTITION ELECTRICAL FEED CABLES WITH SUPPLIER PRIOR TO ROUGH-IN.

**ELECTRIC/NETWORK LEGEND:**

- WALL MOUNTED FIRE ALARM AUDIO-VISUAL NOTIFICATION APPLIANCE MOUNTED 80" A.F.F.
- WALL MOUNTED DUPLEX ELECTRICAL OUTLET MOUNTED 18" A.F.F. (U.O.N.)
- WALL MOUNTED DUPLEX ELECTRICAL OUTLET MOUNTED 8" ABOVE COUNTER (U.O.N.)
- WALL MOUNTED QUADRAPLEX ELECTRICAL OUTLET MOUNTED 18" A.F.F. (U.O.N.)
- WALL MOUNTED DEDICATED CIRCUIT ELECTRICAL OUTLET MOUNTED 18" A.F.F. (U.O.N.)
- WALL MOUNTED TELEPHONE/DATA LOCATION: G.C. SHALL PROVIDE SINGLE GANG COVER PLATE. COORDINATE WITH OWNER DATA VENDOR FOR REQUIREMENTS AT EACH LOCATION
- WALL MOUNTED TELEPHONE/DATA LOCATION MOUNTED 8" ABOVE COUNTER (U.O.N.): G.C. SHALL PROVIDE SINGLE GANG COVER PLATE.
- INDICATES WALL MOUNTED FURNITURE INFEEED LOCATION OF POWER AND TELECOMMUNICATION CABLING FOR POWERED WORKSTATIONS, SEE PLAN FOR LOCATIONS AND ENGINEERING FOR SPECS. THE G.C. SHALL COORDINATE WITH FURNITURE VENDOR FOR ALL REQUIREMENTS.
- WALL MOUNTED CARD READER (42" AFF). SECURITY VENDOR
- EXIT BUTTON FOR DOOR RELEASE
- EXIT BUTTON FOR DOOR RELEASE
- MOTION SENSOR FOR DOOR RELEASE
- INDICATES SURFACE MOUNTED G-MOLD. (COORDINATE MOUNTING HEIGHT IN-FIELD) SEE ENGINEER'S DWGS FOR MORE INFORMATION.

**EQUIPMENT LIST:**

- Ⓐ COPY MACHINE OR PRINTER (N.I.C.) - PROVIDE POWER/DATA
- Ⓑ FLAT SCREEN TV (N.I.C.) - G.C. TO PROVIDE IN-WALL FIRE-RATED BLOCKING & POWER/DATA
- Ⓒ REFRIGERATOR-DEDICATED POWER. G.C. TO COORDINATE DOOR SWING CLEARANCES AND DIMENSIONS WITH MILLWORK. PROVIDE FILTERED WATER LINE TO WATER/ICE. KitchenAid Model # KSFZ2C4CY Architect Series II 22.0 cu. ft. Side-by-Side Refrigerator in Stainless Steel
- Ⓓ COUNTERTOP MICROWAVE. G.C. TO COORDINATE POWER AND SIZE REQUIREMENTS WITH MILLWORK. KitchenAid Model # KCMS1655BSS Architect Series II 1.6 cu. ft. Countertop Microwave in Stainless Steel Built-In Capable with Sensor Cooking
- Ⓔ UNDER MOUNT ADA SINGLE BOWL SINK AND FAUCET SEE ENGINEER'S DRAWINGS FOR MORE SPECIFICATIONS (PROVIDE WITH ALL NECESSARY ACCESSORIES). Elkoy Gourmet (Lustertone) Stainless Steel Single Bowl Undermount Sink ELUHA0211545 Elkoy Allure Kitchen Faucet LK792155S
- Ⓕ POWER FOR SHREDDER MACHINE. (n.i.c.)
- Ⓖ POWER AND WATER LINE FOR COFFEE MAKER. G.C. COORDINATE WITH WATER FILTRATION VENDOR ON INSTALL

**PLAN NOTATION:**

- ① INDICATES POWER AND DATA RUN THROUGH A FURNITURE WALL. G.C. TO COORDINATE WITH FURNITURE VENDOR FOR REQUIREMENTS
- ② INDICATES POWER AND DATA TO BE RUN THROUGH SURFACE MOUNTED WIREMOLD. PRODUCT TO BE SPECIFIED BY TENANT. ATTACH TO EXPOSED BRICK WALL AS NECESSARY.
- ③ INDICATES POWER AND DATA TO BE RUN THROUGH EXISTING CONSTRUCTION WALL.

**Bartlett Design**  
LIGHTING & ELECTRICAL ENGINEERING  
845 WASHINGTON STREET, SUITE 300  
PORTLAND, ME 04101  
TEL (207) 443-8447 FAX (207) 448-8080

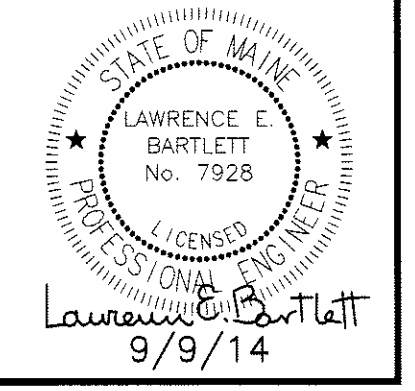

**MEMIC**  
245 COMMERCIAL STREET  
FLOOR 2 & FLOOR 3  
PORTLAND, ME 04101

REVISION NO.	DATE

**ELECTRICAL PLANS**  
SCALE: 1/8"=1'-0"  
DATE: 9.8.2014  
DRWN: JC  
CHK: LEB

DRAWING NO.  
**E-1**