

CITY OF PORTLAND ELECTRONIC STAMP:

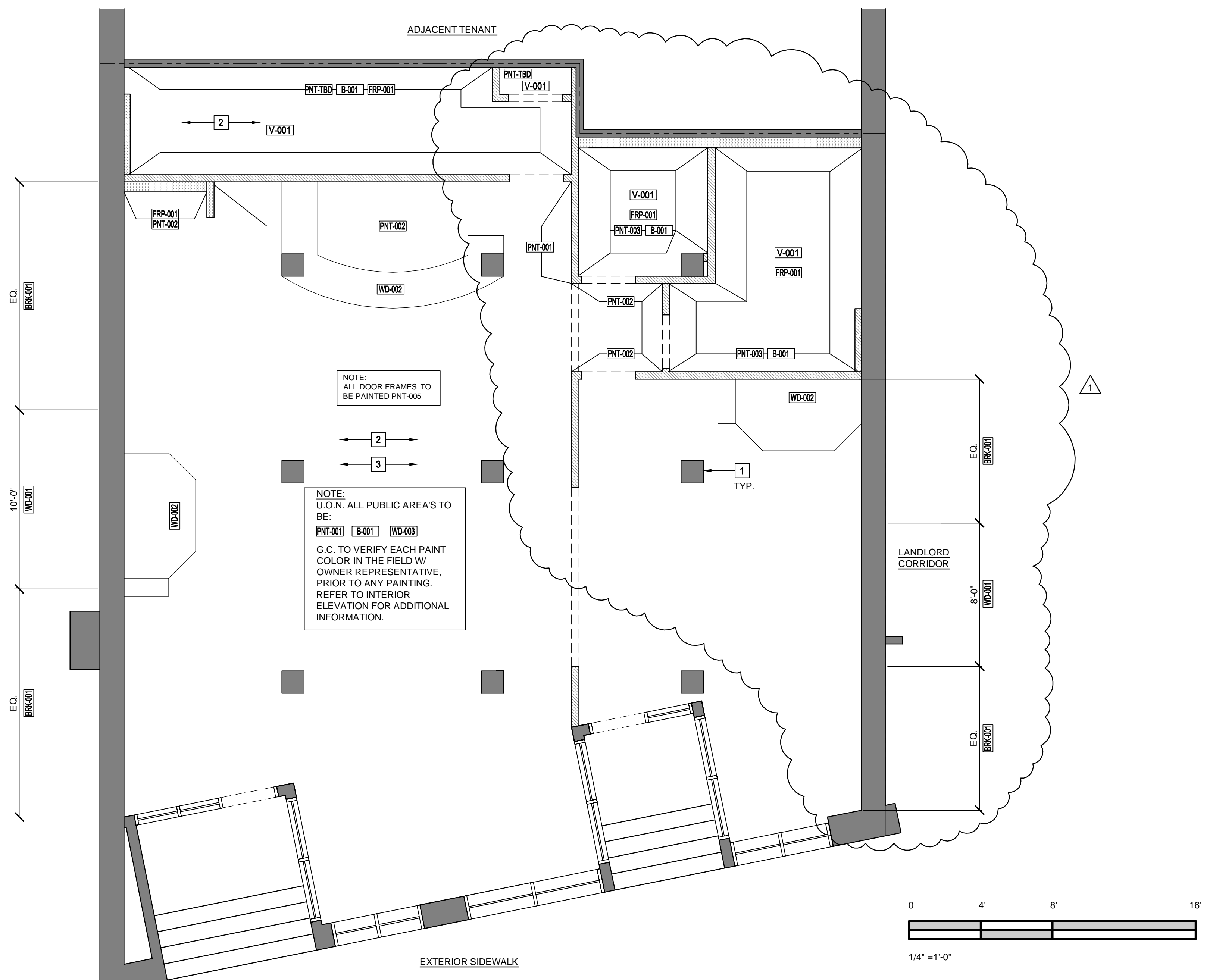

- ALL EXISTING COLUMN ENCLOSURES TO BE **PNT-001** U.O.N. AND GC TO SUPPLY & INSTALL WD. MOULDING PER DIRECTION OF TENANT REPRESENTATIVE **PNT-006**
- GC TO SAVE AND STORE ANY WD. FLOORING REMOVED FOR FUTURE USE.
- GC TO PROTECT EXISTING WD. FLOORING TO REMAIN DURING CONSTRUCTION.

FINISH CODED NOTES

CLIENT:

 255 MASSACHUSETTS AVENUE #801
 BOSTON, MA 02115
 PHONE: (617) 421-6500
 WEBSITE: <http://musepaintbar.com/>

ARCHITECT:

 phase zero
 design
 EIGHT WILCOX STREET
 SHELTON, CONNECTICUT 06070
 PHONE: (860) 264-1624
 FAX: (860) 264-1628
 WEBSITE: www.phasezerodesign.com

MEP CONSULTANT:
 OWNER:

MUSE PAINTBAR
 245 COMMERCIAL STREET
 PORTLAND, ME 04101

MUSE PAINTBAR
 245 COMMERCIAL STREET
 PORTLAND, ME 04101

REV#	DATE	COMMENTS
1	03.05.2014	BUILDING DEPT COMMENTS

1 FINISH PLAN
 SCALE: 1/4"=1'-0"

KEY	PRIMARY LOCATIONS	MFR	MATERIAL	FINISH	NOTES
B-001	MAIN FLOOR BASE	JOHNSONITE	4" RUBBER BASE	BLACK	
BRK-001	SEE PLAN	METRO BRICK	METRO BRICK FLATS	#310 "MAINSTREET" VELOUR FINISH	SOURCED THROUGH "AMERICAN BRICK COMPANY"
FRP-001	SCULLERY SINK, KITCHEN, & RESTROOMS	MARLITE	FRP	PAINT - TBD	UP TO 4'-0" A.F.F.
PNT-001	WALLS	BEHR	PAINT	BLUE SPELL	
PNT-002	WALLS	BEHR	PAINT	MEXICAN CHILE	EGGSHELL PAINT
PNT-003	RESTROOM WALLS / CEILING	BEHR	PAINT	AMAZON STONE	EGGSHELL PAINT
PNT-004	TBD	BEHR	PAINT	CAYMAN BAY	EGGSHELL PAINT
PNT-005	DOOR TRIM	BEHR	PAINT	BLACK	SEMI-GLOSS
PNT-006	MOULDING	BEHR	PAINT	WHITE	SEMI-GLOSS
V-001	KITCHEN & RESTROOMS	ARMSTRONG	VINYL SHEET FLOORING	WHITECLIFFS - 88702	

KEY	PRIMARY LOCATIONS	MFR	MATERIAL	FINISH	NOTES
WD-001	SEE PLAN AND INTERIOR ELEVATIONS	CUSTOM	BARN WOOD SIDING		SUPPLIED BY TENANT. G.C. TO SUPPLY & APPLY TO WOOD BOARD SIDING "FLAME STOP II" WATER-BASED, POST-TREATMENT INTERIOR/EXTERIOR FIRE RETARDANT, MUST CONFORM WITH A CLASS C INTERIOR FINISH RATING
WD-002	STAGES AND BAR	STONE SOURCE	WOOD	TOBACCO PINE	
WD-003	ALL PUBLIC AREA'S	EXISTING	WOOD	WD. STAIN (TBD)	IN PRIVATE AREAS WHERE WD. FLOORING IS BEING REMOVED IN PLACE OF A DIFFERENT FLOORING FINISH. GC TO SAVE WD. FLOORING FOR FUTURE USE OR PATCHING AND REPAIRING IN PUBLIC AREAS

GENERAL NOTES

- NO MATERIAL SUBSTITUTIONS TO BE MADE WITHOUT PRIOR WRITTEN APPROVAL FROM PROJECT MANAGER OR THE ARCHITECT.
- WIPE CLEAN ALL SURFACES WITH DAMP CLOTH.
- EACH SUB CONTRACTOR IS RESPONSIBLE FOR PROVIDING PROPER PROTECTION AGAINST DAMAGE TO FIXTURES, FURNITURE, ADJACENT FINISHED WORK, FLOORING, ETC. FROM HIS OWN WORK.
- RETOUCH OR REFINISH SURFACES DAMAGED BY SUBSEQUENT WORK AS DIRECTED BY G.C. THE COST OF SUCH RESTORATION WORK SHALL BE BORNE BY SUB CONTRACTOR.
- THE GC SHALL BE RESPONSIBLE FOR THE MAINTENANCE OF ALL THE FINISHES IN THE STORE. WALLS, FLOOR AND CEILING PRIOR TO TURNOVER. G.C. SHALL TOUCH UP ALL CORNER BEADS, WALLS, CEILING AND FLOORING AS REQUIRED PRIOR TO TURNOVER AND ANY DAMAGE CAUSED BY OTHER TRADES INCLUDING MILLWORKER.
- EXAMINE ALL SURFACES TO BE PAINTED UNDER THIS CONTRACT TO VERIFY THAT WORK OF OTHER TRADES IS IN SATISFACTORY CONDITION TO RECEIVE SPECIFIED FINISH.
- GC SHALL CAULK BETWEEN MILLWORK AND GYPSUM BOARD WALLS IF REQUIRED TO CREATE A SMOOTH FINISH.
- GYPSUM WALL BOARD SURFACES SHALL BE WIPED WITH A DAMP CLOTH JUST PRIOR TO APPLICATION OF THE FIRST COAT OF PAINT IN ORDER TO LAY FLAT ANY NAP WHICH MAY HAVE FORMED IN SANDING.
- PAINTING SUBCONTRACTOR IS RESPONSIBLE FOR THE PROTECTION OR REMOVAL & REINSTALLATION OF HARDWARE, SWITCH/OUTLET COVERS, ETC. TO PROTECT FROM PAINTING.
- ALL PAINTED SURFACES TO RECEIVE (1) COAT PRIMER & (2) COATS FINISH PAINT (MINIMUM) WITH ADDITIONAL COATS AS REQUIRED FOR PROPER COVERAGE.
- AT COMPLETION OF PAINTING, ALL PAINT MATERIALS & EQUIPMENT SHALL BE REMOVED, ALL PAINT SPOTS REMOVED AND ALL AREAS THOROUGHLY CLEANED. ANY DIRT OR DEBRIS CAUSED BY WORK SHALL BE CLEANED UP AS WORK PROGRESSES.
- ALL FLOORING SUBCONTRACTORS SHALL HAVE A MINIMUM OF FIVE YEARS EXPERIENCE WORKING WITH RESPECTIVE FLOORING MATERIAL.
- ALL FINISHED FLOORING TO BE PROTECTED BY G.C. FOLLOWING INSTALLATION.
- REFER TO INTERIOR ELEVATIONS SHEETS A200 FOR DETAILED WALL FINISH INFORMATION.

ISSUE DATE: 01.20.2014
 SCALE: AS NOTED

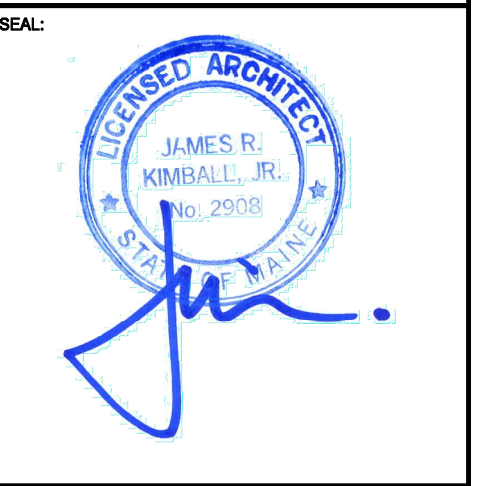

PROJECT NUMBER: 1113158
 DRAWN BY: LAH
 CHECKED BY: MSG
 Copyright (c) by Phase Zero Design Corp.
 All Rights Reserved.

SHEET TITLE:
FINISH PLAN

SHEET NUMBER:
A104