

NOTES:

- TYPE "A" BACKING FOR MISC. ITEMS, IE SURFACE MTD. MIRRORS, WASTE RECEPTACLES, TOWEL DISPENSERS, ETC. MAXIMUM WEIGHT - 50 LBS.
- TYPE "B" BACKING PLATES FOR UPPER WALL HUNG CABINETS (UP TO 2 SHELVES) BASE CABINETS, FULL HEIGHT CABINETS, HANDRAILS, GUARDRAILS, GRAB BARS, WALL HUNG EQUIPMENT, ETC. MAXIMUM WEIGHT - 100 LBS./FT.
- SEE TYPICAL WALL FRAMING FOR GAUGE OF STUDS, VERIFY LENGTH, HEIGHT, LOCATION OF BACKING PLATE, AND NUMBER.
- RECD WITH ACCESSORY MANUFACTURERS. USE #12 SELF TAPPING SHEET METAL SCREWS WHEN ATTACHING ITEMS TO BACKING PLATE.
- WALL STUD FLANGES ARE CONTINUOUS AT BACKING PLATE.

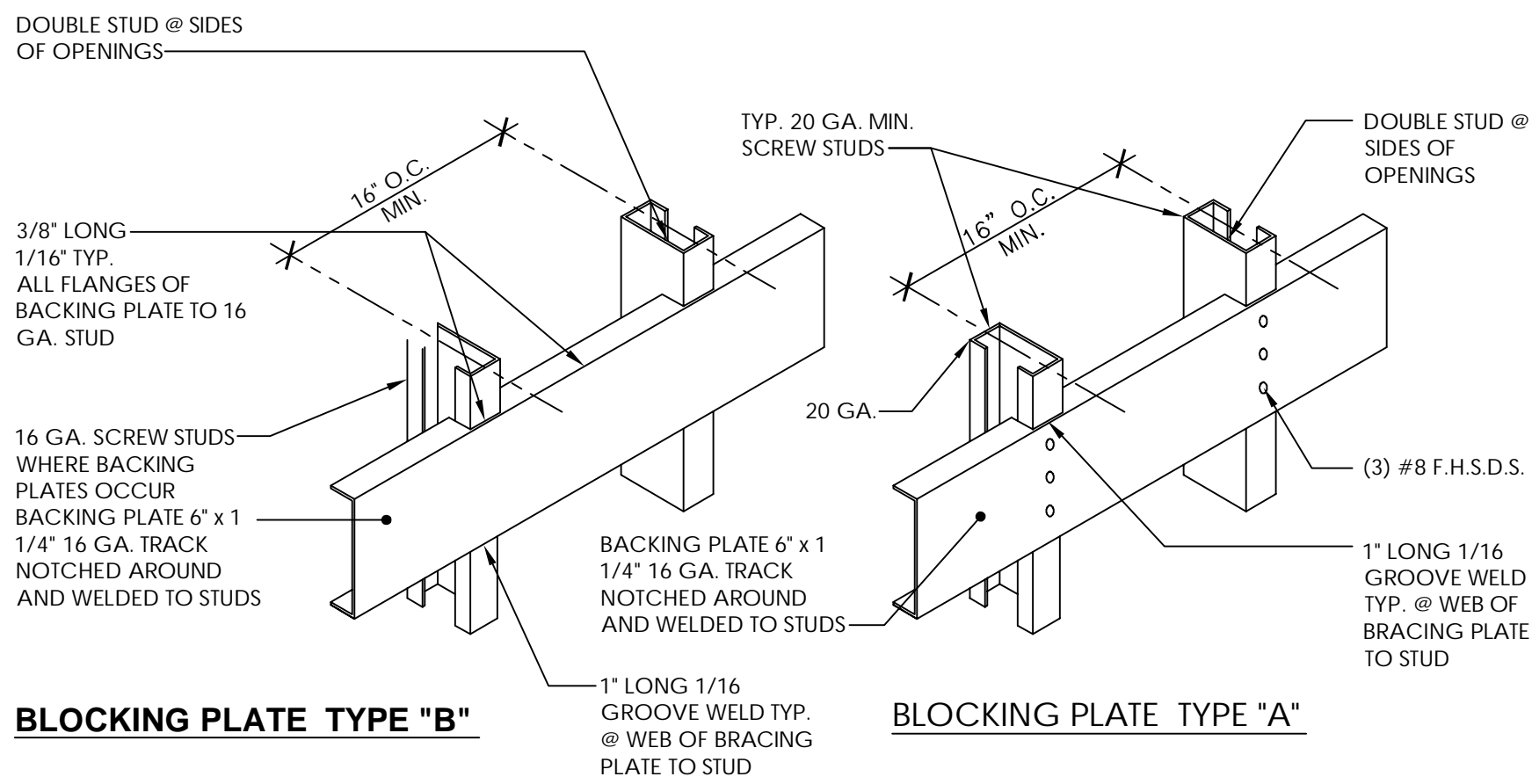
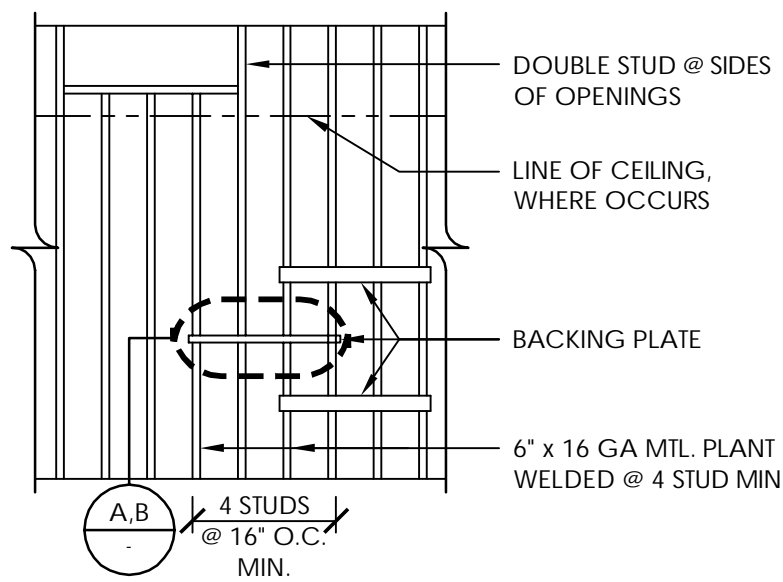

BLOCKING PLATE TYPE "B"

BLOCKING PLATE TYPE "A"

STUD GA. LIMITING HT. SCHEDULE

- A. TABLE BELOW IS BASED ON UNIVERSAL INDUSTRIES, UNIMAST (USG) CORPORATION'S LIMITING HEIGHT TABLES FOR UNBRACED STUDS SPACED 16" AND 24" O.C. (SYSTEM FOLDER SA-923-1990 EDITION). REQUIREMENT FOR 5 PSF LATERAL PRESSURE AND 1/240 ALLOWABLE DEFLECTION FOR FLEXIBLE FINISHES, WITH 1 LAYER OF GYP. BD. PER SIDE OF STUD.
- B. SCHEDULED HEIGHTS MAY BE INCREASED BY 50% WHERE THE STUDS ARE DIAGONALLY BRACED AT THE MAXIMUM HEIGHT POINT TO THE STRUCTURE ABOVE @ 4'-0" O.C.
- C. CAUTION! WHEN USING STUDS MANUFACTURED BY A COMPANY OTHER THEN USG, VERIFY MANUFACTURERS STUD STRENGTH AND LIMITING HEIGHT. ADJUST GAUGE AND MAXIMUM HEIGHT RECOMMENDED BY MANUFACTURERS CURRENT PRINTED SPECIFICATION.

Stud Width	Stud Type	Gauge			Stud Spacing	Maximum Height
		Stud	Bottom Track	Top Track		
1-5/8"	158ST25	25	18	18	16"	9'-6"
		25	18	18	24"	7'-3"
2-1/2"	212ST20	20	18	18	16"	14'-0"
		20	18	18	24"	12'-3"
3-5/8"	358ST20	20	18	18	16"	18'-3"
		20	18	18	24"	16'-0"
6"	600ST20	20	18	18	16"	26'-6"
		20	18	18	24"	23'-3"

6 MANEUVERING CLEARANCE @ HI/LO DRINKING FOUNTAIN
SCALE: 1/2"=1'-0"

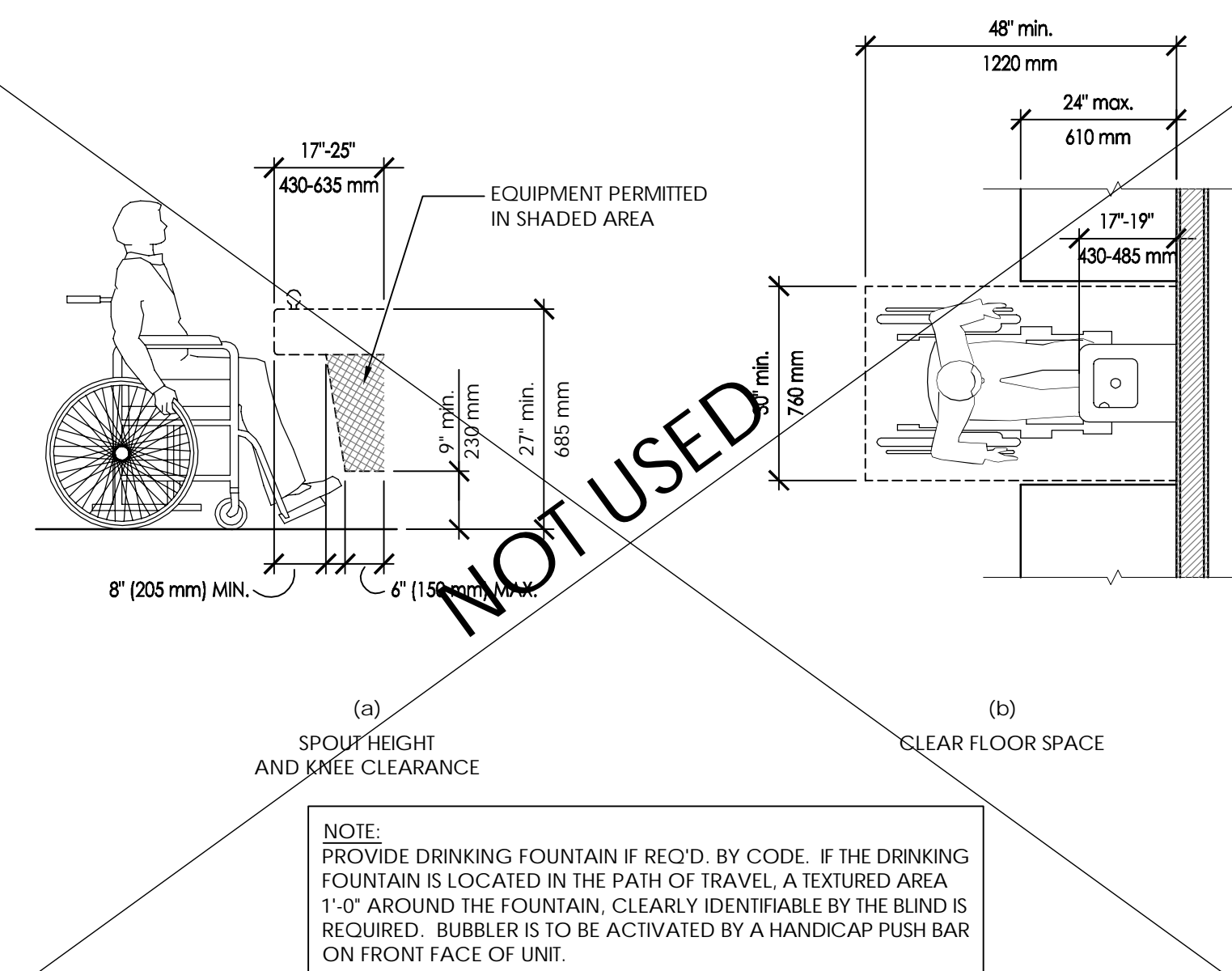

5 MANEUVERING CLEARANCE @ DRINKING FOUNTAIN
SCALE: 1/2"=1'-0"

3 DRAWING TUBE DETAIL
SCALE: 3"=1'-0"

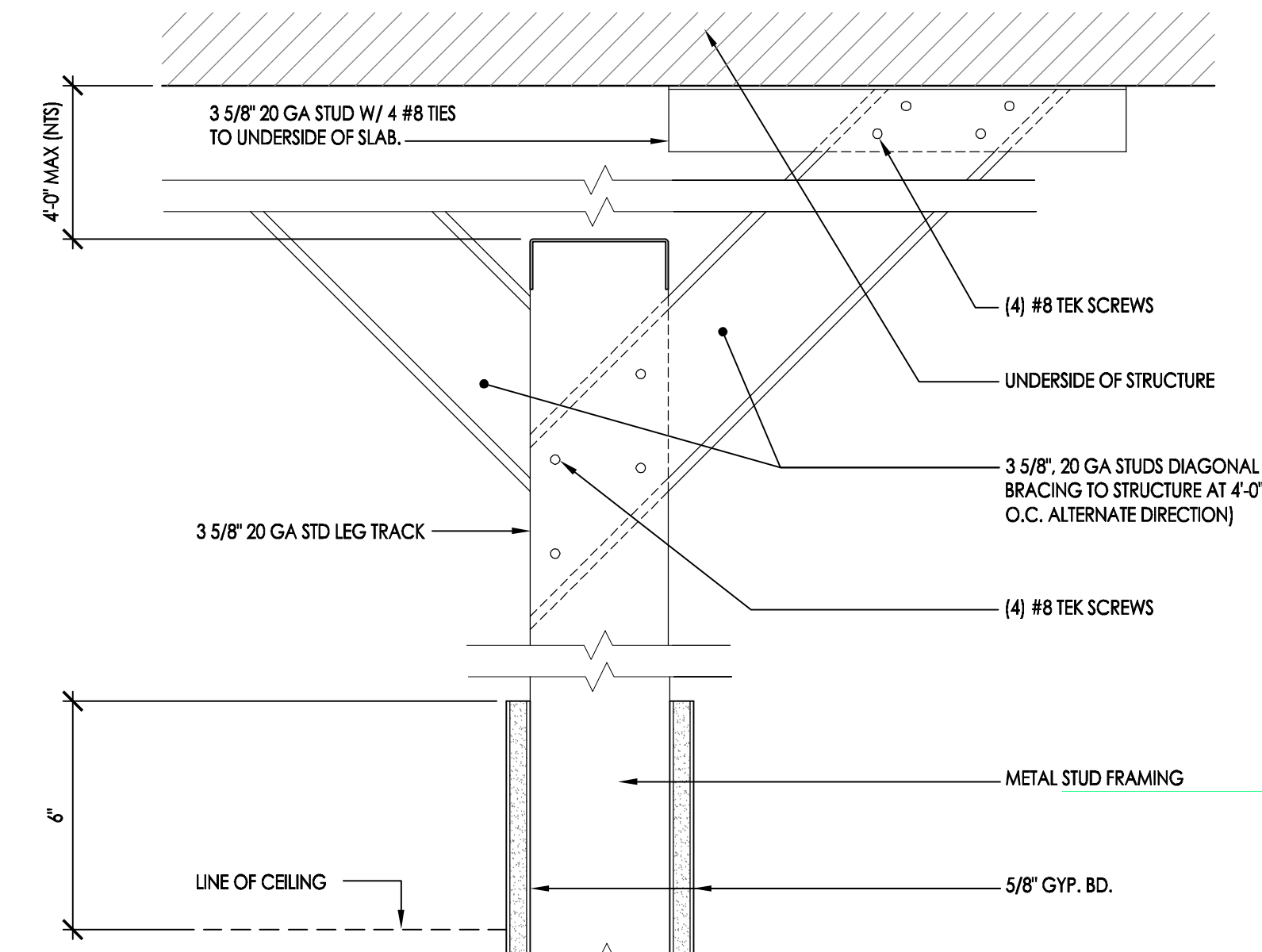

2 PARTITION BRACING DETAIL
SCALE: 3"=1'-0"

9 METAL FRAMING BACKING DETAILS
SCALE: 1/2"=1'-0"

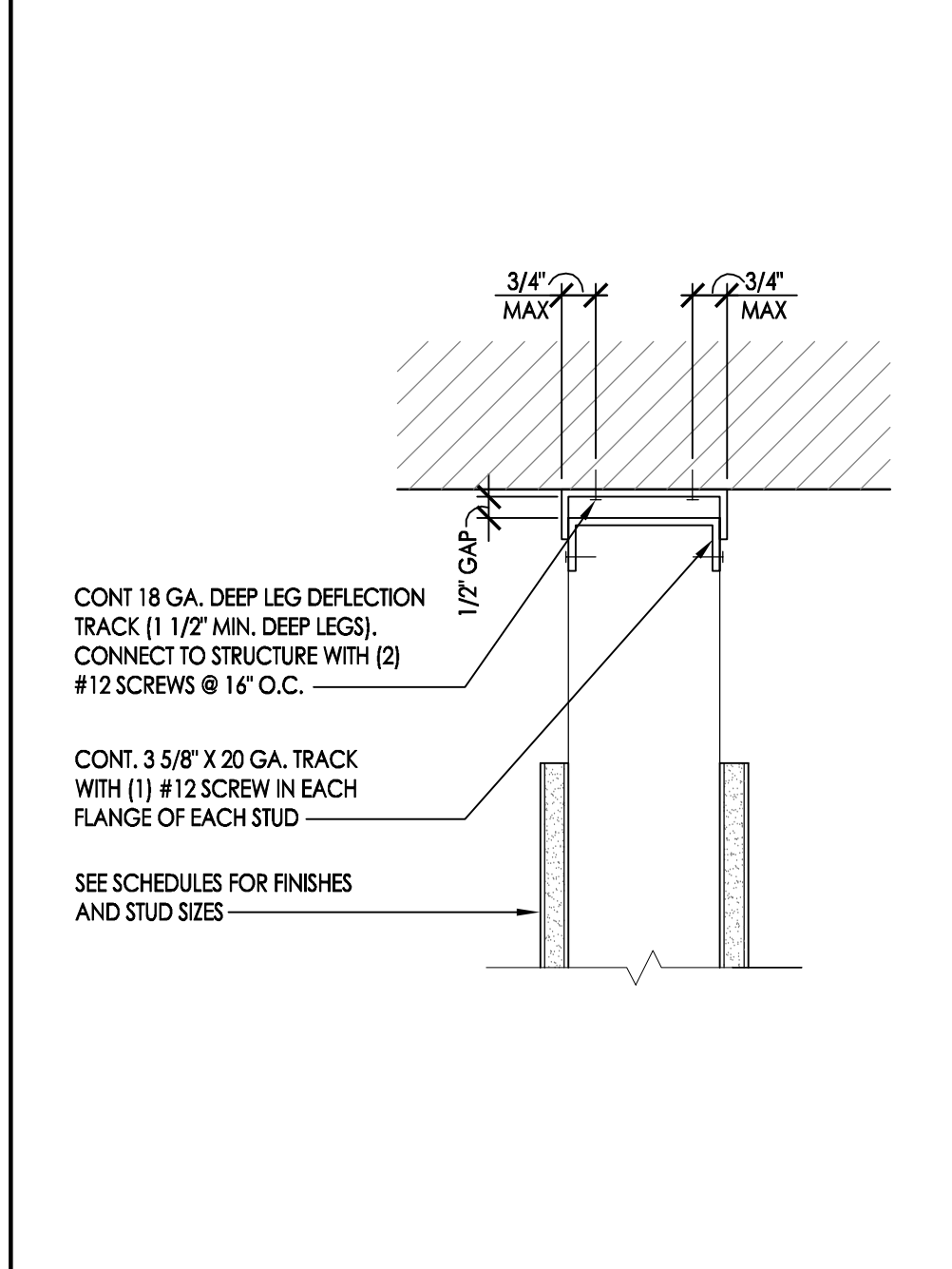

8 DEFLECTION TRACK (NON-RATED)
SCALE: 3"=1'-0"

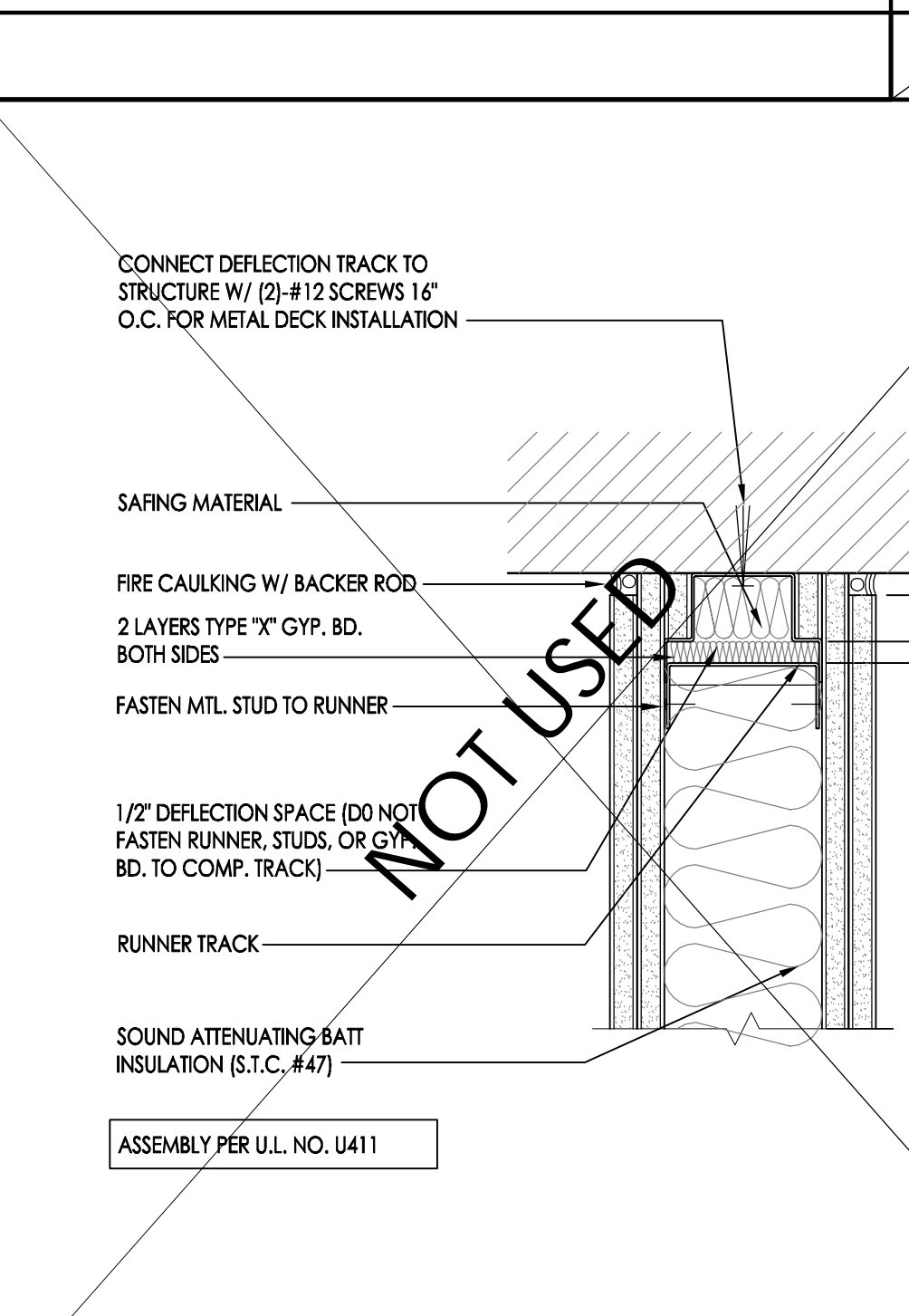

7 DEFLECTION TRACK (2-HOUR RATED)
SCALE: 3"=1'-0"

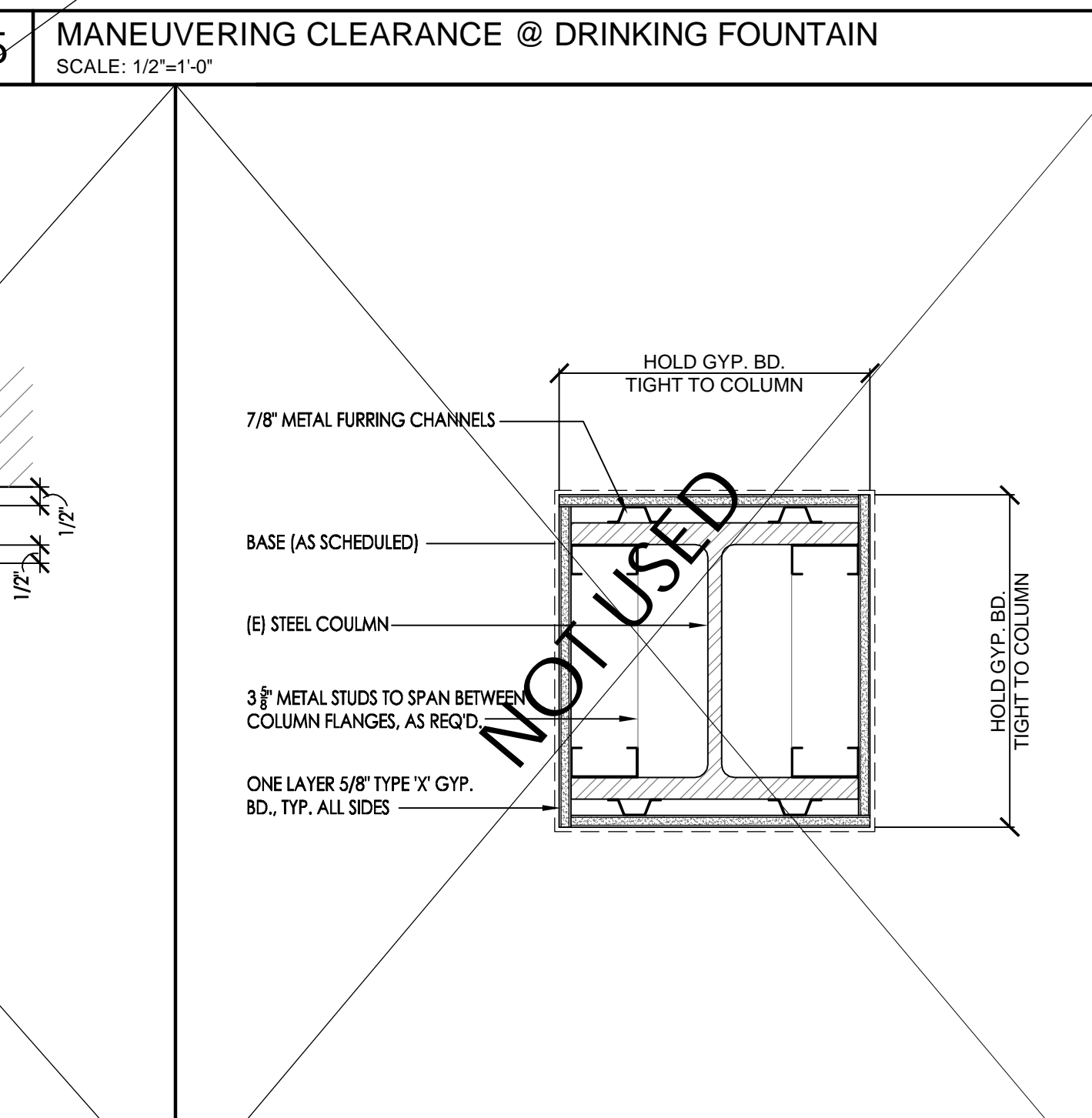

4 TYPICAL COLUMN ENCLOSURE
SCALE: 1 1/2"=1'-0"

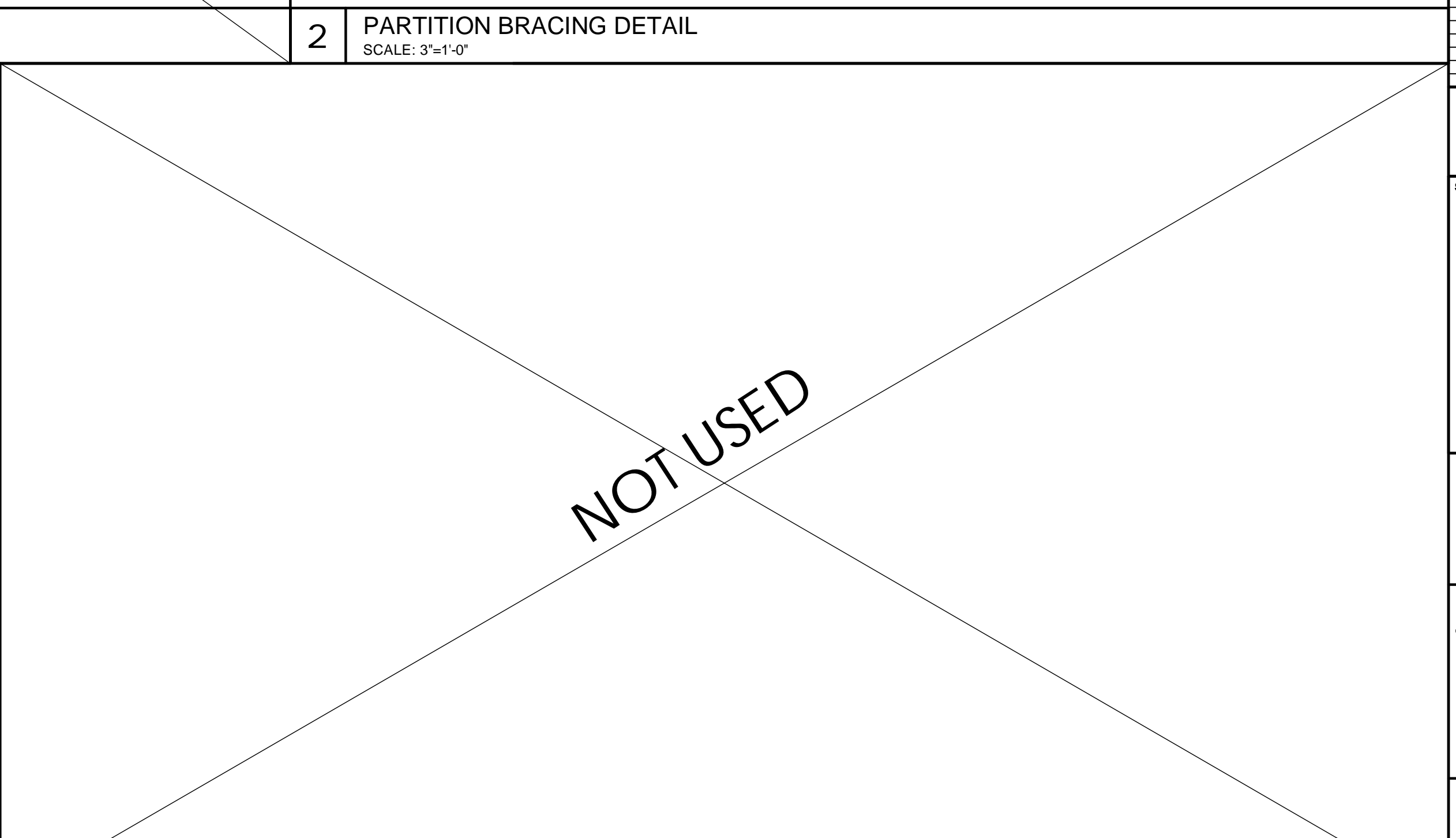

1 NOT USED
SCALE: 1 1/2"=1'-0"

CLIENT:
255 MASSACHUSETTS AVENUE #801
BOSTON, MA 02115
PHONE: (855) 421-6500
WEBSITE: <http://musepaintbar.com/>

ARCHITECT:
phase zero design
EIGHT WILCOX STREET
SINDBURY, CONNECTICUT 06070
PHONE: (860) 264-1624
FAX: (860) 264-1628
WEBSITE: www.phasezerodesign.com

MEP CONSULTANT:
OWNER:

MUSE PAINTBAR
245 COMMERCIAL STREET
PORTLAND, ME 04101

OWNER: MUSE PAINTBAR

REV	DATE	COMMENTS

ISSUE DATE: 01.20.2014
SCALE: AS NOTED

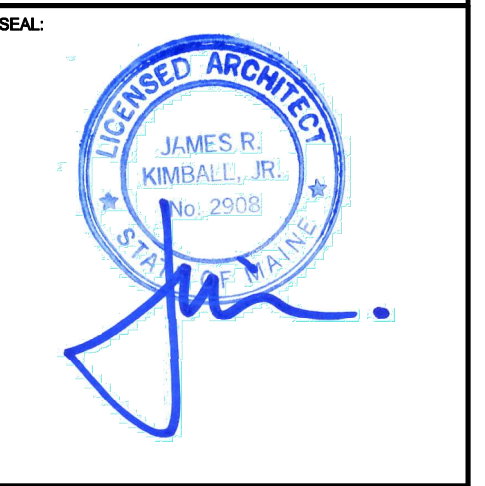

PROJECT NUMBER: 1113158
DRAWN BY: LAH
CHECKED BY: MSG
Copyright (c) by Phase Zero Design Corp. All Rights Reserved.

SHEET TITLE:
TYPICAL DETAILS

SHEET NUMBER:
A500