

**DISPLAY THIS CARD ON PRINCIPAL FRONTAGE OF WORK**  
**CITY OF PORTLAND**

Please Read  
Application And  
Notes, If Any,  
Attached

**BUILDING DEPARTMENT**  
**PERMIT**

Permit Number: 090438

This is to certify that MAINE EMPLOYERS' MUTUAL INSURANCE COMPANYhas permission to New 3' x 3' Hanging SignAT 245 COMMERCIAL ST

CB 0038 F006001

provided that the person or persons, firm or corporation accounting this permit shall comply with all of the provisions of the Statutes of Maine and of the Ordinances of the City of Portland regulating the construction, maintenance and use of buildings and structures, and of the application on file in this department.

Apply to Public Works for street line and grade if nature of work requires such information.

Notification of inspection must be given and written permission procured before this building or part thereof is lathed or otherwise covered-in. 24 HOUR NOTICE IS REQUIRED.

A certificate of occupancy must be procured by owner before this building or part thereof is occupied.

**OTHER REQUIRED APPROVALS**

Fire Dept. \_\_\_\_\_

Health Dept. \_\_\_\_\_

Appeal Board \_\_\_\_\_

Other \_\_\_\_\_

Department Name

**PENALTY FOR REMOVING THIS CARD**

Director - Building &amp; Inspection Services

# City of Portland, Maine - Building or Use Permit Application

389 Congress Street, 04101 Tel: (207) 874-8703, Fax: (207) 874-8716

<b>Permit No:</b> 09-0438		<b>Issue Date:</b>		<b>CBL:</b> 038 F006001	
<b>Location of Construction:</b> 245 COMMERCIAL ST		<b>Owner Name:</b> MAINE EMPLOYERS' MUTUAL I		<b>Owner Address:</b> PO BOX 11409	
<b>Business Name:</b> The Salt Exchange		<b>Contractor Name:</b>		<b>Contractor Address:</b>	
<b>Lessee/Buyer's Name</b>		<b>Phone:</b>		<b>Permit Type:</b> Signs - Permanent	
<b>Past Use:</b> Commercial - "Salt Exchange"		<b>Proposed Use:</b> Commercial - "Salt Exchange" - New 3' x 3' Hanging Sign		<b>Permit Fee:</b> \$83.00	
<i>use under 09-0218</i>				<b>Cost of Work:</b> \$83.00	
<b>Proposed Project Description:</b> New 3' x 3' Hanging Sign				<b>CEO District:</b> 1	
		<b>FIRE DEPT:</b> <input type="checkbox"/> Approved <input checked="" type="checkbox"/> Denied <i>N/A</i>		<b>INSPECTION:</b> Use Group: <i>V</i> Type: <i>Sign</i> <i>KBC 2003</i> Signature: <i>[Signature]</i>	
		<b>PEDESTRIAN ACTIVITIES DISTRICT (P.A.D.)</b> Action: <input type="checkbox"/> Approved <input type="checkbox"/> Approved w/Conditions <input checked="" type="checkbox"/> Denied Signature: _____ Date: _____			
<b>Permit Taken By:</b> Ldobson		<b>Date Applied For:</b> 05/08/2009		<b>Zoning Approval</b>	

1. This permit application does not preclude the Applicant(s) from meeting applicable State and Federal Rules.
2. Building permits do not include plumbing, septic or electrical work.
3. Building permits are void if work is not started within six (6) months of the date of issuance. False information may invalidate a building permit and stop all work..

<b>Special Zone or Reviews</b> <input type="checkbox"/> Shoreland <input type="checkbox"/> Wetland <input type="checkbox"/> Flood Zone <input type="checkbox"/> Subdivision <input type="checkbox"/> Site Plan Maj <input type="checkbox"/> Minor <input type="checkbox"/> MM <input type="checkbox"/> Date: <i>5/12/09</i>	<b>Zoning Appeal</b> <input type="checkbox"/> Variance <input type="checkbox"/> Miscellaneous <input type="checkbox"/> Conditional Use <input type="checkbox"/> Interpretation <input type="checkbox"/> Approved <input type="checkbox"/> Denied Date: _____	<b>Historic Preservation</b> <input type="checkbox"/> Not in District or Landmark <input type="checkbox"/> Does Not Require Review <input type="checkbox"/> Requires Review <input checked="" type="checkbox"/> Approved <input type="checkbox"/> Approved w/Conditions <input type="checkbox"/> Denied Date: <i>8/13/09</i> <i>D. Adams</i>
--------------------------------------------------------------------------------------------------------------------------------------------------------------------------------------------------------------------------------------------------------------------------------------------------------------------------------------------------	-----------------------------------------------------------------------------------------------------------------------------------------------------------------------------------------------------------------------------------------------------------------------------------	----------------------------------------------------------------------------------------------------------------------------------------------------------------------------------------------------------------------------------------------------------------------------------------------------------------------------------------------------------------------

## CERTIFICATION

I hereby certify that I am the owner of record of the named property, or that the proposed work is authorized by the owner of record and that I have been authorized by the owner to make this application as his authorized agent and I agree to conform to all applicable laws of this jurisdiction. In addition, if a permit for work described in the application is issued, I certify that the code official's authorized representative shall have the authority to enter all areas covered by such permit at any reasonable hour to enforce the provision of the code(s) applicable to such permit.

SIGNATURE OF APPLICANT

ADDRESS

DATE

PHONE

RESPONSIBLE PERSON IN CHARGE OF WORK, TITLE

DATE

PHONE

**City of Portland, Maine - Building or Use Permit**

389 Congress Street, 04101 Tel: (207) 874-8703, Fax: (207) 874-8716

<b>Permit No:</b> 09-0438		<b>Date Applied For:</b> 05/08/2009	<b>CBL:</b> 038 F006001																																
<b>Location of Construction:</b> 245 COMMERCIAL ST	<b>Owner Name:</b> MAINE EMPLOYERS' MUTUAL I	<b>Owner Address:</b> PO BOX 11409	<b>Phone:</b>																																
<b>Business Name:</b> The Salt Exchange	<b>Contractor Name:</b>	<b>Contractor Address:</b>	<b>Phone:</b>																																
<b>Lessee/Buyer's Name</b>	<b>Phone:</b>	<b>Permit Type:</b> Signs - Permanent																																	
<b>Proposed Use:</b> Commercial - "Salt Exchange" - New 3' x 3' Hanging Sign		<b>Proposed Project Description:</b> New 3' x 3' Hanging Sign																																	
<table><tr><td><b>Dept:</b> Historic</td><td><b>Status:</b> Approved</td><td><b>Reviewer:</b> Deborah Andrews</td><td><b>Approval Date:</b> 05/13/2009</td></tr><tr><td colspan="3"><b>Note:</b></td><td><b>Ok to Issue:</b> <input checked="" type="checkbox"/></td></tr><tr><td colspan="4"><hr/></td></tr><tr><td><b>Dept:</b> Zoning</td><td><b>Status:</b> Approved</td><td><b>Reviewer:</b> Marge Schmuckal</td><td><b>Approval Date:</b> 05/12/2009</td></tr><tr><td colspan="3"><b>Note:</b></td><td><b>Ok to Issue:</b> <input checked="" type="checkbox"/></td></tr><tr><td colspan="4"><hr/></td></tr><tr><td><b>Dept:</b> Building</td><td><b>Status:</b> Approved with Conditions</td><td><b>Reviewer:</b> Tammy Munson</td><td><b>Approval Date:</b> 05/15/2009</td></tr><tr><td colspan="3"><b>Note:</b></td><td><b>Ok to Issue:</b> <input checked="" type="checkbox"/></td></tr></table>				<b>Dept:</b> Historic	<b>Status:</b> Approved	<b>Reviewer:</b> Deborah Andrews	<b>Approval Date:</b> 05/13/2009	<b>Note:</b>			<b>Ok to Issue:</b> <input checked="" type="checkbox"/>	<hr/>				<b>Dept:</b> Zoning	<b>Status:</b> Approved	<b>Reviewer:</b> Marge Schmuckal	<b>Approval Date:</b> 05/12/2009	<b>Note:</b>			<b>Ok to Issue:</b> <input checked="" type="checkbox"/>	<hr/>				<b>Dept:</b> Building	<b>Status:</b> Approved with Conditions	<b>Reviewer:</b> Tammy Munson	<b>Approval Date:</b> 05/15/2009	<b>Note:</b>			<b>Ok to Issue:</b> <input checked="" type="checkbox"/>
<b>Dept:</b> Historic	<b>Status:</b> Approved	<b>Reviewer:</b> Deborah Andrews	<b>Approval Date:</b> 05/13/2009																																
<b>Note:</b>			<b>Ok to Issue:</b> <input checked="" type="checkbox"/>																																
<hr/>																																			
<b>Dept:</b> Zoning	<b>Status:</b> Approved	<b>Reviewer:</b> Marge Schmuckal	<b>Approval Date:</b> 05/12/2009																																
<b>Note:</b>			<b>Ok to Issue:</b> <input checked="" type="checkbox"/>																																
<hr/>																																			
<b>Dept:</b> Building	<b>Status:</b> Approved with Conditions	<b>Reviewer:</b> Tammy Munson	<b>Approval Date:</b> 05/15/2009																																
<b>Note:</b>			<b>Ok to Issue:</b> <input checked="" type="checkbox"/>																																
1) Signage Installation to comply with Chapter 31 of the IBC 2003 building code.																																			

**Comments:**

5/13/2009-gg: received permit from historic on 5/13/09. /gg

# Signage/Awning Permit Application

If you or the property owner owes real estate or personal property taxes or user charges on any property within the City, payment arrangements must be made before permits of any kind are accepted.

Location/Address of Construction: <u>245 Commercial St. Portland ME</u>		
Tax Assessor's Chart, Block & Lot Chart#      Block#      Lot# <u>38</u> <u>F</u> <u>4930</u>	Owner: <u>MEMIC Co.</u>	Telephone: <u>207-791-3304</u>
Lessee/Buyer's Name (If Applicable) <u>CIS Restaurant LLC</u>	Contractor name, address & telephone:	Total s.f. of signage x \$2.00 Per s.f. plus \$30.00/\$65.00 For H.D. signage= Total Fee: \$ Awning Fee= cost of work Total Fee: \$
Who should we contact when the permit is ready: <u>Charles Bryon</u> phone: <u>207-272-9855</u> Tenant/allocated building space frontage (feet): Length: <u>53.5</u> Height: <u>12</u> Lot Frontage (feet): <u>53.5</u> Single Tenant or Multi Tenant Lot: <u>Multi tenant</u> <u>OK</u> Current Specific use: <u>Restaurant</u> If vacant, what was prior use: <u>Offices</u> Proposed Use: _____ Information on proposed sign(s): Freestanding (e.g., pole) sign? Yes _____ No _____ Dimensions proposed: _____ Height from grade: _____ Bldg. wall sign? (attached to bldg) Yes <u>X</u> No _____ Dimensions proposed: <u>3' x 3'</u> Proposed awning? Yes <u>X</u> No _____ Is awning backlit? Yes _____ No <u>X</u> Height of awning: _____ Length of awning: _____ Depth: _____ Is there any communication, message, trademark or symbol on it? Yes _____ No <u>X</u> If yes, total s.f. of panels w/communications, message, trademark or symbol: _____ s.f. Information on existing and previously permitted sign(s): Freestanding (e.g., pole) sign? Yes _____ No _____ Dimensions: _____ Bldg. wall sign? (attached to bldg) Yes <u>X</u> No _____ Dimensions: <u>3' x 3'</u> Awning? Yes _____ No <u>X</u> Sq. ft. area of awning w/communication: _____ A site sketch and building sketch showing exactly where existing and new signage is located must be provided. Sketches and/or pictures of proposed signage and existing building are also required.		

**Please submit all of the information outlined in the Sign/Awning Application Checklist.**  
**Failure to do so may result in the automatic denial of your permit.**

In order to be sure the City fully understands the full scope of the project, the Planning and Development Department may request additional information prior to the issuance of a permit. For further information visit us on-line at [www.portlandmaine.gov](http://www.portlandmaine.gov), stop by the Building Inspections office, room 315 City Hall or call 874-8703.

I hereby certify that I am the Owner of record of the named property, or that the owner of record authorizes the proposed work and that I have been authorized by the owner to make this application as his/her authorized agent. I agree to conform to all applicable laws of this jurisdiction. In addition, if a permit for work described in this application is issued, I certify that the Code Official's authorized representative shall have the authority to enter all areas covered by this permit at any reasonable hour to enforce the provisions of the codes applicable to this permit.

Signature of applicant:	Date:
-------------------------	-------

This is not a permit; you may not commence ANY work until the permit is issued.



The  
Salt  
Exchange

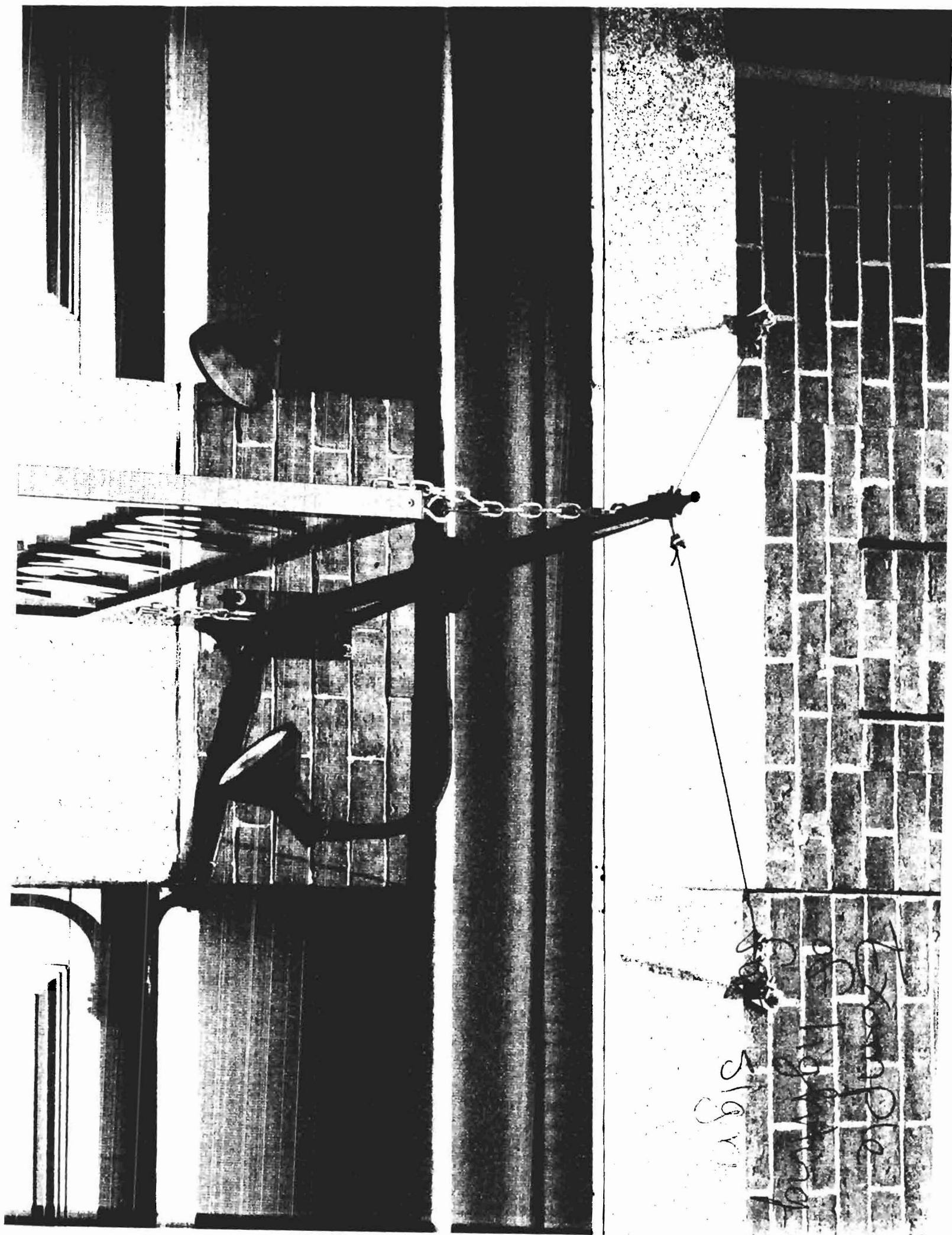

Sample  
of 11/19/19  
2191





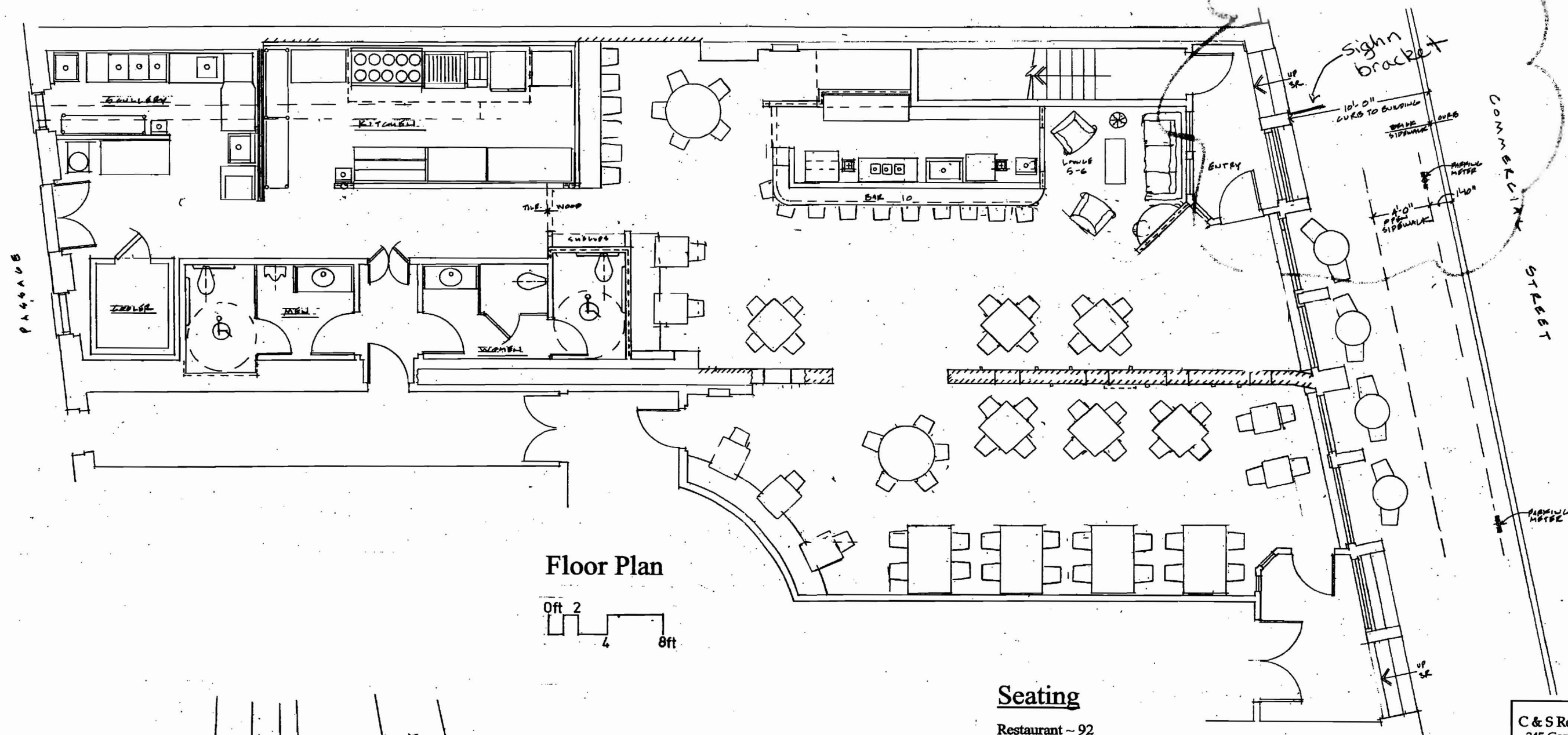

Floor Plan

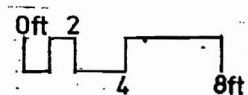

### Seating

Restaurant ~ 92  
Sidewalk ~ 8

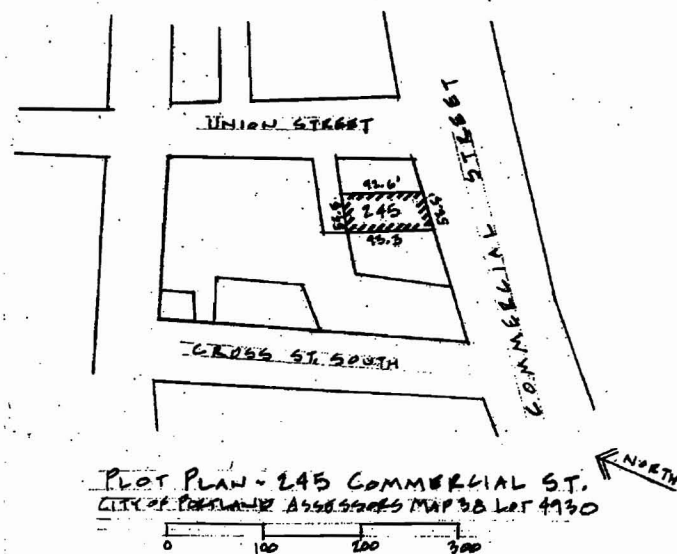

C & S Restaurant LLC  
245 Commercial Street  
Portland, Maine

Buell Heminway  
ARCHITECTS  
P.O. Box 17733 DTS - Portland, Me 04112  
(207) 772-8892 - FAX 772-2870  
Email: bheminiw@giwi.net

Drawing No.

Permit 1

Title:

Permit Plan  
Liquor License  
Outdoor Dining

Date: March 13, 2009  
Scale: Shown  
By: Buell