

**GENERAL NOTES**

- 1: DRAWING NOTES:  
DRAWING NOTES, UNLESS THEY INDICATE OTHERWISE, REFER TO NEW CONSTRUCTION.
- 2: CODE COMPLIANCE:  
ALL WORK SHALL CONFORM TO THE LATEST EDITION OF STATE, LOCAL AND OTHER CODES WHICH APPLY TO THIS PROJECT OR HAVE JURISDICTION.
- 3: CENTERING:  
UNLESS INDICATED OTHERWISE, CENTER BUILDING ELEMENTS WITHIN OR BETWEEN BUILDING ELEMENTS WHEN CONDITIONS OR THE DRAWINGS INDICATE OR IMPLY THAT SUCH IS THE INTENT, WHETHER OR NOT DIMENSIONS ARE INCLUDED.
- 4: SYMMETRY:  
WHERE CONDITIONS OR THE DRAWINGS INDICATE OR IMPLY THAT SYMMETRY IS INTENDED, INFORMATION PROVIDED AT ONE SIDE APPLIES EQUALLY TO BOTH SIDES, UNLESS CONDITIONS CLEARLY PRECLUDE SUCH APPLICATION.
- 5: DRAWING SCALES:  
WORK FROM THE GIVEN DIMENSIONS ONLY. SCALE IS INDICATED ON THE DRAWINGS FOR CONVENIENCE ONLY. IT IS NOT INTENDED THAT INFORMATION BE DETERMINED BY SCALING THE DRAWINGS SINCE SOME ITEMS MAY NOT BE TO SCALE.
- 6: EXISTING FIRE RATINGS:  
CONTRACTOR TO VERIFY ALL EXISTING FIRE RATINGS, INCLUDING BUT NOT LIMITED TO: WALLS, DOORS, GLAZING, FLOOR-CEILING, ROOF-CEILING.
- 7: SPRINKLER SYSTEM:  
UPGRADE SPRINKLER SYSTEM IN AREA OF RENOVATION TO MEET ALL APPLICABLE CODES (FEDERAL, STATE AND LOCAL)
- 8: FIRE ALARM:  
UPGRADE FIRE ALARM SYSTEM IN AREA OF RENOVATION TO MEET ALL APPLICABLE CODES (FEDERAL, STATE AND LOCAL)
- 9: EMERGENCY LIGHTING:  
UPGRADE EMERGENCY LIGHTING SYSTEM IN AREA OF RENOVATION TO MEET ALL APPLICABLE CODES (FEDERAL, STATE AND LOCAL)

**PLAN NOTES:**

- 1.) ALL NEW WALLS TO BE 3-5/8" METAL STUDS AT 24" O.C. WITH A LAYER OF 5/8" GWB EACH SIDE, UNLESS OTHERWISE NOTED
- 2.) NEW (NON-FIRE RATED) FRAMED WALLS TO EXTEND 6" ABOVE ADJACENT CEILINGS, PROVIDE DIAGONAL BRACING TO STRUCTURE ABOVE AS REQUIRED
- 3.) PROVIDE SOLID BLOCKING IN WALLS FOR ALL CABINETS, GRAB BARS, WALL HUNG FIXTURES, ETC.
- 4.) PROVIDE TRANSITION STRIPS CENTERED UNDER DOORS AT FLOORING MATERIAL TRANSITIONS
- 5.) ALL WALLS, EXISTING AND NEW TO BE PAINTED
- 6.) PROVIDE MOISTURE RESISTANT (MR) GWB AT ALL BATHROOM WALLS
- 7.) PROVIDE 4" VINYL COVE BASE UNLESS OTHERWISE NOTED
- 8.) TOILET ROOM AND BREAK ROOM TO RECEIVE 12X12 VCT FLOORING, ALL OTHER AREAS TO RECEIVE HARDWOOD FLOORING

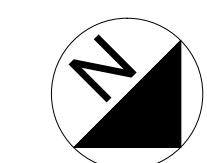
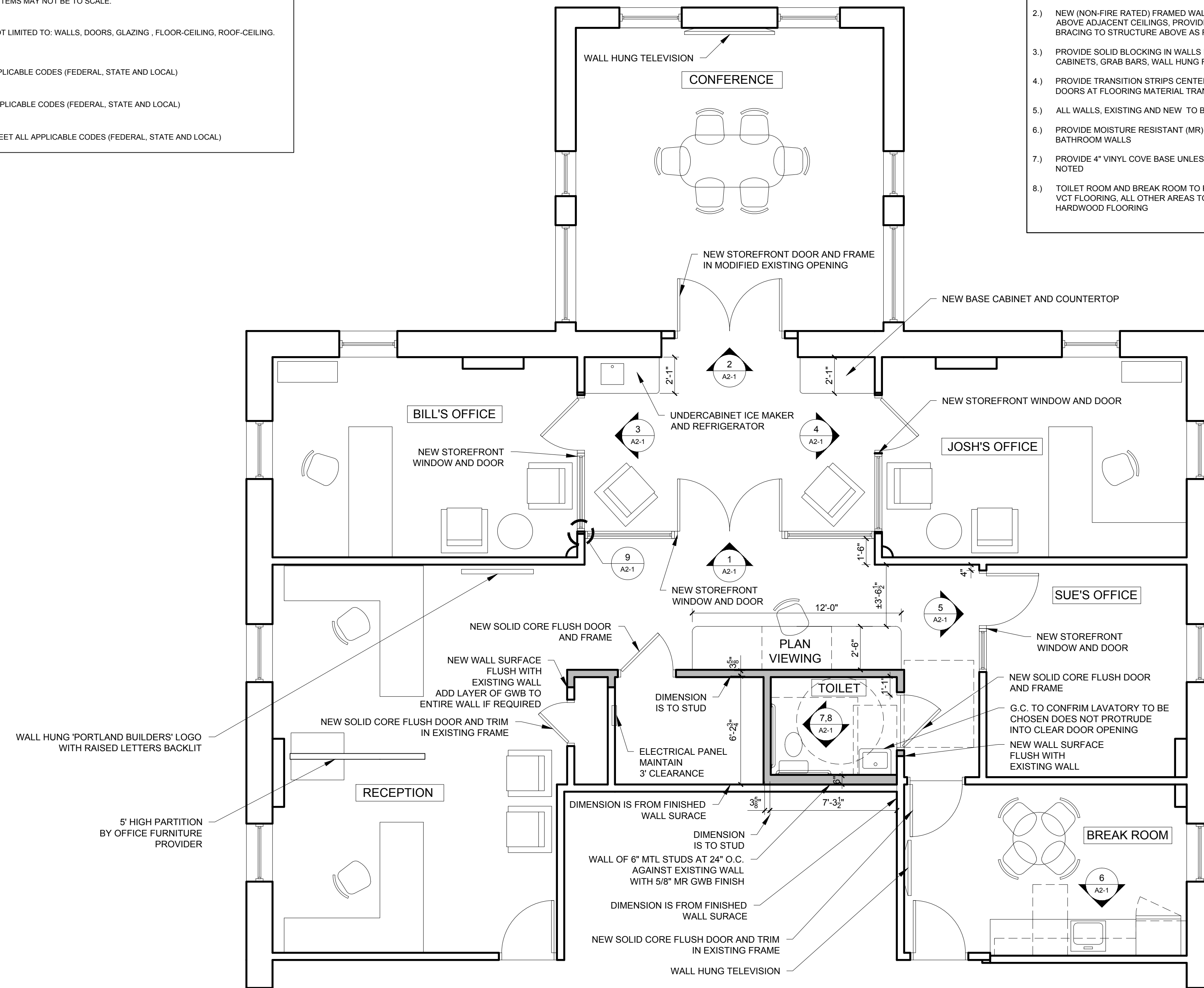

**WALL LEGEND:**

|                    |  |
|--------------------|--|
| EXISTING WALL      |  |
| WALL TO BE REMOVED |  |
| NEW WALL           |  |

1 FLOOR PLAN  
1/4"=1'-0"



© 2013 RYAN SENATORE ARCHITECTURE

**OFFICES FOR PORTLAND BUILDERS**  
70 CENTER STREET, SUITE 304  
PORTLAND, MAINE



**RYAN SENATORE ARCHITECTURE**  
67 GRAY ROAD  
GORHAM, MAINE 04038  
207-650-6414  
senatorearchitecture.com

CONSULTANTS:

REVISIONS:

DATE: MAY 29, 2013

PROJECT No. 1305

DRAWN BY: RJS

CHECKED BY: RJS

SCALE: AS NOTED

SHEET TITLE:  
FLOOR PLAN  
GENERAL NOTES

**A1-1**