

SINK COMBS DETHELEFS

Copyright © Sink Combs Dethlefs
475 Lincoln Street, Suite 110, Denver, Colorado 80202
303.308.0200
FAX 303.622.2222

REMOVALS NOTES:

- SEE NOTES R1 THROUGH R5 ON SHEET G1006 FOR ADDITIONAL REMOVALS INFORMATION.
- CLEARING LIMITS SHALL EXTEND ONLY TO SUCH A POINT NECESSARY TO COMPLETE EARTHWORK ACTIVITIES.
- THE UTILITY INFORMATION SHOWN ON THIS PLAN IS APPROXIMATE AND IS BASED ON A SURVEY COMPLETED BY SHYKA, SHEPPARD, & GARSTER LAND SURVEYORS. THE SITE CONTRACTOR SHALL FIELD VERIFY ALL EXISTING UTILITIES PRIOR TO BEGINNING ANY SITE CLEARING, GRUBBING AND EARTHWORK ACTIVITIES.
- ALL SOIL AND EROSION CONTROL MEASURES SHALL BE IN PLACE PRIOR TO THE COMMENCEMENT OF ANY WORK. SEE CG101 FOR MORE INFORMATION. THE SITE CONTRACTOR IS RESPONSIBLE FOR INSPECTING AND MAINTAINING ALL SOIL AND EROSION CONTROL MEASURES.
- SOME TREE TRIMMING NOT SHOWN ON THIS PLAN MAY BE NECESSARY FOR CONSTRUCTION PURPOSES. THE SITE CONTRACTOR SHOULD EVALUATE AND SCHEDULE ACCORDINGLY.
- SEE PHASING PLANS FOR ADDITIONAL INFORMATION RELATED TO SEQUENCE OF CONSTRUCTION, SIDEWALK / LANE CLOSURES & APPROXIMATE LOCATION OF SECURITY FENCING / GATES.
- SITE CONTRACTOR SHALL COORDINATE WITH THE CITY OF PORTLAND AND OFFICIALS A STAFF WHEN WORKING WITHIN THE SPRING, CENTER AND FREE STREET R.O.W.'S.
- IN ALL LOCATIONS INDICATING "FULL DEPTH" HOT MIX ASPHALT, INSTALL PAVEMENT TO MATCH EXISTING SURFACE. ALL SITE IMPROVEMENT WORK SHALL BE COMPLETED PRIOR TO GRINDING EXISTING PAVEMENT & PAVEMENT OVERLAY INSTALLATION.
- THE CONTRACTOR SHALL MAINTAIN SAFE ACCESS TO ALL THE EXISTING BUILDINGS WITHIN THE PROJECT LIMITS, WHICH INCLUDES H.C. ACCESS, CUSTOMER ACCESS, EMERGENCY VEHICLE ACCESS DELIVERY TRUCK ACCESS, AND TEMPORARY ACCESS. THE ACCESS TO THE BUILDING SHALL BE COORDINATED WITH THE OWNER. THESE ACCESSES SHALL BE MAINTAINED BY THE CONTRACTOR THROUGHOUT THE CONSTRUCTION DURATION. WEEKEND WORK AND/OR PHASING OF WORK MAY BE REQUIRED TO COMPLETE REQUIRED SITE IMPROVEMENTS.
- CONTRACTOR TO MAINTAIN ACCESS TO ALL FIRE HYDRANTS WITHIN THE CONSTRUCTION LIMITS AT ALL TIMES.
- SEE SHEETS PH100 AND PH101 FOR PHASING OF CONSTRUCTION.
- SEE SITE LEDGE REMOVALS PLAN, SHEET CD102 FOR ADDITIONAL INFORMATION.

EXISTING	LEGEND	PROPOSED
(Symbol)	STREET LIGHTING	(Symbol)
(Symbol)	BUILDING LIGHTING	(Symbol)
(Symbol)	WATER SHUTOFF / GATE VALVE	(Symbol)
(Symbol)	ELECTRIC COMM. MANHOLE	(Symbol)
(Symbol)	PARKING METER	(Symbol)
(Symbol)	MANHOLE	(Symbol)
(Symbol)	SEWER MANHOLE	(Symbol)
(Symbol)	GAS SHUTOFF	(Symbol)
(Symbol)	CATCH BASIN	(Symbol)
(Symbol)	FIRE HYDRANT SIGN	(Symbol)
(Symbol)	PAVEMENT REMOVALS	(Symbol)
(Symbol)	LIMITS OF CONSTRUCTION	(Symbol)
(Symbol)	PROPERTY SETBACK	(Symbol)
(Symbol)	PROPERTY LINE	(Symbol)
(Symbol)	ABUTTING PROPERTY LINE	(Symbol)

REV.	DESCRIPTION	DATE
9	SPRING STREET DESIGN DEVELOPMENT	08-16-2013
8	SM800	05-07-2013 (R)
7	RFR230	04-05-2013 (R)
6	BULLETIN #25	02-01-2013 (R)
5	CONSTRUCTION DOCUMENTS	01-21-2013
4	NW ENTRY CONSTRUCTION DOCS	10-31-2012
3	PHASE 2 DESIGN DEVELOPMENT	10-26-2012
2	NW ENTRY F.S.E CON DOCS	08-23-2012
1	ADDENDUM #1	08.09.12

SPRING STREET DESIGN DEVELOPMENT 08.16.2013

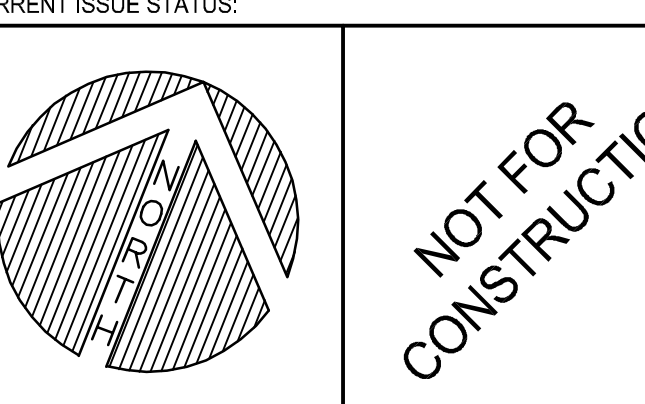

WBRC ARCHITECTS ENGINEERS
WWW.WBRC.COM
BANDOLIER, MAINE 207-947-4818
ROCKLAND, MAINE 207-949-4818
SARASOTA, FLORIDA 941-375-2882

CUMBERLAND COUNTY CIVIC CENTER RENOVATION

PROJECT: PORTLAND, MAINE

SITE REMOVALS PLAN

SHEET TITLE:	375700-SP101-SB80.DWG
WBRC CAD FILE:	375700-SP101-SB80.DWG
PROJECT NO.:	3757.00
SCALE:	GRAPHIC SCALE: 0' 1" 20'
PROJECT MANAGER:	MEJ
DRAWN BY:	JWB
CHECKED BY:	ARB
SHEET NO.:	CD101

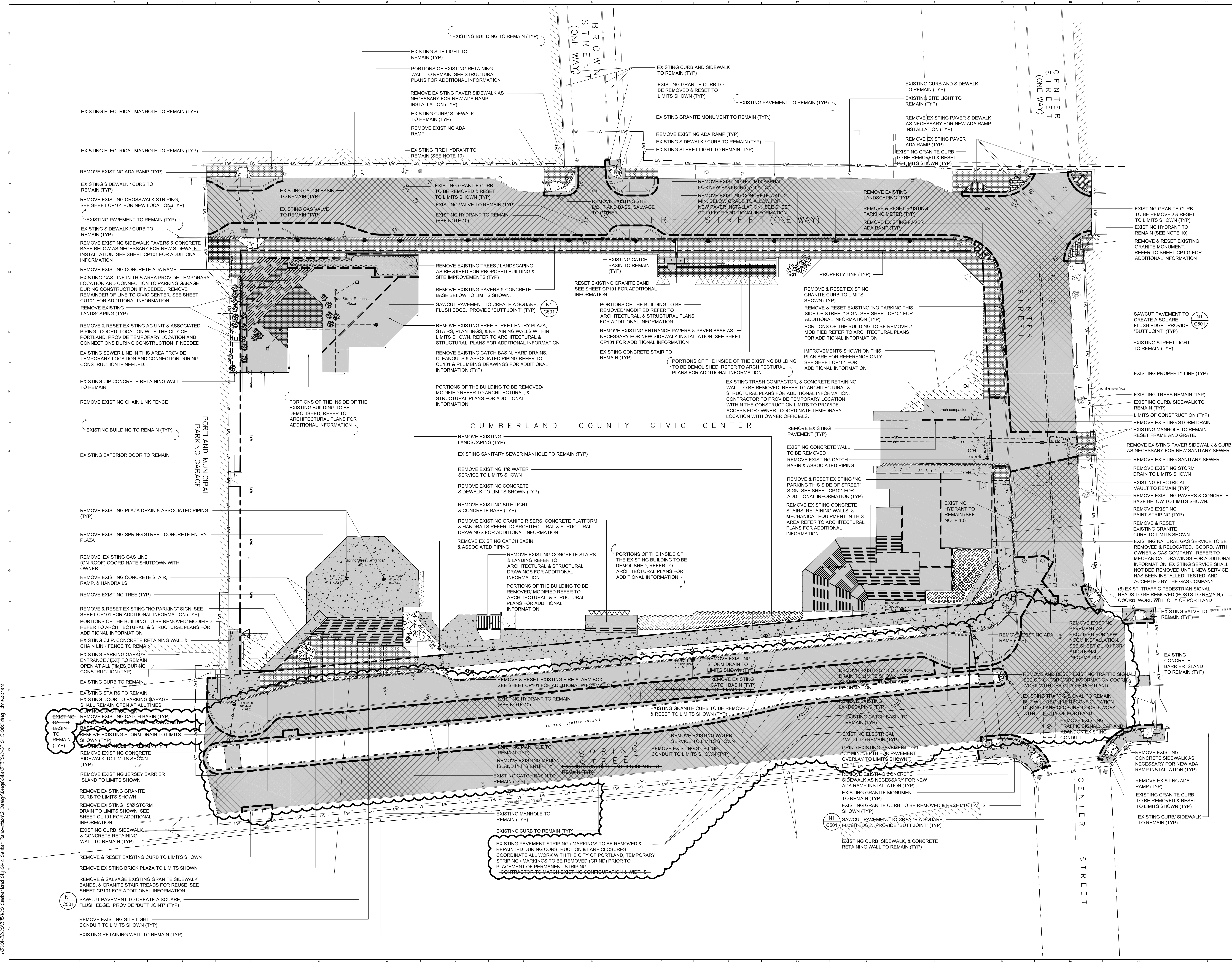

Aug 16, 2013 9:46am
 I:\375700-SP101\Cumberland_Cty_Civic_Center_Renovations\Design\Drawings\SP101-SB80.dwg dthlefs

SINK COMBS DETHLEFS

Copyright © Sink Combs Dethlefs
475 Lincoln Street, Suite 110, Denver, Colorado 80202
303.308.0200
FAX 303.502.2222

- LAYOUT NOTES:**
- SEE NOTES L1 THROUGH L3 ON SHEET 6006 FOR ADDITIONAL LAYOUT INFORMATION.
 - ALL CURB RADI SHALL BE 5' UNLESS OTHERWISE NOTED.
 - COORDINATE ALL SIDEWALK LOCATIONS WITH ARCH AND STRUCTURAL DRAWINGS TO VERIFY NEW EXTERIOR DOOR LOCATIONS. FIELD ADJUST AS REQUIRED.
 - REFER TO STRUCTURAL SHEETS FOR NEW FOUNDATION LAYOUT. COORDINATE LAYOUT WITH FOUNDATION CONTRACTOR.
 - SEE SHEET CU101 FOR ADDITIONAL INFORMATION RELATED TO THE LAYOUT OF SITE LIGHTS AND UTILITY POLES AND THEIR RESPECTIVE CONDUIT AND WIRING. COORDINATE LAYOUT WITH THE ELECTRICAL CONTRACTOR.
 - ALL PROPOSED IMPROVEMENT WORK WITHIN THE STREET R.O.W. SHALL MEET THE CITY OF PORTLAND TECHNICAL MANUAL STANDARDS.
 - ALL PROPOSED SIDEWALK ADA HANDICAP RAMPS AND CROSSWALK LAYOUT AND LOCATIONS SHALL BE APPROVED PRIOR TO CONSTRUCTION BY THE CITY OF PORTLAND'S BIKE/PEDESTRIAN COORDINATOR BRUCE HYMAN (409-4243).
 - SEE SHEETS PH100 AND PH101 FOR PHASING OF CONSTRUCTION.
 - FINAL CROSSWALK MARKINGS SHALL BE APPROVED BY THE CITY OF PORTLAND TRAFFIC ENGINEER PRIOR TO COMPLETING WORK.

LEGEND

EXISTING	PROPOSED
STREET LIGHTING	STREET LIGHTING
WATER SHUTOFF / GATE VALVE	WATER SHUTOFF / GATE VALVE
ELECTRIC COMM. MANHOLE	ELECTRIC COMM. MANHOLE
PARKING METER	PARKING METER
SEWER MANHOLE	SEWER MANHOLE
GAS SHUTOFF	GAS SHUTOFF
CATCH BASIN	CATCH BASIN
FIRE HYDRANT	FIRE HYDRANT
SIGN	SIGN
PAVEMENT	PAVEMENT
CONCRETE SIDEWALK	CONCRETE SIDEWALK
PAVER SIDEWALK	PAVER SIDEWALK
CIP CONCRETE RETAINING WALL	CIP CONCRETE RETAINING WALL
PROPERTY SETBACK	PROPERTY SETBACK
PROPERTY LINE	PROPERTY LINE
ABUTTING PROPERTY LINE	ABUTTING PROPERTY LINE

REV.	DESCRIPTION	DATE
17	SPRING STREET DESIGN DEVELOPMENT	08-16-2013
	RFR362	05-21-2013 (R)
	RFR335	05-03-2013 (R)
	SM090	05-07-2013 (R)
	SM079	04-19-2013 (R)
	RFR230	04-05-2013 (R)
	SM044	02-27-2013 (R)
	SM017.2	02-21-2013
	SM025	02-01-2013 (R)
8	CONSTRUCTION DOCUMENTS	01-21-2013
	SM015	01-17-2013 (R)
6	RFR103	01-03-2013
5	NW ENTRY CONSTRUCTION DOCS	10-31-2012
4	PHASE 2 DESIGN DEVELOPMENT	10-26-2012
	ADDENDUM #2	09-21-2012
2	NW ENTRY F.S.E. CON DOCS	08-23-2012
	ADDENDUM #1	08-09-12 (R)
REV.	DESCRIPTION	DATE

SPRING STREET DESIGN DEVELOPMENT
08.16.2013

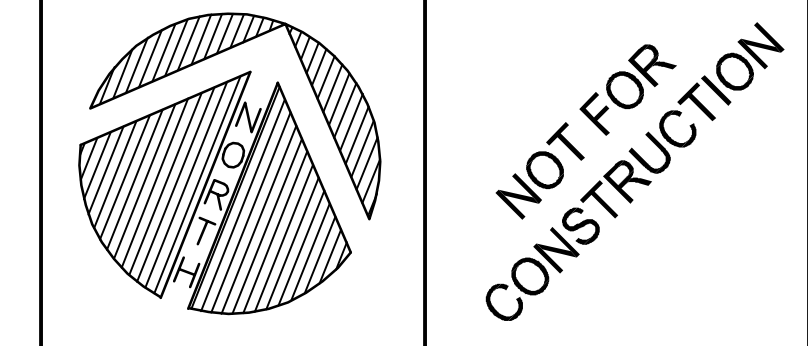

WBRC ARCHITECTS + ENGINEERS
WWW.WBRC.COM
BANGOR, MAINE 207-947-4818
ROCKLAND, MAINE 207-858-4818
SARASOTA, FLORIDA 941-375-2882

CUMBERLAND COUNTY CIVIC CENTER RENOVATION
PROJECT: PORTLAND, MAINE

SITE LAYOUT & MATERIALS PLAN

SHEET TITLE:	375700.SP101.S080.DWG
WBRC CAD FILE:	3757.00
PROJECT NO.:	3757.00
SCALE:	1"=20'
PROJECT MANAGER:	MEJ
DRAWN BY:	JWB
CHECKED BY:	ARB
SHEET NO.:	CP101

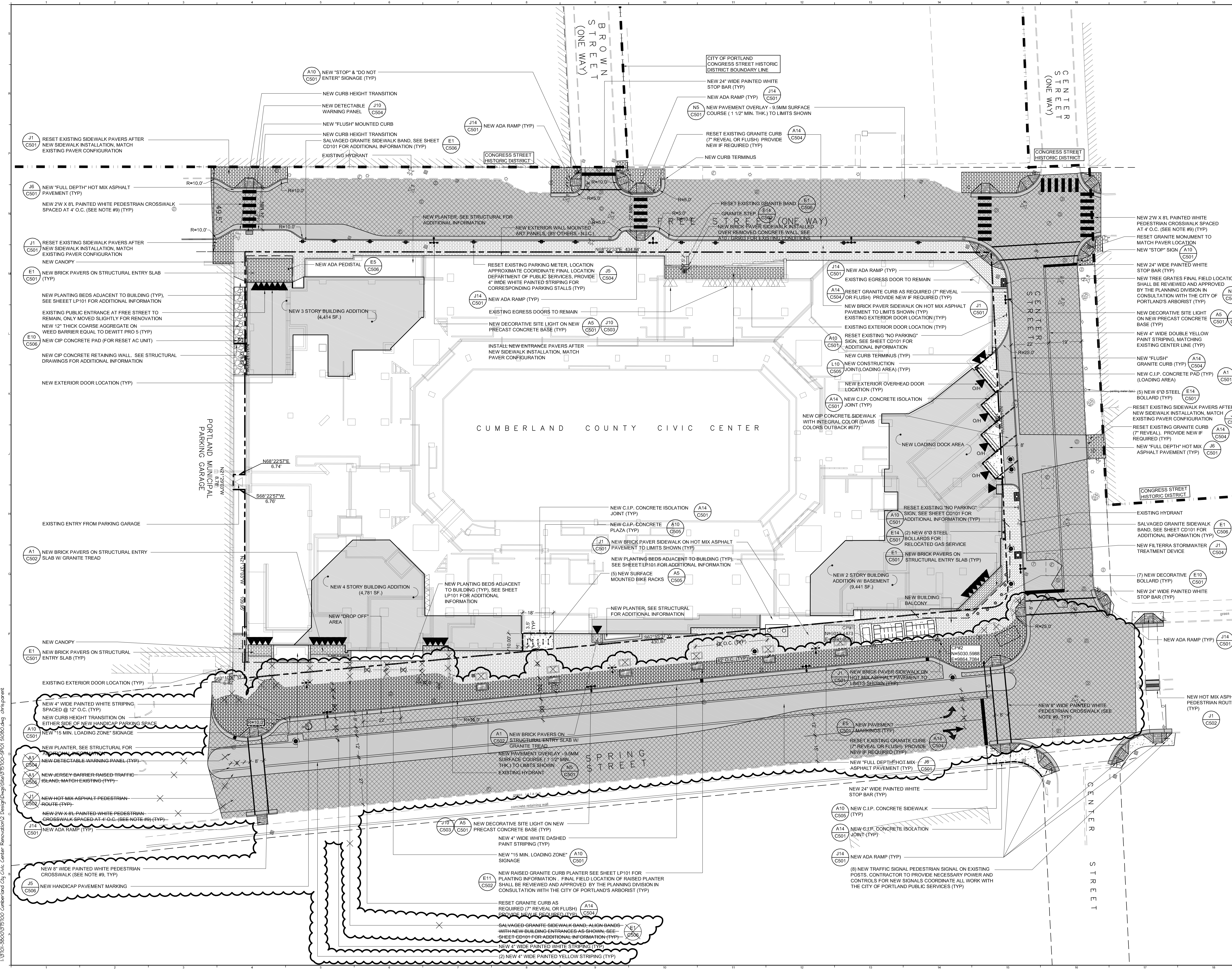

Aug 16, 2013 8:55pm
 I:\375700\375700\Cumberland_Civ_Ctr_Civic_Center_Renov\2\Design\Drawings\375700-SP101_S080.dwg dthlefs@wbrc.com

- GRADING NOTES:**
- SEE NOTES G1 THROUGH G8 ON SHEET G0006 FOR ADDITIONAL GRADING INFORMATION.
 - ALL DISTURBED AREAS NOT RECEIVING PAVEMENT SHALL BE PROVIDED WITH LOAM AND SEED PER THE CONTRACT DOCUMENTS.
 - PROPOSED GRADING SHOWN ON THIS PLAN IS BASED ON A TOPOGRAPHIC SURVEY PREPARED BY SHYKA, SHEPPARD & GARSTER LAND SURVEYORS.
 - TEST PIT LOCATION AND INFORMATION PROVIDED BY S.W. COLE ENGINEERING INC. AND IS LOCATED IN THE DRAWING SET.
 - SEE SHEETS PH100 AND PH101 FOR PHASING OF CONSTRUCTION.

EXISTING	LEGEND	PROPOSED
⊗	STREET LIGHTING	⊗
⊕	WATER SHUTOFF / GATE VALVE	⊕
⊖	ELECTRIC COMM. MANHOLE	⊖
⊙	PARKING METER	⊙
⊚	MANHOLE	⊚
⊛	SEWER MANHOLE	⊛
⊜	GAS SHUTOFF	⊜
⊝	CATCH BASIN	⊝
⊞	FIRE HYDRANT	⊞
⊟	SIGN	⊟
⊠	PAVEMENT	⊠
⊡	SIDEWALK	⊡
⊢	CIP CONCRETE RETAINING WALL	⊢
---	CONTOURS	---
---	TEMP. SILT INLET PROTECTION	---
---	PROPERTY STRIKEBACK	---
---	PROPERTY LINE	---
---	ADJUTING PROPERTY LINE	---

REV.	DESCRIPTION	DATE
10	SPRING STREET DESIGN DEVELOPMENT	08-16-2013
9	RFRWR362	05-21-2013 (R)
8	SM030	05-07-2013 (R)
7	RFRWR230	04-05-2013 (R)
6	SM044	02-27-2013 (R)
5	SM025	02-01-2013 (R)
4	CONSTRUCTION DOCUMENTS	01-21-2013
3	NW ENTRY CONSTRUCTION DOCS	10-31-2012
2	PHASE 2 DESIGN DEVELOPMENT	10-26-2012
1	ADDENDUM #2	09-21-2012
0	NW ENTRY F.S.E. CON DOCS	08-23-2012

SPRING STREET DESIGN DEVELOPMENT 08.16.2013
CURRENT ISSUE STATUS:

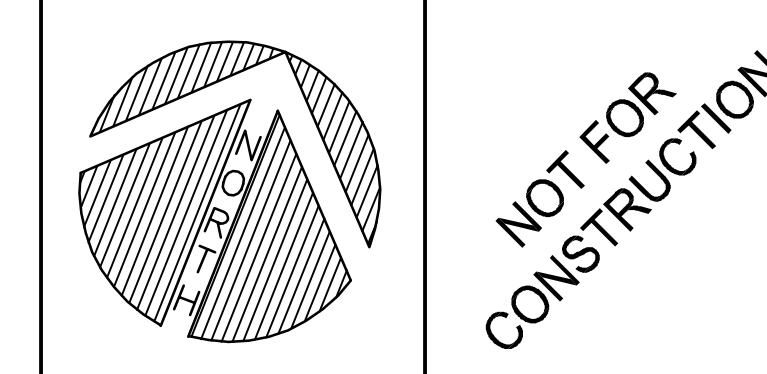

WBRC
ARCHITECTS • ENGINEERS
WWW.WBRC.COM
BANGOR, MAINE 207-947-4818
ROCKLAND, MAINE 207-582-4818
SARASOTA, FLORIDA 941-375-2882

CUMBERLAND COUNTY CIVIC CENTER RENOVATION
PROJECT: PORTLAND, MAINE

SITE GRADING & EROSION CONTROL PLAN

SHEET TITLE:	375700-SP101 S0800.DWG
WBRC CAD FILE:	3757.00
PROJECT NO.:	3757.00
SCALE:	1"=20'
PROJECT MANAGER:	MEJ
DRAWN BY:	JWB
CHECKED BY:	ARB
SHEET NO.:	CG101

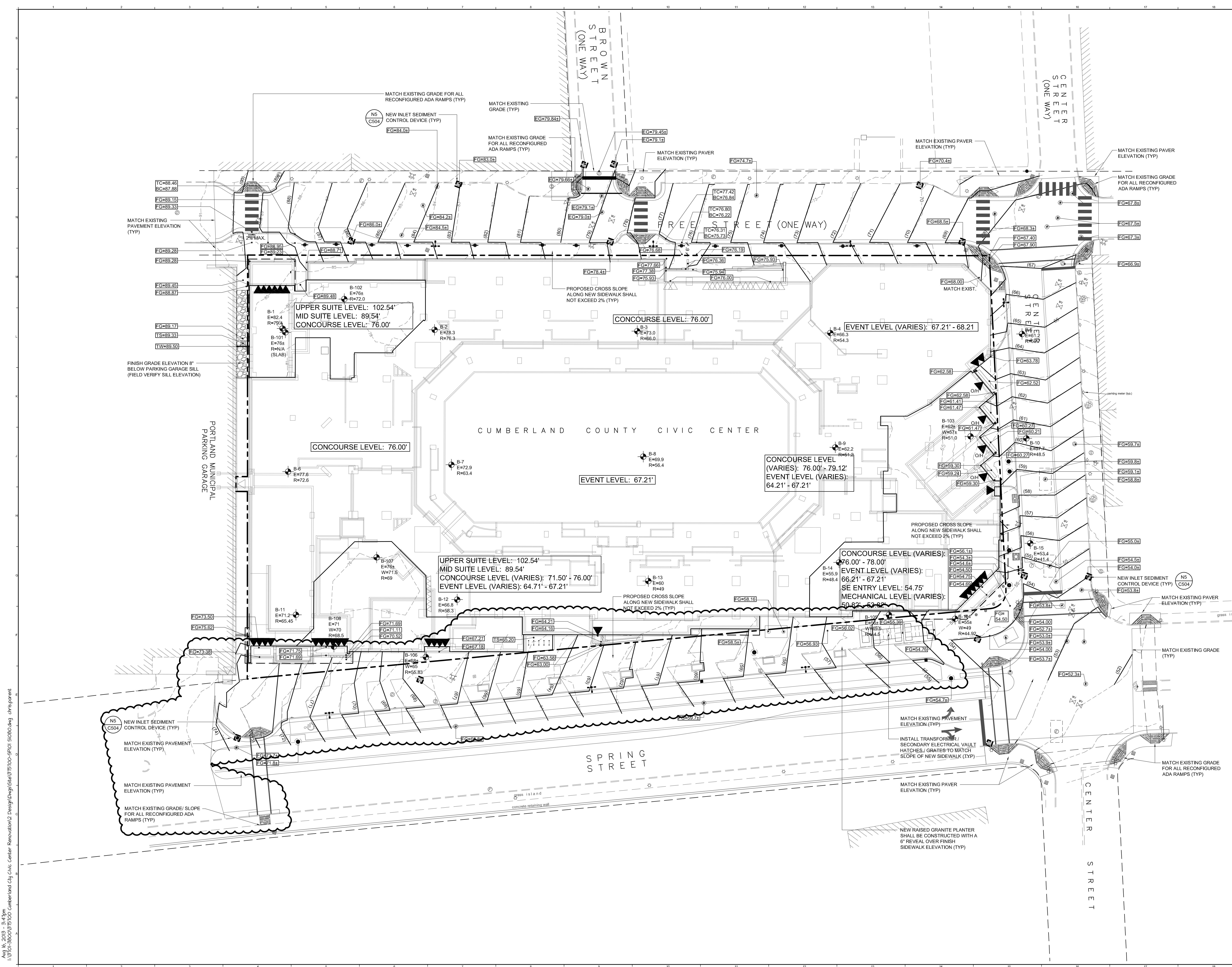

Aug 16, 2013 8:11pm I:\375700-SP101\Cumberland_City_Civic_Center_Renovations\2_Design\Drawings\375700-SP101_S0800.dwg dbr/represent

SINK COMBS DETHLEFS

Copyright © 2013
 475 Lincoln Street, Suite 110
 Durham, Colorado 80202

- UTILITY NOTES:**
- SEE NOTES E1 THROUGH U8 ON SHEET 01006 FOR ADDITIONAL UTILITY INFORMATION.
 - ALL TRENCH EXCAVATION AND BACKFILL FOR ELECTRICAL SYSTEMS SHALL BE BY THE SITE CONTRACTOR. CONDUIT, PULL BOXES, RISER POLES, LIGHT BASES, ETC. SHALL BE SUPPLIED AND INSTALLED BY THE ELECTRICAL CONTRACTOR. LIGHT POLES SHALL BE PROVIDED AND INSTALLED BY CMP.
 - SITE CONTRACTOR TO FIELD VERIFY ALL EXISTING UTILITIES PRIOR TO BEGINNING ANY PROPOSED WORK.
 - PROVIDE 4" MIN. RIGID INSULATION BETWEEN WATER LINE AND SANITARY SEWER LINE. EXTEND 8" IN ALL DIRECTIONS WHERE THEY CROSS.
 - DOMESTIC WATER DISTRIBUTION AND FIRE SUPPRESSION PIPING AND APPURTENANCES SHALL BE SUPPLIED AND INSTALLED BY SITE CONTRACTOR. ALL EXCAVATION AND BACKFILL REQUIRED FOR ANY PART OF THE WATER SUPPLY SYSTEM AND FIRE SUPPRESSION PIPING SHALL BE BY THE SITE CONTRACTOR. COORDINATE INSTALLATION OF PIPING WITH THE PLUMBING AND MECHANICAL CONTRACTORS. PIPING FOR NEW BUILDING SHALL BE SUPPLIED AND INSTALLED BY THE PLUMBING CONTRACTOR FROM THE BUILDING TO A COORDINATED POINT LOCATED 10' FROM THE BUILDING PENETRATION.
 - ALL NEW CATCH BASINS THAT DISCHARGE INTO THE CITY OF PORTLAND'S MUNICIPAL SYSTEM SHALL HAVE A 3' SUMP.
 - THE PROPOSED SIZE OF THE GREASE TRAP SHALL BE APPROVED BY PUBLIC SERVICES DEPARTMENT PRIOR TO INSTALLATION. (STEPHEN HARRIS 874-8943)
 - ALL PROPOSED SEWER MANHOLES SHALL MEET THE REQUIREMENTS OF SECTION II OF THE CITY OF PORTLAND'S TECHNICAL MANUAL AND CHANNEL CONFIGURATION SHALL BE APPROVED PRIOR TO AND AFTER CONSTRUCTION BY THE WASTEWATER COORDINATOR. (JOHN EMERSON 318-0239)
 - REFER TO DETAIL N11 C506 FOR CONCRETE STRUCTURE SCHEDULE.
 - SEE SHEETS PH100 AND PH101 FOR PHASING OF CONSTRUCTION.
 - ALL TEST PITS SHALL BE CONDUCTED PRIOR TO ORDERING ANY STRUCTURES OR PIPE. PROVIDE ALL TEST PIT ELEVATIONS TO THE ENGINEER FOR INVERT ELEVATION VERIFICATION.
 - REMOVE AND RESET EXISTING FRAMES AND GRATES AS NECESSARY TO MATCH PROPOSED GRADES AND CURB LINE.
 - SEE SHEET CU302 AND SHEET CU303 FOR UTILITY PLAN AND PROFILES.
 - CONTRACTOR SHALL COORDINATE W/CM FOR SITE LIGHTING CONNECTION POINTS. CONTRACTOR SHALL ASSUME CONNECTION POINT IS 250 FEET FROM LAST POLE IN CIRCUIT.

LEGEND

EXISTING	PROPOSED
STREET LIGHTING	STREET LIGHTING
WATER SHUTOFF / GATE VALVE	WATER SHUTOFF / GATE VALVE
ELECTRIC COMM. MANHOLE	ELECTRIC COMM. MANHOLE
PARKING METER	PARKING METER
MANHOLE	MANHOLE
SEWER MANHOLE	SEWER MANHOLE
GAS SHUTOFF	GAS SHUTOFF
CATCH BASIN	CATCH BASIN
FIRE HYDRANT	FIRE HYDRANT
SIGN	SIGN
PAVEMENT	PAVEMENT
SEWALK	SEWALK
CP CONCRETE RETAINING WALL	CP CONCRETE RETAINING WALL
GAS SERVICE / MAIN	GAS SERVICE / MAIN
WATER SERVICE / MAIN	WATER SERVICE / MAIN
STORM DRAIN	STORM DRAIN
FOOTING DRAIN	FOOTING DRAIN
CLEANOUT	CLEANOUT
SANITARY SEWER	SANITARY SEWER
UNDERGROUND SECONDARY	UNDERGROUND SECONDARY
UNDERGROUND PRIMARY	UNDERGROUND PRIMARY
UNDERGROUND ELECTRIC	UNDERGROUND ELECTRIC
UNDERGROUND TRAFFIC CONDUIT	UNDERGROUND TRAFFIC CONDUIT
UNDERGROUND FIRE ALARM	UNDERGROUND FIRE ALARM
UNDERGROUND TEL. COM.	UNDERGROUND TEL. COM.
PROPERTY LINE	PROPERTY LINE
ABUTTING PROPERTY LINE	ABUTTING PROPERTY LINE

REV.	DESCRIPTION	DATE
11	SPRING STREET DESIGN DEVELOPMENT	08-16-2013
	RFR446	08-02-2013 (R)
	RFR427	07-18-2013 (R)
	SM080	05-07-2013 (R)
	SM044	02-27-2013 (R)
6	CONSTRUCTION DOCUMENTS	01-31-2013
5	NW ENTRY CONSTRUCTION DOCS	10-31-2012
4	PHASE 2 DESIGN DEVELOPMENT	10-26-2012
	ADDENDUM #2	08-21-2012
2	NW ENTRY F.S.E CON DOCS	08-23-2012
	ADDENDUM #1	08-09-12

SPRING STREET DESIGN DEVELOPMENT
 08.16.2013

NOT FOR CONSTRUCTION

WBRC ARCHITECTS • ENGINEERS
 WWW.WBRCAE.COM
 BANGOR, MAINE 207-947-4300
 ROCKLAND, MAINE 207-582-4000
 SARASOTA, FLORIDA 941-375-2800

CUMBERLAND COUNTY CIVIC CENTER RENOVATION
 PROJECT: PORTLAND, MAINE

SITE UTILITY PLAN

SHEET TITLE:	375700-SP101-SIB00.DWG
WBRC CAD FILE:	3757.00
PROJECT NO.:	3757.00
SCALE:	1"=20'
PROJECT MANAGER:	MEJ
DRAWN BY:	JWB
CHECKED BY:	ARB/SJL
SHEET NO.:	CU101

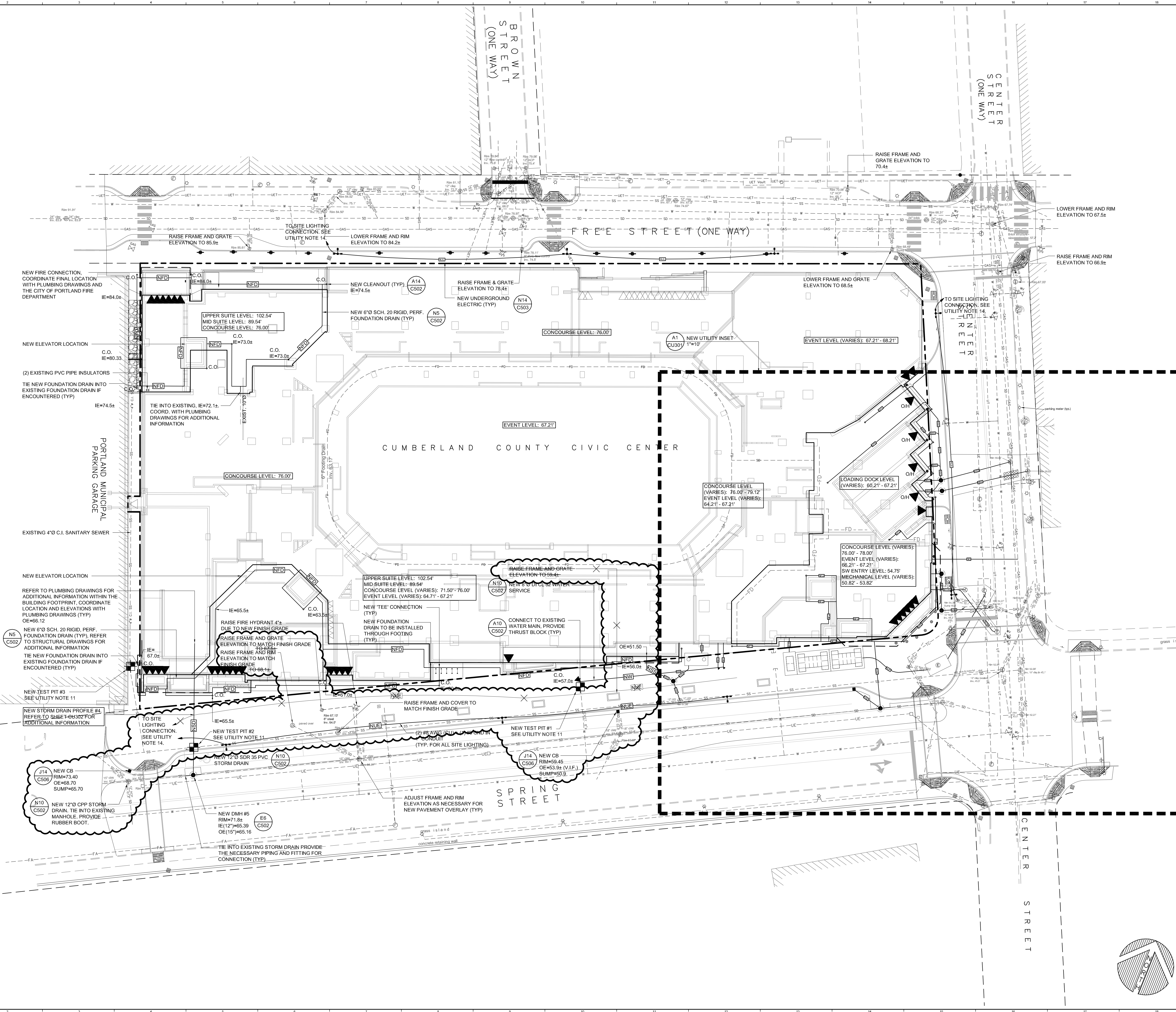

Aug 16, 2013 9:45am
 I:\375700-SP101\Cumberland_Civ_Center_Renov\Drawings\Site\375700-SP101_SIB00.dwg dbr@wbrc.com

SINK COMBS DETHLEFS

Copyright © Sink Combs Dethlefs
475 Lincoln Street, Suite 110, Denver, Colorado 80202
303.308.0200
FAX 303.502.2222

- UTILITY NOTES:**
- SEE NOTES E1 THROUGH U8 ON SHEET CU300 FOR ADDITIONAL UTILITY INFORMATION.
 - ALL TRENCH EXCAVATION AND BACKFILL FOR ELECTRICAL SYSTEMS SHALL BE BY THE SITE CONTRACTOR. CONDUIT, PULL BOXES, RISER POLES, LIGHT BASES, ETC. SHALL BE SUPPLIED AND INSTALLED BY THE ELECTRICAL CONTRACTOR. LIGHT BASES TO BE SET BY THE SITE CONTRACTOR.
 - SITE CONTRACTOR TO FIELD VERIFY ALL EXISTING UTILITIES PRIOR TO BEGINNING ANY PROPOSED WORK.
 - PROVIDE 4" MIN. RIGID INSULATION BETWEEN WATER LINE AND SANITARY SEWER LINE. EXTEND 8' IN ALL DIRECTIONS WHERE THEY CROSS.
 - DOMESTIC WATER DISTRIBUTION AND FIRE SUPPRESSION PIPING AND APPURTENANCES SHALL BE SUPPLIED AND INSTALLED BY SITE CONTRACTOR. ALL EXCAVATION AND BACKFILL REQUIRED FOR ANY PART OF THE WATER SUPPLY SYSTEM AND FIRE SUPPRESSION PIPING SHALL BE BY THE SITE CONTRACTOR. COORDINATE INSTALLATION OF PIPING WITH THE PLUMBING AND MECHANICAL CONTRACTORS. PIPING FOR NEW BUILDING SHALL BE SUPPLIED AND INSTALLED BY THE PLUMBING CONTRACTOR FROM THE BUILDING TO A COORDINATED POINT LOCATED 10' FROM THE BUILDING PENETRATION.
 - ALL NEW CATCH BASINS THAT DISCHARGE INTO THE CITY OF PORTLAND'S MUNICIPAL SYSTEM SHALL HAVE A 3' BUMP.
 - THE PROPOSED SIZE OF THE GREASE TRAP SHALL BE APPROVED BY PUBLIC SERVICES DEPARTMENT PRIOR TO INSTALLATION. (STEPHEN HARRIS 874-8843)
 - ALL PROPOSED SEWER MANHOLES SHALL MEET THE REQUIREMENTS OF SECTION II OF THE CITY OF PORTLAND'S TECHNICAL MANUAL AND CHANNEL CONFIGURATION SHALL BE APPROVED PRIOR TO AND AFTER CONSTRUCTION BY THE WASTEWATER COORDINATOR. (JOHN EMERSON 318-0239)
 - REFER TO DETAIL N11 C506 FOR CONCRETE STRUCTURE SCHEDULE.
 - SEE SHEETS PH100 AND PH101 FOR PHASING OF CONSTRUCTION.
 - ALL TEST PITS SHALL BE CONDUCTED PRIOR TO ORDERING ANY STRUCTURES OR PIPE. PROVIDE ALL TEST PIT ELEVATIONS TO THE ENGINEER FOR INVERT ELEVATION VERIFICATION.
 - REMOVE AND RESET EXISTING FRAMES AND GRATES AS NECESSARY TO MATCH PROPOSED GRADES AND CURB LINE.
 - SEE SHEET CU302 AND SHEET CU303 FOR UTILITY PLAN AND PROFILES.
 - CONTACT CENTRAL MAINE POWER COMPANY FOR TRANSFORMER VAULT CONTRACT DRAWINGS.

EXISTING		LEGEND		PROPOSED	
⊙	STREET LIGHTING	⊙	WATER SHUTOFF / GATE VALVE	⊙	NEW STREET LIGHTING
⊙	ELECTRIC COMM. MANHOLE	⊙	PARKING METER	⊙	NEW WATER SERVICE / MAIN
⊙	SEWER MANHOLE	⊙	MANHOLE	⊙	NEW STORM DRAIN
⊙	GAS SHUTOFF	⊙	CATCH BASIN	⊙	NEW FOOTING DRAIN
⊙	FIRE HYDRANT	⊙	NEW FIRE HYDRANT	⊙	NEW SANITARY SEWER
⊙	SON	⊙	NEW SON	⊙	NEW UNDERGROUND SECONDARY
⊙	PAVEMENT	⊙	NEW PAVEMENT	⊙	NEW UNDERGROUND PRIMARY
⊙	SIDEWALK	⊙	NEW SIDEWALK	⊙	NEW UNDERGROUND ELECTRIC
⊙	CONCRETE RETAINING WALL	⊙	NEW CONCRETE RETAINING WALL	⊙	NEW UNDERGROUND TRAFFIC CONDUIT
⊙	GAS SERVICE / MAIN	⊙	NEW GAS SERVICE / MAIN	⊙	NEW UNDERGROUND FIRE ALARM
⊙	WATER SERVICE / MAIN	⊙	NEW WATER SERVICE / MAIN	⊙	NEW UNDERGROUND TEL. COM.
⊙	STORM DRAIN	⊙	NEW STORM DRAIN	⊙	PROPERTY LINE
⊙	FOOTING DRAIN	⊙	NEW FOOTING DRAIN	⊙	ABUTTING PROPERTY LINE
⊙	NEW SANITARY SEWER	⊙	NEW SANITARY SEWER		
⊙	NEW UNDERGROUND SECONDARY	⊙	NEW UNDERGROUND SECONDARY		
⊙	NEW UNDERGROUND PRIMARY	⊙	NEW UNDERGROUND PRIMARY		
⊙	NEW UNDERGROUND ELECTRIC	⊙	NEW UNDERGROUND ELECTRIC		
⊙	NEW UNDERGROUND TRAFFIC CONDUIT	⊙	NEW UNDERGROUND TRAFFIC CONDUIT		
⊙	NEW UNDERGROUND FIRE ALARM	⊙	NEW UNDERGROUND FIRE ALARM		
⊙	NEW UNDERGROUND TEL. COM.	⊙	NEW UNDERGROUND TEL. COM.		
⊙	PROPERTY LINE	⊙	NEW PROPERTY LINE		
⊙	ABUTTING PROPERTY LINE	⊙	NEW ABUTTING PROPERTY LINE		

REV.	DESCRIPTION	DATE
9	SPRING STREET DESIGN DEVELOPMENT	08-16-2013
8	RFR#446	08.02.13 (R)
7	RFR#427	07.18.13 (R)
6	RFR#416	07.01.13 (R)
5	CONSTRUCTION DOCUMENTS	01-21-2013
4	NW ENTRY CONSTRUCTION DOCS	10-31-2012
3	PHASE 2 DESIGN DEVELOPMENT	10-26-2012
2	NW ENTRY F.S.E. CON DOCS	08-23-2012
1	ADDENDUM #1	08.09.12 (R)

SPRING STREET DESIGN DEVELOPMENT
08.16.2013
CURRENT ISSUE STATUS:

NOT FOR CONSTRUCTION

WBRC ARCHITECTS • ENGINEERS
WWW.WBRC.COM
BANDOLIER, MAINE 207-947-4318
ROCKLAND, MAINE 207-429-4242
SARASOTA, FLORIDA 941-375-2862

CUMBERLAND COUNTY CIVIC CENTER RENOVATION
PROJECT: PORTLAND, MAINE

SITE LARGE SCALE UTILITY PLAN

SHEET TITLE:	375700-CU301.DWG
WBRC CAD FILE:	3757.00
PROJECT NO.:	3757.00
SCALE:	1"=10'
PROJECT MANAGER:	MEJ
DRAWN BY:	TAR
CHECKED BY:	ARB/SJL
SHEET NO.:	CU301

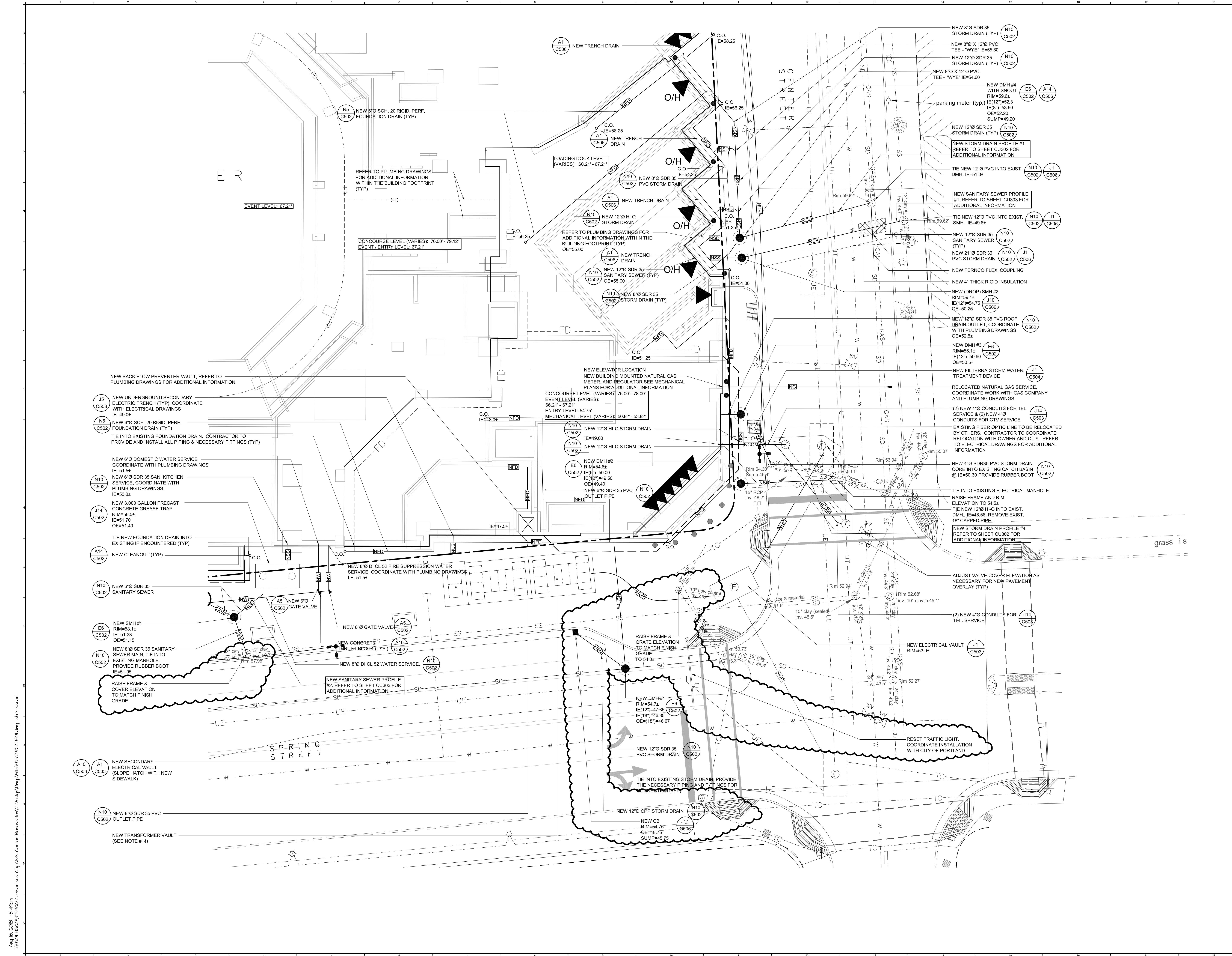

Aug 16, 2013 8:48am
 I:\375700-CU301\C301\C301.dwg
 User: arbor
 Plot: 375700-CU301.dwg

STORMWATER/SANITARY SEWER CONCRETE STRUCTURE SCHEDULE					
STRUCTURE NO.	6' DIA.	4' DIA.	TYPE 'F'	GRATE/LID	COMMENTS
DMH#1		X		SOLID COVER	
DMH#2		X		SOLID COVER	
DMH#3		X		SOLID COVER	
DMH#4		X		SOLID COVER	
DMH#5		X		SOLID COVER	
SMH#1		X		SOLID COVER	
SMH#2		X		SOLID COVER	

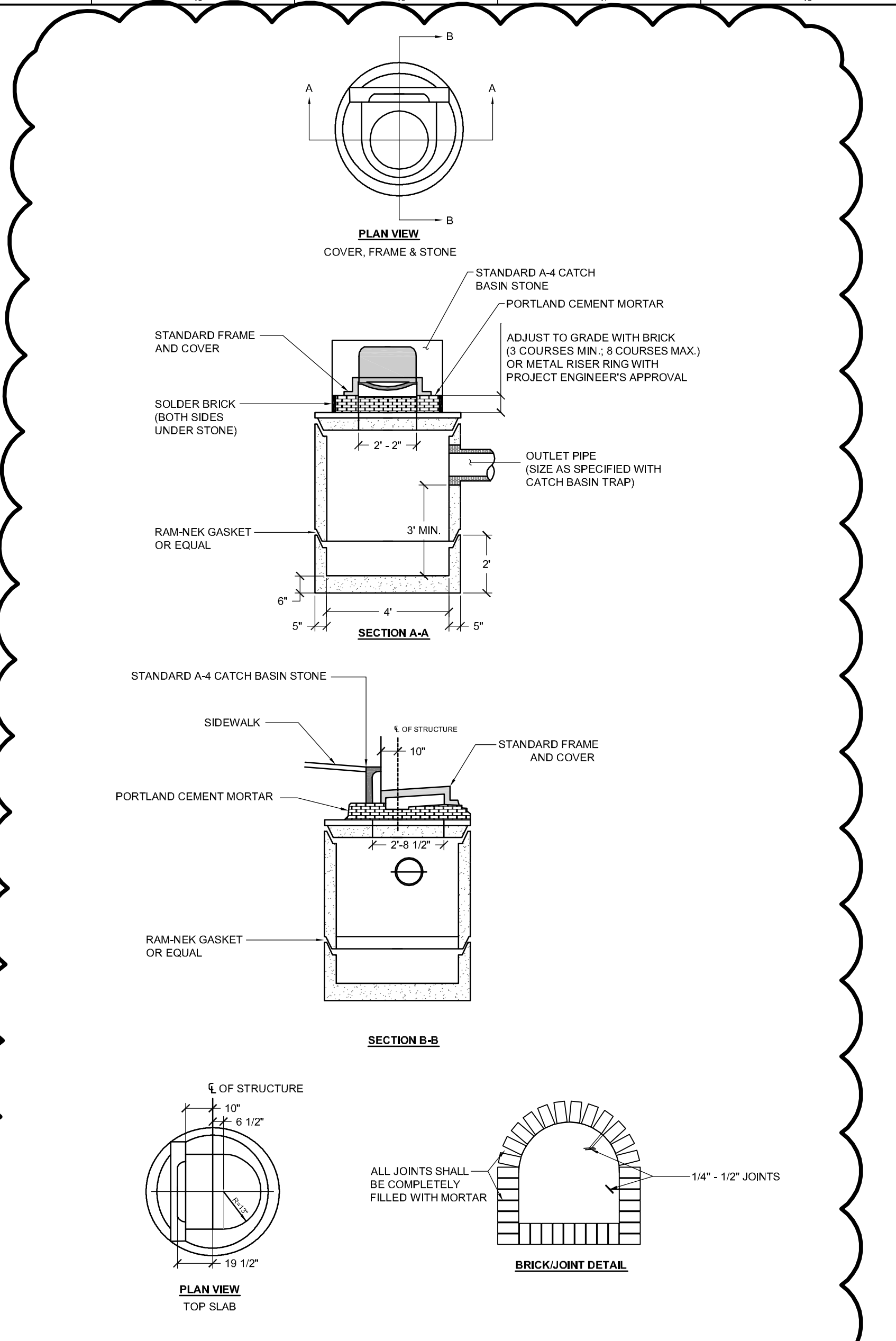
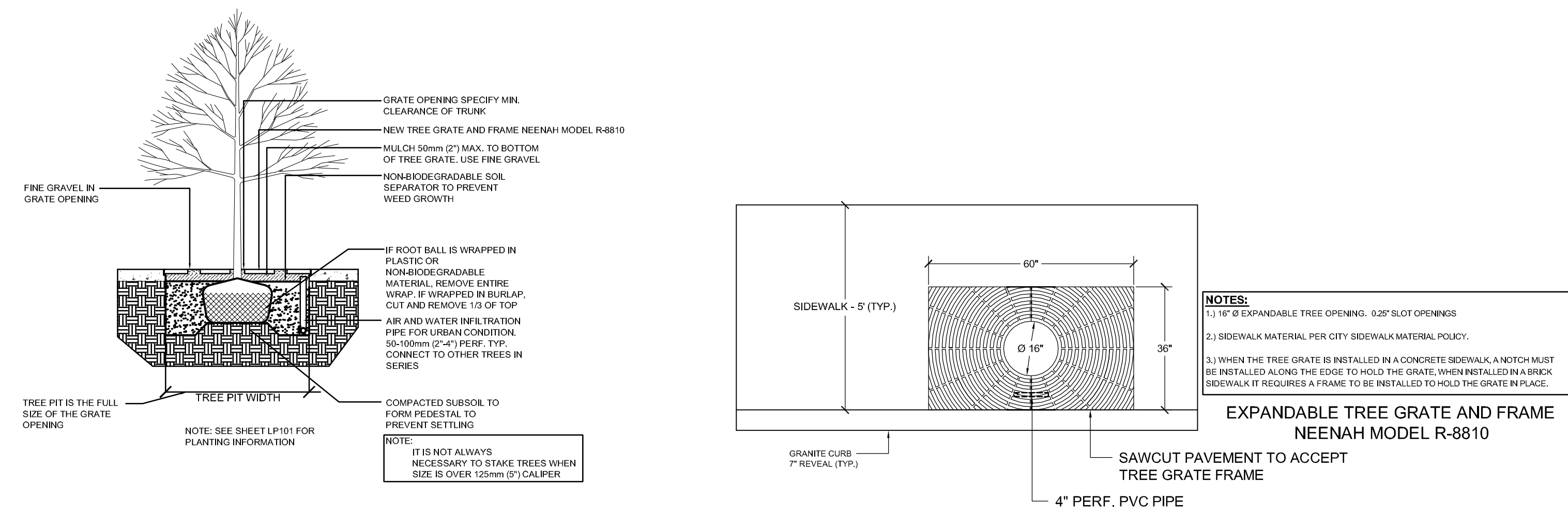

SINK COMBS DETHLEFS
 Copyright
 Sink Combs
 Durham, N.C.
 475 Lincoln Street
 Suite 110
 Denver, Colorado 80202
 303.308.0300
 FAX 303.5522

N1 STRUCTURE SCHEDULE

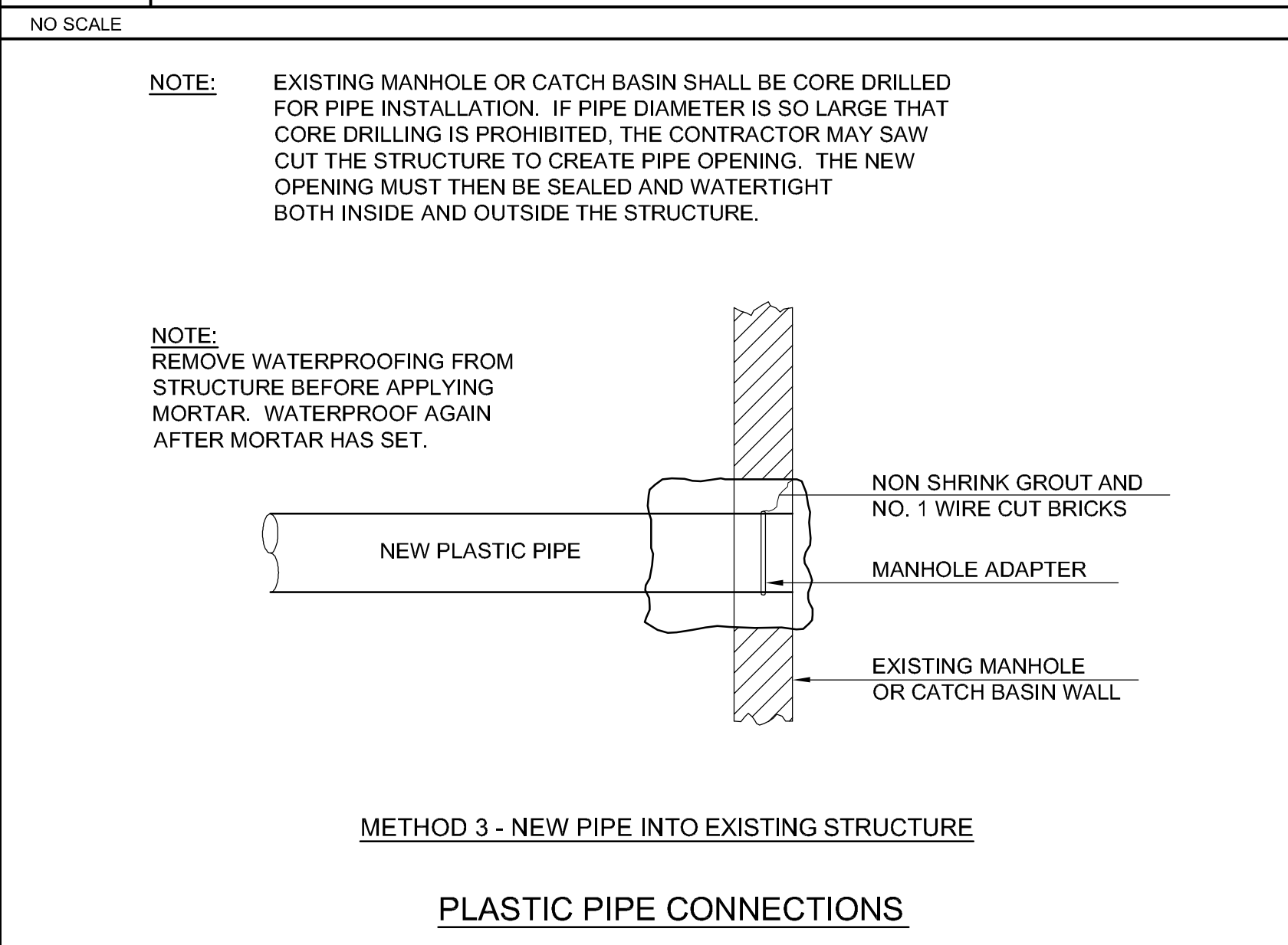

N5 NEW TREE GRATE

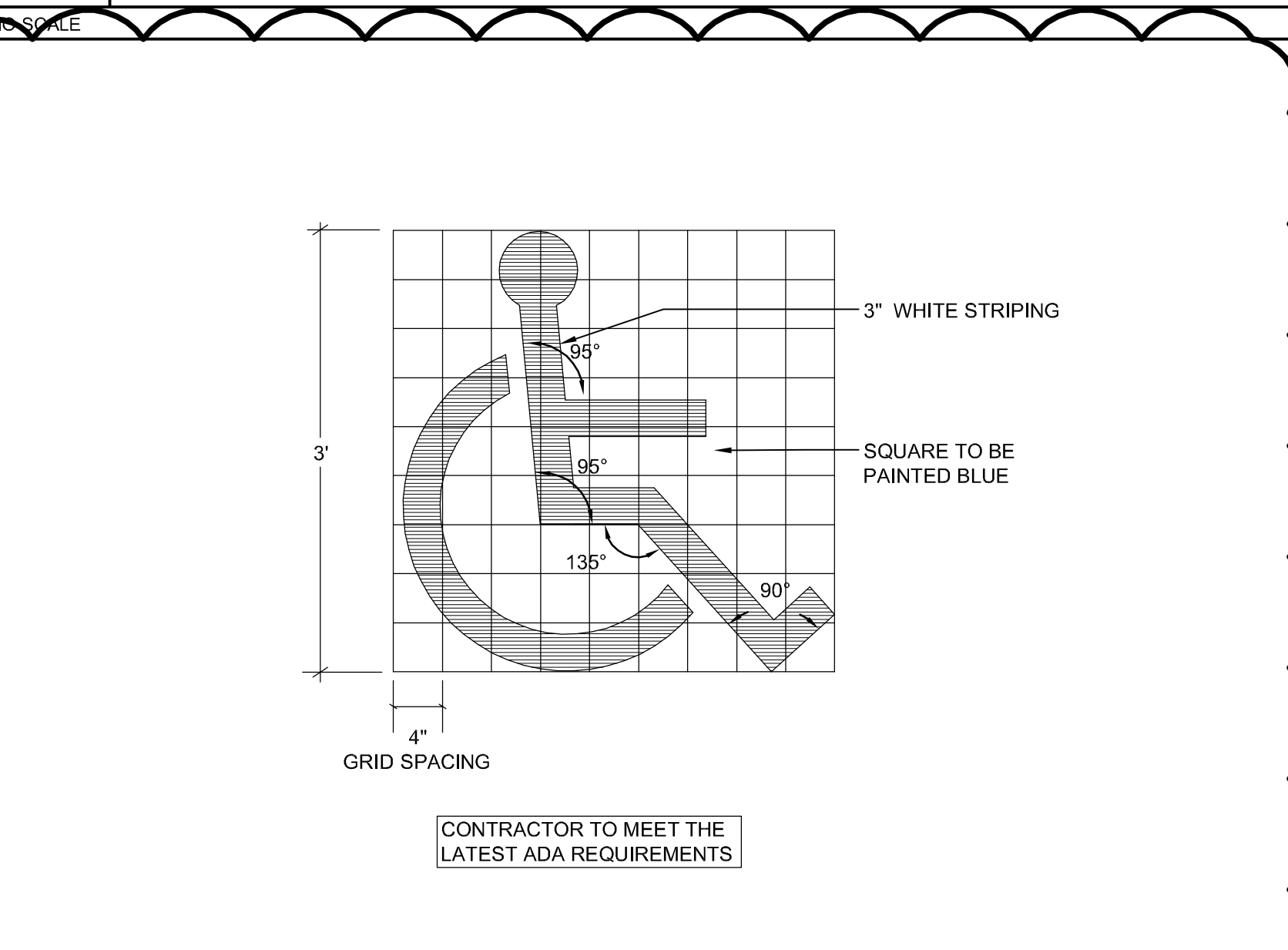

J10 TYPICAL OUTSIDE DROP MANHOLE

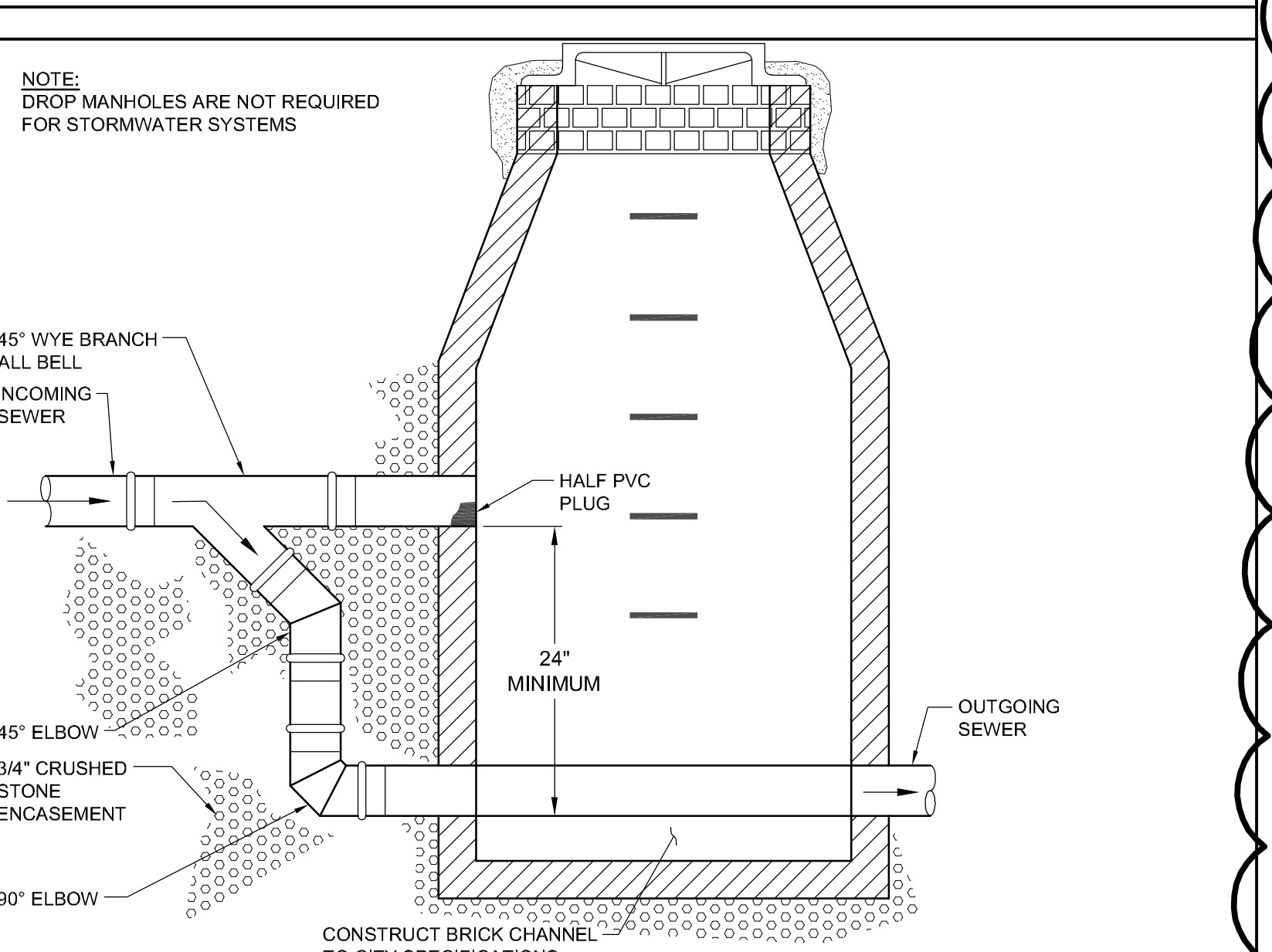

J14 NEW CATCH BASIN

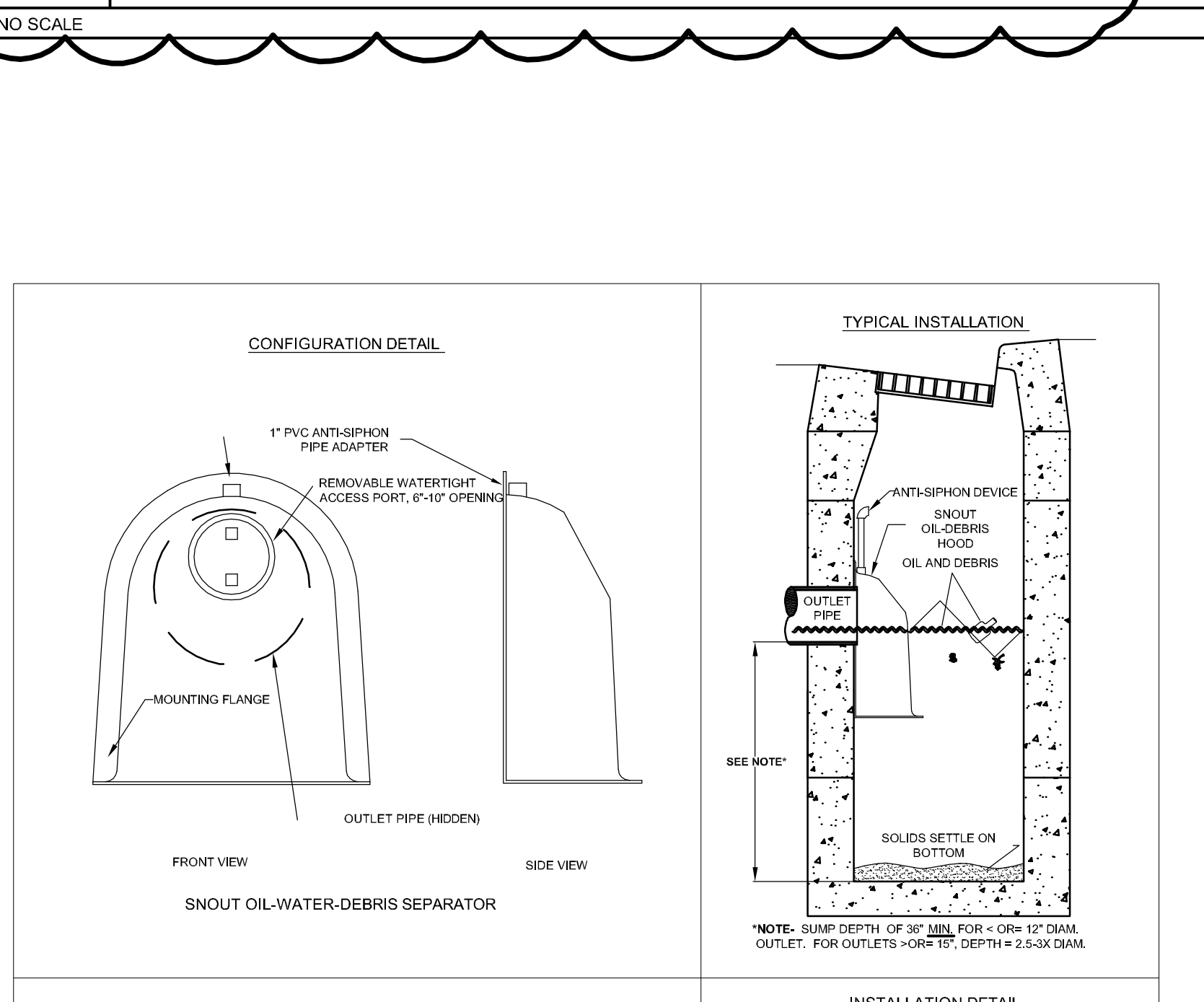

6	SPRING STREET DESIGN DEVELOPMENT	08-16-2013
5	CONSTRUCTION DOCUMENTS	01-21-2013
4	NW ENTRY CONSTRUCTION DOCS	10-31-2012
3	PHASE 2 DESIGN DEVELOPMENT	10-26-2012
2	NW ENTRY F.S.E CON DOCS	08-23-2012
1	ADDENDUM #1	08.09.12 (R)
REV.	DESCRIPTION	DATE

SPRING STREET DESIGN DEVELOPMENT
 08.16.2013
 CURRENT ISSUE STATUS:

J1 METHOD 3 - NEW PIPE INTO EXISTING STRUCTURE

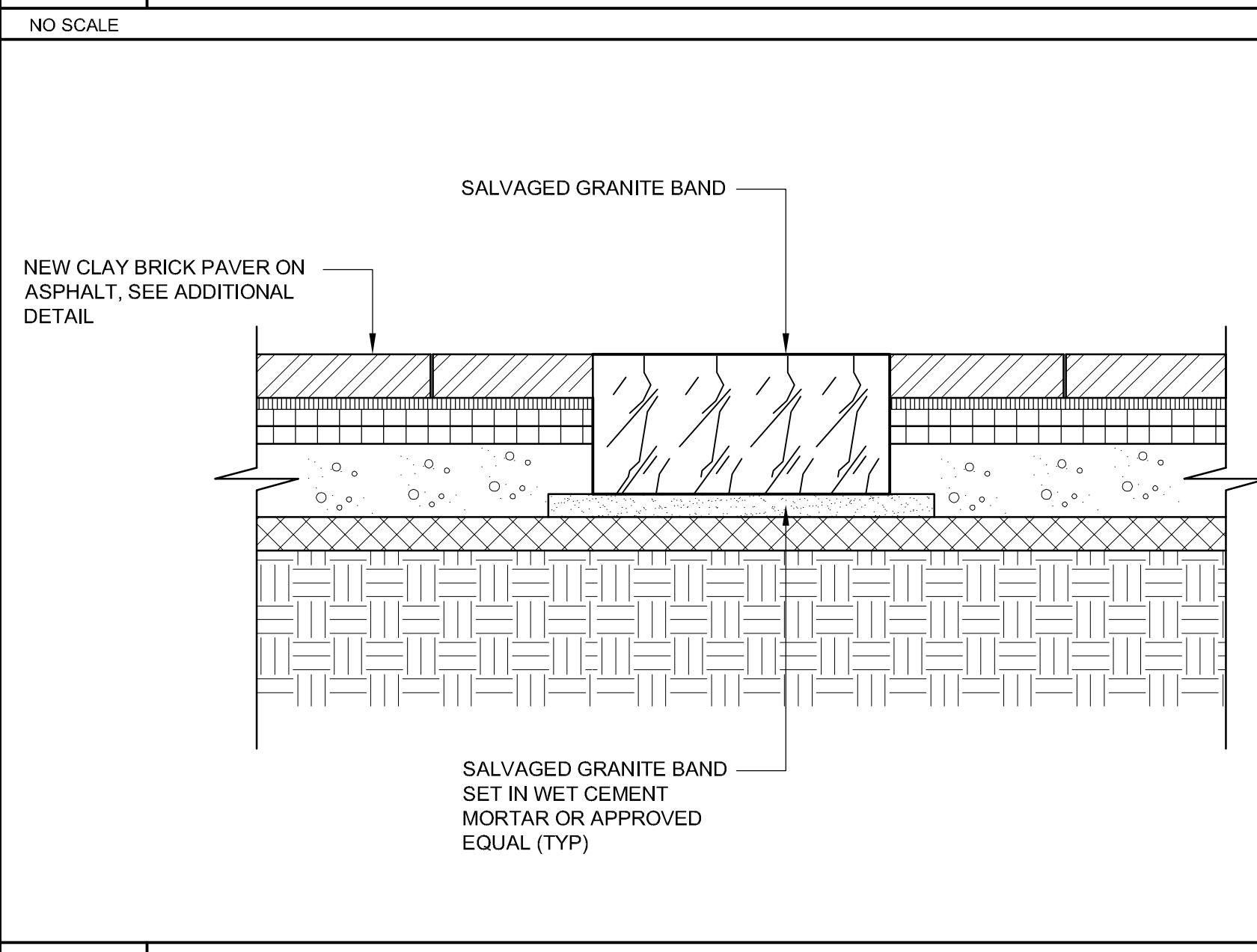

J5 NEW HANDICAP PAVEMENT MARKING

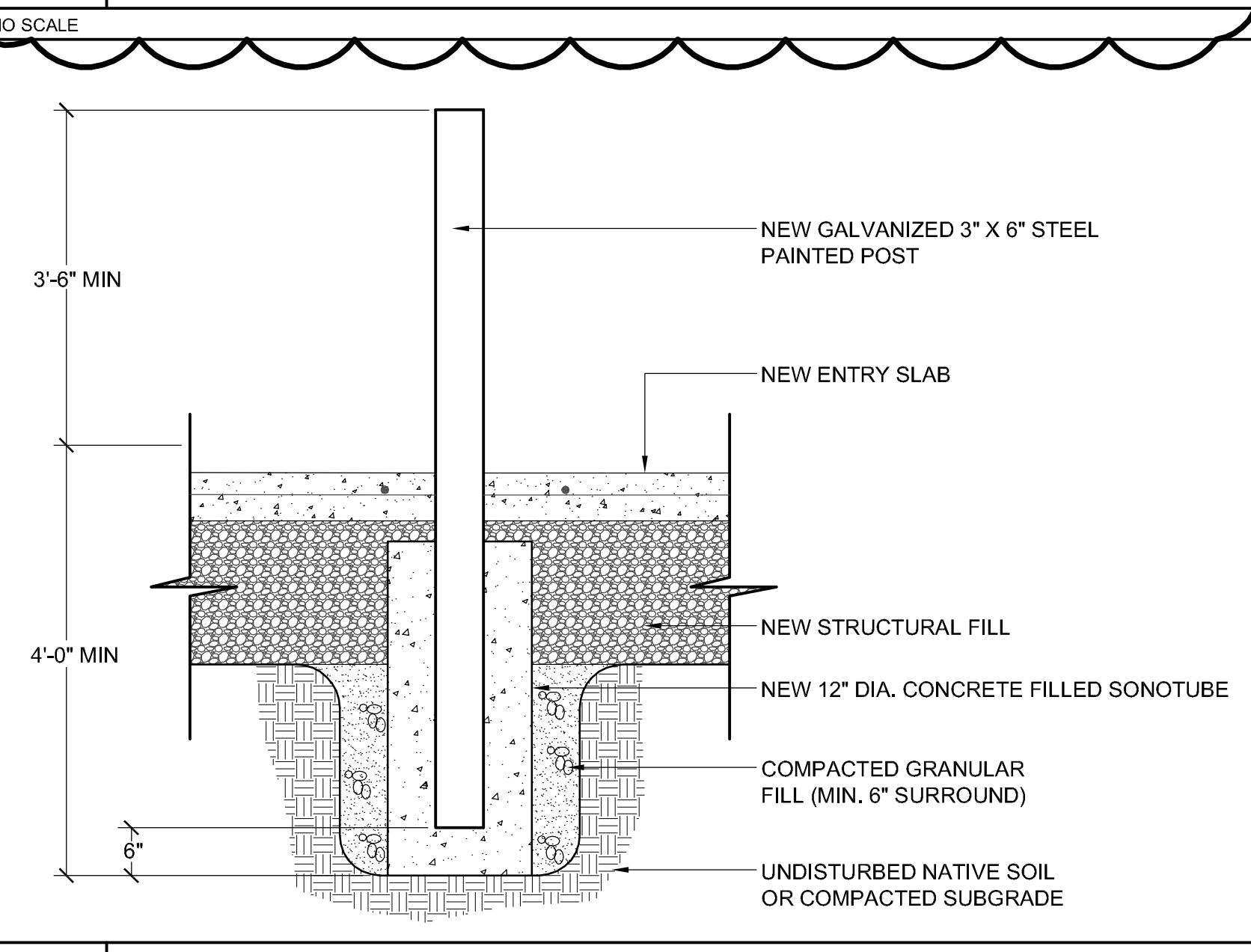

E10 NEW CIP CONCRETE PAD

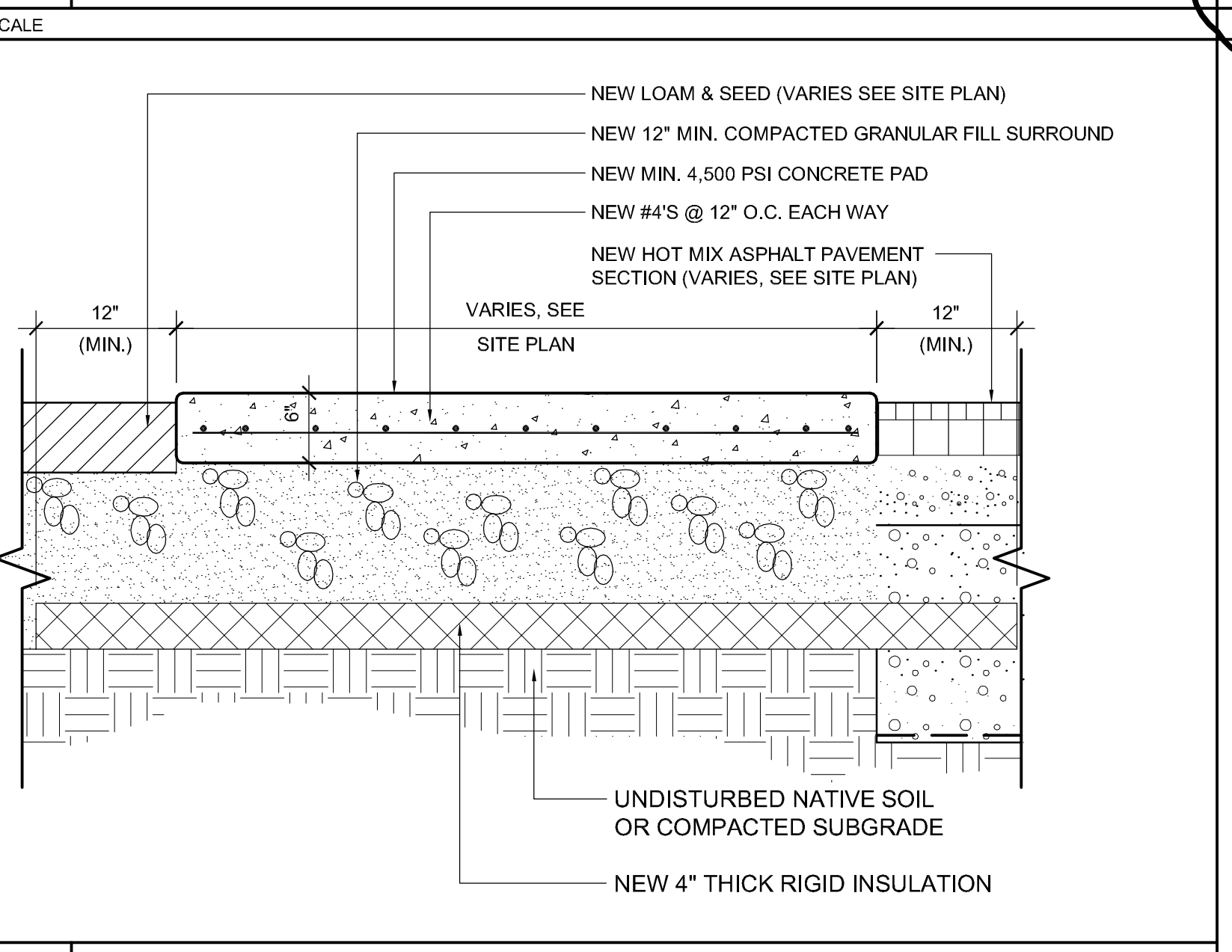

E1 SALVAGED GRANITE SIDEWALK BAND

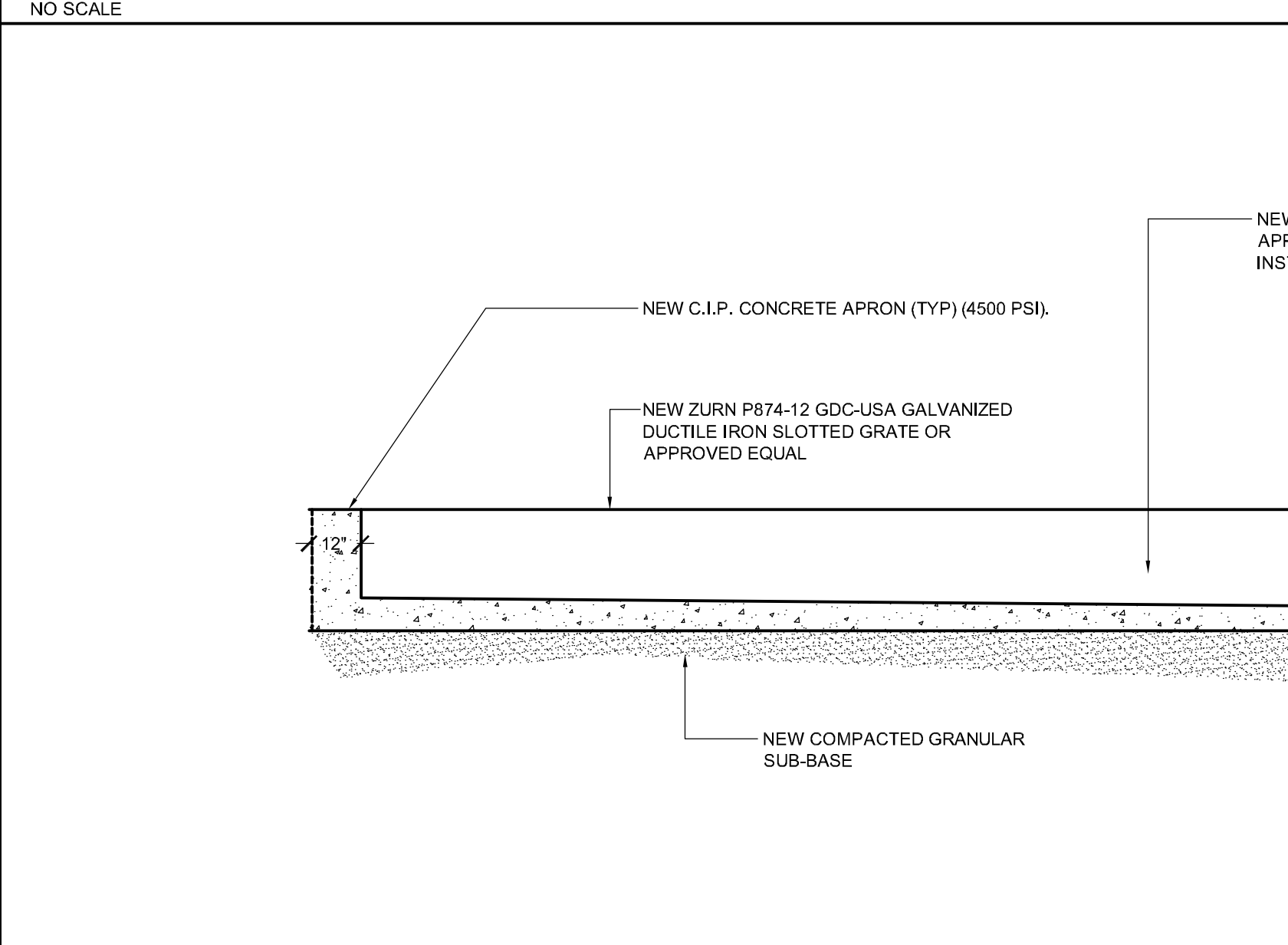

E5 NEW ADA ACCESS PEDESTAL

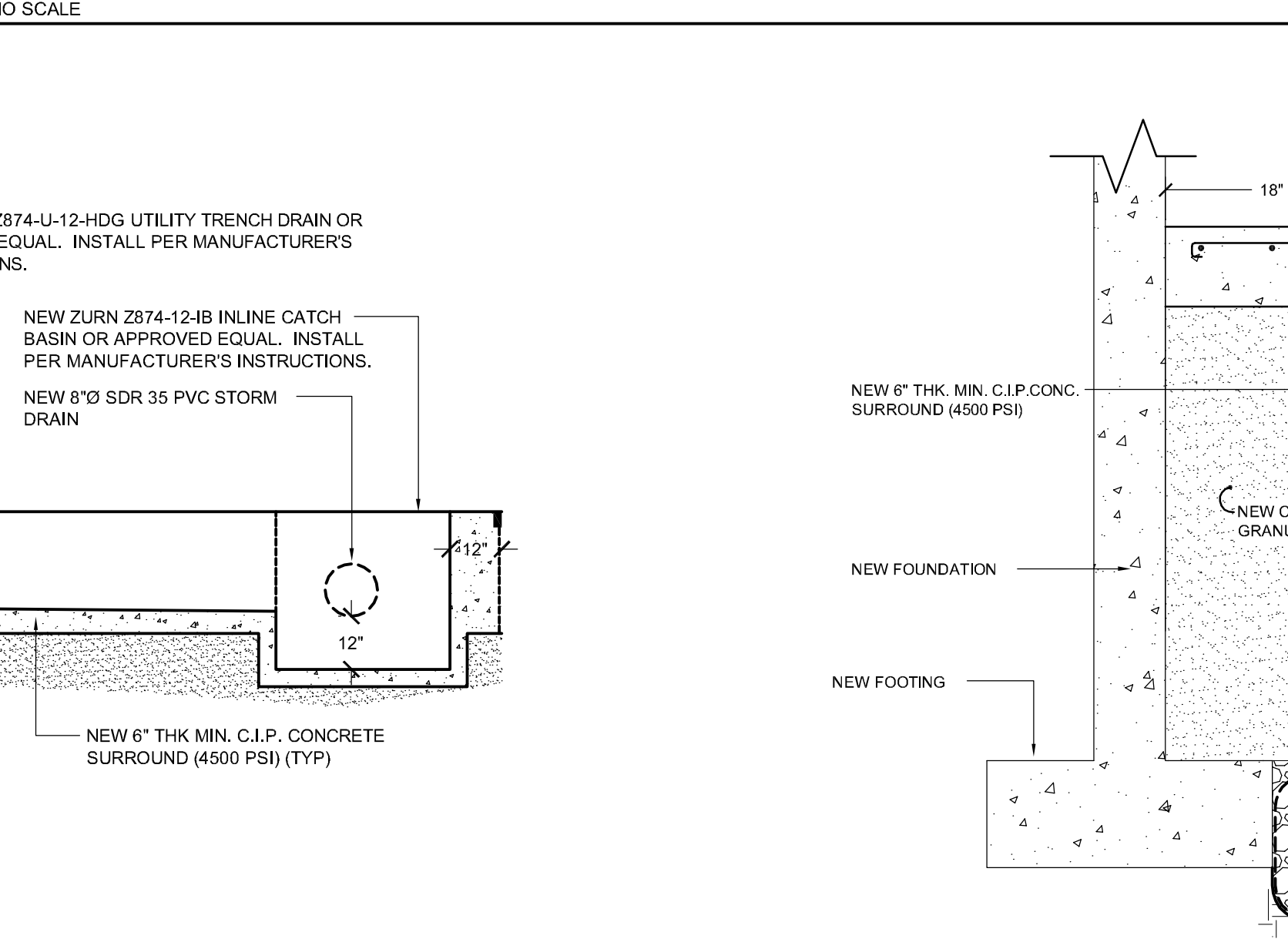

E10 NEW CIP CONCRETE PAD

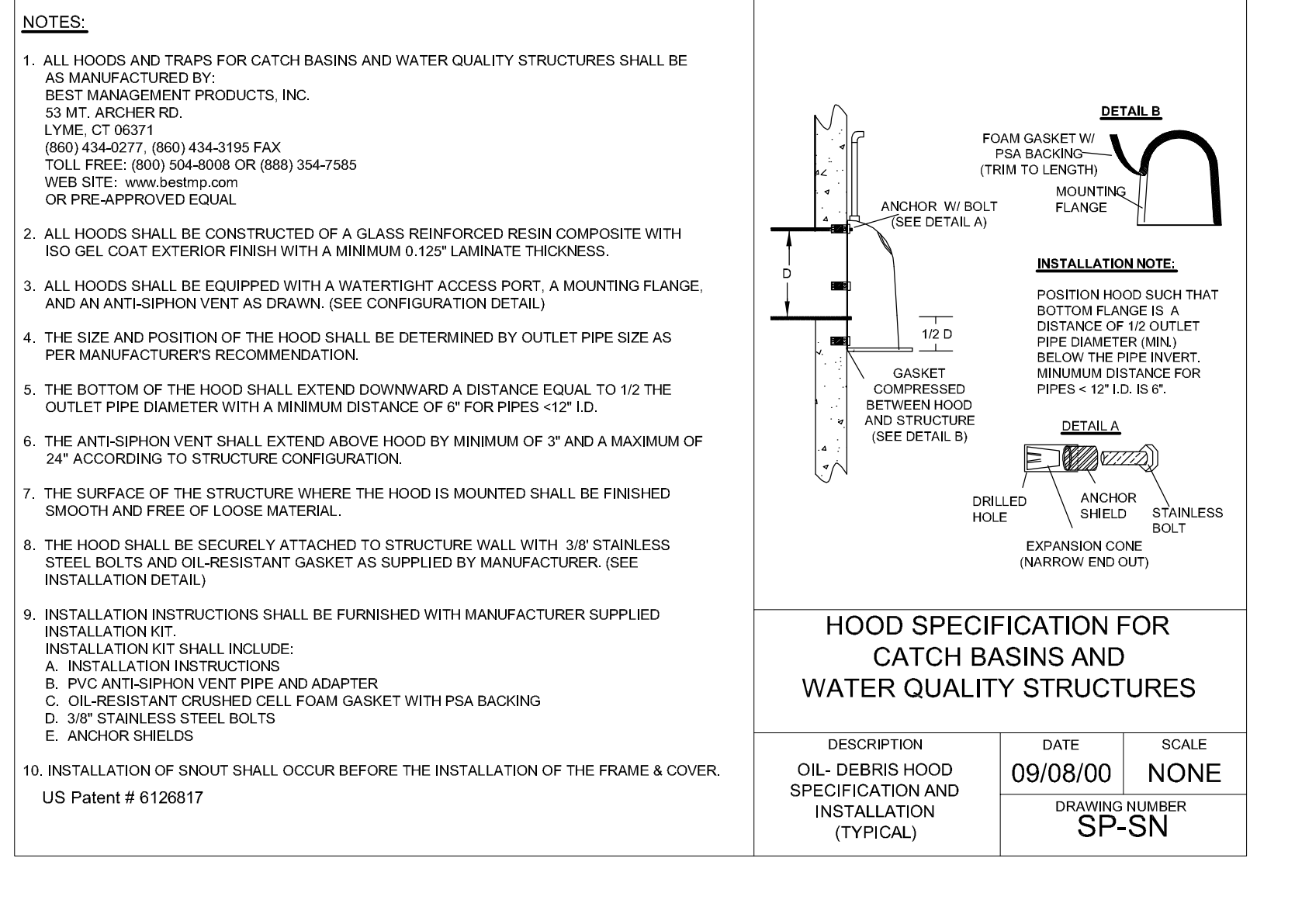
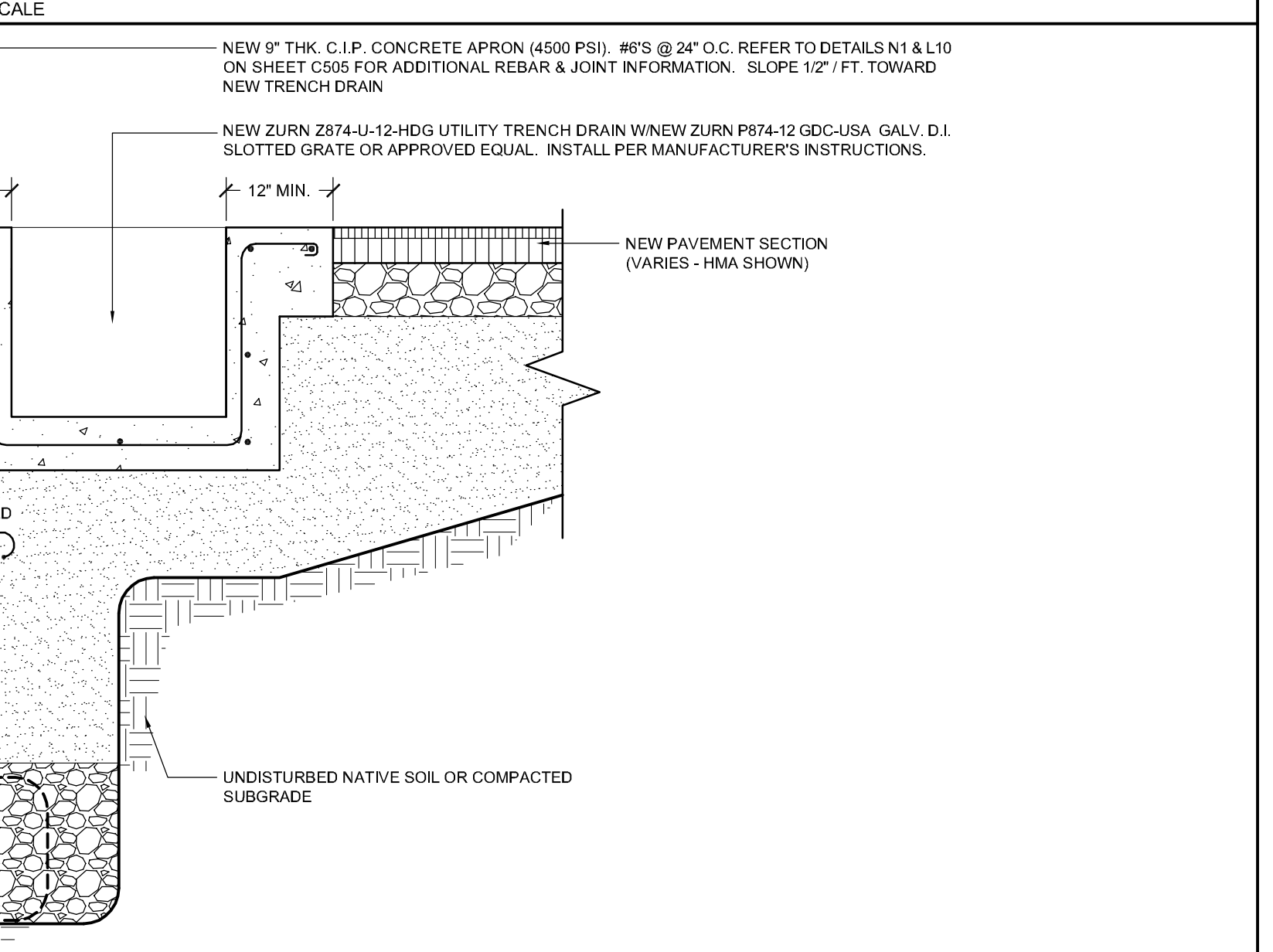

A1 NEW TRENCH DRAIN

NO SCALE

A14 NEW SNOUT

NO SCALE

C506

Aug 16, 2016 8:52am
 I:\315-350-375700\Cumberland_Civ_Ctr_Cen_Renov\Drawings\375700-C501.dwg chrp.dwg