

SINK COMBS DETAILERS

CONTRACT NO. 15-000000
 PROJECT NO. 15-000000
 SHEET NO. E3.22B

TECHNICAL NOTES:

- 1. VERIFY ALL DIMENSIONS AND LOCATIONS TO SCHEDULE.
- 2. VERIFY ALL DIMENSIONS AND LOCATIONS TO FACE OF FINISH MATERIAL.
- 3. VERIFY ALL DIMENSIONS AND LOCATIONS TO FACE OF FINISH MATERIAL.
- 4. VERIFY ALL DIMENSIONS AND LOCATIONS TO FACE OF FINISH MATERIAL.
- 5. VERIFY ALL DIMENSIONS AND LOCATIONS TO FACE OF FINISH MATERIAL.
- 6. VERIFY ALL DIMENSIONS AND LOCATIONS TO FACE OF FINISH MATERIAL.
- 7. VERIFY ALL DIMENSIONS AND LOCATIONS TO FACE OF FINISH MATERIAL.
- 8. VERIFY ALL DIMENSIONS AND LOCATIONS TO FACE OF FINISH MATERIAL.
- 9. VERIFY ALL DIMENSIONS AND LOCATIONS TO FACE OF FINISH MATERIAL.
- 10. VERIFY ALL DIMENSIONS AND LOCATIONS TO FACE OF FINISH MATERIAL.

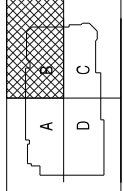

REV.	DESCRIPTION	DATE
1	FOR CONSTRUCTION DOCUMENTS	01-21-2013

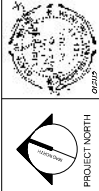

CUMBERLAND COUNTY CIVIC CENTER RENOVATION
 PORTLAND, ME

CONCOURSE LEVEL
 SYSTEMS PLAN - QUAD B

DATE PLOTTED: 01/21/2013	SCALE: 1/8" = 1'-0"	SHEET NO.: E3.22B
PROJECT NO.: 15-000000	DRAWN BY: JMB	CHECKED BY: JMB
DATE: 01/21/2013	TIME: 10:00 AM	PLotted by: JMB

