

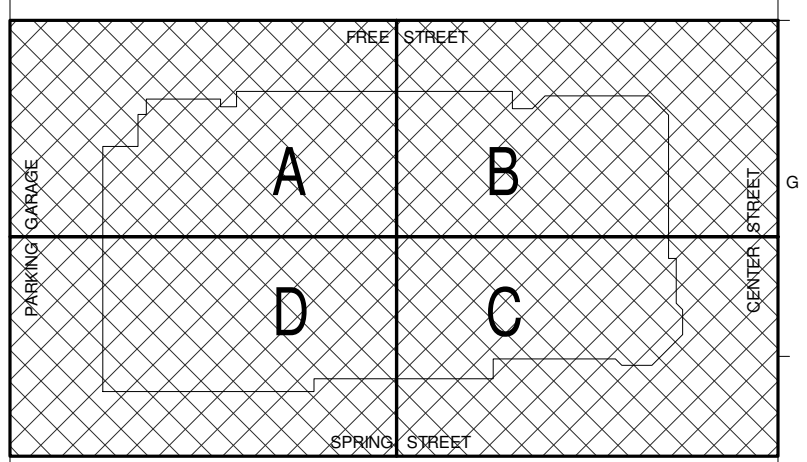

MECHANICAL LEVEL EXITING PLAN - CENTER STAGE CONDITION
1/16" = 1'-0"

COORDINATED LOCATIONS OF EXISTING AND NEW FIRE EXTINGUISHERS AND FIRE EXTINGUISHER CABINETS.
UPDATED EGRESS BASED ON NEW STAIR ADDITION AT SE CORNER (SI #060).



- FIRE RATING PLAN NOTES**
- REFER TO BUILDING CODE REPORT PREPARED BY FP&C CONSULTANTS INC. LOCATED IN THE PROJECT MANUAL APPENDIX.
 - THE CODE ANALYSIS PLANS INDICATE GENERAL LOCATIONS OF FIRE RESISTIVE PARTITIONS AND SHAFTS. REFER TO THE ARCHITECTURAL FLOOR PLANS AND THE INTERIOR WALL TYPE SCHEDULE FOR SPECIFIC CONSTRUCTION REQUIREMENTS.
 - ALL HORIZONTAL AND/OR VERTICAL PENETRATIONS OF FIRE RESISTIVE ASSEMBLIES SHALL BE FIRE STOPPED TO PROVIDE THE SAME LEVEL OF FIRE RESISTANCE AS THE ASSEMBLY IN WHICH THEY OCCUR.
 - PUBLISHED INFORMATION FOR THESE ASSEMBLIES HAS BEEN REPRODUCED AND INCLUDED FOR REFERENCE.
 - ALL FIRE RESISTIVE CONSTRUCTION SHALL CONFORM TO THE APPLICABLE REQUIREMENTS OF THE REFERENCED FIRE RESISTIVE DESIGN ASSEMBLIES.
 - REFER TO A9.91 FOR THE FIRE RESISTIVE ASSEMBLIES.
 - REFER TO SMOKE CONTROL REPORT PREPARED BY FP&C CONSULTANTS INC. LOCATED IN THE PROJECT MANUAL APPENDIX.
 - EACH CONCESSION AND COMMISSARY WILL BE EQUIPPED WITH HAND HELD FIRE EXTINGUISHERS PROVIDED BY THE OWNER.

FIRE RATING PLAN LEGEND

	SMOKE SEPARATION
	1-HOUR FIRE RESISTIVE SEPARATION
	2-HOUR FIRE RESISTIVE SEPARATION
	2-HOUR FIRE RESISTIVE EXIT CONSTRUCTION
	2-HOUR FIRE-WRAP DUCT
	OCCUPANCY CLASSIFICATION FOR BUILDING AREA
	RATED SHAFTWALL CEILING PER IBC 208 EQUIVALENT TO PERIMETER WALL RATING

EXIT WIDTH FACTORS

	NON-SMOKE PROTECTED	SMOKE PROTECTED
STAIRS AND AISLE STEPS	0.3 (INCH/OCCUPANT)	0.144" (INCH/OCCUPANT)
PASSAGEWAYS, RAMPS, & DOORPS	0.2 (INCH/OCCUPANT)	0.110" (INCH/OCCUPANT)

EXIT STUDY LEGEND

	SMOKE PROTECTED ("SP")	NON-SMOKE PROTECTED ("NSP")
DESIGN OCCUPANT LOAD FOR SEATING AREA OR ROOM	XXX	XXX
NUMBER OF OCCUPANTS ADVANCING	XXX	XXX
COMBINED NUMBER OF OCCUPANTS ADVANCING	XXX	XXX
NON-CONVERGING OCCUPANTS ADVANCING	XXX	XXX
COMBINED NON-CONVERGING OCCUPANTS ADVANCING	XXX	XXX
EGRESS ELEMENT REQUIREMENTS	TOTAL OCCUPANTS EXITING: XXX TOTAL ELEMENT EGRESS WIDTH (DECIMAL INCHES): XXX REQUIRED WIDTH FOR OCCUPANT LOAD (DECIMAL INCHES): XXX	TOTAL OCCUPANTS EXITING: XXX TOTAL ELEMENT EGRESS WIDTH (DECIMAL INCHES): XXX REQUIRED WIDTH FOR OCCUPANT LOAD (DECIMAL INCHES): XXX
TRAVEL DISTANCE AND TRAVEL PATH	→	
DIRECTION OF OCCUPANT FLOW	* →	

* FIGURES INTERPOLATED FROM TABLE 1028.6.2 FROM THE 2009 IBC.

2	SI #069	03-28-2013
1	SI #032	02-07-2013
0	CONSTRUCTION DOCUMENTS	01-21-2013
REV.	DESCRIPTION	DATE
SI #069		
03-28-2013		
CURRENT ISSUE STATUS:		

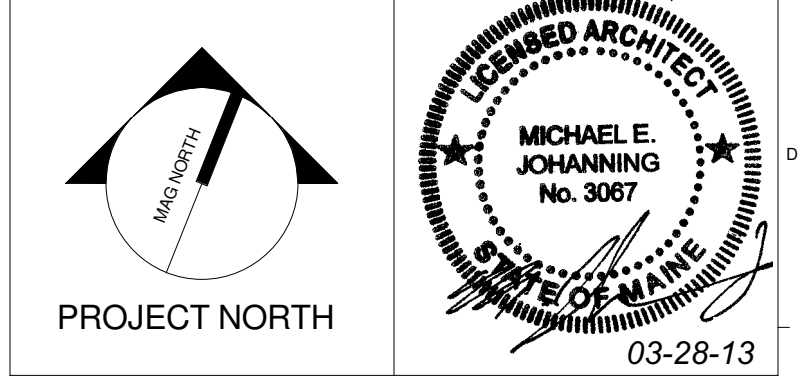

WBRC
ARCHITECTS • ENGINEERS
WWW.WBRCAL.COM
BANGOR, MAINE 207.647.4511
PORTLAND, MAINE 207.838.4511
SUBSIDIARY, FLORIDA 813.656.0727

CUMBERLAND COUNTY CIVIC CENTER RENOVATION
PROJECT: PORTLAND, MAINE
MECH. LEVEL - LIFE SAFETY PLAN - CENTER STAGE

SHEET TITLE: MECH. LEVEL - LIFE SAFETY PLAN - CENTER STAGE
WBRC CAD FILE: C:\Revit\Local\2013\03\032813\032813.dwg
PROJECT No. 3757.00 GRAPHIC SCALE: 1" = 1'-0"
SCALE: As indicated
PROJECT MANAGER: JRB
DRAWN BY: RAD
CHECKED BY: MEJ
SHEET No. **LSB.00**

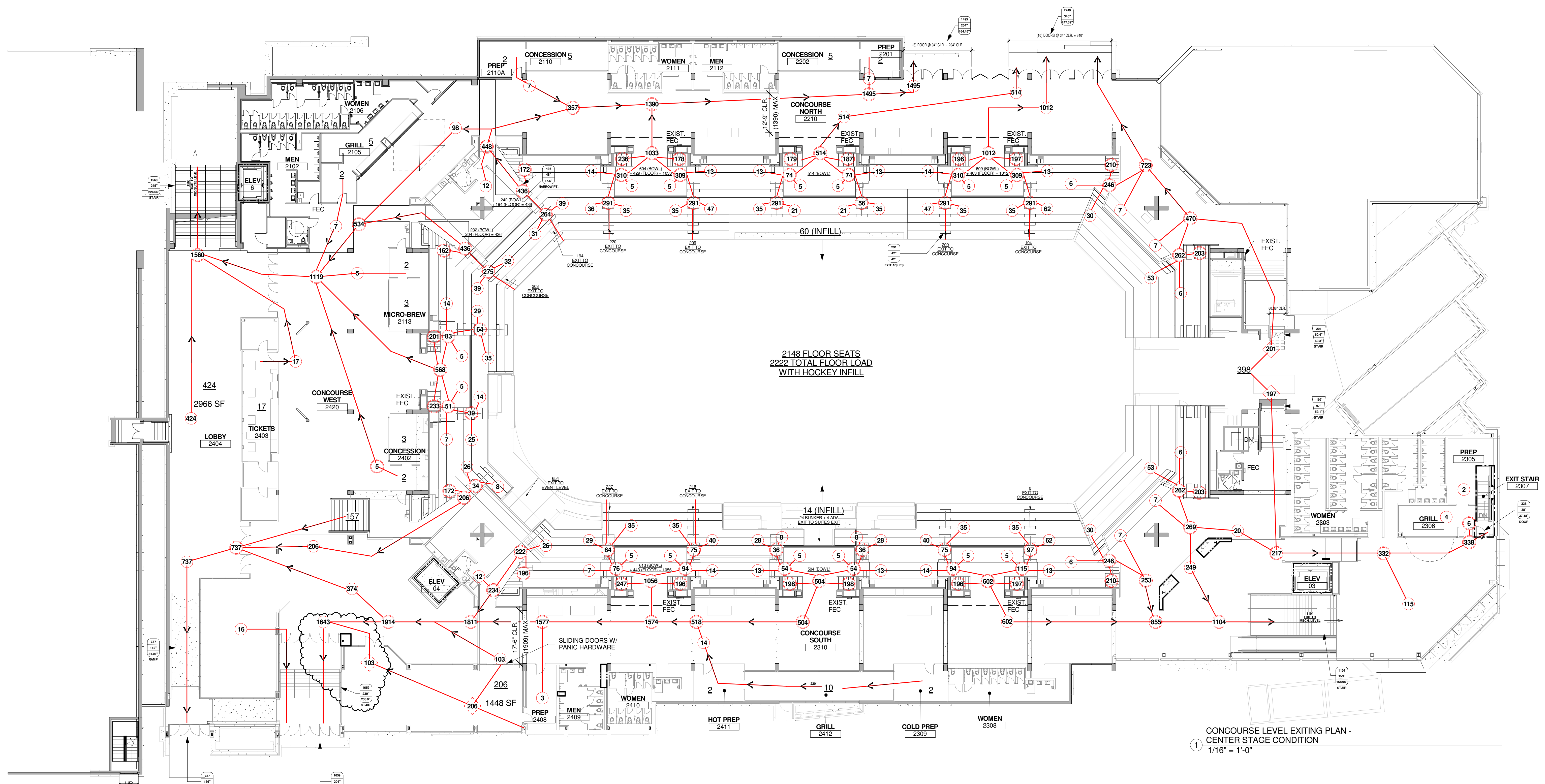

CONCOURSE LEVEL EXITING PLAN - CENTER STAGE CONDITION
1/16" = 1'-0"

COORDINATED LOCATIONS OF EXISTING AND NEW FIRE EXTINGUISHERS AND FIRE EXTINGUISHER CABINETS.
UPDATED EGRESS BASED ON NEW STAIR ADDITION AT SE CORNER (SI #060).

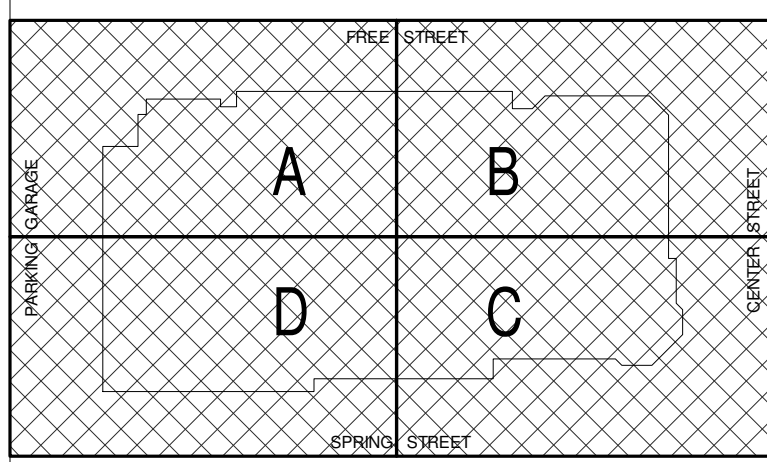

FIRE RATING PLAN NOTES		FIRE RATING PLAN LEGEND		EXIT WIDTH FACTORS																			
1. REFER TO BUILDING CODE REPORT PREPARED BY FP&C CONSULTANTS INC. LOCATED IN THE PROJECT MANUAL APPENDIX. 2. THE CODE ANALYSIS PLANS INDICATE GENERAL LOCATIONS OF FIRE RESISTIVE PARTITIONS AND SHAFTS. REFER TO THE ARCHITECTURAL FLOOR PLANS AND THE INTERIOR WALL TYPE SCHEDULE FOR SPECIFIC CONSTRUCTION REQUIREMENTS. 3. ALL HORIZONTAL AND/OR VERTICAL PENETRATIONS OF FIRE RESISTIVE ASSEMBLIES SHALL BE FIRE STOPPED TO PROVIDE THE SAME LEVEL OF FIRE RESISTANCE AS THE ASSEMBLY IN WHICH THEY OCCUR. a. PUBLISHED INFORMATION FOR THESE ASSEMBLIES HAS BEEN REPRODUCED AND INCLUDED FOR REFERENCE. 4. ALL FIRE RESISTIVE CONSTRUCTION SHALL CONFORM TO THE APPLICABLE REQUIREMENTS OF THE REFERENCED FIRE RESISTIVE DESIGN ASSEMBLIES. 5. REFER TO A9.91 FOR THE FIRE RESISTIVE ASSEMBLIES. 6. REFER TO SMOKE CONTROL REPORT PREPARED BY FP&C CONSULTANTS INC. LOCATED IN THE PROJECT MANUAL APPENDIX. 7. EACH CONCESSION AND COMMISSARY WILL BE EQUIPPED WITH HAND HELD FIRE EXTINGUISHERS PROVIDED BY THE OWNER		--- SMOKE SEPARATION - - - 1-HOUR FIRE RESISTIVE SEPARATION - - - 2-HOUR FIRE RESISTIVE SEPARATION - - - 2-HOUR FIRE RESISTIVE EXIT CONSTRUCTION - - - 2-HOUR FIRE-WRAP DUCT A-4 OCCUPANCY CLASSIFICATION FOR BUILDING AREA RC RATED SHAFTWALL CEILING PER NER-258 EQUIVALENT TO PERIMETER WALL RATING		<table border="1"> <thead> <tr> <th></th> <th>NON-SMOKE PROTECTED</th> <th>SMOKE PROTECTED</th> </tr> </thead> <tbody> <tr> <td>STAIRS AND AISLE STEPS</td> <td>0.3 (INCH/OCCUPANT)</td> <td>0.144" (INCH/OCCUPANT)</td> </tr> <tr> <td>PASSAGEWAYS, RAMPS, & DOORS</td> <td>0.2 (INCH/OCCUPANT)</td> <td>0.110" (INCH/OCCUPANT)</td> </tr> </tbody> </table>			NON-SMOKE PROTECTED	SMOKE PROTECTED	STAIRS AND AISLE STEPS	0.3 (INCH/OCCUPANT)	0.144" (INCH/OCCUPANT)	PASSAGEWAYS, RAMPS, & DOORS	0.2 (INCH/OCCUPANT)	0.110" (INCH/OCCUPANT)									
	NON-SMOKE PROTECTED	SMOKE PROTECTED																					
STAIRS AND AISLE STEPS	0.3 (INCH/OCCUPANT)	0.144" (INCH/OCCUPANT)																					
PASSAGEWAYS, RAMPS, & DOORS	0.2 (INCH/OCCUPANT)	0.110" (INCH/OCCUPANT)																					
		EXIT STUDY LEGEND																					
		<table border="1"> <thead> <tr> <th></th> <th>SMOKE PROTECTED (*SP)</th> <th>NON-SMOKE PROTECTED (*NSP)</th> </tr> </thead> <tbody> <tr> <td>DESIGN OCCUPANT LOAD FOR SEATING AREA OR ROOM</td> <td>XXX</td> <td>XXX</td> </tr> <tr> <td>NUMBER OF OCCUPANTS ADVANCING</td> <td>XXX</td> <td>XXX</td> </tr> <tr> <td>COMBINED NUMBER OF OCCUPANTS ADVANCING</td> <td>XXX</td> <td>XXX</td> </tr> <tr> <td>NON-CONVERGING OCCUPANTS ADVANCING</td> <td>XXX</td> <td>XXX</td> </tr> <tr> <td>COMBINED NON-CONVERGING OCCUPANTS ADVANCING</td> <td>XXX</td> <td>XXX</td> </tr> </tbody> </table>			SMOKE PROTECTED (*SP)	NON-SMOKE PROTECTED (*NSP)	DESIGN OCCUPANT LOAD FOR SEATING AREA OR ROOM	XXX	XXX	NUMBER OF OCCUPANTS ADVANCING	XXX	XXX	COMBINED NUMBER OF OCCUPANTS ADVANCING	XXX	XXX	NON-CONVERGING OCCUPANTS ADVANCING	XXX	XXX	COMBINED NON-CONVERGING OCCUPANTS ADVANCING	XXX	XXX		
	SMOKE PROTECTED (*SP)	NON-SMOKE PROTECTED (*NSP)																					
DESIGN OCCUPANT LOAD FOR SEATING AREA OR ROOM	XXX	XXX																					
NUMBER OF OCCUPANTS ADVANCING	XXX	XXX																					
COMBINED NUMBER OF OCCUPANTS ADVANCING	XXX	XXX																					
NON-CONVERGING OCCUPANTS ADVANCING	XXX	XXX																					
COMBINED NON-CONVERGING OCCUPANTS ADVANCING	XXX	XXX																					
		<table border="1"> <thead> <tr> <th>EGRESS ELEMENT REQUIREMENTS</th> <th>TOTAL OCCUPANTS EXITING</th> <th>TOTAL ELEMENT EGRESS WIDTH (DECIMAL INCHES)</th> <th>REQUIRED WIDTH FOR OCCUPANT LOAD (DECIMAL INCHES)</th> </tr> </thead> <tbody> <tr> <td>XXX</td> <td>XXX</td> <td>XXX</td> <td>XXX</td> </tr> </tbody> </table>		EGRESS ELEMENT REQUIREMENTS	TOTAL OCCUPANTS EXITING	TOTAL ELEMENT EGRESS WIDTH (DECIMAL INCHES)	REQUIRED WIDTH FOR OCCUPANT LOAD (DECIMAL INCHES)	XXX	XXX	XXX	XXX												
EGRESS ELEMENT REQUIREMENTS	TOTAL OCCUPANTS EXITING	TOTAL ELEMENT EGRESS WIDTH (DECIMAL INCHES)	REQUIRED WIDTH FOR OCCUPANT LOAD (DECIMAL INCHES)																				
XXX	XXX	XXX	XXX																				
		TRAVEL DISTANCE AND TRAVEL PATH DIRECTION OF OCCUPANT FLOW																					

* FIGURES INTERPOLATED FROM TABLE 1028.6.2 FROM THE 2009 IBC.

REV.	DESCRIPTION	DATE
2	SI #069	03-28-2013
1	SI #070	03-27-2013
0	CONSTRUCTION DOCUMENTS	01-21-2013

SI #069
03-28-2013
CURRENT ISSUE STATUS:

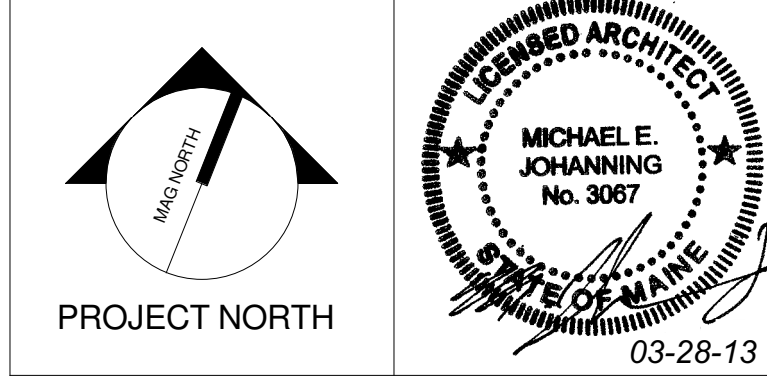

WBRC
ARCHITECTS • ENGINEERS
WWW.WBRCAL.COM
BANGOR, MAINE 307-947-4511
PORTLAND, MAINE 307-838-4511
SUBSIDIARY, FLORIDA 341-556-0727

CUMBERLAND COUNTY CIVIC CENTER RENOVATION

PROJECT: PORTLAND, MAINE
CONCOURSE LEVEL - LIFE SAFETY PLAN - CENTER STAGE

SHEET TITLE	GRAPHIC SCALE	SHEET NO.
WBRC CAD FILE: C:\Revit\2013\03-28-2013\CCC-C Architecture_dbb.dwg	1" = 3757.00'	1
PROJECT No. 3757.00	SCALE: As indicated	PROJECT MANAGER: JRB
SCALE: As indicated	DRAMAN BY: RAB	CHECKED BY: MEJ
		LSB.20

SINK COMBS DETHLEFS

Copyright by Sink Combs Dethlefs, P.C.
475 Lincoln Street, Suite 100, Denver, Colorado 80202
303.398.0200
FAX: 303.398.0222

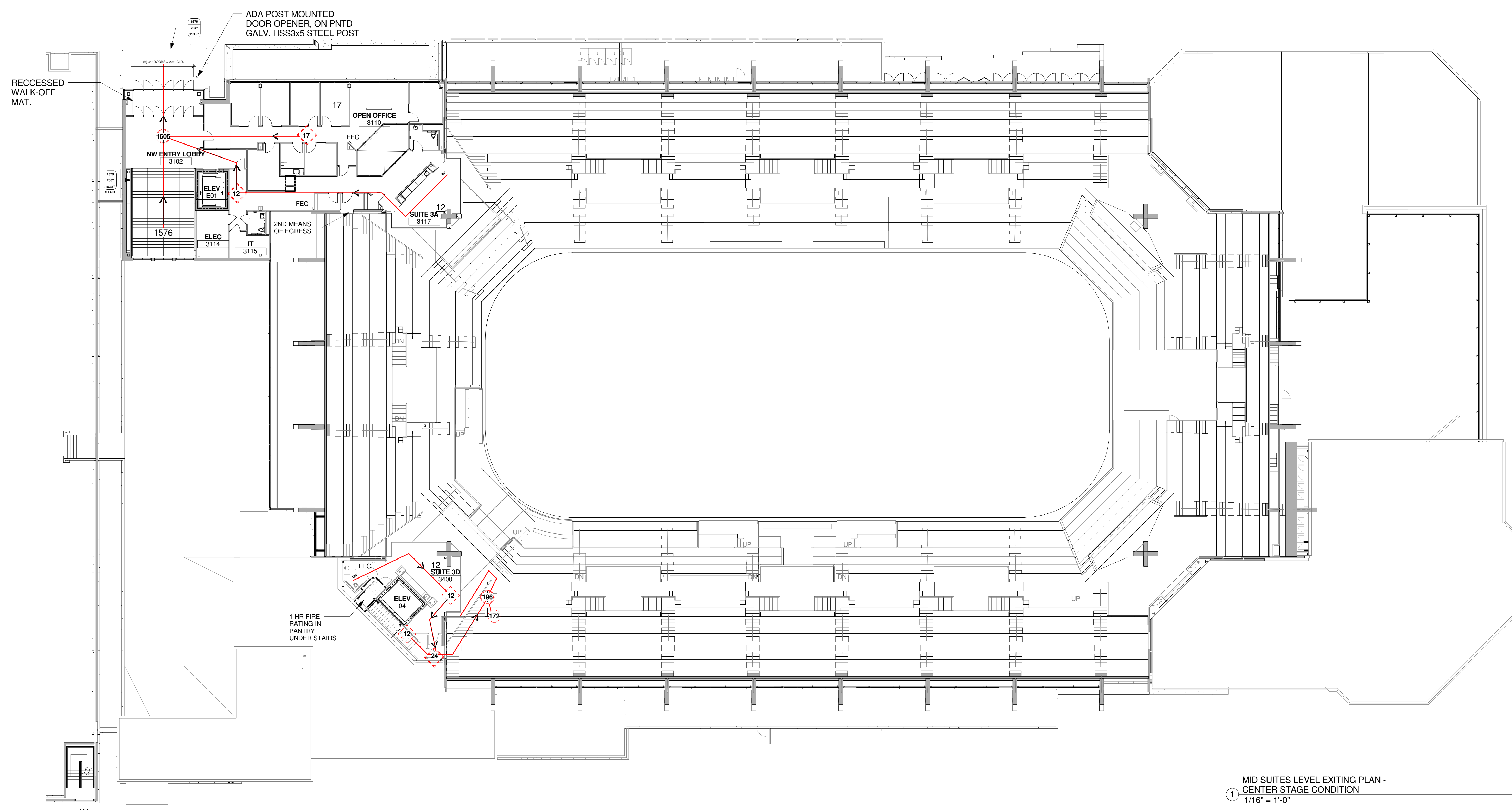

MID SUITES LEVEL EXITING PLAN - CENTER STAGE CONDITION
1/16" = 1'-0"

COORDINATED LOCATIONS OF EXISTING AND NEW FIRE EXTINGUISHERS AND FIRE EXTINGUISHER CABINETS.
UPDATED EGRESS BASED ON NEW STAIR ADDITION AT SE CORNER (SI #060).

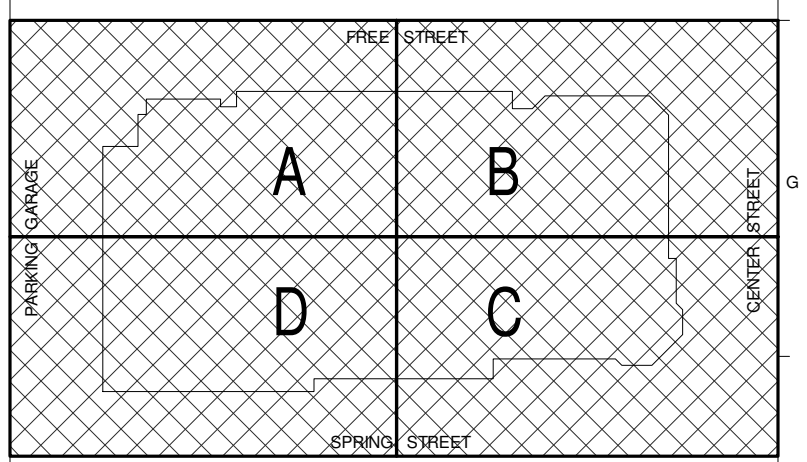

FIRE RATING PLAN NOTES		FIRE RATING PLAN LEGEND		EXIT WIDTH FACTORS										
1. REFER TO BUILDING CODE REPORT PREPARED BY FP&C CONSULTANTS INC. LOCATED IN THE PROJECT MANUAL APPENDIX. 2. THE CODE ANALYSIS PLANS INDICATE GENERAL LOCATIONS OF FIRE RESISTIVE PARTITIONS AND SHAFTS. REFER TO THE ARCHITECTURAL FLOOR PLANS AND THE INTERIOR WALL TYPE SCHEDULE FOR SPECIFIC CONSTRUCTION REQUIREMENTS. 3. ALL HORIZONTAL AND/OR VERTICAL PENETRATIONS OF FIRE RESISTIVE ASSEMBLIES SHALL BE FIRE STOPPED TO PROVIDE THE SAME LEVEL OF FIRE RESISTANCE AS THE ASSEMBLY IN WHICH THEY OCCUR. a. PUBLISHED INFORMATION FOR THESE ASSEMBLIES HAS BEEN REPRODUCED AND INCLUDED FOR REFERENCE. 4. ALL FIRE RESISTIVE CONSTRUCTION SHALL CONFORM TO THE APPLICABLE REQUIREMENTS OF THE REFERENCED FIRE RESISTIVE DESIGN ASSEMBLIES. 5. REFER TO A9.91 FOR THE FIRE RESISTIVE ASSEMBLIES. 6. REFER TO SMOKE CONTROL REPORT PREPARED BY FP&C CONSULTANTS INC. LOCATED IN THE PROJECT MANUAL APPENDIX. 7. EACH CONCESSION AND COMMISSARY WILL BE EQUIPPED WITH HAND HELD FIRE EXTINGUISHERS PROVIDED BY THE OWNER.		--- SMOKE SEPARATION - - - 1-HOUR FIRE RESISTIVE SEPARATION - - - 2-HOUR FIRE RESISTIVE SEPARATION - - - 2-HOUR FIRE RESISTIVE EXIT CONSTRUCTION - - - 2-HOUR FIRE-WRAP DUCT A-4 OCCUPANCY CLASSIFICATION FOR BUILDING AREA RC RATED SHAFTWALL CEILING PER NEB 268 EQUIVALENT TO PERIMETER WALL RATING		<table border="1"> <thead> <tr> <th></th> <th>NON-SMOKE PROTECTED</th> <th>SMOKE PROTECTED</th> </tr> </thead> <tbody> <tr> <td>STAIRS AND AISLE STEPS</td> <td>0.3 (INCH/OCCUPANT)</td> <td>0.144" (INCH/OCCUPANT)</td> </tr> <tr> <td>PASSAGeways, RAMPS, & DOORS</td> <td>0.2 (INCH/OCCUPANT)</td> <td>0.110" (INCH/OCCUPANT)</td> </tr> </tbody> </table>			NON-SMOKE PROTECTED	SMOKE PROTECTED	STAIRS AND AISLE STEPS	0.3 (INCH/OCCUPANT)	0.144" (INCH/OCCUPANT)	PASSAGeways, RAMPS, & DOORS	0.2 (INCH/OCCUPANT)	0.110" (INCH/OCCUPANT)
	NON-SMOKE PROTECTED	SMOKE PROTECTED												
STAIRS AND AISLE STEPS	0.3 (INCH/OCCUPANT)	0.144" (INCH/OCCUPANT)												
PASSAGeways, RAMPS, & DOORS	0.2 (INCH/OCCUPANT)	0.110" (INCH/OCCUPANT)												
		EXIT STUDY LEGEND												
		SMOKE PROTECTED ("SP")	NON-SMOKE PROTECTED ("NSP")											
DESIGN OCCUPANT LOAD FOR SEATING AREA OR ROOM		XXX	XXX											
NUMBER OF OCCUPANTS ADVANCING		XXX	XXX											
COMBINED NUMBER OF OCCUPANTS ADVANCING		XXX	XXX											
NON-CONVERGING OCCUPANTS ADVANCING		XXX	XXX											
COMBINED NON-CONVERGING OCCUPANTS ADVANCING		XXX	XXX											
EGRESS ELEMENT REQUIREMENTS		<table border="1"> <tr> <td>TOTAL OCCUPANTS EXITING</td> <td>XXX</td> <td>XXX</td> </tr> <tr> <td>TOTAL ELEMENT EGRESS WIDTH (DECIMAL INCHES)</td> <td>XXX</td> <td>XXX</td> </tr> <tr> <td>REQUIRED WIDTH FOR OCCUPANT LOAD (DECIMAL INCHES)</td> <td>XXX</td> <td>XXX</td> </tr> </table>		TOTAL OCCUPANTS EXITING	XXX	XXX	TOTAL ELEMENT EGRESS WIDTH (DECIMAL INCHES)	XXX	XXX	REQUIRED WIDTH FOR OCCUPANT LOAD (DECIMAL INCHES)	XXX	XXX		
TOTAL OCCUPANTS EXITING	XXX	XXX												
TOTAL ELEMENT EGRESS WIDTH (DECIMAL INCHES)	XXX	XXX												
REQUIRED WIDTH FOR OCCUPANT LOAD (DECIMAL INCHES)	XXX	XXX												
TRAVEL DISTANCE AND TRAVEL PATH		→												
DIRECTION OF OCCUPANT FLOW		* →												

* FIGURES INTERPOLATED FROM TABLE 1028.6.2 FROM THE 2009 IBC.

1	SI #069	03-28-2013
0	CONSTRUCTION DOCUMENTS	01-21-2013
REV.	DESCRIPTION	DATE

SI #069
03-28-2013
CURRENT ISSUE STATUS:

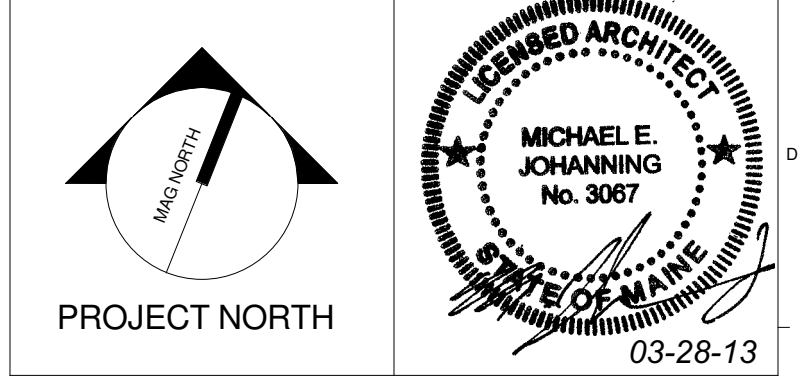

WBRC
ARCHITECTS • ENGINEERS
WWW.WBRCAL.COM
BANGOR, MAINE 207-947-4511
PORTLAND, MAINE 207-838-4511
SUBSIDIARY, FLORIDA 941-556-0727

CUMBERLAND COUNTY CIVIC CENTER RENOVATION
PROJECT: PORTLAND, MAINE

MID SUITES LEVEL - LIFE SAFETY PLAN - CENTER STAGE

SHEET TITLE	WBRC CAD FILE: C:\Revit\2013\03-28-2013\03-28-2013.dwg
PROJECT No.	3757.00
SCALE	As indicated
PROJECT MANAGER	JRB
DRAWN BY	RAD
CHECKED BY	MEJ

SHEET No. **LSB.30**

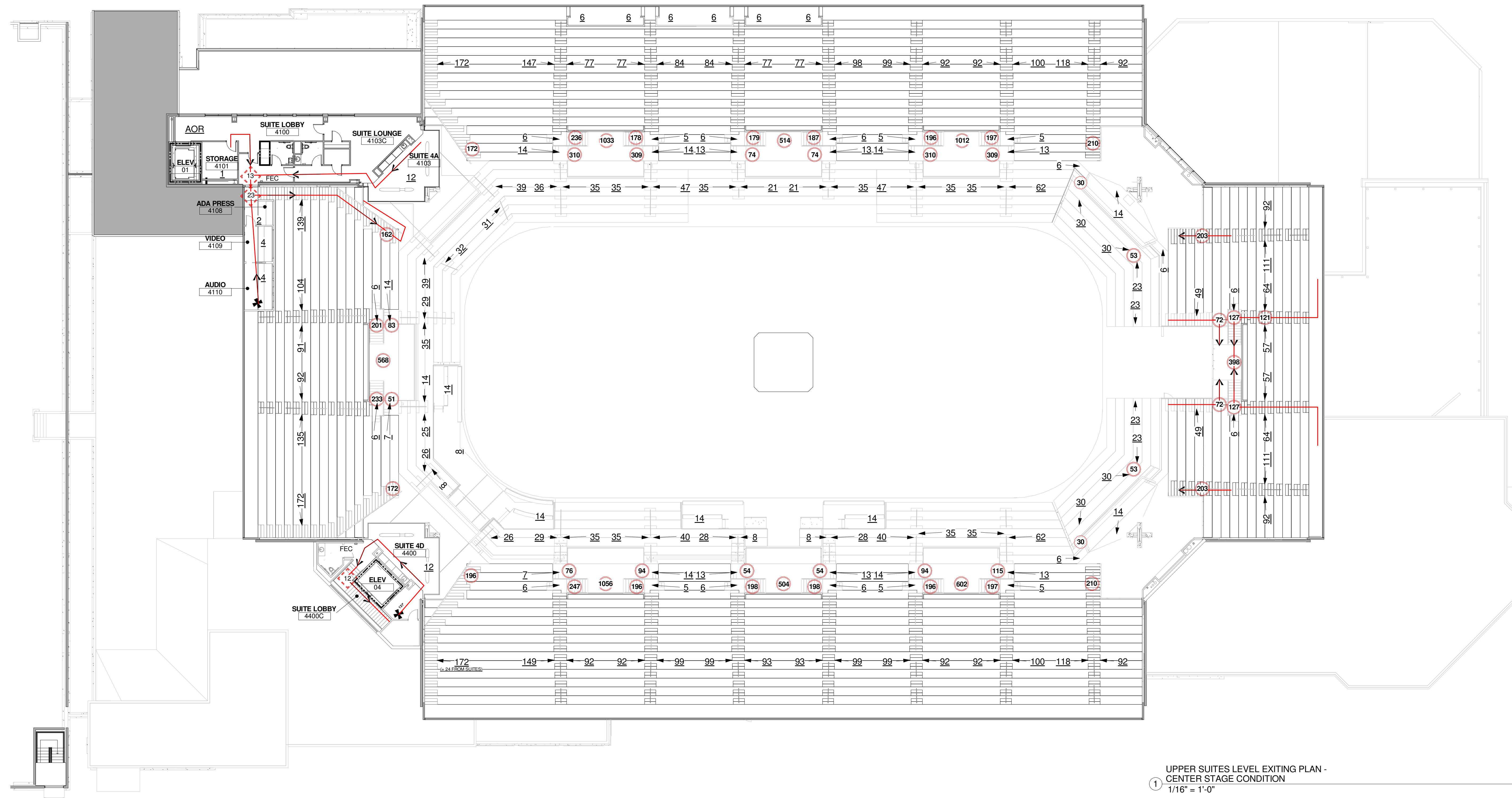

UPPER SUITES LEVEL EXITING PLAN - CENTER STAGE CONDITION
1/16" = 1'-0"

FIRE RATING PLAN NOTES

- REFER TO BUILDING CODE REPORT PREPARED BY FR&C CONSULTANTS INC. LOCATED IN THE PROJECT MANUAL APPENDIX.
- THE CODE ANALYSIS PLANS INDICATE GENERAL LOCATIONS OF FIRE RESISTIVE PARTITIONS AND SHAFTS. REFER TO THE ARCHITECTURAL FLOOR PLANS AND THE INTERIOR WALL TYPE SCHEDULE FOR SPECIFIC CONSTRUCTION REQUIREMENTS.
- ALL HORIZONTAL AND/OR VERTICAL PENETRATIONS OF FIRE RESISTIVE ASSEMBLIES SHALL BE FIRE STOPPED TO PROVIDE THE SAME LEVEL OF FIRE RESISTANCE AS THE ASSEMBLY IN WHICH THEY OCCUR.
 - PUBLISHED INFORMATION FOR THESE ASSEMBLIES HAS BEEN REPRODUCED AND INCLUDED FOR REFERENCE.
- ALL FIRE RESISTIVE CONSTRUCTION SHALL CONFORM TO THE APPLICABLE REQUIREMENTS OF THE REFERENCED FIRE RESISTIVE DESIGN ASSEMBLIES.
- REFER TO A9.91 FOR THE FIRE RESISTIVE ASSEMBLIES.
- REFER TO SMOKE CONTROL REPORT PREPARED BY FR&C CONSULTANTS INC. LOCATED IN THE PROJECT MANUAL APPENDIX.
- EACH CONCESSION AND COMMISSARY WILL BE EQUIPPED WITH HAND HELD FIRE EXTINGUISHERS PROVIDED BY THE OWNER

FIRE RATING PLAN LEGEND

- SMOKE SEPARATION
- 1-HOUR FIRE RESISTIVE SEPARATION
- 2-HOUR FIRE RESISTIVE SEPARATION
- 2-HOUR FIRE RESISTIVE EXIT CONSTRUCTION
- 2-HOUR FIRE-WRAP DUCT
- A-4 OCCUPANCY CLASSIFICATION FOR BUILDING AREA
- RC RATED SHAFTWALL CEILING PER PER 258 EQUIVALENT TO PERIMETER WALL RATING

EXIT WIDTH FACTORS

	NON-SMOKE PROTECTED	SMOKE PROTECTED
STAIRS AND AISLE STEPS	0.3 (INCH/OCCUPANT)	0.144* (INCH/OCCUPANT)
PASSAGEWAYS, RAMPS, & DOORS	0.2 (INCH/OCCUPANT)	0.110* (INCH/OCCUPANT)

EXIT STUDY LEGEND

	SMOKE PROTECTED ("SP")	NON-SMOKE PROTECTED ("NSP")
DESIGN OCCUPANT LOAD FOR SEATING AREA OR ROOM	XXX	XXX
NUMBER OF OCCUPANTS ADVANCING	XXX	XXX
COMBINED NUMBER OF OCCUPANTS ADVANCING	XXX	XXX
NON-CONVERGING OCCUPANTS ADVANCING	XXX	XXX
COMBINED NON-CONVERGING OCCUPANTS ADVANCING	XXX	XXX
EGRESS ELEMENT REQUIREMENTS	TOTAL OCCUPANTS EXITING TOTAL ELEMENT EGRESS WIDTH (DECIMAL INCHES) REQUIRED WIDTH FOR OCCUPANT LOAD (DECIMAL INCHES)	XXX XXX XXX
TRAVEL DISTANCE AND TRAVEL PATH	→	
DIRECTION OF OCCUPANT FLOW	* →	

* FIGURES INTERPOLATED FROM TABLE 1028.6.2 FROM THE 2009 IBC.

COORDINATED LOCATIONS OF EXISTING AND NEW FIRE EXTINGUISHERS AND FIRE EXTINGUISHER CABINETS.
UPDATED EGRESS BASED ON NEW STAIR ADDITION AT SE CORNER (SI #060).

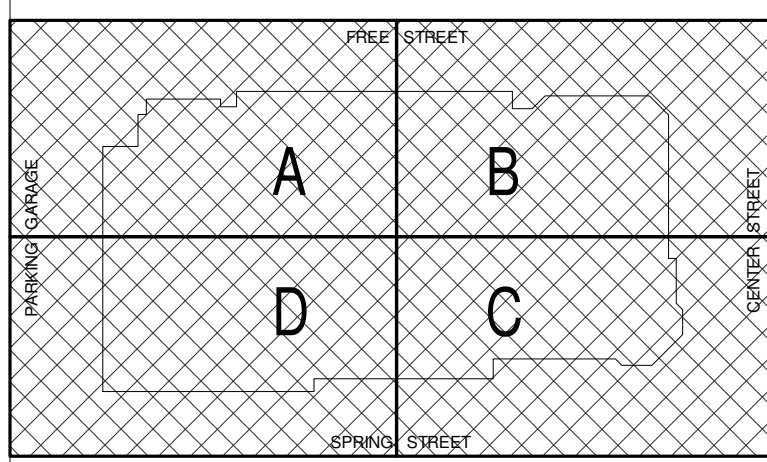

REV.	DESCRIPTION	DATE
1	SI #069	03-28-2013
0	CONSTRUCTION DOCUMENTS	01-21-2013

SI #069
03-28-2013
CURRENT ISSUE STATUS:

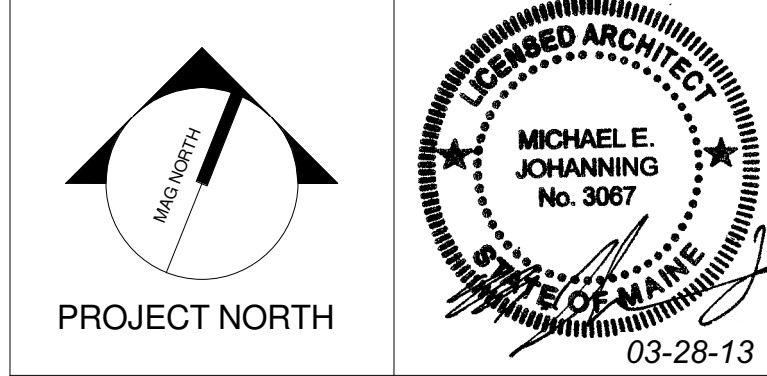

WBRC
ARCHITECTS • ENGINEERS
WWW.WBRCAL.COM
BANGOR, MAINE 207.647.4511
PORTLAND, MAINE 207.838.4511
SUBSIDIARY, FLORIDA 888.556.0727

CUMBERLAND COUNTY CIVIC CENTER RENOVATION

PROJECT: PORTLAND, MAINE
UPPER SUITES LEVEL - LIFE SAFETY PLAN - CENTER STAGE

SHEET TITLE	UPPER SUITES LEVEL - LIFE SAFETY PLAN - CENTER STAGE
WBRC CAD FILE	C:\Revit\2013\03-28-13\03-28-13-01.dwg
PROJECT No.	3757.00
SCALE	As indicated
PROJECT MANAGER	JRB
DRAWN BY	RAD
CHECKED BY	MEJ
SHEET No.	LSB.40