

ARCHITECT
 HKS, INC.
 350 N SAINT PAUL ST, SUITE 100
 DALLAS, TX 75201-4240

STRUCTURAL ENGINEER
 BECKER STRUCTURAL ENGINEERS
 75 YORK STREET
 PORTLAND, MAINE 04101

OWNER
 FATHOM CO, LLC
 80 EXCHANGE STREET, SUITE 400
 PORTLAND, MAINE 04101

OWNER'S CONSTRUCTION MANAGER
 WRIGHT-RYAN CONSTRUCTION, INC.
 10 DANK ORTH STREET
 PORTLAND, MAINE 04101

OWNER'S CIVIL ENGINEER
 WOODWARD & CURRAN
 41 HUTCHINS DRIVE
 PORTLAND, MAINE 04102

OWNER'S INTERIOR ARCHITECT
 EALAIN STUDIO
 408 FORE STREET, SUITE 201
 PORTLAND, MAINE 04101

OWNER'S LANDSCAPE ARCHITECT
 CARROLL ASSOCIATES LANDSCAPE ARCHITECT
 217 COMMERCIAL STREET, SUITE 200
 PORTLAND, MAINE 04101

**CENTER STREET
 BOUTIQUE HOTEL
 PORTLAND, MAINE**

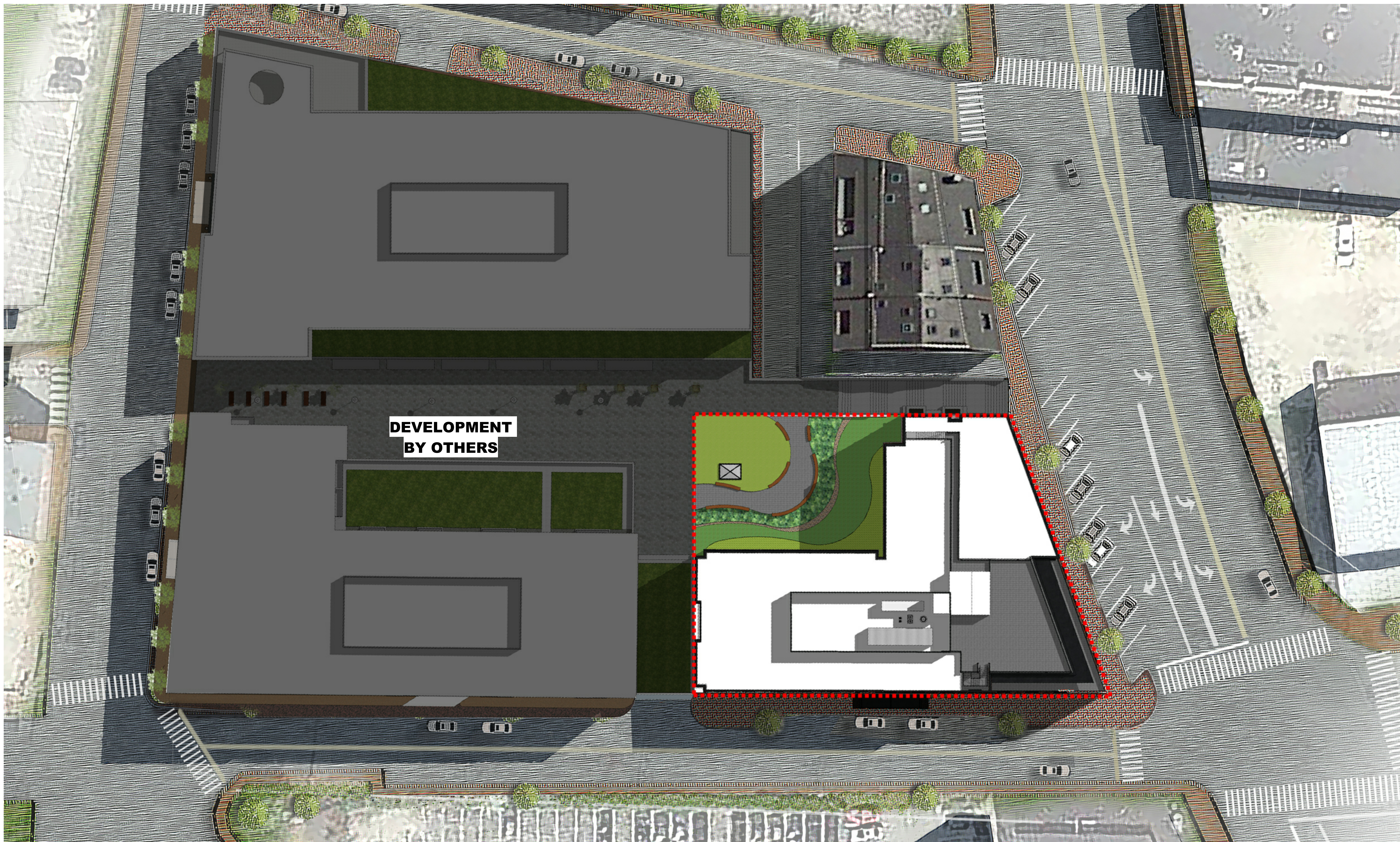

**DEVELOPMENT
 BY OTHERS**

THESE DOCUMENTS ARE PARTIALLY DEVELOPED FROM ARCHITECTURAL AND STRUCTURAL DRAWINGS PROVIDED BY OTHERS. ALL AS-BUILT CONDITIONS SHOULD BE FIELD VERIFIED.

INTERIM REVIEW ONLY
 These documents are incomplete, and are released for interim review only and are not intended for regulatory approval, permit, or construction purposes.
 Architect: _____
 Acct. Reg. No.: _____
 Date: _____

KEY PLAN
 DATUM ELEVATION 52'-0"
 (MSL) = 0.72 INCHES @ 0.70 Portland City Datum.

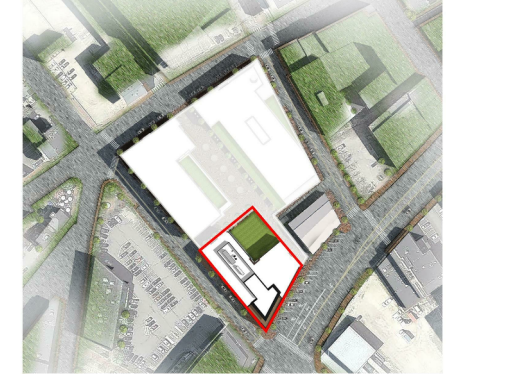

REVISION NO.	DESCRIPTION	DATE

HKS PROJECT NUMBER
22302.000

DATE
12/21/2018

ISSUE
SCHEMATIC DESIGN

SHEET TITLE
SITE ILLUSTRATIVE

SHEET NO.
A1.01

1 SITE ILLUSTRATIVE
 1" = 20'-0"

12/20/2018 2:25:28 PM - TEMPLATE VERSION 3.0.0 2017/06/23