

City of Portland, Maine – Building or Use Permit Application 389 Congress Street, 04101, Tel: (207) 874-8703, FAX: 874-8716

Location of Construction: 505 Fore Street Q's Ice Cream, Inc. 04101 (left side of 1st Fl. of bldg.)		Owner:	Phone: 773-7217	Permit No: 991060
Owner Address: **505 Fore St. Portland, ME 04101	Lessee/Buyer's Name: owner: Tracy-Causser Limited	Phone: 773-7217	Business Name: Q's Ice Cream Inc. **LESSEE: Ann Marie Queshel	PERMIT ISSUED  CITY OF PORTLAND Zone: CBL: 038-C-010
Contractor Name: Scarborough Signs Rt. 1 Scarborough, Maine	Address:		Phone:	
Past Use: Ice Cream Shop	Proposed Use: Same	COST OF WORK: \$ #	PERMIT FEE: \$ 26.20	Zoning Approval: No. 27-99 Special Zone or Reviews: <input type="checkbox"/> Shoreland <input type="checkbox"/> Wetland <input type="checkbox"/> Flood Zone <input type="checkbox"/> Subdivision <input type="checkbox"/> Site Plan maj <input type="checkbox"/> minor <input type="checkbox"/> mm
		FIRE DEPT. <input type="checkbox"/> Approved <input type="checkbox"/> Denied	INSPECTION: 51944 Use Group: Type: 00C496	
Proposed Project Description: Sidewalk "Sandwich Board Sign" 2'wx3'H		PEDESTRIAN ACTIVITIES DISTRICT (P.A.D.) Action: <input type="checkbox"/> Approved <input type="checkbox"/> Approved with Conditions <input type="checkbox"/> Denied Signature: _____ Date: _____		
Permit Taken By: KA	Date Applied For: 9-24-99			Zoning Appeal <input type="checkbox"/> Variance <input type="checkbox"/> Miscellaneous <input type="checkbox"/> Conditional Use <input type="checkbox"/> Interpretation <input type="checkbox"/> Approved <input type="checkbox"/> Denied

- This permit application does not preclude the Applicant(s) from meeting applicable State and Federal rules.
- Building permits do not include plumbing, septic or electrical work.
- Building permits are void if work is not started within six (6) months of the date of issuance. False information may invalidate a building permit and stop all work..

***Send To: Ann Marie Queshel
505 Fore St.
Portland, ME 04101
c/o Q's Ice Cream Inc.

**PERMIT ISSUED
WITH REQUIREMENTS**

CERTIFICATION

I hereby certify that I am the owner of record of the named property, or that the proposed work is authorized by the owner of record and that I have been authorized by the owner to make this application as his authorized agent and I agree to conform to all applicable laws of this jurisdiction. In addition, if a permit for work described in the application is issued, I certify that the code official's authorized representative shall have the authority to enter all areas covered by such permit at any reasonable hour to enforce the provisions of the code(s) applicable to such permit

9-24-99

SIGNATURE OF APPLICANT ADDRESS: DATE: PHONE:

RESPONSIBLE PERSON IN CHARGE OF WORK, TITLE PHONE:

White-Permit Desk Green-Assessor's Canary-D.P.W. Pink-Public File Ivory Card-Inspector

CEO DISTRICT
ub



SIGNAGE PRE-APPLICATION

PLEASE ANSWER ALL QUESTIONS

ADDRESS: 505 Fore St, Portland, ME 04101 ZONE: _____

OWNER: Q's Ice Cream, Inc. / Ann Marie Quesnel

APPLICANT: Ann Marie Quesnel

ASSESSOR NO. _____

SINGLE TENANT LOT? YES _____ NO

MULTI TENANT LOT? YES NO _____

FREESTANDING SIGN? YES NO _____ DIMENSIONS _____

(ex. pole sign. . .) Sidewalk "Specials type" sign.

MORE THAN ONE SIGN? YES _____ NO DIMENSIONS _____

BLDG. WALL SIGN? YES _____ NO _____ DIMENSIONS _____

(attached to bldg)

MORE THAN ONE SIGN? YES _____ NO _____ DIMENSIONS _____

LIST ALL EXISTING SIGNAGE AND THEIR DIMENSIONS: Business sign, overhead, attached to building above door approximately 2' x 4'

LOT FRONTAGE (FEET): _____

BLDG FRONTAGE (FEET): _____

AWNING YES _____ NO IS AWNING BACKLIT? YES _____ NO _____

HEIGHT OF AWNING: _____

IS THERE ANY COMMUNICATION, MESSAGE, TRADEMARK OR SYMBOL ON IT? Will be a changing message on board.

*** TENANT BLDG. FRONTAGE (IN FEET) _____

*** **REQUIRED INFORMATION**

AREA FOR COMPUTATION

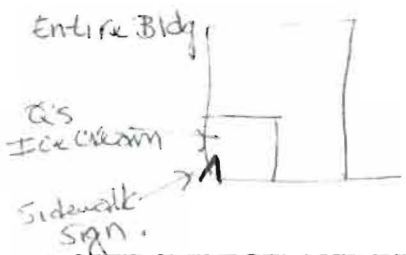

See previous site sketch dated 1996.

A SITE SKETCH AND BUILDING SKETCH SHOWING EXACTLY WHERE EXISTING AND NEW SIGNAGE IS LOCATED MUST BE PROVIDED. SKETCHES AND/OR PICTURES OF PROPOSED ARE ALSO REQUIRED.

SIGNATURE OF APPLICANT: Ann Marie Quesnel DATE: 9-10-99

THIS IS NOT A PERMIT/CONSTRUCTION CANNOT COMMENCE UNTIL THE PERMIT IS ISSUED

**Sign Permit Pre-Application
Attached Single Family Dwellings/Two-Family Dwelling
Multi-Family or Commercial Structures and Additions Thereto**

In the interest of processing your application in the quickest possible manner, please complete the Information below for a Building or Use Permit.

NOTEIf you or the property owner owes real estate or personal property taxes or user charges on ANY PROPERTY within the City, payment arrangements must be made before permits of any kind are accepted.**

Location/Address of Construction (include Portion of Building):		Q's Ice Cream, Inc. 505 Fore St. Portland, ME 04101		Left side of 1st floor of building	
Total Square Footage of Proposed Structure			6 ft		
Tax Assessor's Chart, Block & Lot Number			Owner:		Telephone#:
Chart# 038	Block# C	Lot# 016	Ann Marie Quesnel Tracy-Causeur Limited		(207) 773-7017
Owner's Address:		Lessee/Buyer's Name (If Applicable)		Total Sq. Ft. of Sign	Fee
505 Fore St. Portland, ME 04101		Ann Marie Quesnel		6 ft	\$26.20
Proposed Project Description:(Please be as specific as possible)					
Sidewalk "Sandwich Board" Sign to have changing message. 2'w x 3'H,					
Contractor's Name, Address & Telephone					Rec'd By
Scarboro Signs, Rt. 1 Scarborough, ME					(Signature)
Current Use:			Proposed Use:		
Ice Cream Shop			Same		

Signature of applicant:	Date:
Ann Marie Quesnel	9-22-99.

Signage Permit Fee: \$30.00 plus .20 per square foot of signage



Q's Ice Cream

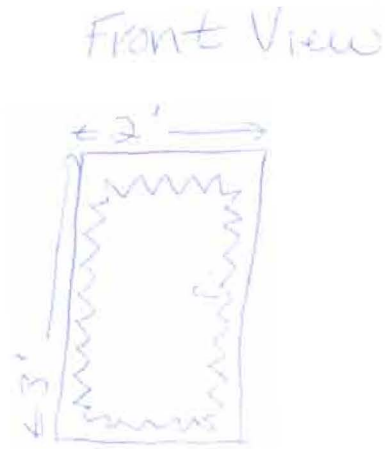
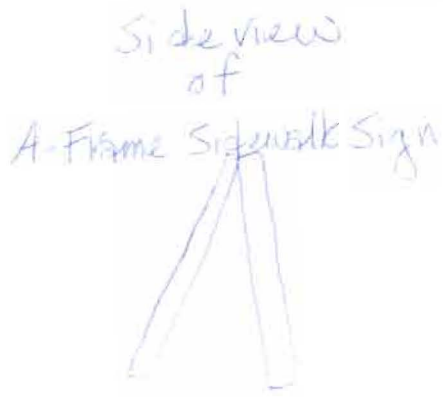

chalk board
for
changing
message

9/13/99

Ann Marie Quesnel
Q's Ice Cream

Ann Marie:

Please accept this note as
my expressed authorization for
you to have a sign on the
sidewalk in front of Q's ice cream
during your tenancy, provided such
sign is in conformity with any
applicable governing authority.

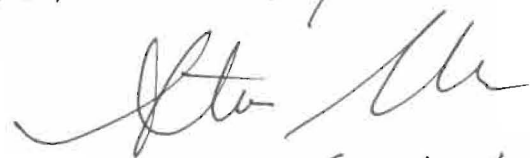

Stephen Goodrich, member
Tracy-Courser, LLC 9/13/99

ACORD CERTIFICATE OF LIABILITY INSURANCE

DATE (MM/DD/YY)
09/21/99

PRODUCER
TURNER BARKER INSURANCE

ONE INDIA ST
PORTLAND ME 04101

THIS CERTIFICATE IS ISSUED AS A MATTER OF INFORMATION ONLY AND CONFERS NO RIGHTS UPON THE CERTIFICATE HOLDER. THIS CERTIFICATE DOES NOT AMEND, EXTEND OR ALTER THE COVERAGE AFFORDED BY THE POLICIES BELOW.

COMPANIES AFFORDING COVERAGE

COMPANY A ASSURANCE CO OF AMERICA
COMPANY B
COMPANY C
COMPANY D

INSURED
Q'S ICE CREAM, INC.

505 FORE STREET
PORTLAND, ME 04101-3931

COVERAGES

THIS IS TO CERTIFY THAT THE POLICIES OF INSURANCE LISTED BELOW HAVE BEEN ISSUED TO THE INSURED NAMED ABOVE FOR THE POLICY PERIOD INDICATED, NOTWITHSTANDING ANY REQUIREMENT, TERM OR CONDITION OF ANY CONTRACT OR OTHER DOCUMENT WITH RESPECT TO WHICH THIS CERTIFICATE MAY BE ISSUED OR MAY PERTAIN, THE INSURANCE AFFORDED BY THE POLICIES DESCRIBED HEREIN IS SUBJECT TO ALL THE TERMS, EXCLUSIONS AND CONDITIONS OF SUCH POLICIES. LIMITS SHOWN MAY HAVE BEEN REDUCED BY PAID CLAIMS.

CO LTR	TYPE OF INSURANCE	POLICY NUMBER	POLICY EFFECTIVE DATE (MM/DD/YY)	POLICY EXPIRATION DATE (MM/DD/YY)	LIMITS								
A	GENERAL LIABILITY <input checked="" type="checkbox"/> COMMERCIAL GENERAL LIABILITY <input type="checkbox"/> CLAIMS MADE <input checked="" type="checkbox"/> OCCUR OWNER'S & CONTRACTOR'S PROT	PPS29137255	6/04/99	6/04/00	GENERAL AGGREGATE \$2,000,000 PRODUCTS - COMP/OP AGG \$2,000,000 PERSONAL & ADV INJURY \$1,000,000 EACH OCCURRENCE \$1,000,000 FIRE DAMAGE (Any one fire) \$1,000,000 MED EXP (Any one person) \$ 10,000								
	AUTOMOBILE LIABILITY <input type="checkbox"/> ANY AUTO <input type="checkbox"/> ALL OWNED AUTOS <input type="checkbox"/> SCHEDULED AUTOS <input type="checkbox"/> HIRED AUTOS <input type="checkbox"/> NON-OWNED AUTOS				COMBINED SINGLE LIMIT \$ BODILY INJURY (Per person) \$ BODILY INJURY (Per accident) \$ PROPERTY DAMAGE \$								
	GARAGE LIABILITY <input type="checkbox"/> ANY AUTO				AUTO ONLY - EA ACCIDENT \$ OTHER THAN AUTO ONLY: EACH ACCIDENT \$ AGGREGATE \$								
	EXCESS LIABILITY <input type="checkbox"/> UMBRELLA FORM <input type="checkbox"/> OTHER THAN UMBRELLA FORM				EACH OCCURRENCE \$ AGGREGATE \$								
	WORKERS COMPENSATION AND EMPLOYERS' LIABILITY THE PROPRIETOR/PARTNERS/EXECUTIVE OFFICERS ARE: <input type="checkbox"/> INCL <input type="checkbox"/> EXCL				<table border="1"> <tr> <td>WC STATUTORY LIMITS</td> <td>OTHER</td> </tr> <tr> <td>EL EACH ACCIDENT</td> <td>\$</td> </tr> <tr> <td>EL DISEASE-POLICY LIMIT</td> <td>\$</td> </tr> <tr> <td>EL DISEASE-EA EMPLOYEE</td> <td>\$</td> </tr> </table>	WC STATUTORY LIMITS	OTHER	EL EACH ACCIDENT	\$	EL DISEASE-POLICY LIMIT	\$	EL DISEASE-EA EMPLOYEE	\$
WC STATUTORY LIMITS	OTHER												
EL EACH ACCIDENT	\$												
EL DISEASE-POLICY LIMIT	\$												
EL DISEASE-EA EMPLOYEE	\$												
	OTHER												

DESCRIPTION OF OPERATIONS/LOCATIONS/VEHICLES/SPECIAL ITEMS

CERTIFICATE HOLDER IS NAMED AS ADDITIONAL INSURED RE: SIDEWALK SIGN

CERTIFICATE HOLDER

CITY OF PORTLAND

389 CONGRESS STREET
PORTLAND, ME 04101

CANCELLATION

SHOULD ANY OF THE ABOVE DESCRIBED POLICIES BE CANCELLED BEFORE THE EXPIRATION DATE THEREOF, THE ISSUING COMPANY WILL ENDEAVOR TO MAIL 10 DAYS WRITTEN NOTICE TO THE CERTIFICATE HOLDER NAMED TO THE LEFT, BUT FAILURE TO MAIL SUCH NOTICE SHALL IMPOSE NO OBLIGATION OR LIABILITY OF ANY KIND UPON THE COMPANY, ITS AGENTS, OR REPRESENTATIVES.

AUTHORIZED REPRESENTATIVE

ROBERTA RUMPF

BUILDING PERMIT REPORT

DATE: 24/sep/99 ADDRESS: 505 Fore St. CBL: 038-C-016

REASON FOR PERMIT: Side walk sign -

BUILDING OWNER: Tracy - Causer Limited

PERMIT APPLICANT: /Contractor Scarborough Sign

USE GROUP Signage - CONSTRUCTION TYPE

The City's Adopted Building Code (The BOCA National Building Code/1996 with City Amendments)
The City's Adopted Mechanical Code (The BOCA National Mechanical Code/1993)

CONDITION(S) OF APPROVAL

This permit is being issued with the understanding that the following conditions are met: X/

Approved with the following conditions:

- 1. This permit does not excuse the applicant from meeting applicable State and Federal rules and laws.
2. Before concrete for foundation is placed, approvals from the Development Review Coordinator and Inspection Services must be obtained. (A 24 hour notice is required prior to inspection) ALL LOT LINES SHALL BE CLEARLY MARKED BEFORE CALLING.
3. Foundation drain shall be placed around the perimeter of a foundation that consists of gravel or crushed stone containing not more than 10 percent material that passes through a No. 4 sieve.
4. Foundations anchors shall be a minimum of 1/2" in diameter, 7" into the foundation wall, minimum of 12" from corners of foundation and a maximum 6' o.c. between bolts.
5. Waterproofing and dampproofing shall be done in accordance with Section 1813.0 of the building code.
6. Precaution must be taken to protect concrete from freezing. Section 1908.0
7. It is strongly recommended that a registered land surveyor check all foundation forms before concrete is placed. This is done to verify that the proper setbacks are maintained.
8. Private garages located beneath habitable rooms in occupancies in Use Group R-1, R-2, R-3 or I-1 shall be separated from adjacent interior spaces by fire partitions and floor/ceiling assembly which are constructed with not less than 1-hour fire resisting rating.
9. All chimneys and vents shall be installed and maintained as per Chapter 12 of the City's Mechanical Code.
10. Sound transmission control in residential building shall be done in accordance with Chapter 12, Section 1214.0 of the City's Building Code.
11. Guardrails & Handrails: A guardrail system is a system of building components located near the open sides of elevated walking surfaces for the purpose of minimizing the possibility of an accidental fall from the walking surface to the lower level.
12. Headroom in habitable space is a minimum of 7'6". (Section 1204.0)
13. Stair construction in Use Group R-3 & R-4 is a minimum of 10" tread and 7 1/4" maximum rise. All other Use Group minimum 11" tread, 7" maximum rise. (Section 1014.0)
14. The minimum headroom in all parts of a stairway shall not be less than 80 inches. (6'8") 1014.4
15. Every sleeping room below the fourth story in buildings of Use Groups R and I-1 shall have at least one operable window or exterior door approved for emergency egress or rescue.

16. Each apartment shall have access to two (2) separate, remote and approved means of egress. A single exit is acceptable when it exits directly from the apartment to the building exterior with no communications to other apartment units. (Section 1010.1)
17. All vertical openings shall be enclosed with construction having a fire rating of at least one (1) hour, including fire doors with self closer's. (Over 3 stories in height requirements for fire rating is two (2) hours.) (Section 710.0)
18. The boiler shall be protected by enclosing with (1)hour fire rated construction including fire doors and ceiling, or by providing automatic extinguishment. (Table 302.1.1)
19. All single and multiple station smoke detectors shall be of an approved type and shall be installed in accordance with the provisions of the City's Building Code Chapter 9, Section 920.3.2 (BOCA National Building Code/1996), and NFPA 101 Chapter 18 & 19. (Smoke detectors shall be installed and maintained at the following locations):
 - In the immediate vicinity of bedrooms
 - In all bedrooms
 - In each story within a dwelling unit, including basements
 In addition to the required AC primary power source, required smoke detectors in occupancies in Use Groups R-2, R-3 and I-1 shall receive power from a battery when the AC primary power source is interrupted. (Interconnection is required) Section 920.3.2.
20. A portable fire extinguisher shall be located as per NFPA #10. They shall bear the label of an approved agency and be of an approved type. (Section 921.0)
21. The Fire Alarm System shall maintained to NFPA #72 Standard.
22. The Sprinkler System shall maintained to NFPA #13 Standard.
23. All exit signs, lights and means of egress lighting shall be done in accordance with Chapter 10 Section & Subsections 1023.0 & 1024.0 of the City's Building Code. (The BOCA National Building Code/1996)
24. Section 25-135 of the Municipal Code for the City of Portland states, "No person or utility shall be granted a permit to excavate or open any street or sidewalk from the time of November 15 of each year to April 15 of the following year".
25. The builder of a facility to which Section 4594-C of the Maine State Human Rights Act Title 5 MRSA refers, shall obtain a certification from a design professional that the plans commencing construction of the facility, the builder shall submit the certification the Division of Inspection Services.
26. Ventilation shall meet the requirements of Chapter 12 Sections 1210.0 of the City's Building Code. (Crawl spaces & attics).
27. All electrical, plumbing and HVAC permits must be obtained by a Master Licensed holders of their trade. **No closing in of walls until all electrical (min.72 hours notice) and plumbing inspections have been done.**
28. All requirements must be met before a final Certificate of Occupancy is issued.
29. All building elements shall meet the fastening schedule as per Table 2305.2 of the City's Building Code (the BOCA National Building Code/1996).
30. Ventilation of spaces within a building shall be done in accordance with the City's Mechanical Code (The BOCA National Mechanical Code/1993). (Chapter M-16)
31. Please read and implement the attached Land Use Zoning report requirements.
32. Boring, cutting and notching shall be done in accordance with Sections 2305.4.4, 2305.5.1 and 2305.5.3 of the City's Building Code.
33. Glass and glazing shall meet the requirements of Chapter 24 of the building code.
34. All signage, shall be done in accordance with Section 3102.0 signs of the City's Building Code, (The BOCA National Building Code 1996).
35. *The proposed sign shall meet the rules of the city's portable sidewalk sign requirements.*
36. _____
37. _____
38. _____

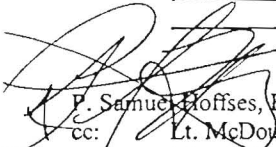
 P. Samuel Hoffses, Building Inspector
 cc: Lt. McDougall, PFD
 Marge Schmuckal, Zoning Administrator

PSH 7/24/99

****On the basis of plans submitted and conditions placed on these plans any deviations shall require a separate approval.**