

City of Portland, Maine - Building or Use Permit Application
 389 Congress Street, 04101 Tel: (207) 874-8703, Fax: (207) 874-8716

PERMIT ISSUED

Permit No: 02-0386
 Date Issued: MAY 17 2002
 CBL: 038 C014001

| | | | |
|--|---------------------------------|---|----------------------|
| Location of Construction: 8 Cotton St | Owner Name: Jordan, Mark | Owner Address: P.O. Box 1047 | Phone: 883-9051 |
| Business Name: | Contractor Name: The Signery | Contractor Address: 299 Forest Avenue Portland | Phone: 2078797700 |
| Lessee/Buyer's Name | Phone: | Permit Type: Signs - Permanent | Zone: B-3 |

| | | | | |
|---------------------------------|-------------------------------------|------------------------|--------------------------|--------------------|
| Past Use: Restaurant/Cantina | Proposed Use: Restaurant/Cantina | Permit Fee: \$30.00 | Cost of Work: \$62.00 | CEO District: 1 |
|---------------------------------|-------------------------------------|------------------------|--------------------------|--------------------|

| | | |
|--|--|--|
| Proposed Project Description: Install Two 2' x 8' Signs/ Attached to Building | FIRE DEPT: <input type="checkbox"/> Approved <input checked="" type="checkbox"/> Denied Signature: <i>N/A</i> | INSPECTION: Use Group: U Type: Sign BOCA 1999 Signature: <i>[Signature]</i> |
|--|--|--|

| | | |
|---|-------------------------------|-------|
| PEDESTRIAN ACTIVITIES DISTRICT (P.A.D.) | | |
| Action: <input type="checkbox"/> Approved <input checked="" type="checkbox"/> Approved w/Conditions <input type="checkbox"/> Denied | Signature: <i>[Signature]</i> | Date: |

| | | |
|-------------------------|---------------------------------|------------------------|
| Permit Taken By: gad | Date Applied For: 04/18/2002 | Zoning Approval |
|-------------------------|---------------------------------|------------------------|

| | | | |
|--|---|---|---|
| 1. This permit application does not preclude the Applicant(s) from meeting applicable State and Federal Rules. 2. Building permits do not include plumbing, septic or electrical work. 3. Building permits are void if work is not started within six (6) months of the date of issuance. False information may invalidate a building permit and stop all work.. | Special Zone or Reviews <input type="checkbox"/> Shoreland <input type="checkbox"/> Wetland <input type="checkbox"/> Flood Zone <input type="checkbox"/> Subdivision <input type="checkbox"/> Site Plan Maj <input type="checkbox"/> Minor <input type="checkbox"/> MM <input type="checkbox"/> Date: <i>OK 4/30/02</i> | Zoning Appeal <input type="checkbox"/> Variance <input type="checkbox"/> Miscellaneous <input type="checkbox"/> Conditional Use <input type="checkbox"/> Interpretation <input type="checkbox"/> Approved <input type="checkbox"/> Denied Date: | Historic Preservation <input type="checkbox"/> Not in District or Landmark <input type="checkbox"/> Does Not Require Review <input type="checkbox"/> Requires Review <input checked="" type="checkbox"/> Approved <input type="checkbox"/> Approved w/Conditions <input type="checkbox"/> Denied to D.A. 4/30/02 Date: <i>DA 5/10/02</i> |
|--|---|---|---|

CERTIFICATION

I hereby certify that I am the owner of record of the named property, or that the proposed work is authorized by the owner of record and that I have been authorized by the owner to make this application as his authorized agent and I agree to conform to all applicable laws of this jurisdiction. In addition, if a permit for work described in the application is issued, I certify that the code official's authorized representative shall have the authority to enter all areas covered by such permit at any reasonable hour to enforce the provision of the code(s) applicable to such permit.

| | | | |
|---|---------|------|-------|
| SIGNATURE OF APPLICANT | ADDRESS | DATE | PHONE |
| | | | |
| RESPONSIBLE PERSON IN CHARGE OF WORK, TITLE | | DATE | PHONE |
| | | | |

SIGNAGE PRE-APPLICATION

PLEASE ANSWER ALL QUESTIONS

ADDRESS: 10 Cotton Street ZONE: B-3

OWNER: Mark Jordan

APPLICANT: Lance Meader

ASSESSOR NO. 5744

PLEASE CIRCLE APPROPRIATE ANSWER

SINGLE TENANT LOT? YES NO MULTI-TENANT LOT? YES NO

FREESTANDING SIGN? (ex. Pole Sign) YES NO --- DIMENSIONS _____ HEIGHT _____

MORE THAN ONE SIGN? YES NO DIMENSIONS _____ HEIGHT _____

SIGN ATTACHED TO BLDG.? YES NO DIMENSIONS 2' x 8'

MORE THAN ONE SIGN? YES NO DIMENSIONS 2' x 8'

AWNING: YES NO IS AWNING BACKLIT? YES NO HEIGHT OFF SIDEWALK 7'

IS THERE ANY MESSAGE, TRADEMARK OR SYMBOL ON IT?

LIST ALL EXISTING SIGNAGE AND THEIR DIMENSIONS:

No existing signage, only brackets remain from previous sign.

~~10 Cotton Street~~
10 Cotton Street

16 ft
16 ft
32 ft

*** TENANT BLDG. FRONTAGE (IN FEET): 25' H x 50' W = 1250 sq. ft

*** REQUIRED INFORMATION

AREA FOR COMPUTATION

YOU SHALL PROVIDE:

A SITE SKETCH AND BUILDING SKETCH SHOWING EXACTLY WHERE EXISTING AND NEW SIGNAGE IS LOCATED MUST BE PROVIDED. SKETCHES AND/OR PICTURES OF PROPOSED ARE ALSO REQUIRED.

SIGNATURE OF APPLICANT: [Signature] DATE: 4-17-2

10 COTTON ST,

black wood
w/ gold letter.

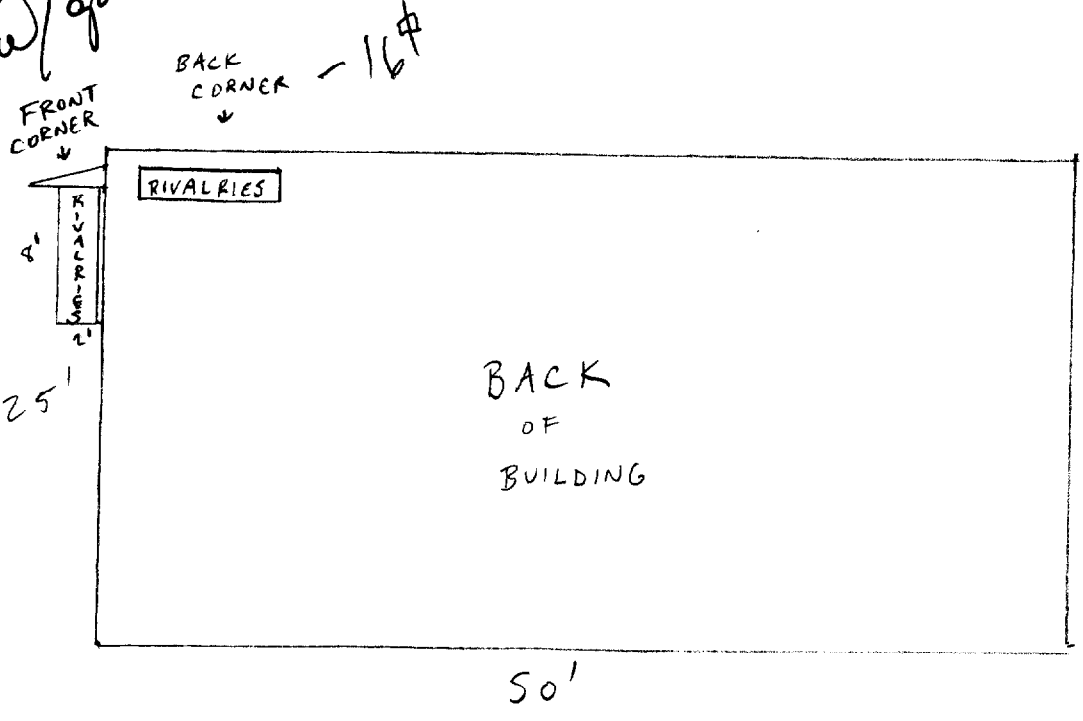

existing
Brackett

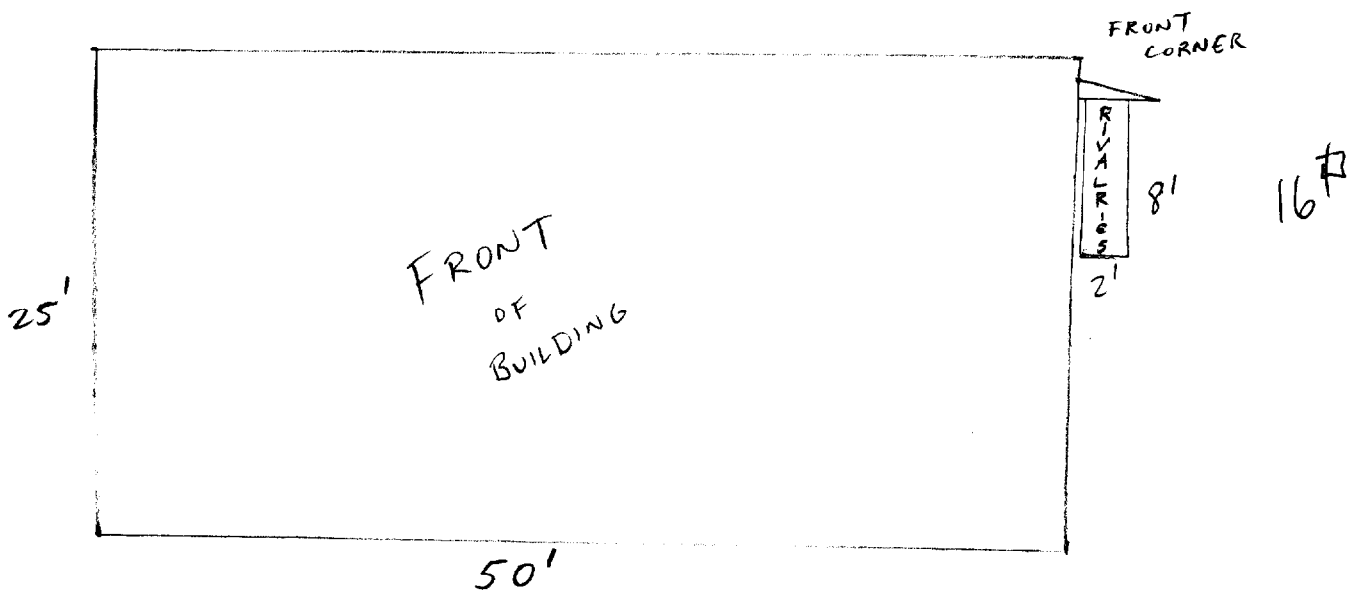

PRIVATE
PARKING
LOT

Lagged - 1/2" - 6 Bolts
into masonry

50'

2'x5' sign

10 COTTON ST,

TOP
OF
BUILDING

45'

PRIVATE
PARKING
LOT

sign
↓

SIDEWALK

8'

COTTON ST,

02-0386

THIS IS NOT A PERMIT/CONSTRUCTION MAY NOT COMMENCE UNTIL THE PERMIT IS ISSUED

Signage Application

If you or the property owner owes real estate or personal property taxes or user charges on any property within the City, payment arrangements must be made before permits of any kind are accepted.

| | | |
|---|--|---|
| Location/Address of Construction: <u>10 Cotton Street</u> | | |
| Total Square Footage of Proposed Structure <u>32 sq. ft.</u> | Square Footage of Lot 5'4" <u>50'W x 45'D</u> | |
| Tax Assessor's Chart, Block & Lot Chart# <u>38</u> Block# <u>C</u> Lot# <u>014</u> 3777 | Owner: <u>Mark Jordan</u> | Telephone: <u>883-9051</u> |
| Lessee/Buyer's Name (If Applicable) | Applicant name, address & telephone: <u>Lance Meader</u> <u>59 State St. #6</u> <u>831-8539</u> | Total s.f. of signage <u>32</u> x 1.00 per s.f. \$ <u>32</u> , plus \$30.00 base fee Fee: \$ <u>62</u> |
| Current use: <u>Restaurant / Catering</u> | | |
| If the location is currently vacant, what was prior use: <u>Restaurant</u> | | |
| Approximately how long has it been vacant: <u>8-12 months</u> | | |
| Proposed use: <u>Restaurant / Rivalries, LLC</u> | | |
| Project description: <u>2 signs - both attached to building Both 8' x 8'</u> | | |
| Contractor's name, address & telephone: <u>The Signery - Don Wright 299 Forest Ave.</u> | | |
| Who should we contact when the permit is ready: <u>Lance Meader 831-8539</u> | | |
| Mailing address: <u>59 State St. #6</u> <u>Portland, ME 04101</u> <u>→ call</u> | | |
| We will contact you by phone when the permit is ready. You must come in and pick up the permit and review the requirements before starting any work, with a Plan Reviewer. A stop work order will be issued and a \$50.00 fee if any work starts before the permit is picked up. Phone: <u>831-8539</u> | | |

DEPT. OF BUILDING INSPECTION
CITY OF PORTLAND, ME
APR 18 2002
RECEIVED

IF THE REQUIRED INFORMATION IS NOT INCLUDED IN THE SUBMISSIONS THE PERMIT WILL BE AUTOMATICALLY DENIED AT THE DISCRETION OF THE BUILDING/PLANNING DEPARTMENT, WE MAY REQUIRE ADDITIONAL INFORMATION IN ORDER TO APPROVE THIS PERMIT.

I hereby certify that I am the Owner of record of the named property, or that the owner of record authorizes the proposed work and that I have been authorized by the owner to make this application as his/her authorized agent. I agree to conform to all applicable laws of this jurisdiction. In addition, if a permit for work described in this application is issued, I certify that the Code Official's authorized representative shall have the authority to enter all areas covered by this permit at any reasonable hour to enforce the provisions of the codes applicable to this permit.

| | |
|--|---------------------|
| Signature of applicant: <u>[Signature]</u> | Date: <u>4-17-2</u> |
|--|---------------------|

This is NOT a permit, you may not commence ANY work until the permit is issued. If you are in a Historic District you may be subject to additional permitting and fees with the Planning Department on the 4th floor of City Hall

505 Main Street Saco Corp
POB 1047
Scarborough, Me 04070-1047

April 17, 2002

Re: Rivalries signage

Lance:

I have reviewed your plans for the signs and have no issue with the placement or design of them. All permits must be in hand before the installation of the signs.

Regards,

Mark Jordan

A handwritten signature in black ink, consisting of a series of loops and a long horizontal stroke extending to the right.