

**GAWRON TURGEON ARCHITECTS**  
 29 Black Point Road  
 Scarborough, ME 04074  
 www.gawronturgeon.com  
 Tel. 207. 883. 6307  
 Fax. 207. 883. 0361

**PRUDENTIAL**  
 TWO PORTLAND SQUARE FOURTH FLOOR  
 PORTLAND, MAINE

**LIGHTING LEGEND**

- 2X4 RT5
- 6" INTERIOR RECESSED FLUORESCENT DOWNLIGHT
- DECORATIVE SMALL PENDANT - TECH LIGHTING - CEILING MOUNT STYLE; PROVIDE AN ALLOWANCE OF \$200.00
- DECORATIVE SEMI-FLUSH PENDANT - TECH LIGHTING - CEILING MOUNT STYLE; PROVIDE AN ALLOWANCE OF \$450.00

ACT1- ARMSTRONG CEILING, DUNE 1 1/2" ANGLED TEGULAR 24x24x8"  
 ACT2- MATCH EXISTING 2x2 ACT CEILING TILE & GRID SYSTEM

**NOTES:**

1. INTERIOR FIXTURE LEGEND FOR DESIGN INTENT ONLY. REFER TO ELECTRICAL DRAWINGS FOR LIGHT FIXTURE TYPES AND CIRCUITING.
2. MECHANICAL SUBCONTRACTOR TO VERIFY SIZE AND LOCATION OF ANY MECHANICAL REGISTERS WITH ARCHITECT PRIOR TO CONSTRUCTION. LIGHTING LOCATIONS SHALL TAKE PRECEDENCE.
3. SWITCH ALL OFFICES INDEPENDENTLY. DOUBLE SWITCH ALL CONFERENCE ROOMS.
4. INDEPENDENTLY AND DOUBLE SWITCH LAMPS OF 2x4 RT5 FIXTURES.
5. INDEPENDENTLY SWITCH DECORATIVE PENDANT LIGHTS.
6. GENERAL CONTRACTOR TO LAYOUT THE LOCATION OF CIRCULAR PARTITIONS & SOFFITS BY MARKING-UP ON THE CONC. FLOOR FOR ARCHITECTS REVIEW AND APPROVAL PRIOR TO CONSTRUCTION.
7. ELECTRICAL CONTRACTOR SHALL COORDINATE OWNER SUPPLIED TELEPHONE & DATA BOXES WITH LOCATIONS OF OUTLETS.
8. G.C. TO COORDINATE ALL SPECIALTY EQUIPMENT WITH TENANTS VENDOR.
9. G.C. TO INVENTORY ALL EXISTING PARABOLICS AND PROVIDE A QUANTITY FOR HOW MANY CAN BE REUSED.
10. STAFF LOUNGE 433 - DOUBLE SWITCH LAMPS SO THAT 2 LAMPS ARE ON ONE SWITCH AND 1 LAMP IS ON ONE SWITCH.
11. SWITCH RECESSED LIGHTS AT RECEPTION AREA INDEPENDENT FROM WAITING ROOM & ENTRY.
12. PROVIDE A SEPARATE SWITCH FOR AV PROJECTION.
13. INDEPENDENTLY SWITCH RECESSED CANS AT CONFERENCE 2 415.

**D17 FIXTURE LEGEND/NOTES**

- PHASE I
- PHASE II
- PHASE III
- SOLID WALLS REPRESENT NEW WALLS IN EXISTING FACILITY
- EXISTING WALLS AND/OR AREAS TO REMAIN
- EXISTING WALLS TO BE REMOVED

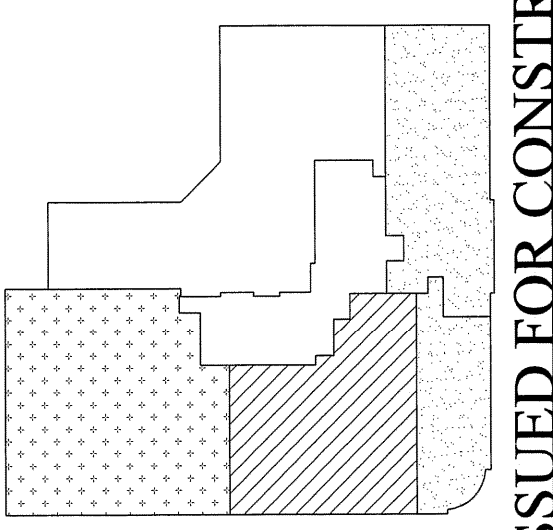

**ISSUED FOR CONSTRUCTION**

**REVISIONS**

#	DATE	DESCRIPTION

DATE:	01-21-08
PROJECT #:	110807
DRAWN BY:	DLP
CHECKED BY:	MET/SWG
DRAWING SCALE:	AS NOTED

**SHEET TITLE**  
 FOURTH FLOOR PLAN  
 REFLECTED CEILING PLAN

**A300**

© COPYRIGHT 1985-2003  
 REPRODUCTION OR REUSE OF  
 THIS DOCUMENT WITHOUT  
 WRITTEN PERMISSION OF  
 GAWRON ARCHITECTS IS PROHIBITED

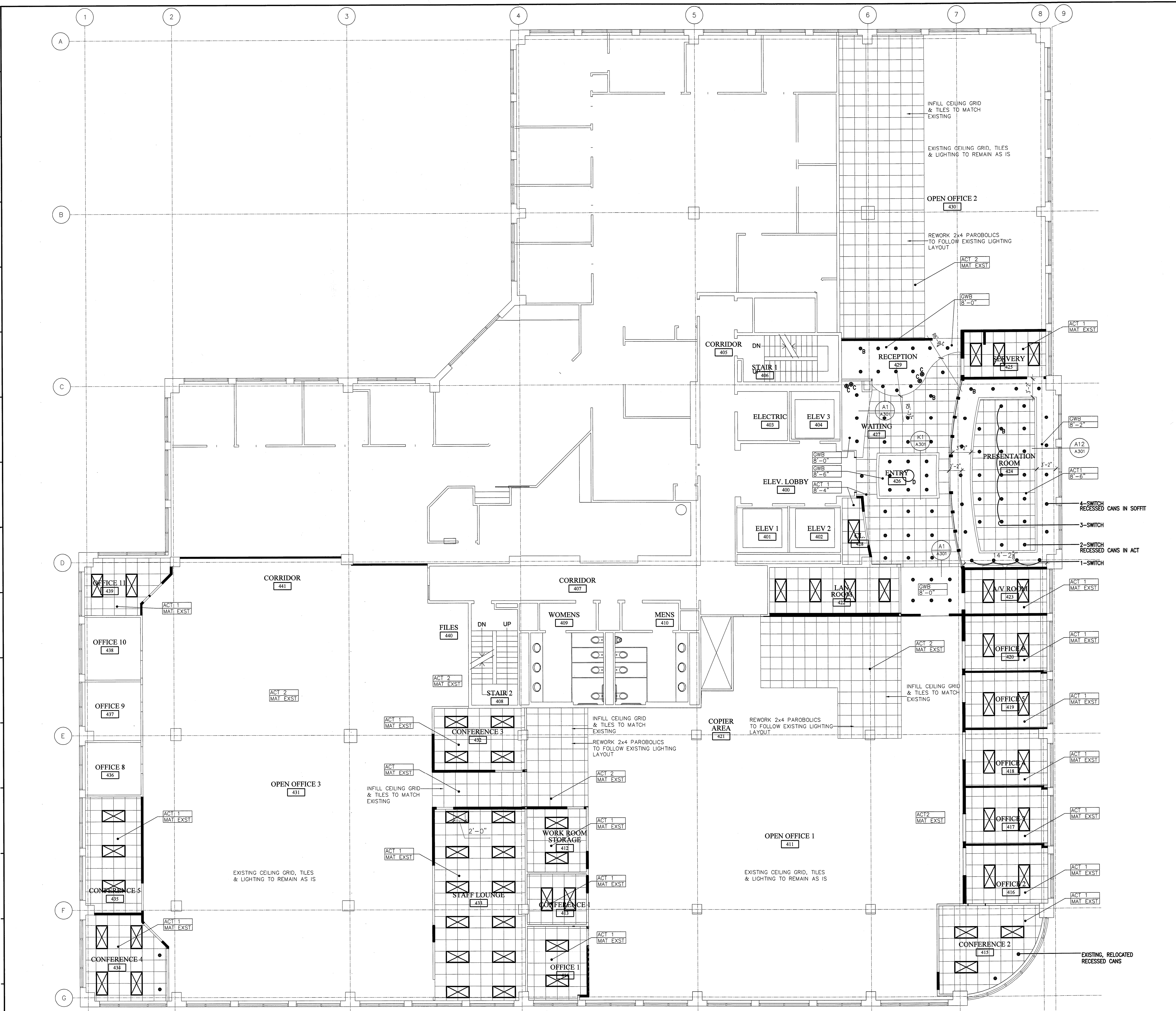

**A1 FOURTH FLOOR PLAN - REFLECTED CEILING PLAN**  
 1/8"=1'-0"

**A17 KEY PLAN**



NTS PLAN NORTH