

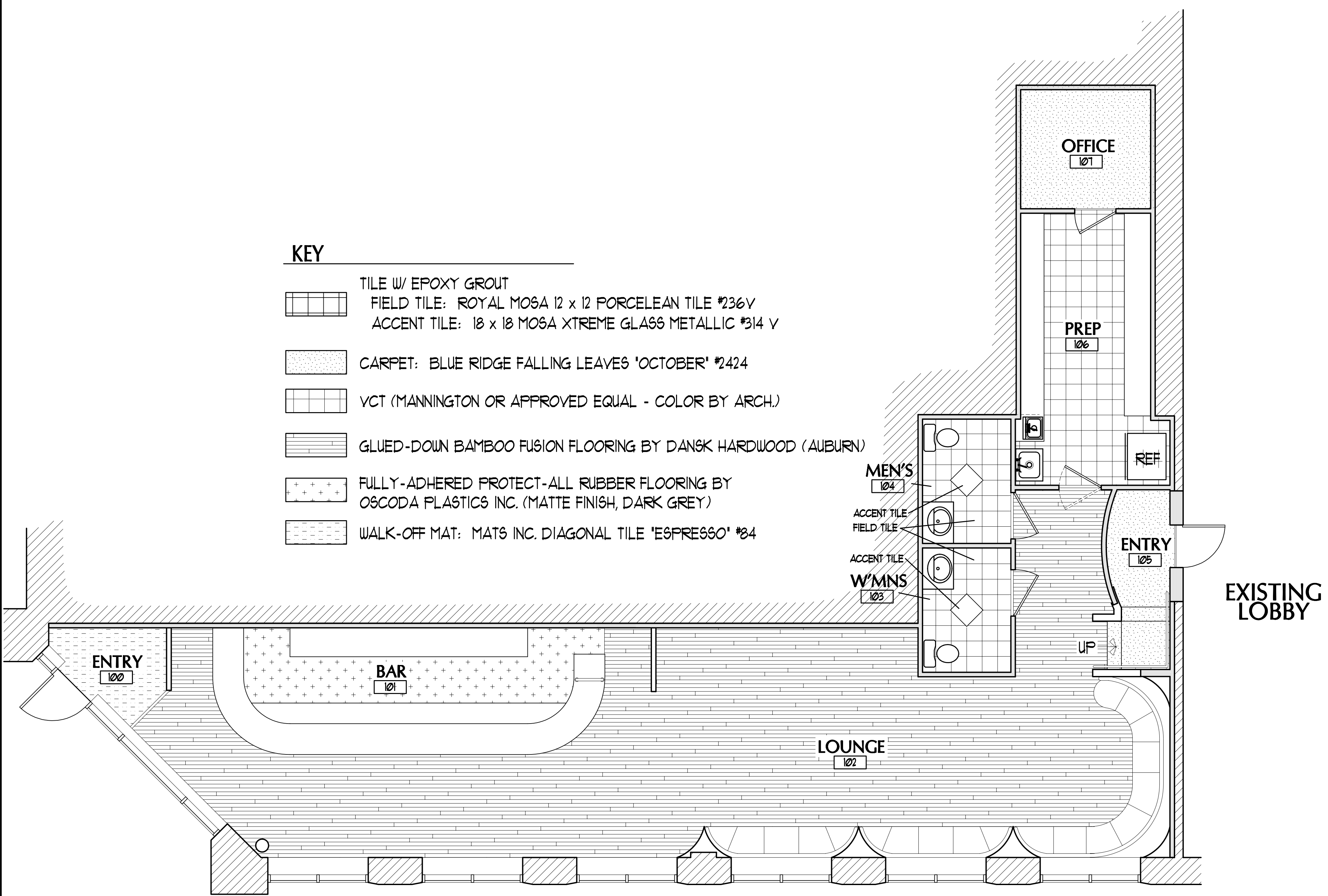

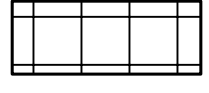

IF THIS SHEET IS NOT 24 X 36 IT IS A REDUCED SCALE PRINT - SCALE ACCORDINGLY

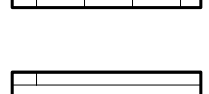
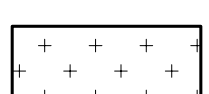
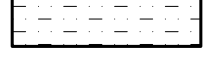

KEY

-  TILE W/ EPOXY GROUT
FIELD TILE: ROYAL MOSA 12 x 12 PORCELEAN TILE #236V
ACCENT TILE: 18 x 18 MOSA XTREME GLASS METALLIC #314 V
-  CARPET: BLUE RIDGE FALLING LEAVES 'OCTOBER' #2424
-  VCT (MANNINGTON OR APPROVED EQUAL - COLOR BY ARCH.)
-  GLUED-DOWN BAMBOO FUSION FLOORING BY DANSK HARDWOOD (AUBURN)
-  FULLY-ADHERED PROTECT-ALL RUBBER FLOORING BY OSCODA PLASTICS INC. (MATTE FINISH, DARK GREY)
-  WALK-OFF MAT: MATS INC. DIAGONAL TILE 'ESPRESSO' #84

FLOOR FINISHES PLAN
SCALE: 1/4" = 1'-0"

EXISTING LOBBY

NOTES

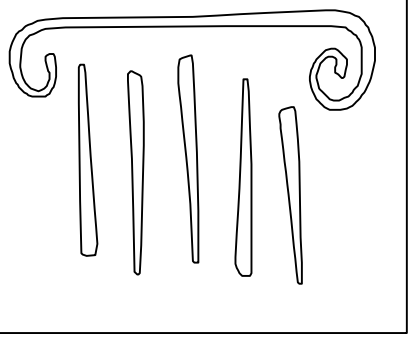

PORT CITY ARCHITECTURE

65 NEWBURY STREET
PORTLAND, ME 04101
207.761.9000
fax: 207.761.2010
info@portcityarch.com

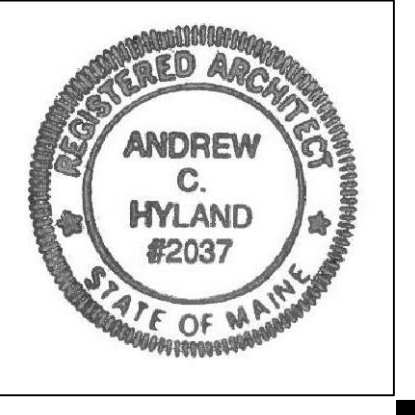

CONSULTANTS:

Electrical Systems of Maine
Mr. John Tarr, P.E.
1200 MINOT AVE.
P.O. BOX 1365
AUBURN, MAINE 04211
207-183-1126

Perkins Restaurant Equipment
Mr. Steve Zafiron
630 JOHN HANCOCK RD.
TAUNTON, MA 02780
207-632-3136

RSE Construction
Mr. R. Shane Estes
120 TARGETT ROAD
NEW GLOUCESTER, ME 04260
207-326-3881

Ginkgo Blue
2 Portland Square
Suite 104
Union Street
Portland, Maine
04101

REVISIONS	
DATE	DESCRIPTION

Date Issued: 12-17-2009

Project Number: 09201

Drawing Scale: AS DRAWN

SHEET NAME:

FL. FINISHES PLAN

Drawn By:

mac

Checked By:

ach

A3.0