



1 LEVEL 7 FLOOR PLAN

**BUILDING USE:**  
 BUILDING IS MIXED USE WITH FIRST FLOOR RETAIL/RECREATION,  
 AND THE REMAINDER OF THE BUILDING IS BUSINESS OCCUPANCY.

**BUILDING AREA:**  
 HEIGHT: 1 STORIES

**AREA:**  
 BUILDING TOTAL: 83,573 SF  
 7TH FLOOR: 20,000 SF  
 TENANT SPACE: 531 SF

**FIRE PROTECTION:**  
 EXISTING BUILDING IS FULLY SPRINKLED  
 EXISTING RATINGS WILL BE MAINTAINED.

ARCHITECTURE AND INTERIOR DESIGN

RSP ARCHITECT, LTD.  
 220 W. MARSHALL STREET NE  
 MINNEAPOLIS, MN 55413

PHONE: 612-671-1100  
 FAX: 612-671-1100  
 EMAIL: RSP@RSPARCH.COM

**EXITING ANALYSIS - LEVEL 7**

ROOM NUMBER	ROOM NAME	AREA S.F.	OCCUPANCY/LOAD FACTOR	OCCUPANCY LOAD	REQUIRED EXIT WIDTH (INCHES OCC. LOAD X 0.2)	NUMBERS OF EXITS REQUIRED	NUMBERS OF EXITS PROVIDED
701	Reception	334	100	4	0.8	1	1
702	Storage	20	300	2	0.2	1	1
703	Reception	40	300	2	0.2	1	1
704	Reception	40	300	2	0.2	1	1
705	Storage	300	300	2	0.2	1	1
706	Multi-Purpose	437	15	30	6	1	1
707	Small Conference	140	15	10	2	1	1
708	Small Conference	140	15	10	2	1	1
709	Small Conference	140	15	10	2	1	1
710	Office	102	100	2	0.4	1	1
711	Office	108	100	2	0.4	1	1
712	Office	140	100	2	0.4	1	1
713	Office	140	100	2	0.4	1	1
714	Office	110	100	2	0.4	1	1
715	Office	110	100	2	0.4	1	1
716	Office	115	100	2	0.4	1	1
717	Office	115	100	2	0.4	1	1
718	Office	115	100	2	0.4	1	1
719	Office	115	100	2	0.4	1	1
720	Office	180	100	2	0.4	1	1
721	Office	117	100	2	0.4	1	1
722	Office	112	100	2	0.4	1	1
723	Office	112	100	2	0.4	1	1
724	Office	124	100	2	0.4	1	1
725	Office	116	100	2	0.4	1	1
726	Work Room	100	100	1	0.2	1	1
727	Work Room	100	100	1	0.2	1	1
728	Office	110	100	2	0.4	1	1
729	Office	119	100	2	0.4	1	1
730	Office	119	100	2	0.4	1	1
731	Office	119	100	2	0.4	1	1
732	Small Conference	151	15	11	2.2	1	1
733	Coats	13	15	1	0.2	1	1
734	Storage	138	300	1	0.2	1	1
735	Storage	138	300	1	0.2	1	1
736	Storage	138	300	1	0.2	1	1
737	Storage	138	300	1	0.2	1	1
738	Storage	138	300	1	0.2	1	1
739	Storage	138	300	1	0.2	1	1
740	Storage	138	300	1	0.2	1	1
741	Storage	138	300	1	0.2	1	1
742	Storage	138	300	1	0.2	1	1
743	Storage	138	300	1	0.2	1	1
744	Storage	138	300	1	0.2	1	1
745	Storage	138	300	1	0.2	1	1
746	Storage	138	300	1	0.2	1	1
747	Storage	138	300	1	0.2	1	1
748	Storage	138	300	1	0.2	1	1
749	Storage	138	300	1	0.2	1	1
750	Storage	138	300	1	0.2	1	1
751	Storage	138	300	1	0.2	1	1
752	Storage	138	300	1	0.2	1	1
753	Storage	138	300	1	0.2	1	1
754	Storage	138	300	1	0.2	1	1
755	Storage	138	300	1	0.2	1	1
756	Storage	138	300	1	0.2	1	1
757	Storage	138	300	1	0.2	1	1
758	Storage	138	300	1	0.2	1	1
759	Storage	138	300	1	0.2	1	1
760	Storage	138	300	1	0.2	1	1
761	Storage	138	300	1	0.2	1	1
762	Storage	138	300	1	0.2	1	1
763	Storage	138	300	1	0.2	1	1
764	Storage	138	300	1	0.2	1	1
765	Storage	138	300	1	0.2	1	1
766	Storage	138	300	1	0.2	1	1
767	Storage	138	300	1	0.2	1	1
768	Storage	138	300	1	0.2	1	1
769	Storage	138	300	1	0.2	1	1
770	Storage	138	300	1	0.2	1	1
771	Storage	138	300	1	0.2	1	1
772	Storage	138	300	1	0.2	1	1
773	Storage	138	300	1	0.2	1	1
774	Storage	138	300	1	0.2	1	1
775	Storage	138	300	1	0.2	1	1
776	Storage	138	300	1	0.2	1	1
777	Storage	138	300	1	0.2	1	1
778	Storage	138	300	1	0.2	1	1
779	Storage	138	300	1	0.2	1	1
780	Storage	138	300	1	0.2	1	1
781	Storage	138	300	1	0.2	1	1
782	Storage	138	300	1	0.2	1	1
783	Storage	138	300	1	0.2	1	1
784	Storage	138	300	1	0.2	1	1
785	Storage	138	300	1	0.2	1	1
786	Storage	138	300	1	0.2	1	1
787	Storage	138	300	1	0.2	1	1
788	Storage	138	300	1	0.2	1	1
789	Storage	138	300	1	0.2	1	1
790	Storage	138	300	1	0.2	1	1
791	Storage	138	300	1	0.2	1	1
792	Storage	138	300	1	0.2	1	1
793	Storage	138	300	1	0.2	1	1
794	Storage	138	300	1	0.2	1	1
795	Storage	138	300	1	0.2	1	1
796	Storage	138	300	1	0.2	1	1
797	Storage	138	300	1	0.2	1	1
798	Storage	138	300	1	0.2	1	1
799	Storage	138	300	1	0.2	1	1
800	Storage	138	300	1	0.2	1	1
TOTAL		9121		169	33	2	3

LEGEND

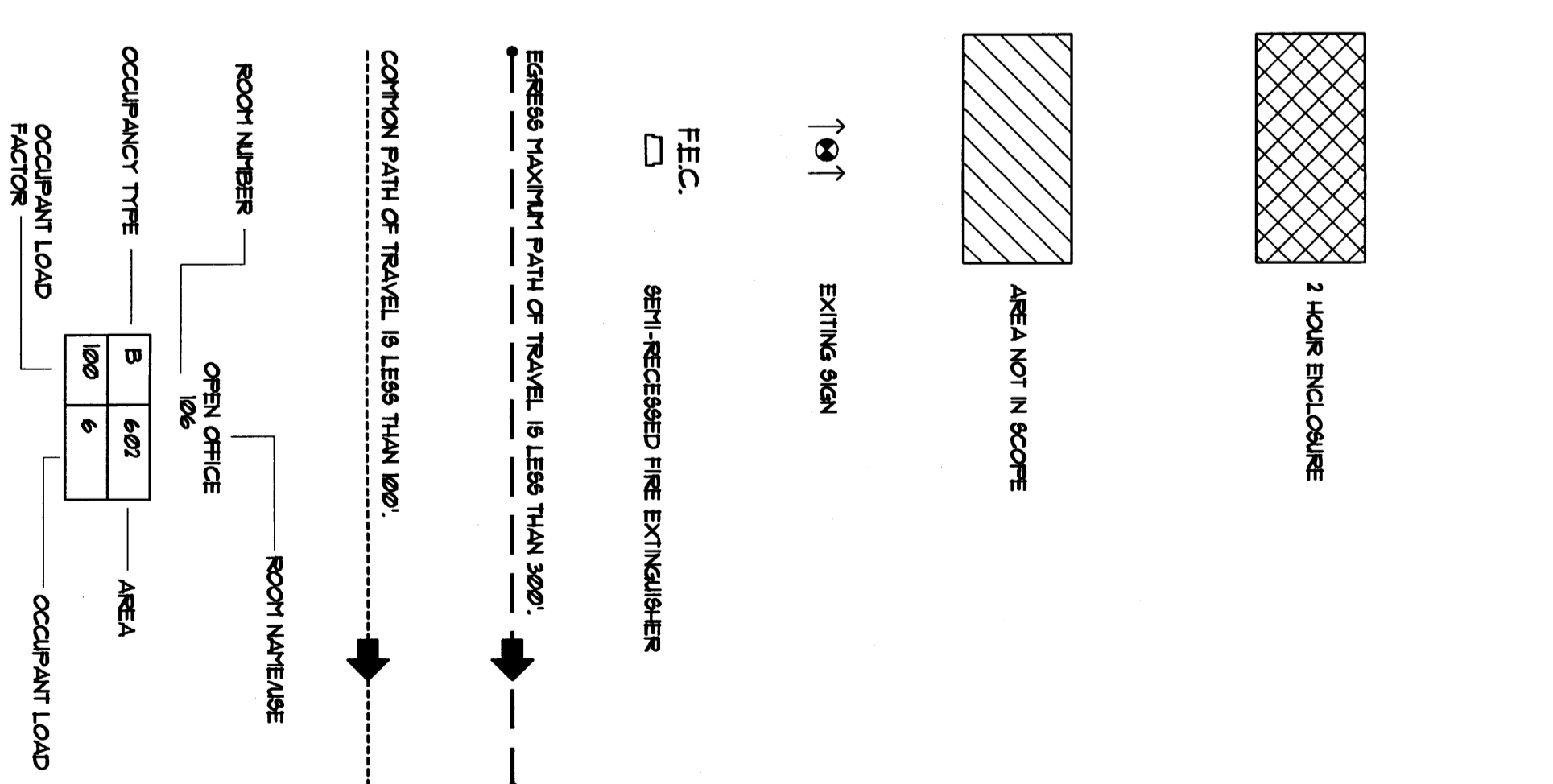

**Ameprise Financial**

**TENANT IMPROVEMENT**

AMERIPRISE FINANCIAL  
 2 PORTLAND SQUARE  
 SUITE # 701  
 PORTLAND, ME 04101

Project No: 17821080028  
 Drawn By: B.J.P.  
 Checked By: K.S.L.  
 Date: 9/18/16

NOTICE: The designs shown and described herein are the property of RSP ARCHITECT, LTD. and are to be used only for the project and location specifically identified. No part of these designs may be reproduced, stored in a retrieval system, or transmitted in any form or by any means, electronic, mechanical, photocopying, recording, or by any information storage and retrieval system, without the prior written permission of RSP ARCHITECT, LTD. All rights reserved.

**RSP Architects, Ltd.**  
 1200 Marshall Street NE  
 Minneapolis, MN 55413  
 Phone: 612-671-1100  
 Fax: 612-671-1100  
 Email: RSP@RSPARCH.COM

**REGISTERED ARCHITECT**  
 Stephen J. Faustich  
 Registration No. 3816  
 Expiration Date 9/30/17  
 Signed Date 9/30/17