

**NEW WORK KEYNOTES – THIS SHEET ONLY**

- N01 FILL IN OPENING WITH ALUMINUM FRAMING AND GLASS AND STONE FACING WITH STUD WALL BACKUP BELOW GLAZED OPENING. MATCH EXISTING.
- N02 PATCH HOLES IN HEAD JAMB AND STOOL LEFT BY REMOVAL OF LIGHTING FIXTURES.
- N03 PAINT EXISTING WINDOW STOOLS.
- N04 PROVIDE CLOSET ROD AND SHELF.
- N05 EXISTING MOP SINK AND FAUCET TO REMAIN.
- N06 EXISTING WATER HEATER AND SUPPORT SHELF ABOVE MOP SINK TO REMAIN.
- N07 NEW CONCRETE-FILLED STEEL PAN STAIR WITH CONTINUOUS STEEL PIPE HANDRAIL BOTH SIDES OF STAIR.
- N08 FURNITURE BY TENANT, TYPICAL.
- N09 EXISTING PLATFORM TO REMAIN. COVER TOP WITH 3/4" PLYWOOD TO SERVE AS BENCH SEATING.

**PARTITION TYPES - SEE DETAIL SECTIONS ON SHEET A5**

- P1 3 5/8" STEEL STUD FRAMING 16" O.C.  
5/8" GYPSUM BOARD BOTH SIDES  
ACOUSTIC INSULATION FULL HEIGHT  
PARTITION HEAD AT 9'-0" A.F.F. - BRACE TO STRUCTURE ABOVE  
ACOUSTICAL SEALANT AT FLOOR TRACK
- P2 6" STEEL STUD FRAMING 16" O.C.  
5/8" GYPSUM BOARD BOTH SIDES  
ACOUSTIC INSULATION FULL HEIGHT  
PARTITION HEAD AT 9'-0" A.F.F. - BRACE TO STRUCTURE ABOVE  
ACOUSTICAL SEALANT AT FLOOR TRACK
- P3 1 5/8" STEEL STUDS 16" O.C. BOTH SIDES OF PARTITION  
CONNECT TWO SIDES OF PARTITION WITH 3 5/8" RUNNER TRACK SPACED MAX 4'-0" O.C VERTICALLY.  
EACH STUD  
5/8" GYPSUM WALLBOARD ON FINISH SIDES OF STUDS  
ACOUSTIC INSULATION FULL HEIGHT, ONE SIDE OF PARTITION  
PARTITION HEAD AT 9'-0" A.F.F. - BRACE TO STRUCTURE ABOVE  
ACOUSTICAL SEALANT AT FLOOR TRACK

NOTE: PARTITIONS AND WALLS NOT OTHERWISE NOTED BY PARTITION TYPE OR BY NEW WORK KEYNOTE ARE EXISTING TO REMAIN. PATCH AS NECESSARY AND PAINT.

**GENERAL NOTES**

1. BEFORE BEGINNING WORK AT THE SITE, AND THROUGHOUT THE COURSE OF THE WORK, INSPECT AND VERIFY THE LOCATION AND CONDITION OF EVERY ITEM AFFECTED BY THE WORK UNDER THIS CONTRACT AND REPORT DISCREPANCIES TO ARCHITECT BEFORE BEGINNING WORK RELATED TO THAT BEING INSPECTED.
2. THE ARCHITECTURAL DRAWINGS SHOW PRINCIPAL AREAS WHERE WORK MUST BE ACCOMPLISHED UNDER THIS CONTRACT. INCIDENTAL WORK MAY ALSO BE NECESSARY IN AREAS NOT SHOWN ON THE ARCHITECTURAL DRAWINGS DUE TO CHANGES AFFECTING EXISTING MECHANICAL, ELECTRICAL, PLUMBING, OR OTHER SYSTEMS. SUCH INCIDENTAL WORK IS ALSO PART OF THIS CONTRACT. INSPECT THOSE AREAS, ASCERTAIN WORK NEEDED, AND DO THAT WORK IN ACCORDANCE WITH THE CONTRACT REQUIREMENTS, AT NO ADDITIONAL COST.
3. DO NOT DRILL OR CUT EXISTING FLOOR JOISTS, BEAMS, COLUMNS, OR OTHER STRUCTURAL MEMBERS UNLESS SPECIFICALLY INDICATED.
4. PROTECT EXISTING WORK TO REMAIN FROM DAMAGE.
5. REPAIR, PATCH, AND FINISH, OR REFINISH AS APPLICABLE, TO MATCH ADJACENT EXISTING FINISHES. THOSE EXISTING SURFACES DAMAGED OR NEWLY EXPOSED DURING PERFORMANCE OF THE WORK. PATCH OPENINGS IN EXISTING WALLS LEFT BY REMOVAL OF EXISTING ELECTRICAL BOXES. SEE ELECTRICAL DRAWINGS FOR LOCATIONS AND QUANTITIES.
6. PATCH EXISTING WALL SURFACES AS NEEDED TO PROVIDE A SMOOTH SURFACE FOR FINISHES.
7. EXCEPT IN SPACES WHERE NO WORK UNDER THIS CONTRACT IS REQUIRED, ENCLOSE EXISTING AND NEW CONDUITS, DUCTS, PIPES, AND SIMILAR ITEMS IN FURRING WHERE SUCH ITEMS PASS THROUGH FINISHED SPACES WHETHER OR NOT FURRING IS INDICATED. INSULATE IN UNHEATED SPACES.
8. WHERE CONDUITS, WIRES, PIPES, AND SIMILAR ITEMS ARE TO BE INSTALLED IN EXISTING WALLS OR PARTITIONS, NEATLY CHASE THE WALLS OR PARTITIONS, INSTALL THE ITEMS, AND PATCH THE WALLS OR PARTITIONS TO MAKE THE INSTALLATION NOT DISCERNIBLE IN THE FINISHED WORK.
9. WHERE "MATCH EXISTING" IS INDICATED, NEW CONSTRUCTION OR FINISHES, AS APPROPRIATE TO THE NOTE, SHALL MATCH THE EXISTING IN EVERY PARTICULAR.
10. DIMENSIONS ARE TO FINISH WALL SURFACE AND TO OPENING CENTERLINE UNLESS NOTED OTHERWISE.
11. DISCONNECT AND REMOVE FLOOR OUTLETS AND BOXES. FILL HOLES IN FLOOR SLAB WITH CONCRETE. SEE DETAIL 2 ON THIS SHEET.

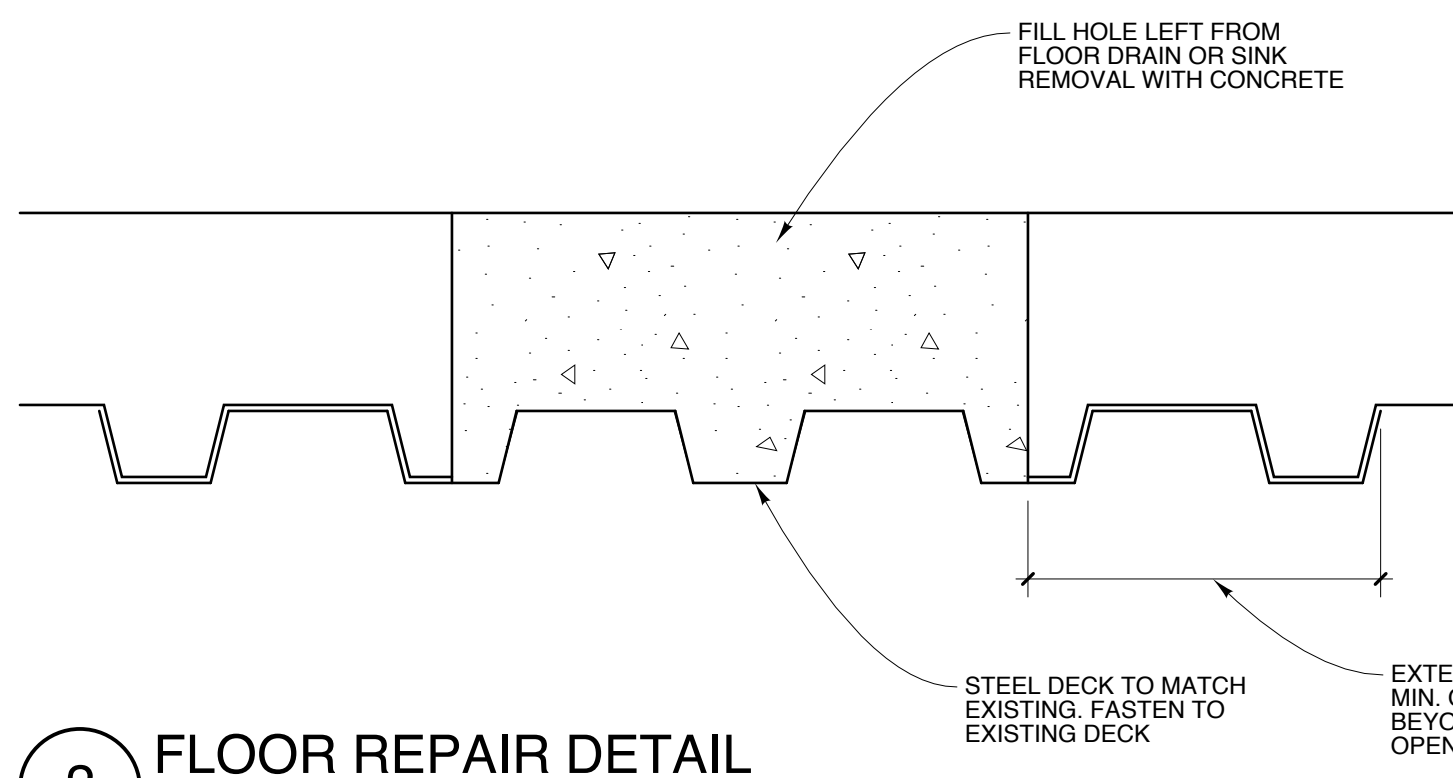
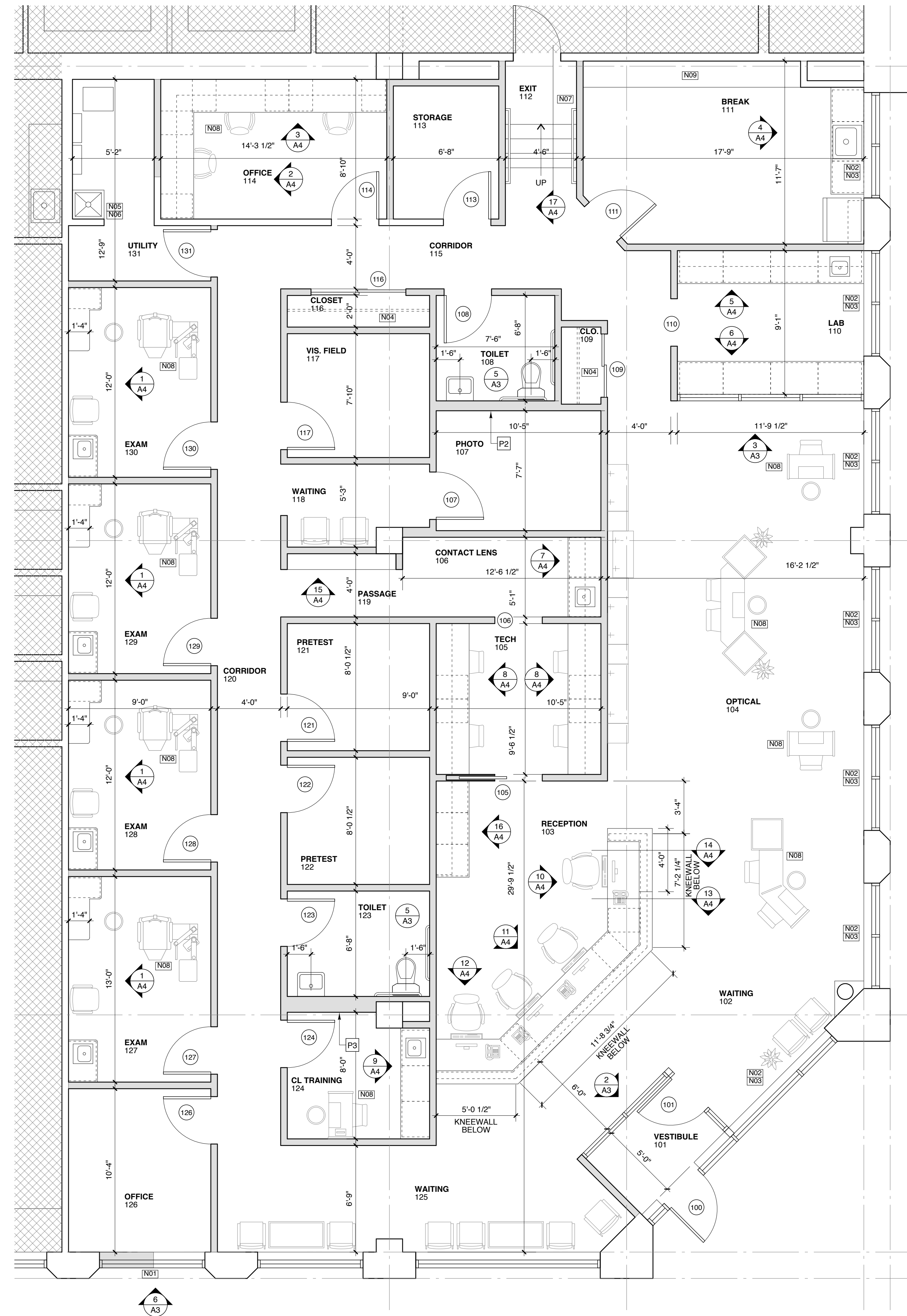

**2 FLOOR REPAIR DETAIL**  
SCALE: 3" = 1'-0"  
1" 2" 4" 8"

TYPICAL AT ALL FLOOR DRAIN, FLOOR SINK, AND PIPE REMOVAL LOCATIONS

**1 FLOOR PLAN**  
SCALE: 1/4" = 1'-0"  
1" 2" 4" 8"

PARTITIONS/WALLS KEY

