

BUILDING CODE DATA

Current Codes Used for Code Information

| | |
|--|------|
| International Building Code | 2009 |
| IBC Maine Amendment | 2009 |
| International Energy Conservation Code | 2009 |
| NFPA 101 | 2006 |

| | |
|-------------------------------------|------|
| ADA Standards for Accessible Design | 2010 |
|-------------------------------------|------|





OCCUPANCY - MERCANTILE GROUP M

OCCUPANT LOAD = 1,207 GROSS S.F. /30 = 40 PPL

INTERIOR FINISH CLASSIFICATION

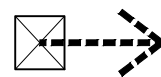
| | |
|-------------------|---------|
| EXIT ENCLOSURES - | CLASS B |
| CORRIDORS - | CLASS C |
| ROOMS & SPACES - | CLASS C |

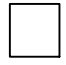
LIFE SAFETY SYMBOLS

-  TRAVEL DISTANCE (FROM FURTHEST POINT)
-  OCCUPANCY LOAD
OCCUPANT LOAD
EGRESS CAPACITY
-  MERCHANDISE USE
-  EXIT SIGN

LIFE SAFETY NOTES:

- THE BUILDING IS FULLY SPRINKLED AND MONITORED.
- THE FLOOR AREA, INCLUDING THE RENOVATED AREA HAS BEEN EVALUATED FOR EGRESS CAPACITY. THE EXISTING MEANS OF EGRESS ARE SUFFICIENT.
- TRAVEL DISTANCE TO EXITS <200 FT MAX. ALLOWED.
- COMMON PATH OF TRAVEL <100 FT MAX. ALLOWED (WHERE OCCUPANT LOAD IS LESS THAN 30).
- DEAD END CORRIDORS <20 FT MAX. ALLOWED.
- EXIT SEPARATION DISTANCE MEETS IBC 2009.
- EXISTING EXIT SIGNS SHALL REMAIN AND ARE ASSUMED COMPLIANT.



59 Mills Road Kennebunkport, ME 04046

o:207.967.8850 f:207.967.8851
www.grahamarchitects.com

PROJECT

Retail Store Renovation
2 Portland Square
Portland, Maine 04101

CBL: 038 B002001

CLIENT

CBRE | Boulos Asset Management
One Portland Square
Portland, ME 04101

INFORMATION

Path: m:\CBRE\2PSff\
Issue Date: 09.10.13
Drawn By: DG
Checked By: DG



TITLE

PROPOSED PLAN

SCALE: 1/8"=1'-0"

©2013 Graham Architects All rights reserved. Information, material, and designs in this document are proprietary to and owned by Graham Architects and may not be disclosed to any third party, reproduced, posted on a global computer information network, or distributed in any way without the written consent from Graham Architects.

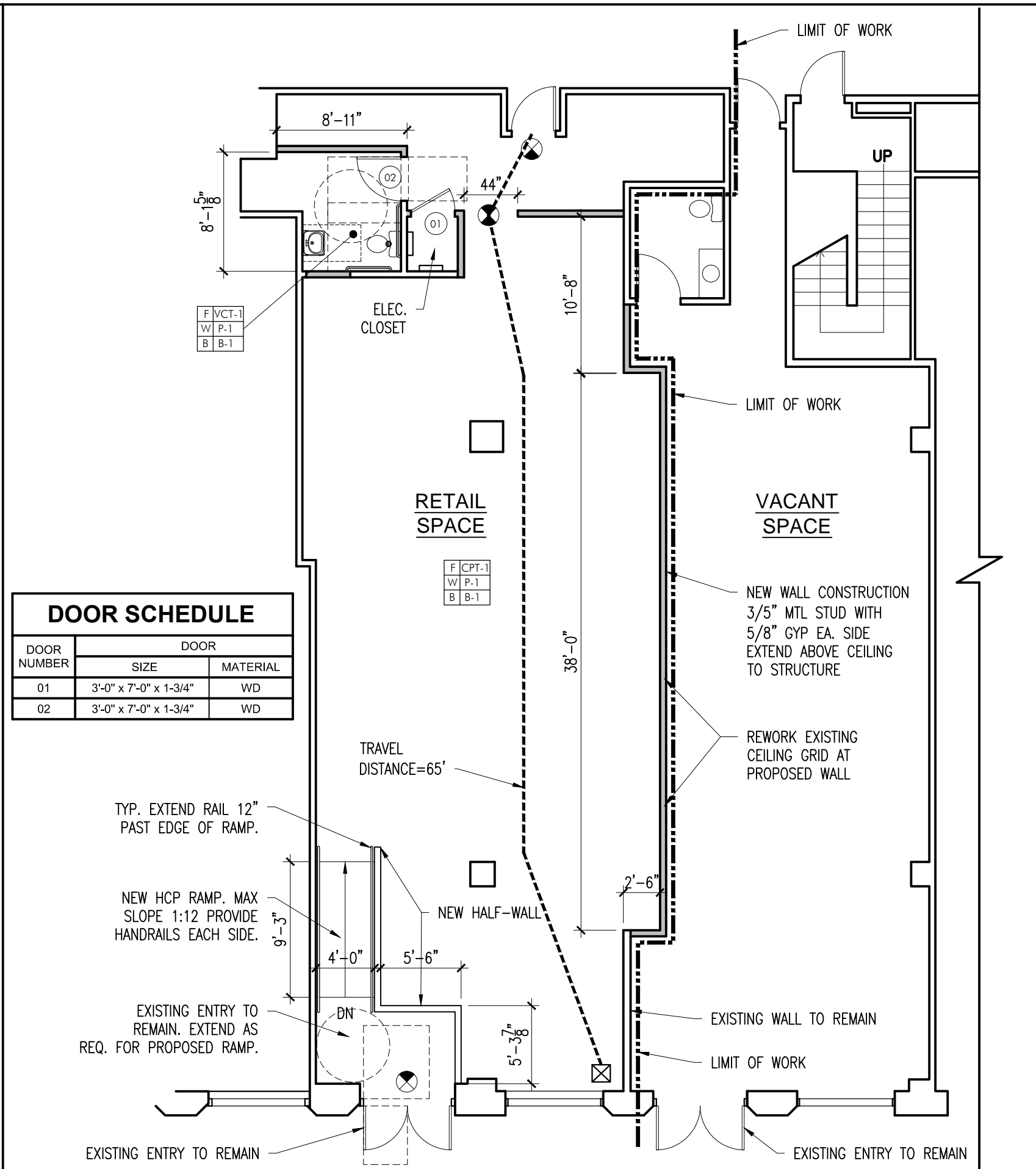

| DOOR SCHEDULE | | |
|---------------|------------------------|----------|
| DOOR NUMBER | DOOR | |
| | SIZE | MATERIAL |
| 01 | 3'-0" x 7'-0" x 1-3/4" | WD |
| 02 | 3'-0" x 7'-0" x 1-3/4" | WD |

