

TOP OF DECORATIVE COLUMN ON R-10 INS. STEEL CHANNEL RESTS (TYPICAL OF BOTH COLUMNS)

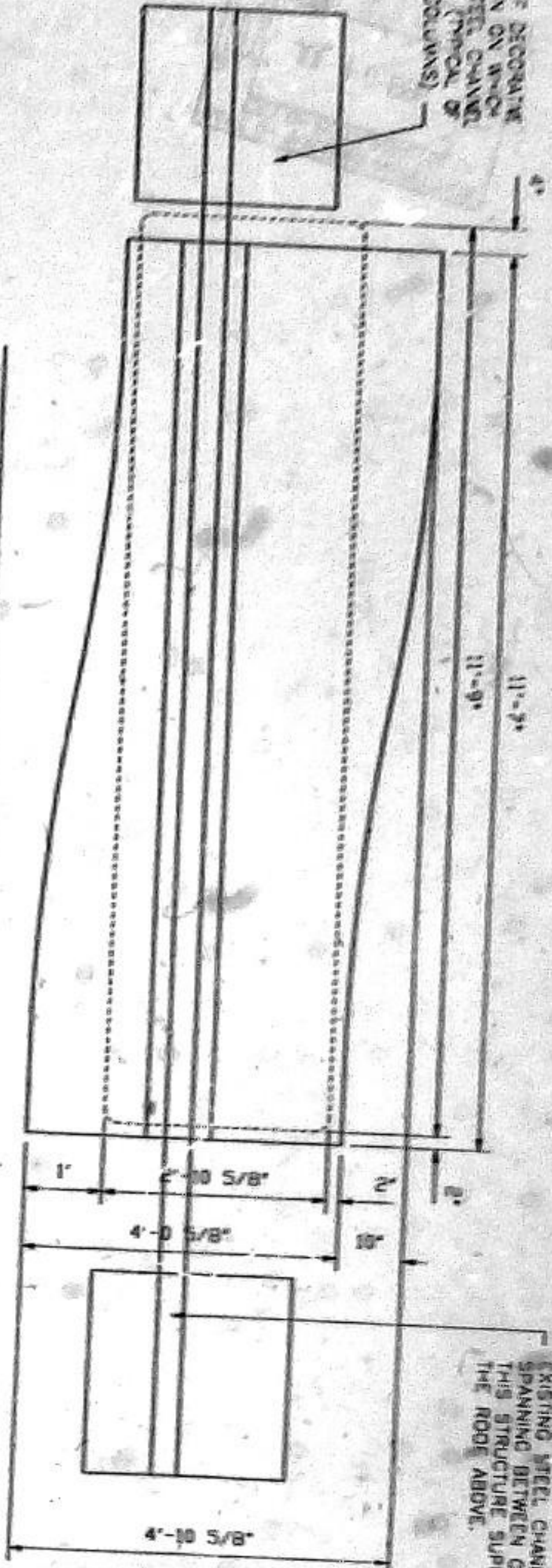

PLAN VIEW OF ILLUMINATED ATM CABINET OVER EXISTING BUILDING PERIMETER  
SCALE: 1/2" = 1'-0"

FABRICATED ALUMINUM CABINET PAINTED PMS #341 GREEN. ILLUMINATED ACRYLIC SIGN FACES ON BLEED FRAME RETAINER SYSTEM TO HAVE TRANSLUCENT GREEN BACKGROUND TO MATCH PMS #341 WITH ALL LOGOS BEING WHITE. ENDS OF CABINET ARE NON-ILLUMINATED ALUMINUM PANELS PAINTED #341 GREEN.  
TOP OF CABINET IS COMPLETELY COVERED AND SEALED AGAINST WEATHER.

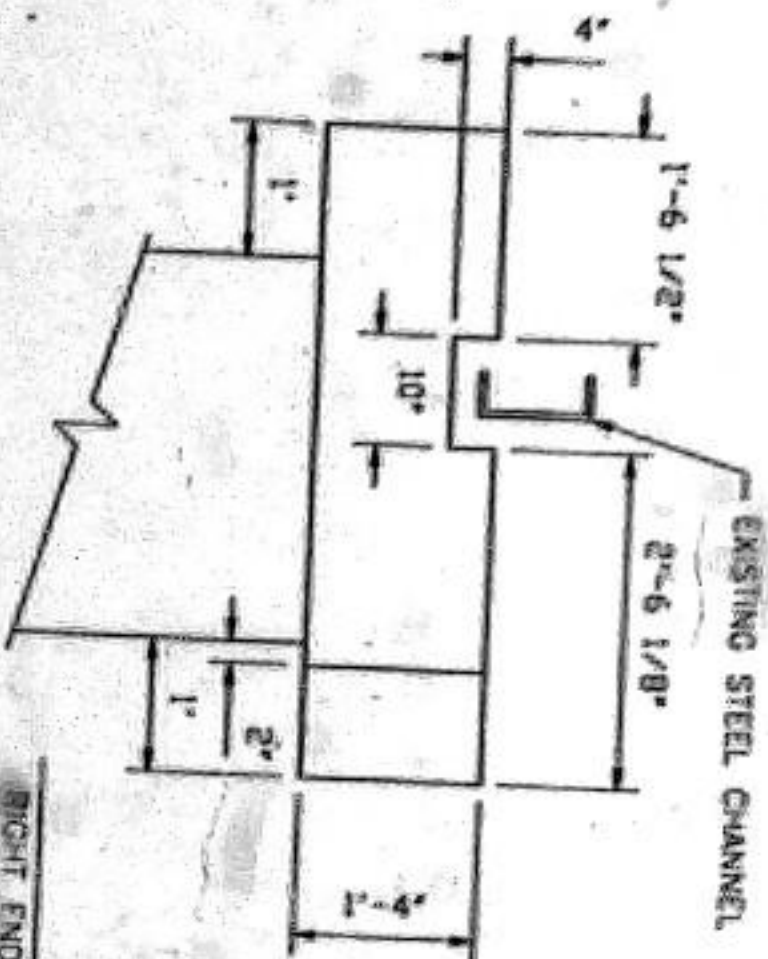

RIGHT END VIEW SHOWING EXISTING STEEL CHANNEL  
SCALE: 1/2" = 1'-0"

EXISTING STEEL CHANNEL SPANNING BETWEEN COLUMNS. THIS STRUCTURE SUPPORTS THE ROOF ABOVE.

SHEET 3	OF 5	FILE	DATE 2/3/06	SCALE 1/2"=1'-0"	REVISION	INITIAL	DATE
PROJECT			CLIENT RPA				
PEOPLES BANK DRIVE-UP ATM			ADDRESS 645 S. GRANT AVE				
ONE PORTLAND SQUARE			CITY COLUMBUS	STATE OHIO			
PORTLAND, MAINE			SALES PERSON ED PENNA	DESIGNER R.T. KING	APPROV		
DRWG. NO. ONEPORT13			ORIGINAL W.O.	DATE			

VACUPORIN INDUSTRIES INC.  
1877 E. 17th Avenue  
COLUMBUS, OHIO 43230  
TOLL FREE 1-800-368-1146

THIS IS AN OFFICIAL VACUPORIN DRAWING FOR YOUR RECORD. USE IN CONNECTION WITH A PROJECT BEING PLANNED FOR YOU BY VACUPORIN INDUSTRIES. IT IS NOT TO BE REPRODUCED, CHANGED OR OTHERWISE BE USED WITHOUT WRITTEN PERMISSION FROM AN AUTHORIZED OFFICE OF VACUPORIN.