

2003 INTERNATIONAL BUILDING CODE

USE GROUP OFFICE OCCUPANCY, GROUP B

6TH FLOOR OCCUPANT LOAD		134 OCCUPANTS
TOTAL OCCUPANT LOAD, 258 OCCUPANTS		
MAIN OFFICE AREA	13406 SQ. FT. @ 100 GROSS	41 OCCUPANTS
FUTURE EXPANSION	4074 SQ. FT. @ 100 GROSS	23 OCCUPANTS
CONFERENCE ROOM	348 SQ. FT. @ 15 NET	13 OCCUPANTS
CONFERENCE ROOM	197 SQ. FT. @ 15 NET	40 OCCUPANTS
MEETING ROOM	596 SQ. FT. @ 15 NET	7 OCCUPANTS
KITCHEN	109 SQ. FT. @ 15 NET	

CONSTRUCTION TYPE
 NON-COMBUSTIBLE, PROTECTED
 7 STORIES
 BUILDING IS EQUIPPED THROUGHOUT
 WITH AN AUTOMATED SPRINKLER SYSTEM
 AS REQUIRED BY IBC 903.3.1.1

EGRESS
 MINIMUM NUMBER OF EXITS 2
 MINIMUM CORRIDOR WIDTH 44"
 MINIMUM STAIR WIDTH 51.8"
 MINIMUM CEILING HT. 7'6"
 MAXIMUM EGRESS TRAVEL DISTANCE 300'
 MAXIMUM COMMON PATH OF TRAVEL 100'
 EGRESS DOORS TO COMPLY WITH IBC 2003 SEC. 1008

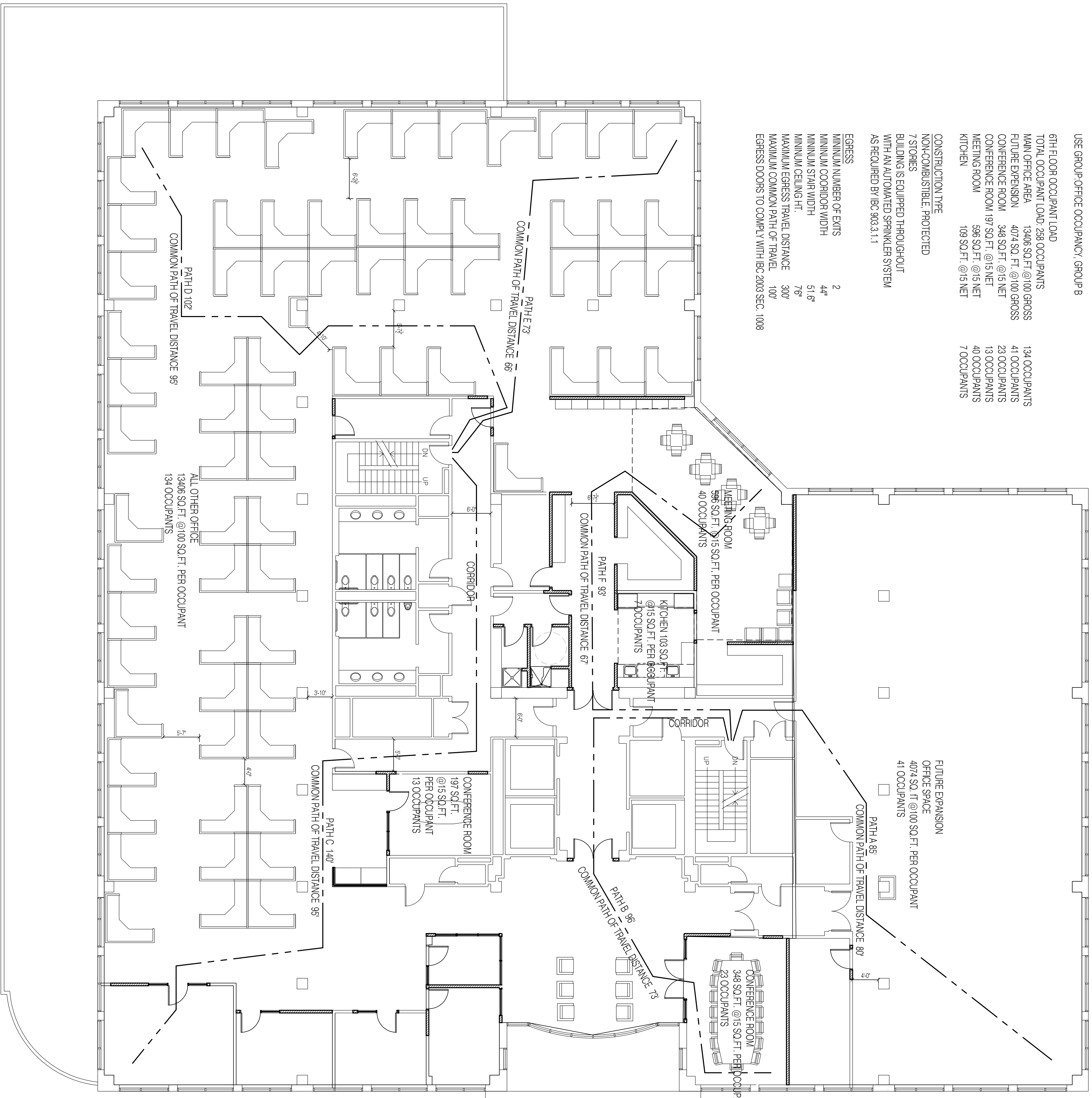

EGRESS PLAN

1/8" = 1'-0"

SHEET TITLE

EGRESS PLAN AND OCCUPANCY LOAD

300 Fore Street, Portland, ME 04101

STONE COAST
 2 PORTLAND SQUARE, PORTLAND, ME
 MARC KEFFER, STONE COAST FUND SERVICES



A-1.3

REVISION
 DESIGNER
 DATE: