

OWNER REVIEW NAME DATE

1 2/5/2010 PERMIT SET
NO. DATE DESCRIPTION
ISSUE LOG
= CLOUED CHANGE

TD BANK
TENANT RENOVATION
1 PORTLAND SQUARE
CAMBRIDGE, MA 02111
© SYMMES MAINI & MCKEE ASSOCIATES, INC. 2010

**7th FLOOR
DEMOLITION
PLAN**

SCALE 1/8"=1'-0"
DRAWN BY AAB
CHECKED BY AAB
PROJ. ARCH./ENGR. AAB
PROJ. MGR. SPD
JOB NO. 09053/09063.01
© SYMMES MAINI & MCKEE ASSOCIATES, INC. 2010

ADD.07

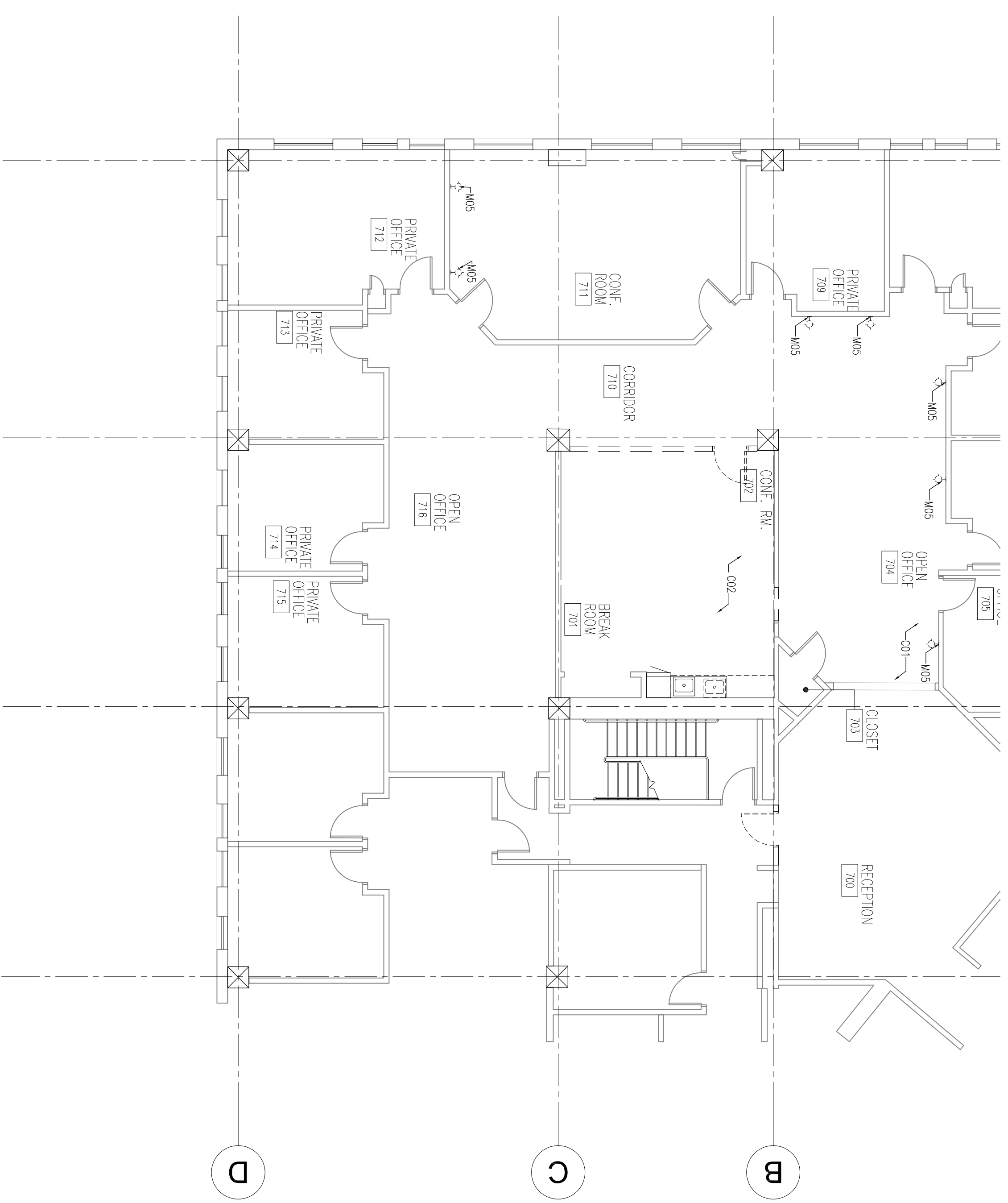

DEMOLITION	DEMOLITION GENERAL NOTES	DEMOLITION REVNOTES	DEMOLITION PLAN LEGEND:	
<p>02 41 20 - SELECTIVE DEMOLITION</p> <p>A. Definitions: Detach items from existing construction and legally dispose of them.</p> <p>1. Remove: Detach items from existing construction and legally dispose of them.</p> <p>2. Remove and Salvage: Detach items from existing construction and deliver them to Owner.</p> <p>3. Remove and Reinstall: Detach items from existing construction, prepare them for reuse, and reinstall them where indicated.</p> <p>4. Existing to Remove: Existing items of construction that are not to be removed and are not otherwise indicated to be removed, removed and salvaged, or removed and reinstalled.</p> <p>B. Existing Warranties: Do not void existing warranties.</p> <p>C. Existing Services and Systems: Monitor services and systems indicated to remain and protect against damage. Make necessary temporary adjustments to mechanical and electrical systems and seal or cap off indicated utility services in concealed location.</p> <p>D. Demolish and remove existing construction only to the extent required by new construction and as indicated. Cut work neatly, without damaging adjacent surfaces.</p> <p>F. Remove and Reinstall Items: Protect from damage until reinstallation. Clean and materials in locations indicated. Comply with installation requirements for new materials and equipment. Provide connections, supports, and miscellaneous materials necessary to make item functional for use indicated. Remove and reinstall items listed below:</p> <p>1. Doors and frames</p> <p>2. Fire extinguishers and cabinets.</p>	<p>C. Dispose: Except for items or materials indicated to be recycled, reused, salvaged, reinstalled, or otherwise indicated to remain Owner's property, remove demolished materials from Project site and dispose of them legally.</p> <p>H. Cleaning and Repair: Remove dirt, debris, and debris caused by selective demolition operations. Restore damaged surfaces which are indicated to remain.</p> <p>I. Ceilings: Existing ceiling panels to be removed throughout & provide new. Suspension grid to remain U.O.N.</p> <p>J. Ceiling Panels: Existing suspension grid. Remove and reinstall ceiling panels throughout & provide new. Remove and reinstall grid components as required to install new work above ceiling.</p> <p>K. Floors: Completely remove existing finish material and adhesives.</p> <p>L. Electrical: Disconnect and remove existing lighting fixtures as indicated. Remove abandoned devices and boxes; remove conductor back to nearest junction box; remove abandoned boxes contain and recovery to nearest partition or ceiling indicated to remain.</p> <p>M. Plumbing: Disconnect and remove plumbing fixtures as indicated. Unless otherwise indicated, remove and install new plumbing fixtures, including partitions or ceiling indicated to remain and cap off behind finished surface.</p>	<p>1. REMOVE EXISTING FIRE EXTINGUISHER CABINET AND/OR FIRE EXTINGUISHER ALONG WALLS BEING DEMOLISHED. SALVAGE FOR REUSE.</p> <p>2. REMOVE EXISTING FLOOR COVERING, ADHESIVE, AND RESILIENT WALL BASE.</p> <p>3. REMOVE ALL SCREENS FROM WALLS THROUGHOUT.</p> <p>4. REMOVE ALL EXISTING CLOCKS AND PROJECTION SCREENS THROUGHOUT.</p> <p>5. REMOVE EXISTING LIGHT FIXTURES AS NOTED. SEE ELECTRICAL DRAWINGS.</p> <p>6. REMOVE ALL DAMAGED CEILING TILES.</p> <p>7. CEILING GRID TO REMAIN. U.O.N. ALL DAMAGED CEILING PANELS TO BE REPLACED WITH NEW TO MATCH EXISTING. U.O.N.</p>	<p>DOORS</p> <p>601 REMOVE WALL FOR NEW DOOR.</p> <p>602 REMOVE EXISTING DOOR AND HARDWARE.</p> <p>603 REMOVE WALL FOR NEW SCHEDULE.</p> <p>604 REMOVE AND REPLACE DAMAGED CEILING TILES.</p> <p>605 REMOVE EXISTING TILE AND REPLACE AS SPECIFIED</p> <p>MISCELLANEOUS</p> <p>606 REMOVE EXISTING BUILT-IN MILLWORK AND/OR CASEWORK.</p> <p>607 REMOVE EXISTING SINK, FACET, AND EJECTOR PUMP</p> <p>608 REMOVE WOOD WALL PANELING.</p> <p>609 REMOVE EXISTING SINK, FACET, AND EJECTOR PUMP AND SALVAGE FOR REINSTALLATION IN NEW CASEWORK (MAINTAIN AND MAKE SAFE EXISTING ROUGH-IN FOR FUTURE REINSTALLATION).</p> <p>610 REMOVE WALL SOURCE. SEE ELECTRICAL DRAWINGS FOR ADDITIONAL INFORMATION</p>	<p>EXISTING CONSTRUCTION TO REMAIN</p> <p>EXISTING CONSTRUCTION TO BE DEMOLISHED</p> <p>EXISTING DOOR & FRAME TO REMAIN</p> <p>EXISTING DOOR & FRAME TO BE DEMOLISHED</p>