

OWNER REVIEW _____ DATE _____
NAME _____ DATE _____

NO.	DATE	DESCRIPTION
1	2/5/2010	PERMIT SET
ISSUE LOG		
△	= CLOUED CHANGE	
TD BANK		
TENANT RENOVATION		
1 PORTLAND SQUARE CAMBRIDGE, MASSACHUSETTS		

**7th FLOOR
ELEC/TEL DATA
COORDINATION PLAN**

SCALE 1/8"=1'-0"
DRAWN BY AAB
CHECKED BY AAB
PROJ. ARCH./ENGR. AAB
PROJ. MGR. SPD
JOB NO. 09053/09063.01
SYMME MAINI & MCKEE ASSOCIATES, INC. 2010

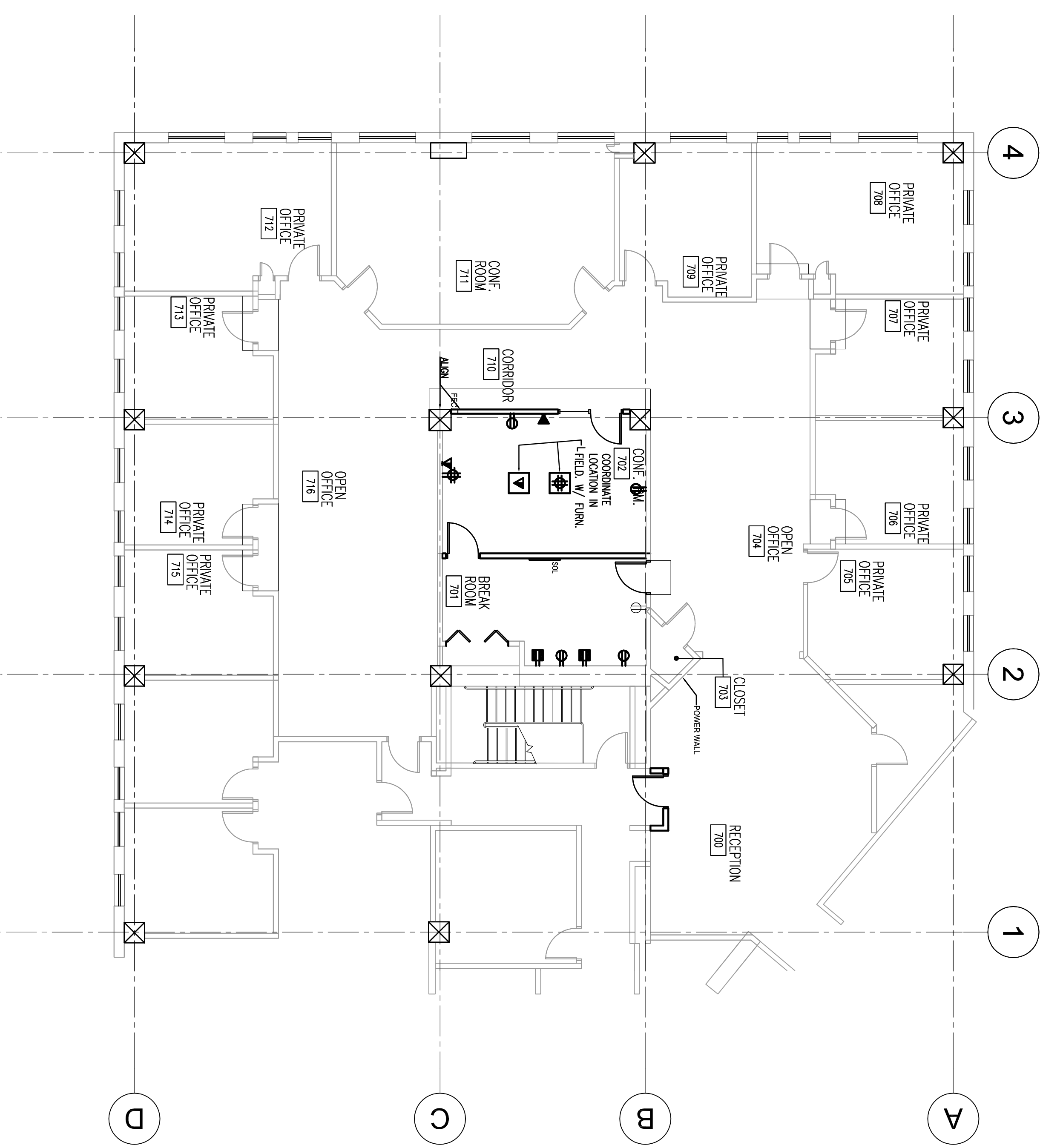

GENERAL NOTES

1. CONSTRUCTION SHALL COMPLY WITH THE MAINE BUILDING CODE, OTHER APPLICABLE CODES OR STANDARDS AND REGULATORY AGENCIES.
2. VERIFY EXISTING CONDITIONS IN THE FIELD PRIOR TO ANY DEMOLITION OR NEW CONSTRUCTION. REPORT DISCREPANCIES TO THE ARCHITECT IMMEDIATELY.
3. USE WRITTEN DIMENSIONS.
4. ALL WALLS TO BE G3A U.O.N. REFER TO SHEET A0.01 FOR WALL DESIGNATION.
5. COORDINATE LOCATIONS OF EXPOSED WALL MOUNTED MECHANICAL AND ELECTRICAL DEVICES TO ALIGN THESE DEVICES BOTH HORIZONTALLY AND VERTICALLY. SUBMIT COORDINATION DRAWINGS SHOWING AND REVISIONS ON QUESTIONS. REVISIONS INCLUDE BUT ARE NOT LIMITED TO: SWITCHES, THERMOSTATS, CONTROLS AND RECEPTACLES, ALL TO BE COLOR WHITE.
6. PROVIDE FIRE EXTINGUISHERS (WITH CABINETS) IN QUANTITIES AND LOCATIONS ON DWGS (MIN. 1/6000 SQ. FT. & 75' MAX. TRAVEL DISTANCE). REVIEW FIRE EXTINGUISHER LOCATIONS WITH THE ARCHITECT/DESIGNER PRIOR TO CONSTRUCTION. PROVIDE FULLY-RECESSED EXTINGUISHER CABINET LOCATIONS TO ACCOMMODATE FULLY-RECESSED CABINETS, U.O.N.
7. COORDINATE BLOCKING REQUIREMENTS AND LOCATIONS WITH ELEVATIONS AND DETAILS. ALL BLOCKING TO BE FIRE TREATED.
8. PATCH & REPAIR ALL SPRAY FIRE PROOFING AT BUILDING STRUCTURE, WHERE MISSING OR DAMAGED, TO MAINTAIN REQUIRED FIRE RATING. JAMBS ARE TYPICALLY LOCATED 4" FROM FACE OF PERPENDICULAR PARTITION TO INSIDE FACE OF DOOR FRAME, UNLESS OTHERWISE NOTED OR DIMENSIONED.
9. ALL EXISTING WALLS TO REMAIN EXPOSED AND REPAIRED TO MEET REQUIREMENTS OF NEW SURFACES, U.O.N.

11. WHERE NEW PARTITIONS ABUT EXISTING PARTITIONS, ALIGN COMMON EDGES OF MATERIALS, REMOVE EXISTING CORNER BEAD AND PROVIDE SMOOTH FINISH AT INTERSECTION, TYP.
12. PATCH & RE-FINISH ALL WALLS WITH IMPERFECTIONS AND WHERE SCREWS, NAILS, PROJECTION SCREENS, WALLCOVERINGS, CORNER GUARDS, ETC. WERE REMOVED.
13. PARTITIONS ARE DIMENSIONED FROM FACE OF GWB TO FACE OF GWB.
14. AT INTERIOR PARTITIONS THAT ABUT THE EXTERIOR WALL, ALIGN G OF PARTITION WITH G OF EXISTING WINDOW MULLIONS.
15. EXISTING WALLS WHICH GRAPHICALLY INDICATE NEW CONSTRUCTION INSIDE OF THEM (SUCH AS BLOCKING) SHOULD BE BUILT SO THAT THE NEW CONSTRUCTION MATCHES THE EXISTING CONSTRUCTION WHICH IT IS BEING BUILT INTO.
16. DEFLECTION TRACKS: PROVIDE DEFLECTION TRACKS AT PARTITIONS WHICH FORMERLY HAD DEFENSE AND STOCK ROOM LABELS. CONSTRUCT BAK, CEILING AND SEAWAY AT TOP AND BOTTOM OF PARTITION. AT FULL HEIGHT PARTITIONS, HOLD GWB AWAY FROM DEFLECTION TRACK. 2" MINIMUM BELOW BOTTOM OF TRACK. PROVIDE DEFLECTION TRACKS AT PARTITIONS WHICH DO NOT FASTEN GWB TO DEFLECTION TRACK. AT FIRE RATED CONSTRUCTION PROVIDE UL APPROVED TESTED DETAIL.
17. ALL COLUMN AND PIPE ENCLOSURES TO BE CONSTRUCTED TIGHT TO PIPE AND LOCATIONS.
18. PATCH, REPAIR, SAND, SMOOTH AND REFINISH ALL COLUMNS.
19. PATCH AND REPAIR ALL EXISTING WALLS WHERE EXISTING FACE PLATE COVERS ELECTRICAL PANELS, BULLETIN BOARDS, TRASH BINS, MISCELLANEOUS BRACKETS, FIRE EXTINGUISHERS, AND SWAGE WERE REMOVED.

CONSTRUCTION KEY NOTES

(021) INFILL WALL TO MATCH EXISTING WALL TYPE.
 (022) PATCH DRYPWALL WHERE ADJACENT WALL WAS REMOVED.
 (023) PATCH DRYPWALL WHERE CASEWORK WAS REMOVED.
 (024) PATCH DRYPWALL WHERE WOODEN PANELING WAS REMOVED.
 (025) NOT USED
 (026) NOT USED
 (027) NOT USED

CONSTRUCTION LEGEND

DRAWING TITLE	TITLE REFERENCE	NEW PARTIAL HEIGHT WALL	EXISTING WALL	NEW WALL	EXISTING DOOR	NEW DOOR AND DOOR NUMBER	ROOM TAG	PARTITION TYPE	EXISTING ELECTRICAL PANEL	DIMENSION LINE	REVISIONS TAG	COLUMN LINE	FIRE EXTINGUISHER CABINET	EXISTING FIRE EXTINGUISHER CABINET	CARD READER	CONSTRUCTION KEY NOTE TAG
1	SECTION REFERENCE	[Symbol]	[Symbol]	[Symbol]	[Symbol]	[Symbol]	[Symbol]	[Symbol]	[Symbol]	[Symbol]	[Symbol]	[Symbol]	[Symbol]	[Symbol]	[Symbol]	[Symbol]
1	DETAIL REFERENCE	[Symbol]	[Symbol]	[Symbol]	[Symbol]	[Symbol]	[Symbol]	[Symbol]	[Symbol]	[Symbol]	[Symbol]	[Symbol]	[Symbol]	[Symbol]	[Symbol]	[Symbol]
1	INTERIOR ELEVATION PLAN REFERENCE	[Symbol]	[Symbol]	[Symbol]	[Symbol]	[Symbol]	[Symbol]	[Symbol]	[Symbol]	[Symbol]	[Symbol]	[Symbol]	[Symbol]	[Symbol]	[Symbol]	[Symbol]