

E

D

C

B

A

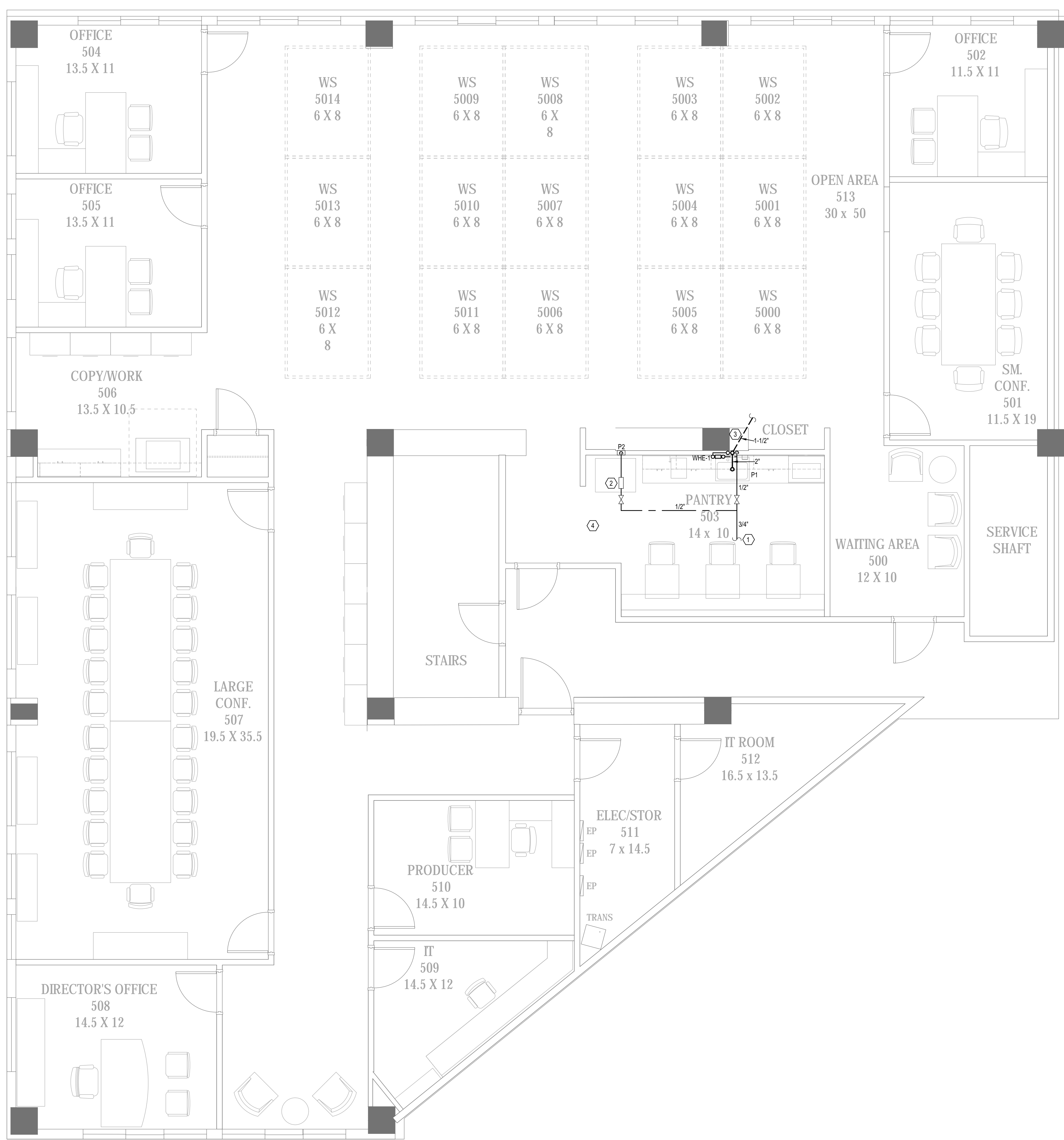

- PLUMBING KEYNOTES FOR THIS SHEET ONLY**
- ① EXTEND NEW 3/4" DOMESTIC WATER LINE AND CONNECT TO EXISTING 3/4" DOMESTIC WATER LINE ABOVE CEILING. VERIFY EXACT LOCATION AND SIZE OF EXISTING 3/4" DOMESTIC WATER LINE PRIOR TO BEGINNING NEW WORK.
 - ② PROVIDE SHUT-OFF VALVE AND WATTS MFG. CO. MODEL LF-009, SIZE 1/2" RPZ DOUBLE CHECK BACKFLOW PREVENTER MOUNTED PER CITY OF PORTLAND, MAINE SPECIFICATIONS.
 - ③ EXTEND NEW 2" SANITARY AND 1-1/2" VENT AND CONNECT TO EXISTING MINIMUM 2" SANITARY MINIMUM 1-1/2" VENT. VERIFY EXACT LOCATION AND SIZE OF EXISTING SANITARY AND VENT PIPING PRIOR TO BEGINNING NEW WORK.
 - ④ DEMOLITION NOTE: REMOVE EXISTING SINGLE COMPARTMENT SINK AND EXISTING UNDER COUNTER WATER HEATER COMPLETELY. CUT AND CAP EXISTING SANITARY, VENT AND WATER LINES NOT TO BE REUSED TO BELOW FINISH FLOOR, ABOVE FINISH CEILING AND BEHIND FINISH WALL. PATCH WALL, FLOOR AND CEILING TO MATCH EXISTING.

1 PLUMBING FLOOR PLAN
SCALE: 1/4" = 1'-0"

THIS DOCUMENT HAS BEEN PREPARED BY PROGRESSIVE AE AS AN INSTRUMENT OF SERVICE AND PROGRESSIVE AE SHALL RETAIN ALL COPYRIGHT, PATENT, TRADEMARK, AND OTHER RESERVED RIGHTS, INCLUDING THE COPYRIGHT THEREIN.

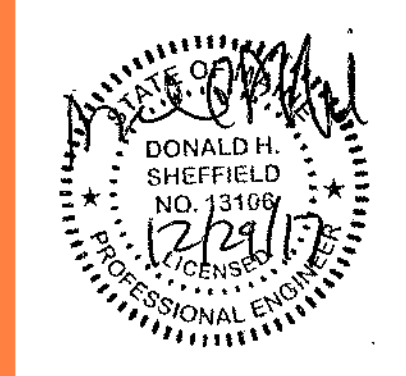

If this document is scanned and stored in a digital or electronic format and is received from someone other than the sealing professional identified in the document, you must contact the sealing professional by writing to validate authenticity of the document. The sealing professional declines the seal and signature and shall not be liable for any liability associated with it where the authenticity of any digital or electronic seal or signature has not been validated in this manner.

ISSUANCES
ISSUED FOR CONSTRUCTION
2017-12-28

REVISIONS
NO. DATE DESCRIPTION