

REFLECTED CEILING PLAN NOTES

1. TILE- ARMSTRONG -MESA - Beveled Tegalur Tile - 9/16" (682) (CONFIRM MATCH PHASE ONE)
2. GRID- ARMSTRONG SUPRAFINE XL - 9/16" EXPOSED TEE SYSTEM (CONFIRM MATCH PHASE ONE)
3. IN ROOMS 142, 144, & 145- REUSE EXISTING LIGHTING FIXTURES. REWORK EXISTING 15/16TH LAY IN GRID, WITH NEW ARMSTRONG FINE FISSURED CEILING TILE (TYPE OF TEGULAR TBD DEPENDANT ON EXISTING GRID).
4. ALL NEW CEILING TILE AND GRID FROM PHASE ONE TO REMAIN
5. IN CONFERENCE ROOM 102 AND 117 EXISTING CEILING TILE, GRID AND LIGHTING TO REMAIN
6. ALL EXISTING 2X2 "D1" FIXTURES TO BE RELOCATED AND RETROFITTED WITH A DIMMING PACKAGE.
7. FIXTURE K- NEEDS TO HAVE THE JUNCTION BOX AND CANOPY RUN OVER ONE OF THE HANGING CABLES AND NOT CENTER OF FIXTURE.- SEE ELEVATION 1.
8. FIXTURE J - NEEDS TO HAVE (QTY 4) LED EDISON BASE LAMPS - FIXTURE ON DIMMER
9. ALL FIXTURES TO BE ON DIMMERS

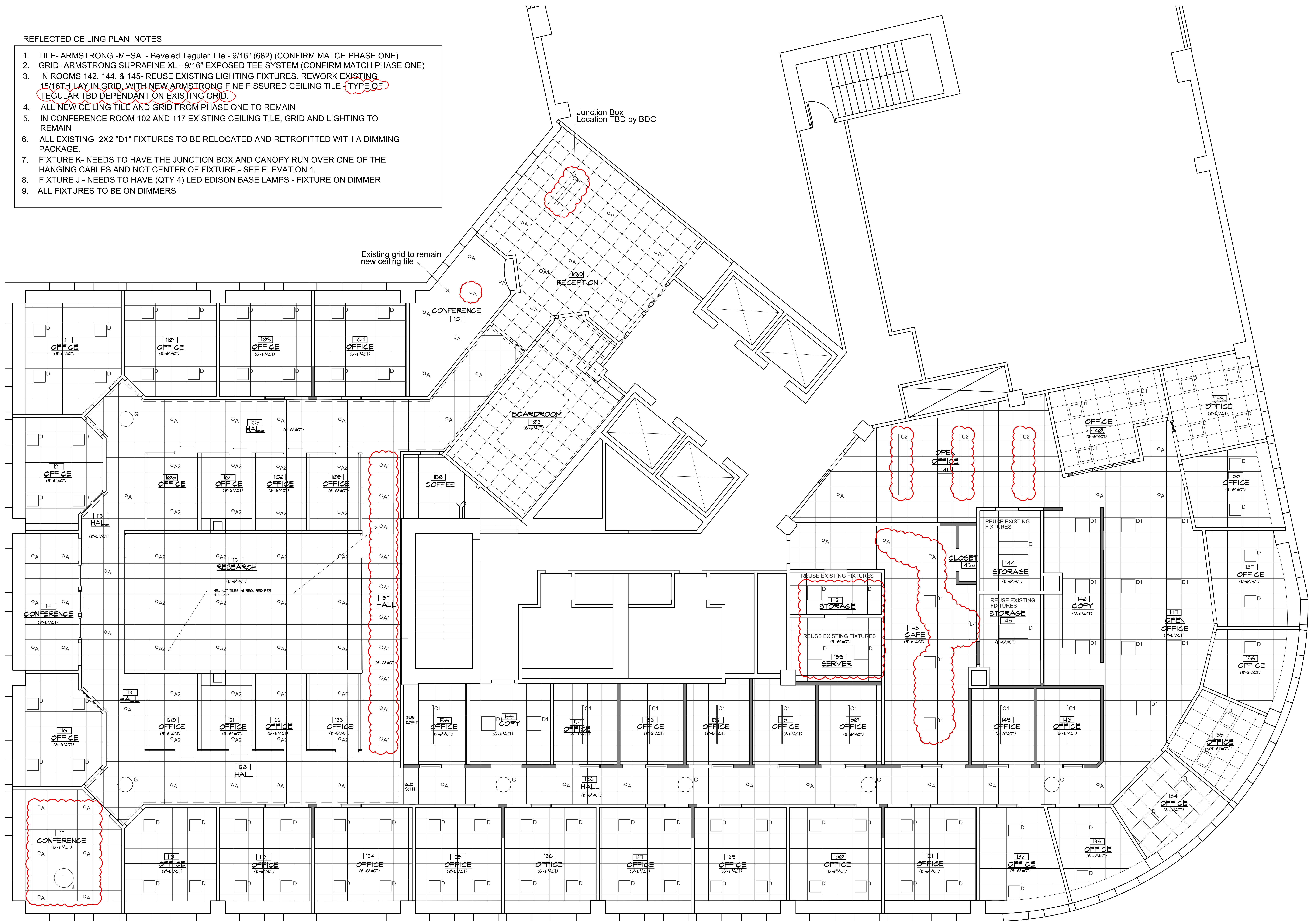

REFLECTED CEILING PLAN
SCALE: 1/4" = 1'-0"

REVISED: OCTOBER 02, 2017
PERMIT SET: JULY 14, 2017

REVISIONS	
DATE	MAY 2017
PROJECT	HM PAYSON
DRAWN BY	MSB
CHECK BY	LZ