

| | | | |
|------|-----------------|--|--|
| CPT1 | CARPET | MILLIKEN-COLOR FIELD PATINA- PAT44-48 COPPER- | SEE CARPET RENDERING / INSTALLATION PLAN |
| CPT2 | CARPET | MILLIKEN-COLOR FIELD PATINA- PAT144-48 DARK COPPER | SEE CARPET RENDERING / INSTALLATION PLAN |
| CPT3 | CARPET | MILLIKEN-COLOR FIELD PATINA- PAT 144-COPPER RUST | SEE CARPET RENDERING / INSTALLATION PLAN |
| VCT1 | VINYL COMP.TILE | MANNINGTON PROGRESSIONS - PUTTY 55129 | |
| VB1 | VINYL BASE | JOHNSONITE 4" STRAIGHT VINYL BASE - COLOR 469 MYSTIFY CG | |
| VB2 | VINYL BASE | JOHNSONITE 4" STRAIGHT VINYL BASE - COLOR 32 PEBBLE WG | |
| VB3 | VINYL BASE | JOHNSONITE 4" COVE VINYL BASE - COLOR 469 MYSTIFY CG | |
| T1 | PORCELAIN TILE | STONE SOURCE - EVO-Q - 3"X24" - HERINGBONE INSTALLATION | |
| GT1 | GROUT | HYDROMENT OR EQUAL - 1/8" GROUT LINE COLOR TBD | |
| D1 | MEMBRANE | SCHLUTER DITRA- UNCOUPLING MEMBRANE UNDER PORCELAIN TILE | |
| TS1 | TRANSITION | SCHLUTER "SCHEME" TILE TO CPT TRANSITIONS; STAINLESS | |
| TS2 | TRANSITION | VINYL TRANS. STRIP JOHNSONITE CARPET TO VCT TRANSITIONS | |
| WT1 | WALL TILE | N/A | |
| WD1 | WOOD WALL | APPROVED SAMPLE PRESENTED BY GC. | |
| LVT | LUX VINYL TILE | MOHAWK HOT HEAVY GROWN UP C0075- 958 COLE | |

| | | | |
|-----|-------|--|--|
| PT1 | PAINT | BENJAMIN MOORE - HALF MOON CREST 1481- SEE NOTES FOR PAINT APPLICATION | |
| PT2 | PAINT | SHERWIN WILLIAMS - SHOJI WHITE SW 7042 - SEE NOTES FOR PAINT APPLICATION | |
| PT3 | PAINT | BENJAMIN MOORE - SABRE GRAY 1482 - SEE NOTES FOR PAINT APPLICATION | |
| PT4 | PAINT | BENJAMIN MOORE - IRON GATE 1545 - SEE NOTES FOR PAINT APPLICATION | |
| PT5 | PAINT | BENJAMIN MOORE - - SEE NOTES FOR PAINT APPLICATION | |

| | |
|---------------------------|----------------------------|
| SCHEME 1 - Reception 100. | |
| FLOOR | T1, GT1, TS1, D1, AREA RUG |
| BASE | WOOD REFINISHED TO MATCH |
| WALLS | PT2, WD1 |
| CEILING | ACT |
| DOORS | SEE DOOR SCHEDULE |
| HM DOOR FRAME/ SYSTEM | PT2 SEMI GLOSS |
| SOFFIT | FACE AND UNDER SIDE PT1 |

| | |
|--|-------------------------|
| SCHEME 2 - All Offices TYP (unless noted) Conf. 117, Conf. 114 and Conf. 101 | |
| FLOOR | CPT1 |
| BASE | VB1 |
| WALLS | PT1 |
| CEILING | ACT |
| DOORS | SEE DOOR SCHEDULE |
| HM DOOR FRAME/ SYSTEM | PT2 SEMI GLOSS |
| SOFFIT | IN OFFICE 156 TO BE PT2 |

| | |
|--|-------------------|
| SCHEME 3 - STOR. 142,145, 144, SERV. 159 | |
| FLOOR | VCT1 |
| BASE | VB3 |
| WALLS | PT2, WD1 |
| CEILING | ACT |
| DOORS | SEE DOOR SCHEDULE |
| HM DOOR FRAME/ SYSTEM | PT2 SEMI GLOSS |

| | |
|-----------------------|-------------------------|
| SCHEME 4-RESEARCH 115 | |
| FLOOR | SEE CPT INSTALL PLAN |
| BASE | VB1 AND VB2 (SEE PLAN) |
| WALLS | PT2 AND PT4- (SEE PLAN) |
| CEILING | EXISTING TO REMAIN |
| DOORS | SEE DOOR SCHEDULE |
| HM DOOR FRAME/ SYSTEM | PT2 SEMI GLOSS |

| | |
|--|---------------------------------|
| SCHEME 5 - Offices 105, 106, 107, 108, 120, 121, 122, 123, Hall 103, 113, 128, 157, open office 147, 141, Copy 146 AND 155 | |
| FLOOR | CPT1 |
| BASE | VB1 |
| WALLS | PT1 (SEE PLAN FOR PT3) |
| CEILING | SEE RCP |
| DOORS | SEE DOOR SCHEDULE |
| HM DOOR FRAME/ SYSTEM | PT2 SEMI GLOSS - (PT3 COPY 146) |

| | |
|-----------------------|-------------------|
| SCHEME 6 - CAFE 143 | |
| FLOOR | LVT |
| BASE | VB3 |
| WALLS | PT1 |
| CEILING | ACT |
| DOORS | SEE DOOR SCHEDULE |
| HM DOOR FRAME/ SYSTEM | PT2 SEMI GLOSS |

| | |
|-------------------------|--------------------|
| SCHEME 7 BOARD ROOM 102 | |
| FLOOR | EXISTING TO REMAIN |
| BASE | EXISTING TO REMAIN |
| WALLS | PT1 |
| CEILING | EXISTING TO REMAIN |
| DOORS | SEE DOOR SCHEDULE |
| HM DOOR FRAME/ SYSTEM | PT2 SEMI GLOSS |

| | |
|-------------------------|--------------------|
| SCHEME 8 - COFFEE - 158 | |
| FLOOR | EXISTING TO REMAIN |
| BASE | EXISTING TO REMAIN |
| WALLS | PT2 |
| CEILING | EXISTING TO REMAIN |
| DOORS | SEE DOOR SCHEDULE |
| HM DOOR FRAME/ SYSTEM | PT2 SEMI GLOSS |

INTERIOR PAINTING NOTES
 Gypsum Board: Provide a primer and two finish coats over interior gypsum board surfaces:
 1. GWB Soffits and Ceilings: Flat Acrylic Finish, except as indicated otherwise.
 2. GWB Walls: Low-Luster (Eggshell), Acrylic Finish, except as indicated otherwise.
 3. Door Trim: Semi-gloss, Acrylic Finish, except as indicated otherwise.

SPECIALTY MILLWORK FIXTURES BY GC

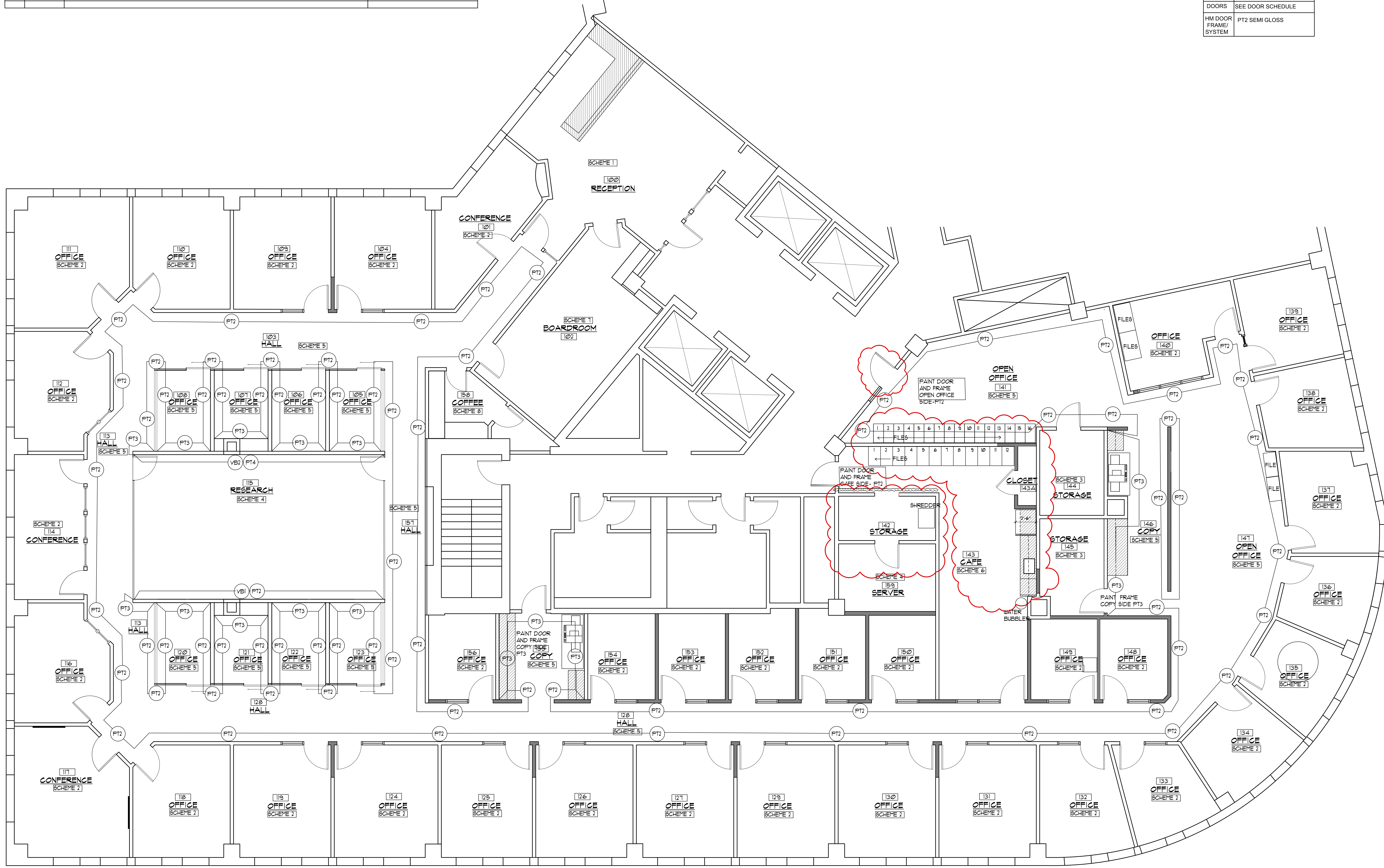

FINISH PLAN
 SCALE: 1/4" = 1'-0"

REVISED: OCTOBER 02, 2017
 PERMIT SET: JULY 14, 2017