

- ALL FINISHES SHALL BE INSTALLED IN STRICT ACCORDANCE WITH MANUFACTURER'S RECOMMENDATIONS.
- ALL PAINTED SURFACES SHALL RECEIVE (2) COATS OVER PRIMER, UNLESS SPECIFIED OTHERWISE.
- ALL AREAS TO RECEIVE PATCH & REPAIR SHALL MATCH ADJACENT FINISHES, UNLESS OTHERWISE NOTED.
- ALL WALLS SHALL BE PAINTED P1, UNLESS OTHERWISE NOTED.
- ALL FLOORING SHALL CONTINUE UNDER TOE/KICKS AND COUNTERTOP OVERHANGS OF ALL CASEWORK, TYPICAL THROUGHOUT.
- CONTRACTOR SHALL PROVIDE (3) 4x4 WALL SAMPLE BRUSH-OUTS OF PAINT COLOR FOR ARCHITECTS AND OWNER'S REVIEW PRIOR TO PURCHASE OF PAINT. ASSUME (2) ROUNDS OF REVISIONS TO COLOR. PROVIDE 10% OVERAGE OF ALL FINISHES FOR TENANT.
- PROTECT ALL FLOOR FINISHES TO REMAIN DURING CONSTRUCTION. FINISH MATERIALS SHALL COMPLY WITH V.O.C. LIMITS LISTED BELOW OR LIMITS OF AUTHORITIES HAVING JURISDICTION, WHICHEVER IS MORE STRINGENT.
- ADHESIVES, SEALANTS & CAULKS SHALL MEET THE REQUIREMENTS OF SOUTH COAST AIR QUALITY MANAGEMENT DISTRICT RULE 1168, 2005.
- ARCHITECTURAL PAINTS AND COATINGS SHALL COMPLY WITH GREEN SEAL STANDARD GS-11, PAINTS, 3RD EDITION, 2011.
- CARPET SHALL MEET THE TESTING & PRODUCT REQUIREMENTS OF THE CARPET AND RUG INSTITUTE'S GREEN LABEL PLUS PROGRAM, MOST RECENT EDITION.
- HARDWOOD, PLYWOOD, PARTICLEBOARD, & MEDIUM DENSITY FIBERBOARD COMPOSITE WOOD PRODUCTS USED ON THE INTERIOR OF THE BUILDING SHALL CONTAIN NO ADDED UREA-FORMALDEHYDE RESINS.

THIS DRAWING IS THE PROPERTY OF CANAL 5 STUDIO AND IS NOT TO BE COPIED OR REPRODUCED IN PART OR WHOLE. 2014 © CANAL 5 STUDIO

Mark	Date	Description

Project Status
ISSUED FOR CONSTRUCTION
 SEPTEMBER 21, 2016

Drawing Title
FLOOR 10 FINISH PLAN

Scale: 1/8" = 1'-0"

Drawing Number
A72.4

FINISH LEGEND	
FLOOR FINISH	<ul style="list-style-type: none"> CPT-1 - Private Offices & Workstations CPT-2 - Meeting Rooms & Conference Rooms CPT-3 - Corridors CPT-4 - Broadloom Carpet LVT-1 - Kitchen, Copy, Break rms. RF-1 - Resilient Flooring T-1 - Porcelain Floor Tile & Wall Tile T-2 - Porcelain Wall Tile @ Toilet Rooms
	<ul style="list-style-type: none"> WB-1 - Wall Base WB-2 - PAINTED WOOD BASE - P-9 WB-3 - STAINED WOOD BASE - TO MATCH EXISTING WOOD. WB-4 - Traditional Wall Base VB-1 - (4") Rubber Wall Base VB-2 - (4") Rubber Wall Base T-3 - Porcelain Wall Base Tile (6"x 24")
	<ul style="list-style-type: none"> P-1 - Paints (Sherwin Williams) P-2 - Wall (Field Color) P-3 - Private Office (Accent Color) P-4 - Corridor (Accent Color) P-5 - Corridor (Field Color) P-6 - Lounge/bary (Accent Color) P-7 - Stair Wall Color (Field Color) P-8 - Stair Wall Color (Accent Color) P-9 - Stair Metal Stringer Color P-10 - Door Frames, Doors & Wall Base WB-1 GWB - GWB Ceilings & Soffits
	<ul style="list-style-type: none"> WC-1 - Wallcovering WC-2 - Elevators/Conference Breakout & Boardroom WC-3 - Reception Area WC-4 - Large Conference & Small Conference rooms PL-1 - Plastic Laminate PL-2 - Kitchen 991 & Coffee Bar 1081 PL-3 - Casework @ Copy Mail 709, Typical Copy Rooms & Coffee Bars PL-4 - Toilet Rooms PL-5 - Copy/Mail Center SS-1 - Solid Surface SS-2 - Countertop @ Copy Mail 709, Kitchen 991, Typical Copy Rooms & Coffee Bars SS-3 - Small/Medium Meeting Rooms, Front Desk & Boardroom SS-4 - Vanity @ Toilet Rooms SS-5 - Transition Counter @ Conference Breakout WD-1 - Solid Hardwood/Wood Veneer

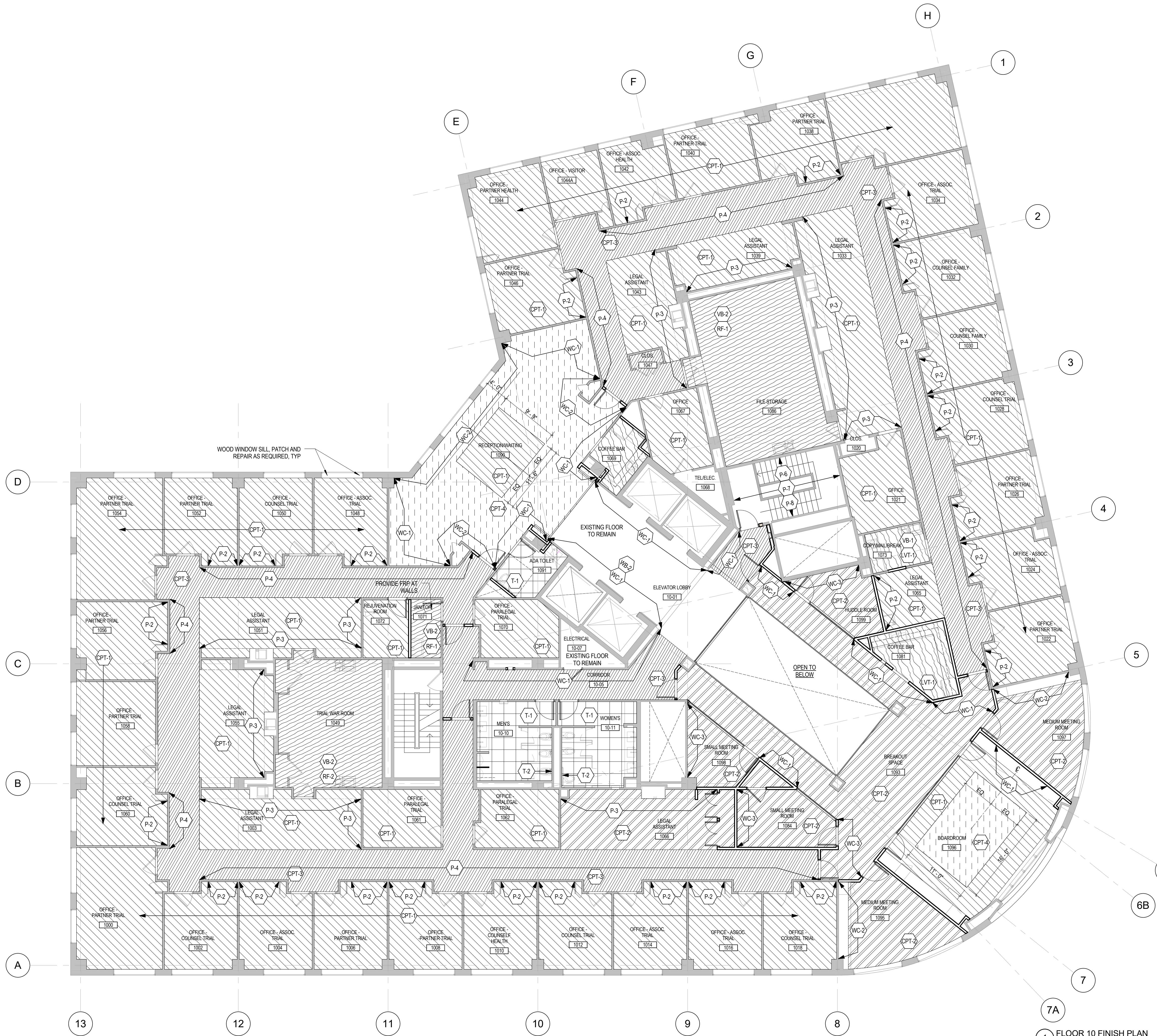

FLOOR 10 FINISH PLAN
 1/8" = 1'-0"