

REFLECTED CEILING PLAN GENERAL NOTES

- CONTRACTOR TO PROVIDE ANY MISSING ESCUTCHEONS AT SPRINKLER HEADS.
- ALL LIGHT FIXTURES AND HVAC REGISTERS SHALL BE LOCATED ON CEILING GRID U.N.O. ALL CEILING FIXTURES INCLUDING ALL DOWNLIGHTS & SPRINKLER HEADS SHALL BE CENTERED ON PANEL OR TILE, TYP U.O.N.
- NOTIFY ARCHITECT OF ANY CONFLICTS WITH THE SUSPENDED GRID SYSTEM, HVAC, OR SPRINKLER FIXTURES PRIOR TO INSTALLATION. ALL FIXTURE RELOCATION IS SUBJECT TO ARCHITECT'S APPROVAL. EMERGENCY LIGHTING SHALL BE PROVIDED PER CODE REQUIREMENTS.
- ALL CEILING FIXTURES AND WIRING FOR LIGHT FIXTURES, EXIT SIGNS, OR OTHER ELECTRICAL DEVICES SHALL BE U.L. APPROVED, THERMALLY PROTECTED, AND SHALL BE INSTALLED IN CONDUIT OR OTHER WIRING METHOD APPROVED BY THE BUILDING DEPARTMENT. ALL SWITCHES, THERMOSTATS, AND OTHER WALL-MOUNTED CONTROL DEVICES SHALL BE MOUNTED AT 48" ABOVE UNFINISHED FLOOR TO TOP OF BOX U.O.N.
- SUBMITTALS AND SHOP DRAWINGS FOR ALL LIGHT FIXTURES ARE REQUIRED FOR APPROVAL PRIOR TO PURCHASE OF MATERIALS/FIXTURES.
- THIS DRAWING IS FOR LAYOUT PURPOSES ONLY. ENGINEERING OF SWITCHING AND CIRCUITRY SHALL BE PROVIDED BY THE ELECTRICAL CONTRACTOR IN ACCORDANCE WITH APPLICABLE BUILDING CODES AND REGULATIONS FOR BUILDING LIFE SAFETY. EMERGENCY, EGRESS AND NIGHT LIGHTS. SEE ELECTRICAL NOTES. HORNS AND STROBES SHALL BE PROVIDED THROUGHOUT AREA OF WORK AS REQUIRED TO MEET CODE REQUIREMENTS. LAYOUT MUST BE SUBMITTED TO ARCHITECT FOR APPROVAL PRIOR TO INSTALLATION.
- LIGHT FIXTURES AND SWITCHING SHALL CONFORM TO CODE REQUIREMENTS. PROVIDE A CONSISTENT LAMP COLOR TEMPERATURE THROUGHOUT THE SPACE. MATCH EXISTING BUILDING STANDARD LAMP U.O.N.
- REWORK EXISTING LIGHT FIXTURE SWITCH LOCATIONS, HVAC DIFFUSER LOCATIONS, FIRE SPRINKLER LAYOUT AND THERMOSTAT LOCATIONS AS REQUIRED FOR NEW LAYOUT.
- PATCH AND REPAIR ALL AREAS AFFECTED BY CONSTRUCTION. ALL NEW GWB CEILINGS & SOFFITS SHALL BE SMOOTH FINISH. MATCH LEVEL OF EXISTING. EXISTING SOFFITS TO REMAIN SHALL BE FINISHED TO SMOOTH LEVEL. A FINISH AS WELL.
- EXIT SIGNS ARE NORMALLY ILLUMINATED AT ALL TIMES AND PROVIDED WITH AN EMERGENCY ELECTRICAL SYSTEM FROM STORAGE BATTERIES, UNIT EQUIPMENT, OR AN ON-SITE GENERATOR SET TO INSURE CONTINUED ILLUMINATION FOR AT LEAST 90 MINUTES IN CASE OF PRIMARY POWER LOSS. PROVIDE CEILING ACCESS PANELS AS REQUIRED FOR CODE COMPLIANCE AND MAINTENANCE OF ALL SYSTEMS ABOVE CEILING. CONTRACTOR TO ATTEMPT TO PROVIDE MULTIPLE POINTS OF ACCESS THROUGH ONE PANEL WHEN LAYING OUT UTILITIES ABOVE CEILING. PRIOR TO INSTALLATION, CONTRACTOR TO REVIEW IN FIELD WITH ARCHITECT AND OWNER THE LOCATIONS OF ALL PANELS. CEILING ACCESS PANELS TO BE PAINTED TO MATCH CEILING FINISH.
- OPEN TO STRUCTURE CEILING SHALL BE CLEANED OF DEBRIS, CAP ALL UNUSED CONDUIT, WIRE, PIPE, & DUCT AND PREP TO RECEIVE NEW PAINT.
- CONTRACTOR TO PROVIDE ANY MISSING ESCUTCHEONS AT SPRINKLER HEADS.

CEILING LEGEND

	CEILING TYPE TAG & HEIGHT A.F.F. 8'-0"
	GWB CEILING ON METAL STUD FRAMING
	ACOUSTICAL TILE CEILING
	SPRINKLER HEAD
	SMOKE/HEAT DETECTOR
	EXIT SIGN
	RECESSED CAN FIXTURE - ROUND
	RECESSED CAN FIXTURE - SQUARE
	2' x 2' FLUSH MOUNT FIXTURE
	2' x 4' FLUSH MOUNT FIXTURE
	ROUND PENDANT FIXTURE
	LINEAR PENDANT FIXTURE
	SUPPLY DIFFUSER
	RETURN GRILL

NOTE:
 LIGHTING, MECHANICAL, & FIRE PROTECTION SYMBOLS ON ARCHITECTURAL DRAWINGS PROVIDED FOR LAYOUT AND COORDINATION PURPOSES ONLY. SEE ENGINEERING DRAWINGS, SCHEDULES, AND SPECIFICATIONS FOR PRODUCT DATA & REQUIREMENTS.

NOTE:
 REUSE EXISTING GRID AT ALL PERIMETER OFFICES.
 EXISTING GWB CEILINGS AND SOFFITS TO REMAIN SHOWN HALFTONE.
 EXISTING BARREL VAULT CEILINGS IN CORRIDORS TO REMAIN.

THIS DRAWING IS THE PROPERTY OF CANAL 5 STUDIO AND IS NOT TO BE COPIED OR REPRODUCED IN PART OR WHOLE. 2014 © CANAL 5 STUDIO

Mark | Date | Description

Project Status

**ISSUED FOR
 CONSTRUCTION**

SEPTEMBER 21, 2016

Drawing Title

**FLOOR 7
 REFLECTED
 CEILING PLAN**

Scale: 1/8" = 1'-0"

Drawing Number

A70.1

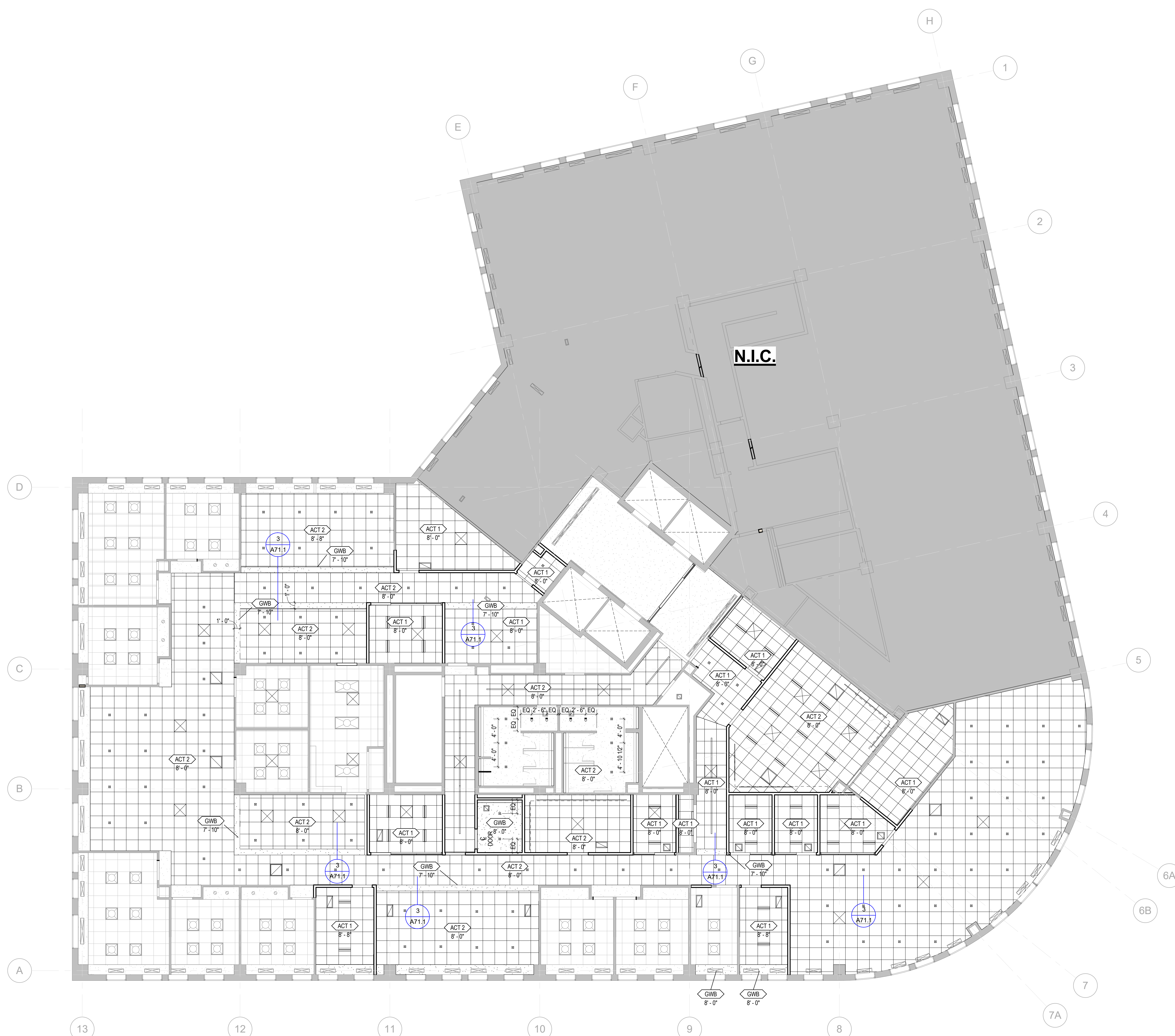

1 SEVENTH FLOOR RCP
 1/8" = 1'-0"