

- DEMOLITION NOTES**
- ALL DEMOLITION WORK SHALL CONFORM TO ALL LOCAL, STATE, & NATIONAL SAFETY CODES.
 - CONTRACTOR'S PRICE SHALL INCLUDE ANY COSTS THAT WILL BE INCURRED TO MEET ALL CONDITIONS AND REQUIREMENTS OF THE OWNER WITH RESPECT TO DEMOLITION, CONTROL OF NOISE, REFUSE, SCREENING FOR DUST, AND GENERAL DISRUPTION TO THE OPERATION OF THE BUILDING.
 - EXISTING UTILITIES TO REMAIN UNLESS NOTED OTHERWISE.
 - EXISTING FIRE PROTECTION AND LIFE SAFETY SYSTEMS TO REMAIN. PROTECT AND MAINTAIN DURING CONSTRUCTION. CONTRACTOR'S PRICING SHALL INCLUDE MODIFYING THE EXISTING FIRE SPRINKLER AND FIRE ALARM SYSTEMS AS REQD FOR NEW PLAN LAYOUT AND CODE REVISIONS, INCLUDING ADA.
 - MAINTAIN INTEGRITY OF ALL EXISTING FIRE RATED ASSEMBLIES TO REMAIN, INCLUDING ENCLOSURES AT COLUMNS, STAIRS, & SHAFTS.
 - MAINTAIN EXISTING EXIT PASSAGEWAYS AT ALL TIME.
 - PROTECT ALL EXISTING FINISHES, MILLWORK, AND CONSTRUCTION TO REMAIN.
 - BEFORE STARTING WORK, THE CONTRACTOR SHALL VERIFY EXISTING CONDITIONS, INCLUDING DIMENSIONS AND ELEVATIONS, AND REPORT ANY DISCREPANCIES TO ARCHITECT BEFORE START OF DEMOLITION. QUESTIONS REGARDING THE SCOPE OF DEMOLITION SHALL BE CLARIFIED WITH ARCHITECT PRIOR TO PROCEEDING WITH WORK. THE CONTRACTOR SHALL PREPARE A LIST OF EXISTING DAMAGED AREAS, DOCUMENTED BY DATED PHOTOGRAPHS AND SIGNED BY THE PERSON CONDUCTING THE INVESTIGATION TO BE PRESENTED TO THE OWNER FOR VERIFICATION PRIOR TO STARTING DEMOLITION.
 - THE ARCHITECT HAS NO KNOWLEDGE OF AND SHALL NOT BE HELD LIABLE FOR ANY ASBESTOS OR OTHER HAZARDOUS MATERIALS DISCOVERED DURING CONSTRUCTION. THE CONTRACTOR SHALL ISOLATE THE AFFECTED AREA AND CONTACT THE OWNER FOR FURTHER INSTRUCTIONS BEFORE PROCEEDING.
 - CONTRACTOR SHALL COORDINATE DEMOLITION OPERATIONS WITH THE OWNER, AND PROCURE PRIOR APPROVAL FOR ALL DEMOLITION PROCEDURES, INCLUDING USE OF BUILDING FACILITIES, PLACEMENT OF DUMPSTERS, REFUSE REMOVAL, AND PHASING. CONTRACTOR SHALL COORDINATE REMOVAL AND STORAGE OF ALL SALVAGED ITEMS WITH THE OWNER.
 - PROTECT AND MAINTAIN THE OPERATION OF ANY EXISTING SYSTEMS TO REMAIN FUNCTIONAL DURING THE PROJECT. PROCURE PRIOR APPROVAL FROM THE OWNER FOR ANY SHUTDOWNS REQUIRED.
 - CONTRACTOR TO VERIFY STRUCTURAL CONDITIONS BEFORE DEMOLITION BEGINS. PROVIDE TEMPORARY OR PERMANENT STRUCTURE AS REQUIRED.
 - MISC. EQUIPMENT OR FURNISHINGS SHALL BE STORED OR REMOVED AT THE DISCRETION OF THE OWNER.
 - REPAIR & PREPARE EXISTING WALLS, FLOORS, AND CEILINGS TO RECEIVE NEW FINISHES. REMOVE ALL EXISTING FLOOR FINISHES AND WALL BASE. U.N.O. REMOVE ALL EXISTING CONDITIONS WHICH CAUSE UNEVENNESS IN FLOORING SURFACE, SUCH AS FASTENERS, OUTLET CORES, MOUNDED COVER PLATES, RESILIENT FLOORING, CARPET, CARPET PAD, FLOOR PATCH, TO ENSURE THAT FLOOR IS SMOOTH AND LEVEL. PREPARE FOR NEW FINISHES.
 - WHERE PLUMBING FIXTURES ARE REMOVED, EXISTING PIPING SHALL BE CAPPED OR REMOVED.
 - WHERE ELECTRICAL FIXTURES ARE REMOVED, EXISTING WIRING SHALL BE REMOVED BACK TO DISTRIBUTION PANEL OR ELEC. J-BOX. REFER TO ELECTRICAL DEMOLITION DRAWINGS.
 - AFTER DEMOLITION, ALL ABANDONED PENETRATIONS SHALL BE PATCHED AND FIRE PROTECTED ACCORDING TO CODE.
 - CONTRACTOR TO PROTECT AREAS TO REMAIN OPERATIONAL FROM DUST & DEBRIS. CONTRACTOR IS RESPONSIBLE FOR MAINTAINING AND CLEANING ANY AREAS EXPOSED TO DUST OR DEBRIS FROM DEMOLITION ACTIVITIES.

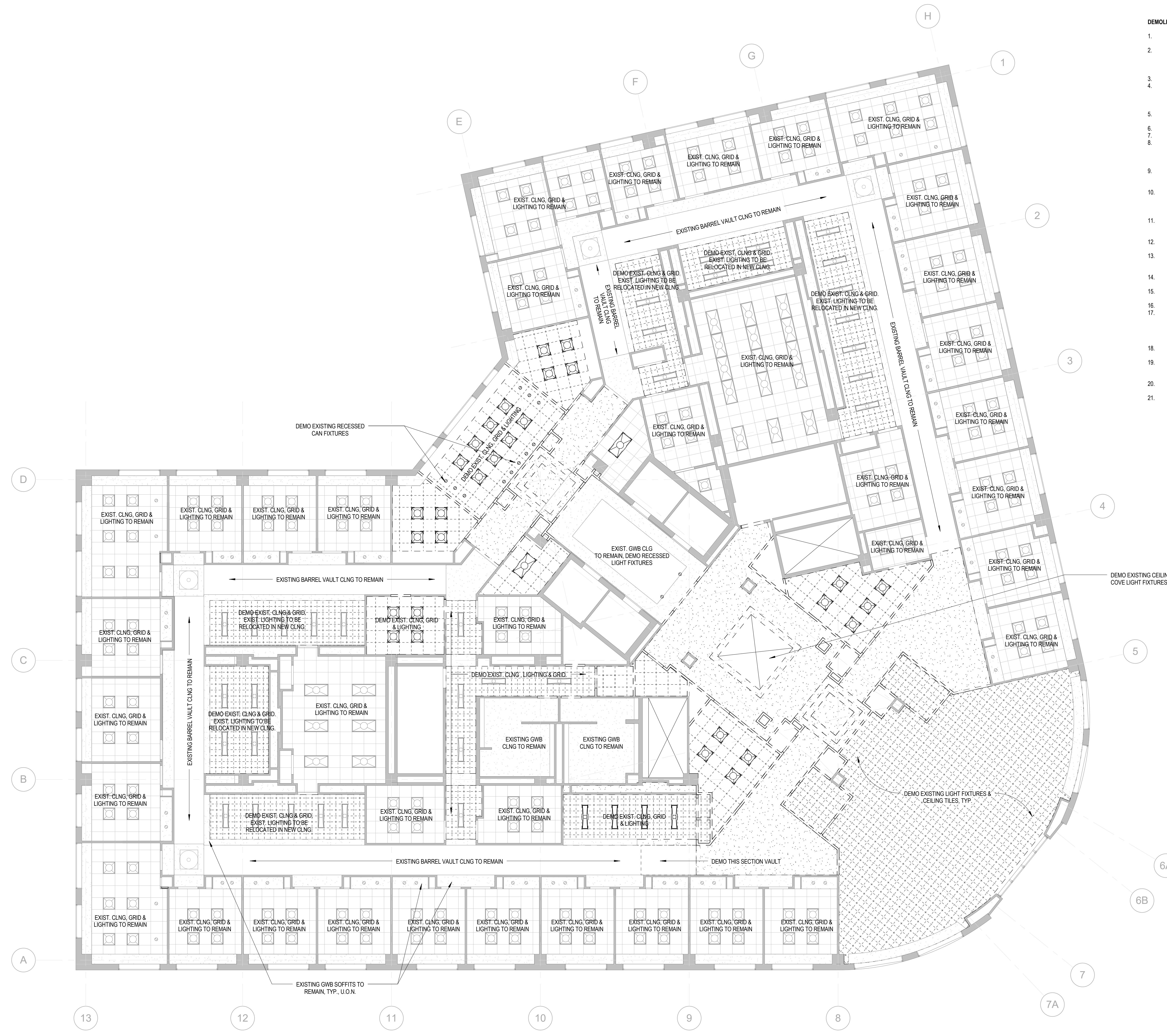

1 FLOOR 10 DEMO RCP
 1/8" = 1'-0"

THIS DRAWING IS THE PROPERTY OF CANAL 5 STUDIO AND IS NOT TO BE COPIED OR REPRODUCED IN PART OR WHOLE. 2014 © CANAL 5 STUDIO

Mark	Date	Description

Project Status
**ISSUED FOR
 CONSTRUCTION**
 SEPTEMBER 21, 2016

Drawing Title
**FLOOR 10 DEMO
 RCP**

Scale: As indicated

Drawing Number
A07.4