



Graham Architects

Kennebunkport, Maine
T:207.967.8850
F:207.967.8851

www.grahamarchitects.com

PROJECT

HMPayson

One Portland Square, 5th Floor
Portland, Maine 04101

ISSUED 02.02.14

CLIENT

H.M. Payson
One Portland Square, 5th Floor
Portland, Maine 04101

CONTRACTOR

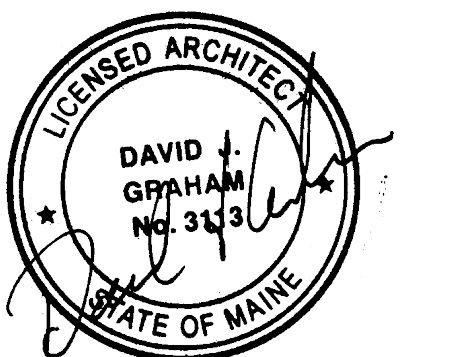

INFORMATION

Path: m:\architecture\CBRE\HMPayson

Issue Date: 02.03.14

Drawn By: DG

Checked By: DG

Revision:

- 1.
- 2.
- 3.
- 4.

TITLE

Finish Plan

SCALE: AS NOTED

©2014 Graham Architects All rights reserved. Information, material, and designs in this document are proprietary to and owned by Graham Architects and may not be disclosed to any third party, reproduced, posted on a global computer information network, or distributed in any way without the written consent from Graham Architects.

A5

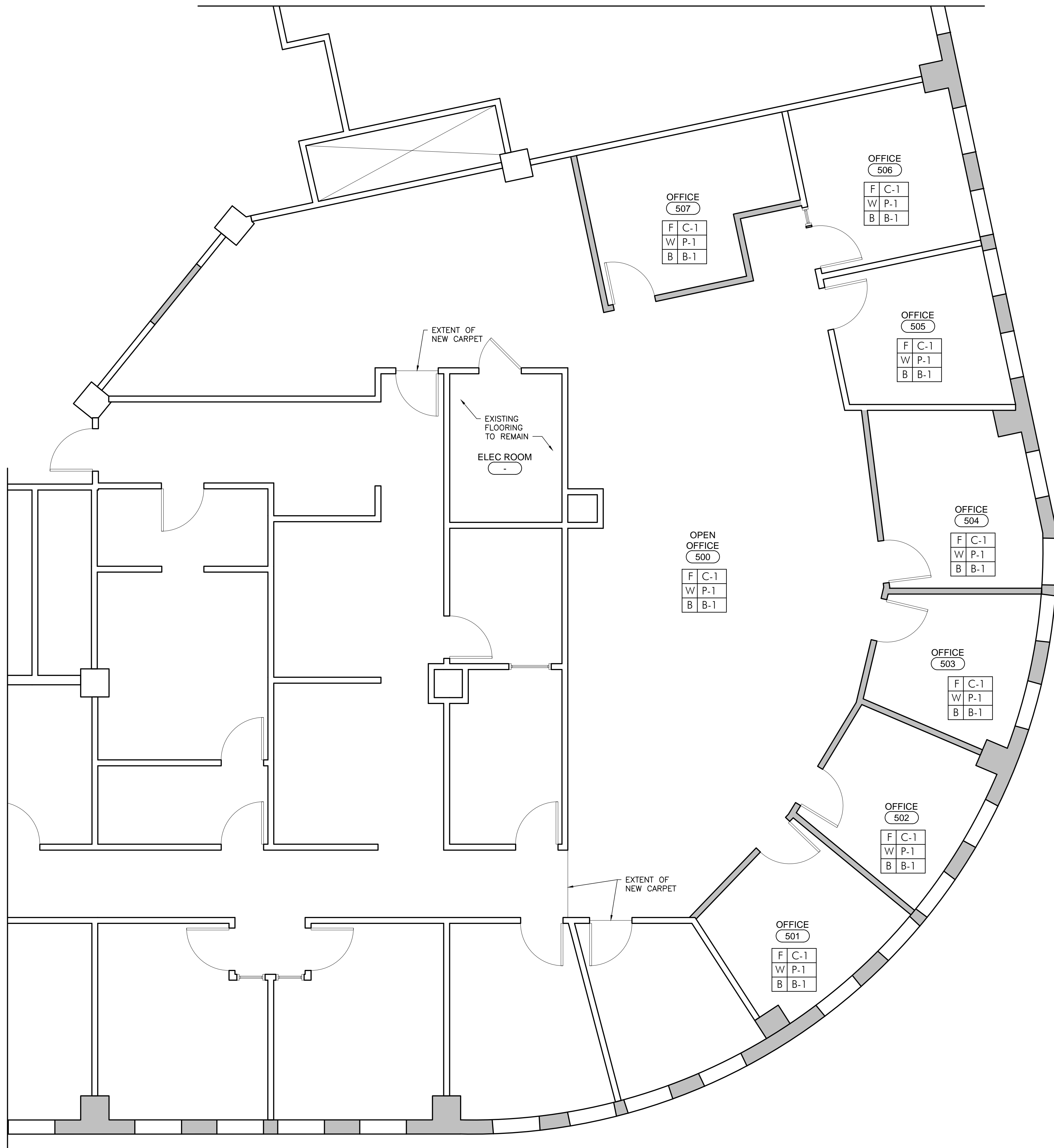

FINISH KEY

CODE	MANUFACTURE	MATERIAL / STYLE	PATTERN	COLOR	REMARKS
FLOORING					
C-1	TO BE DETERMINED	TO BE DETERMINED	TO BE DETERMINED	TO BE DETERMINED	
BASE					
B-1	JOHNSONITE	MATCH EXISTING		TBD	
WALLS					
P-1	BENJAMIN MOORE	LATEX EGGSHELL		TBD	
DOOR FRAMES					
TR-1	BENJAMIN MOORE	MATCH EXISTING		TBD	
CEILING					
ACT-1	ARMSTONG	MATCH EXISTING	MATCH EXISTING		

GENERAL FINISH NOTES

1. CONTRACTOR TO SUBMIT ALL FINISHES FOR ARCHITECT'S APPROVAL PRIOR TO INSTALLATION. INSTALLATION OF FINISHES TO COMPLY WITH MANUFACTURES SPECIFICATIONS AND REQUIREMENTS.
2. CONTRACTOR IS REQUIRED TO FIELD INSPECT EXISTING FLOOR CONSTRUCTION AND SLABS CONDITIONS, PRIOR TO BID, AND DETERMINE THE AMOUNT OF FLOOR LEVELING REQUIRED. INFORM SOLIDUS OF REQUIRED LEVELING AND INCLUDE ALL COSTS WITH BID.
3. ALL PAINT SHALL BE APPLIED IN ACCORDANCE WITH MANUFACTURES SPECIFICATIONS FOR PARTICULAR SURFACES. PROVIDE A MINIMUM TWO(2) COATS OVER (1) PRIMER COAT AS REQUIRED. TOUCHUP WHERE REQUIRED BEFORE COMPLETION. AREAS WHERE EXISTING DARK COLOR MAY REQUIRE SEVERAL COATS.
4. PROVIDE HARD RUBBER TRANSITION STRIP AT TRANSITION FROM RESILIENT FLOORING AND CARPET.
5. FLOORING TRANSITION SHALL OCCUR AT CENTER LINE OF DOOR.
6. REMOVE ALL ROUGH SPACKLE, ETC. FROM WALL TO PROVIDE A SMOOTH SURFACE WHERE BASE IS TO BE APPLIED.

3 NTS FINISH KEY

ROOM FINISH SCHEDULE

RM. No.	ROOM NAME	FLOOR	FLOOR FINISH	BASE	WALLS			CEILING			
					MAT.	FIN.	ACCENT PAINT	MAT.	FIN.	HGT.	
500	OPEN OFFICE	EXIST	-	EXIST	GYP.	PAINT	P-1	-	ACT	ACT 1	EXIST.
501	OFFICE	C-1	-	B1	GYP.	PAINT	P-1	-	ACT	ACT 1	EXIST.
502	OFFICE	C-1	-	B1	GYP.	PAINT	P-1	-	ACT	ACT 1	EXIST.
503	OFFICE	C-1	-	B1	GYP.	PAINT	P-1	-	ACT	ACT 1	EXIST.
504	OFFICE	C-1	-	B1	GYP.	PAINT	P-1	-	ACT	ACT 1	EXIST.
505	OFFICE	C-1	-	B1	GYP.	PAINT	P-1	-	ACT	ACT 1	EXIST.
506	OFFICE	C-1	-	B1	GYP.	PAINT	P-1	-	ACT	ACT 1	EXIST.
507	OFFICE	C-1	-	B1	GYP.	PAINT	P-1	-	ACT	ACT 1	EXIST.

2 NTS ROOM FINISH SCHEDULE

1 1/4"=1'-0" FINISH PLAN