

174
1000 of Square 5

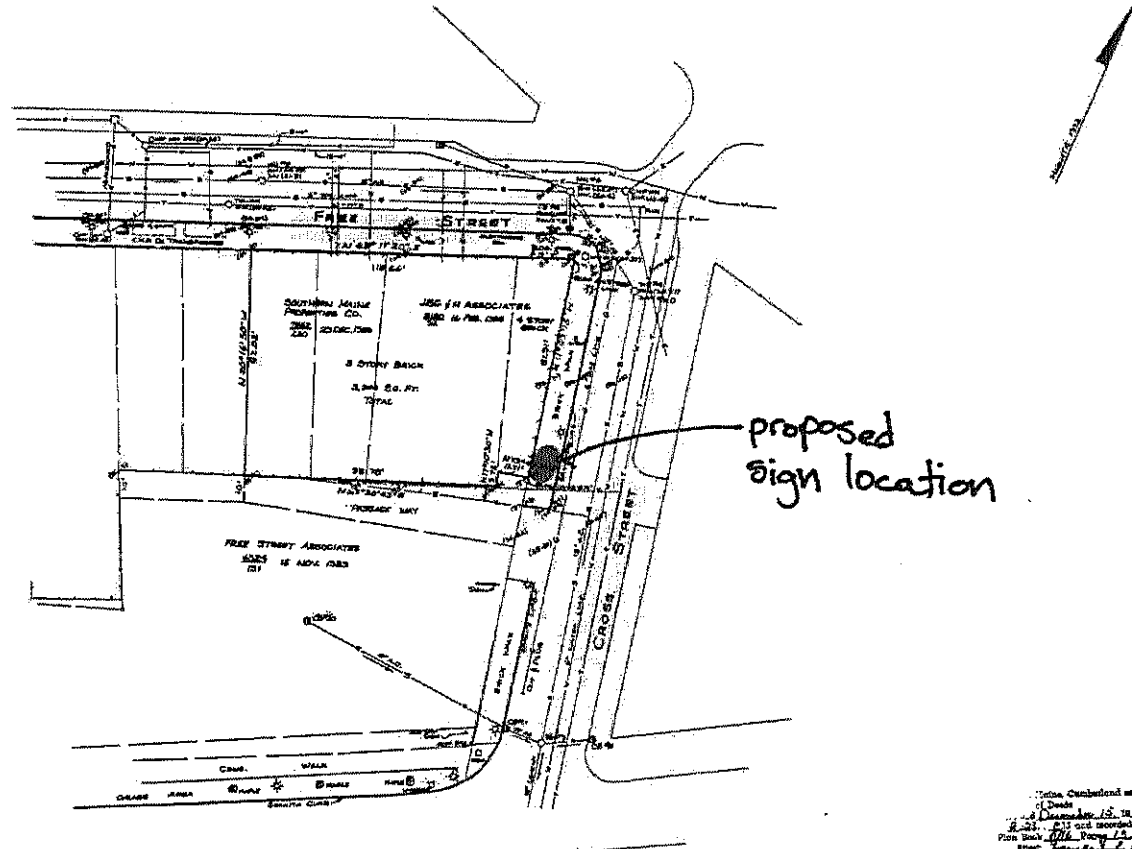

proposed
sign location

- (SOLID)
- NEAREST
 - NEARBY
 - NEARBY
 - NEARBY
 - NEARBY
 - NEARBY
 - NEARBY
 - NEARBY
 - NEARBY



John P. Strathmore Jr.

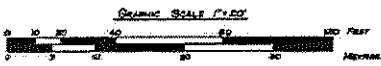

NOTE:
NO FIELD SURVEY AT THIS DATE. DATA ON PROPERTY LINES, PERMITS AND UTILITIES TAKEN FROM RECORDS MADE FOR J.S. BROWN & SONS, INC. ENGINEERS, 20, 1981. UTILITIES SHOWN ARE FROM FIELD SURVEYS, PLANS FROM UTILITY COMPANIES, BUILDING CONNECTION INVESTIGATIONS AND OTHER SOURCES AND ARE APPROXIMATE ONLY. UNDERGROUND UTILITIES SHOULD BE DONE PRIOR TO ACTUAL CONSTRUCTION.

1000 of Square 5
of Deeds
...
...
...
...

1984

DATE	REVISION
	PLAN OF PROPERTY
PORTLAND, MAINE	
MADE FOR	
PROPOSED 10 FREE STREET CONDOMINIUM ASSOCIATION STANDARD BOUNDARY SURVEY	
M. I. AND E. C. JORDAN - SURVEYORS	
DIVISION OF E. C. JORDAN CO.	
580 COLUMBIAN STREET PORTLAND, MAINE	
DATE	BY
AUG. 5, 1984	DS
PLAT NO.	PLAT PERM.
	4-55