

STORE #  
001800001RVvvtAAL

Preferred Wireless Consultants - 484 Congress Street, Portland, ME

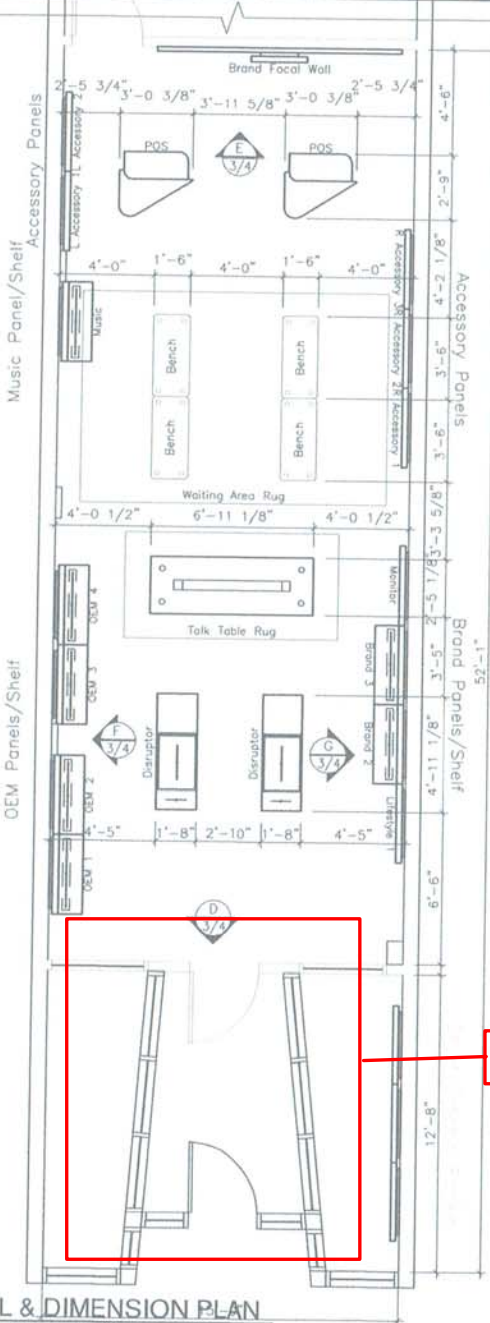

Per William Heilig both doors swing outward

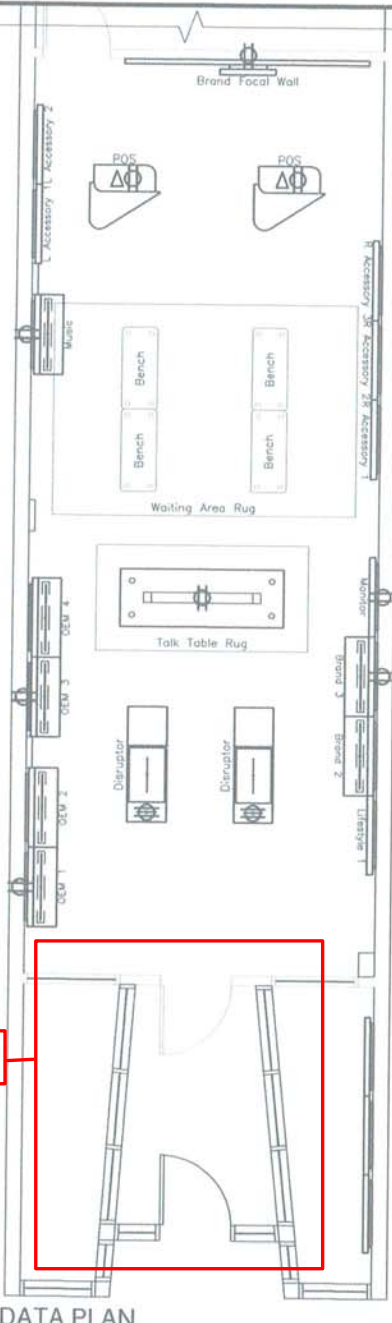

Notes:

Contacts:

Sheet:  
2

**B** DETAIL & DIMENSION PLAN  
SCALE: 1/8" = 1'-0"

**C** POWER & DATA PLAN  
SCALE: 1/8" = 1'-0"

principle  
 2023 Linnville Centre Blvd, Suite 250  
 Ashland, MA 01807 USA  
 P: 961.687.4061 | 800.647.1104  
 www.principle.com  
 All Services are available  
 on an as-is basis.  
 Free estimates to be made by  
 Certified Electrical Contractors only.

© 2014  
 This document is the property of Preferred Wireless Consultants. All rights reserved. No part of this document may be reproduced or transmitted in any form or by any means, electronic or mechanical, including photocopying, recording, or by any information storage and retrieval system, without the prior written permission of Preferred Wireless Consultants.