

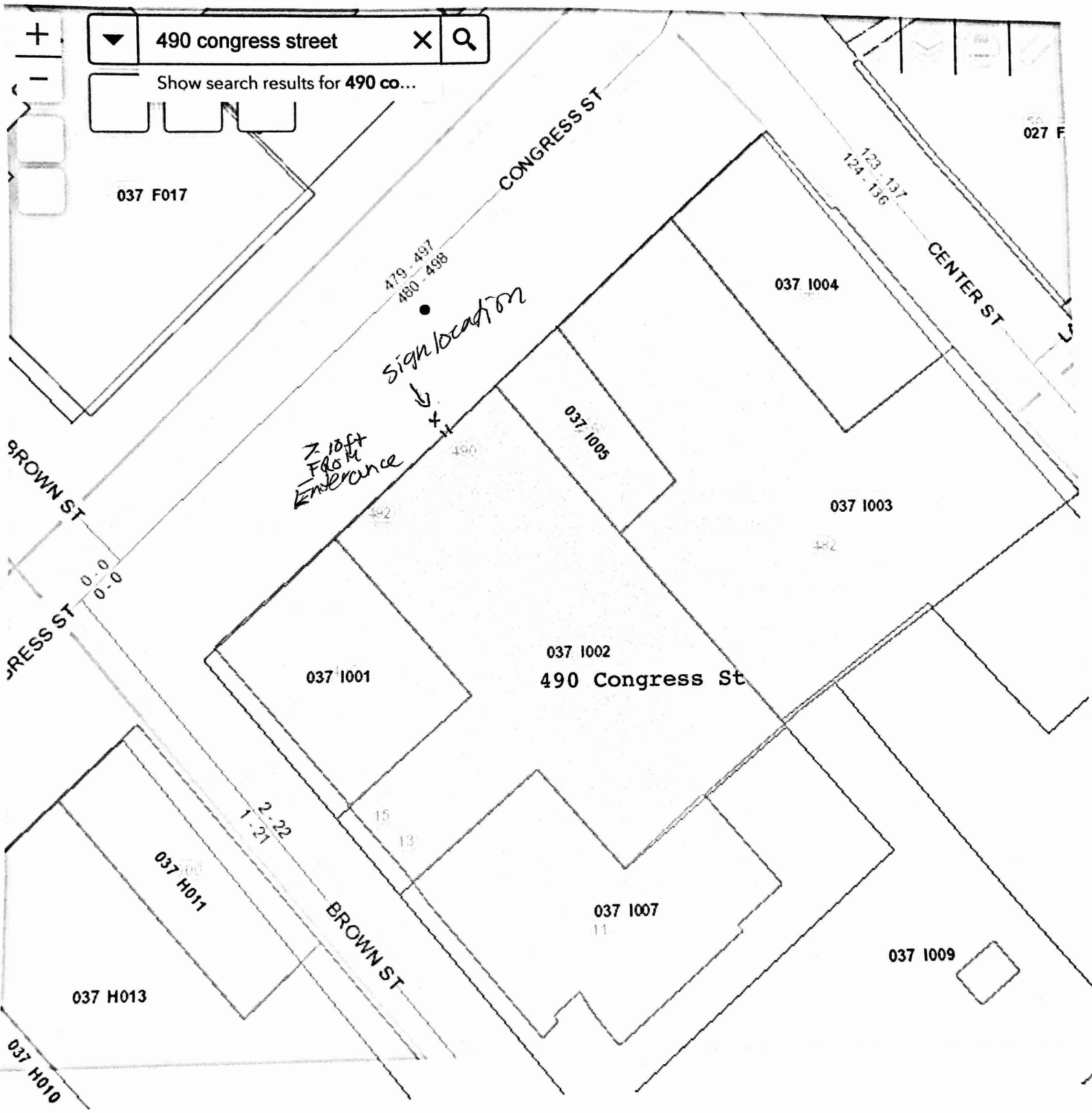

City of Portland Maine GIS Viewer

with Web AppBuilder for ArcGIS





Permitting and Inspections Department
Michael A. Russell, MS, Director

Signage /Awning Permit Application Checklist

(For the purposes of this application, an awning shall be considered to be a lightweight metal frame structure over which a fabric covering is attached.)

All of the following information shall be submitted:

- Signage/Awning Permit Application form
- Certificate of Liability listing the City as an additional insured if any portion of the sign abuts or encroaches on any public right of way, or can fall into any public right of way.
- A copy of the signed lease or letter of permission from the property owner indicating the specific permissions granted and the tenant/space building frontage.
- A plan showing the specific locations of all existing and proposed signs:
 - For freestanding signs: the plan shall depict lot lines, buildings, driveways, abutting streets or rights of way, lengths of street frontages, and setbacks from freestanding signs to the nearest lot line.
 - For all other signs and awnings: the plan shall depict buildings, driveways, abutting streets or rights of way, and building façade dimensions. Photos or other documentation similar to a drawn plan are acceptable, provided that all required information is included.
- A drawing or photo of the proposed sign showing content, all dimensions, materials, source of illumination, details of anchoring and installation (e.g., attachment specifications, footing details for freestanding signs, etc.).
- Certificate of flammability is required for awnings or banners.
- A UL Classification Mark, found on the product, is required for illuminated signs at the time of final inspection.
- Photos of existing signage.

be sure to submit all information outlined in the Sign/Awning Application Checklist with your application.

The Permitting and Inspections Department may request additional information prior to the issuance of a permit. For further information, visit us online at www.portlandmaine.gov/1728/Permitting-Inspections.