

**THIRD FLOOR FRAMING PLAN**

- NOTES:
1. (MC) INDICATES MOMENT CONNECTION.
  2. ALL BEAMS AND COLUMNS ARE EXISTING L.L.C.
  3. (---) INDICATES EXISTING COLUMN W/ HSB+4x4x1/2 CONE TO THE PER ON EACH SIDE.
  4. ATTACH 1/2\"/>

THESE DRAWINGS HAVE BEEN DEVELOPED BY L&L STRUCTURAL ENGINEERING SERVICES, INC. FOR THE FULL SET ONLY. THE DRAWINGS ARE THE PROPERTY OF L&L STRUCTURAL ENGINEERING SERVICES, INC. AND THEY SHALL NOT BE LOANED, REPRODUCED OR ALTERED WITHOUT THE WRITTEN CONSENT OF L&L STRUCTURAL ENGINEERING SERVICES, INC.



390 Congress Street  
Portland, Maine  
Kempall Building, LLC  
Portland, Maine  
James Sterling  
A.A. Architect  
112 High Street  
Portland, Maine

THIRD FLOOR FRAMING PLAN

SCALE: 1/8" = 1'-0"

DATE:  
JUNE 27, 2005

FOR CONSTRUCTION

S-1.4

The headers required for the 16'-0" R.O. are as follows:

The upper most level - 5 14x18 Vers-Iam  
 The two lower levels - 5 14x14 Vers-Iam

*ROW FROM MARK LEASURE  
10/1/05 IN PLAN*

Also provide a (3) jack studs to support the 16" VL and then (4) jack studs for the others. Between eve 1 & 2 support the jack studs w/ (5) 2X6 studs and install (3) 2X12 post in the basement below the (6) 2X6. Block the joist cavity solid below w/ posts.

NOTE: PROVIDE 2x6 SHEAR WALL CONTINUOUS TO ROOF AT THIS LEVEL. TYPICAL APPLY 1 LAYER OF 5/8" SHEET ROCK EACH SIDE. BLOCK ALL PANEL EDGES SOLID.

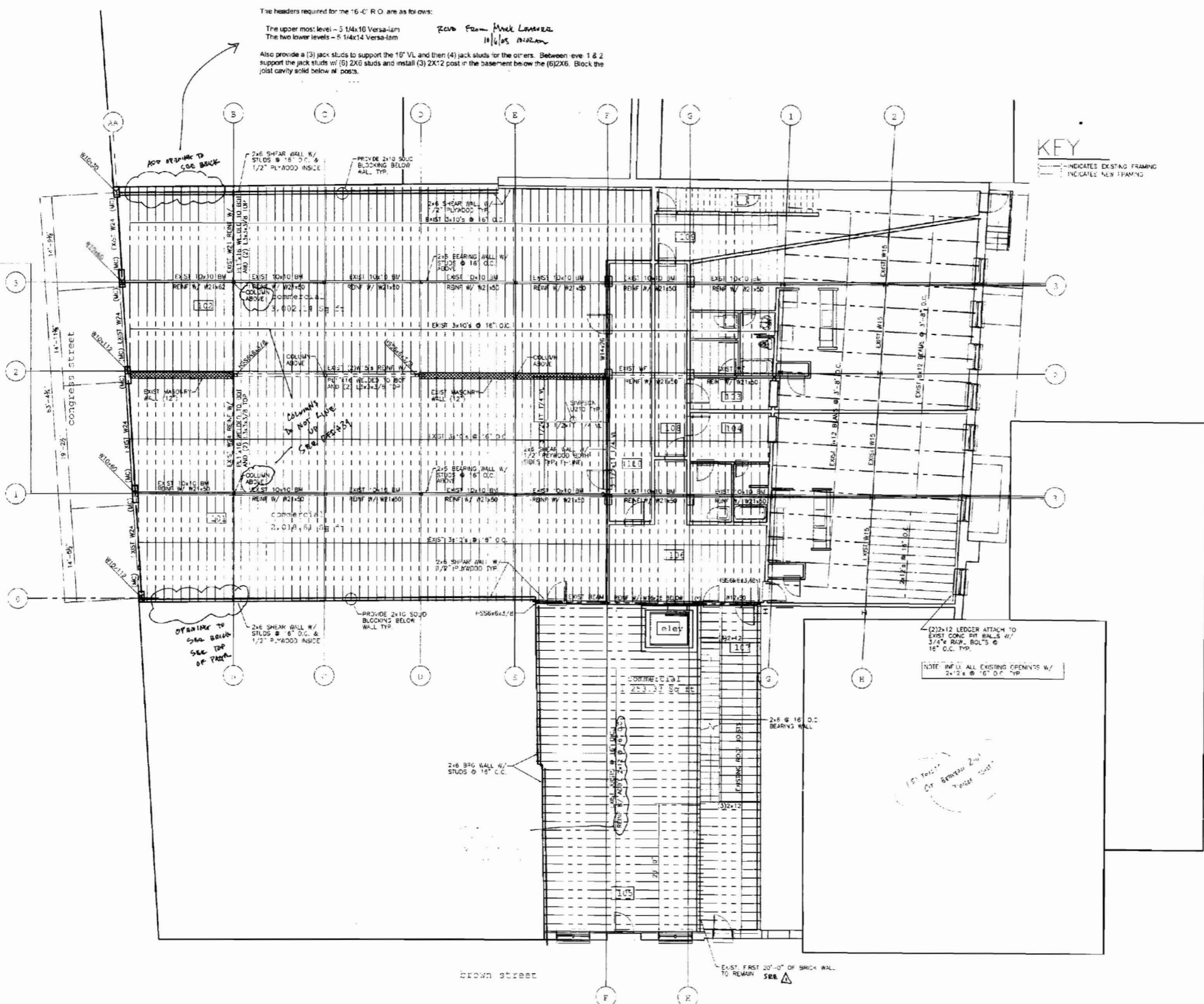

**KEY**  
 - - - - - INDICATES EXISTING FRAMING  
 ———— INDICATES NEW FRAMING

**SECOND FLOOR FRAMING PLAN**

- REVISIONS:
1. (MC) - INDICATES MOMENT CONNECTION.
  2. ALL BEAMS AND COLUMNS ARE EXISTING I.N.C.
  3. (O) INDICATES EXISTING COLUMN W/ -SS-4x4x3/8 CONT TO THE F.O.Y. ON EACH SIDE.
  4. 1 LAYER 1/2" PLYWOOD TO SHEAR WALLS W/ 1/2" BR NAILS @ 4" C.C. AT MAKE TIGHT AND 1" C.C. AT INTERMEDIATE SUPPORTS. BLOCK ALL PANEL EDGES SOLID.

THESE DRAWINGS HAVE BEEN DEVELOPED BY L&L STRUCTURAL ENGINEERING SERVICES, INC. FOR THE TILED SET ONLY. THESE DRAWINGS ARE THE SOLE PROPERTY OF L&L STRUCTURAL ENGINEERING SERVICES, INC. AND THEY SHALL NOT BE USED, LENT, COPIED OR ALTERED WITHOUT THE WRITTEN CONSENT OF L&L STRUCTURAL ENGINEERING SERVICES, INC.



400 Congress Street  
 Portland, Maine  
 Kimball Building, LLC  
 Portland, Maine  
 James Stealing  
 AIA  
 Architect  
 142 High Street  
 Portland, Maine

FOR CONSTRUCTION

SECOND FLOOR FRAMING PLAN

SCALE: 1/8" = 1'-0"

DATE: JUNE 27, 2005

S-1.3

