

DOOR SCHEDULE see spec for hardware

door number	type	size	room name/remarks
BASEMENT LEVEL			
002a	I	3'0"x6'8"	elevator mechanical room
004a	I	3'0"x6'8"	electrical/ gas/ water
005a	I	3'0"x6'8"	stair entry
005b	I	3'0"x6'8"	commercial storage
005c	I	3'0"x6'8"	commercial entry
005d-e-f-g-h-k-l-m-n	I	3'0"x6'8"	storage
005j	I	3'0"x6'8"	residential storage
005o	I	3'0"x6'8"	stair entry
005p	I	(2)2'8"x6'8"	trash room (double)
005q	L	*4'9"x6'4"	bulkhead - field verify existing foundation dimensions
005r	I	3'0"x6'8"	bathroom
005s	I	3'0"x6'8"	residential storage
006a-b-c-d-e-f-g-h-i	J	3'0"x6'8"	residential storage
010a-c-d-e-f-g	J	3'0"x6'8"	residential storage
010b	I	3'0"x6'8"	commercial entry
FIRST LEVEL			
COMMERCIAL			
101a	F	(2)3'0"x7'0"	entry (double door)
101b	D	3'0"x6'8"	storage entry
102a	F	(2)3'0"x7'0"	entry (double door)
102b	D	3'0"x6'8"	storage entry
103a	E	3'0"x8'0"	entry
103b	D	3'0"x6'8"	back entry
FREE STREET UNITS			
104/ 105			
a	D	3'0"x6'8"	entry
104b	A	2'8"x6'8"	closet
105b	A	2'8"x6'8"	laundry
c	A	3'0"x6'8"	bathroom
d	A	2'8"x6'8"	closet
104e	C	(2)2'8"x6'8"	laundry (double)
105e	D	3'0"x6'8"	entry
f	K	3'0"x3'0"	mechanical access panel
COMMUNAL			
106a-106b	D	3'0"x6'8"	storage entry
106c	D	3'0"x6'8"	lobby/elevator vestibule
107a	D	3'0"x8'0"	entry
107b	D	3'0"x6'8"	stair entry
107c	D	3'0"x6'8"	lobby/ elevator vestibule
109a	D	3'0"x6'8"	stair entry
109b	I	3'0"x8'0"	egress
109c	D	3'0"x6'8"	stair entry
112a	G	3'0"x8'0"	entry/ intercom

see plans for door swing/ lockset orientation
see spec for hardware schedule

DOOR K	
thickness	1 3/4"
material	solid core birch veneer
finish	clear
rating	none
threshold	none
note	field size and location detail see -1/ A-4.3

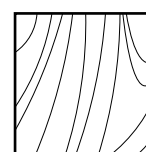

DOOR L	
description	bulkhead
material	metal
note	field size to existing foundation

DOOR A	
thickness	1 3/8"
material	solid core birch veneer
finish	clear
rating	20 min
threshold	varies see 7.1

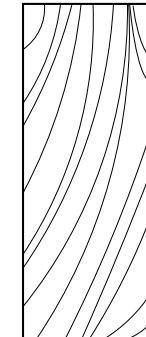

DOOR B	
thickness	1 3/8" sliding
material	solid core birch veneer
finish	clear
rating	none
threshold	varies see 7.1
hardware	henderson - husky sliding 200

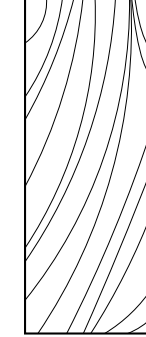

DOOR C	
thickness	1 3/8" double door
material	solid core birch veneer
finish	clear
rating	none
threshold	none

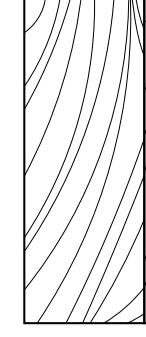

DOOR D	
thickness	1 3/4"
material	solid core birch veneer
finish	clear
rating	1 hour
threshold	varies see 7.1

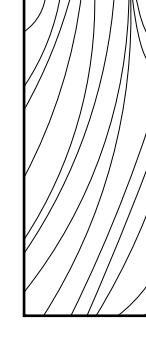

DOOR E	
thickness	1 3/4"
material	stainless-steel insulated, glass panel and wood detail
finish	enamel color
rating	none
threshold	metal

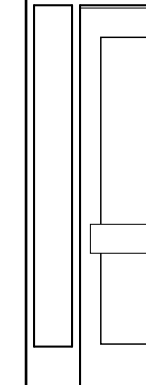

DOOR F	
thickness	1 3/4" double
material	stainless-steel insulated, glass panel and wood detail
finish	enamel color
rating	none
threshold	metal

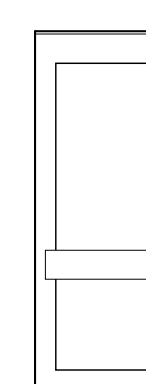

DOOR G	
thickness	1 3/4"
material	solid core birch veneer, glass panel
finish	clear
rating	1 hour
threshold	none

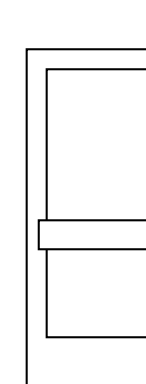

DOOR H	
thickness	1 3/4"
material	solid core, glass inset
finish	enamel color
rating	none
threshold	metal

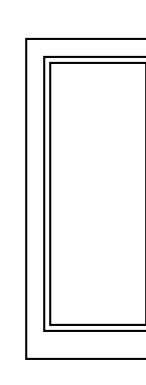

DOOR I	
thickness	1 3/4"
material	stainless steel - insulated
finish	enamel color
rating	1 hour
threshold	metal

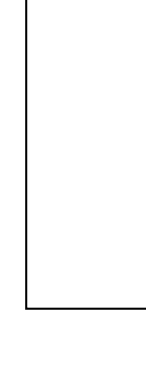

DOOR J	
thickness	1 3/4"
material	steel - chainlink fence
finish	enamel color
rating	none
threshold	none

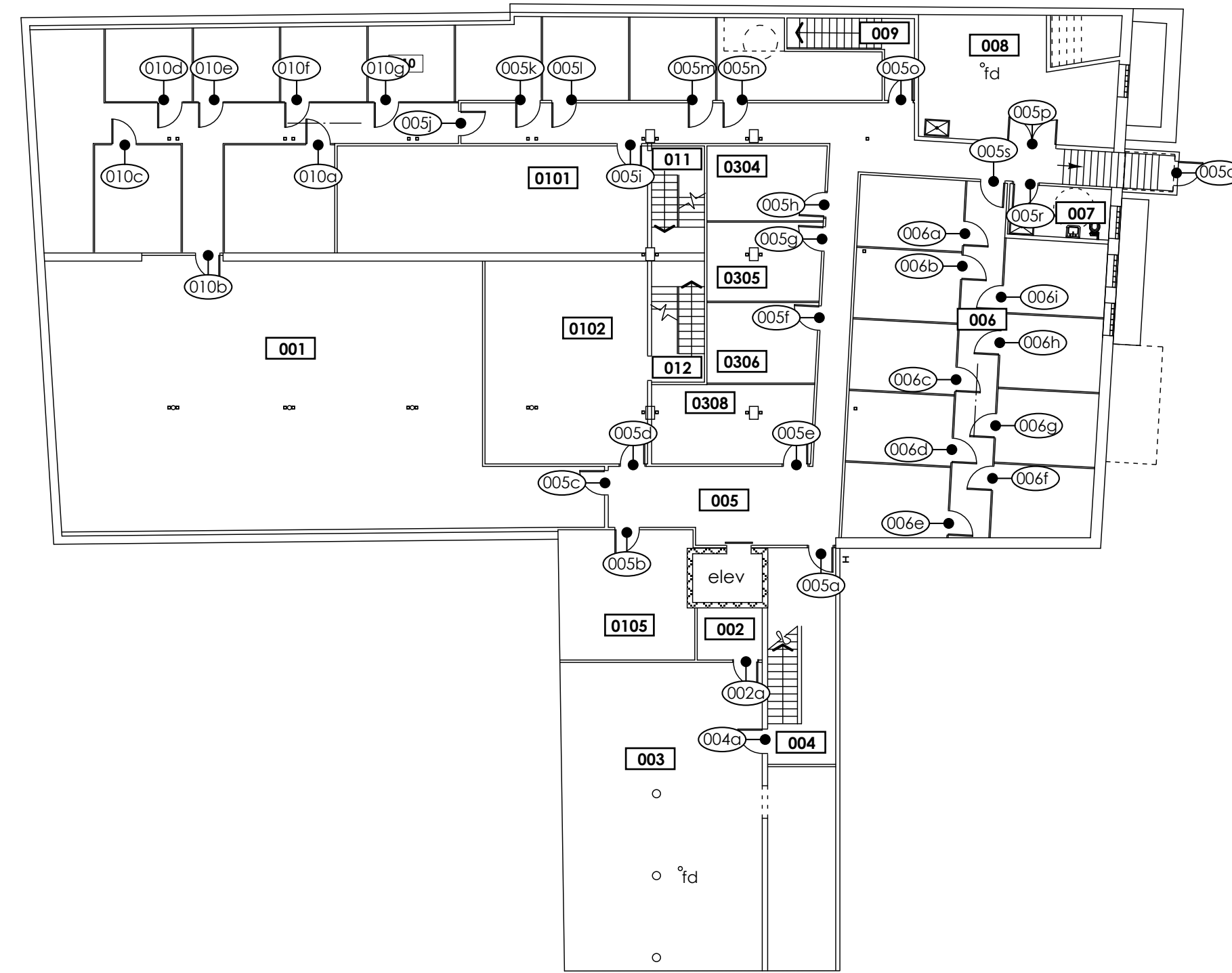
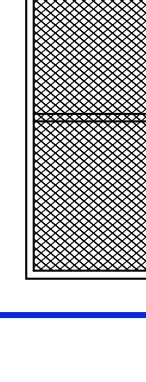

0 basement level

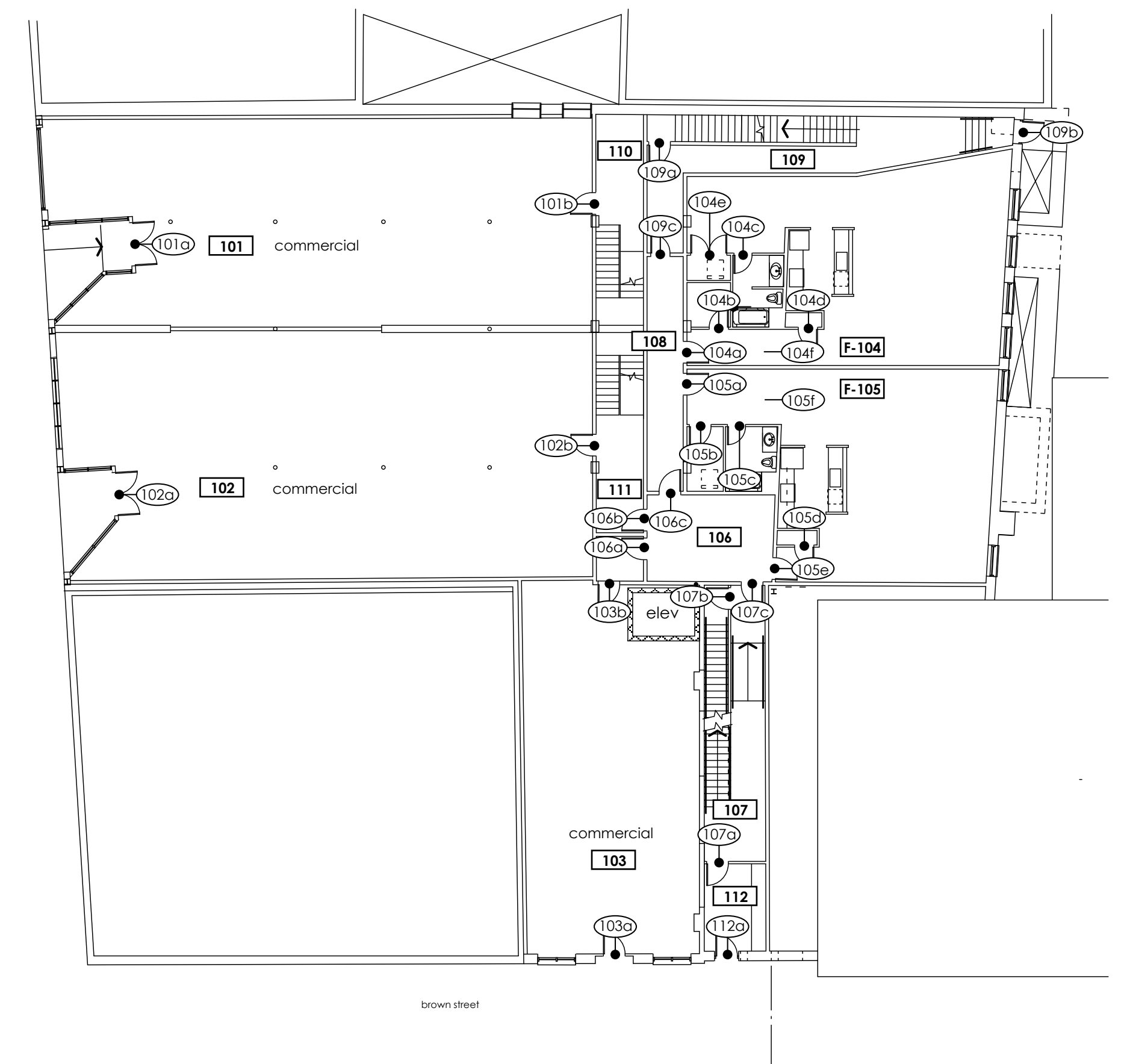

1 first level

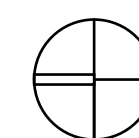

490 Congress Street
Portland, Maine
Kimball Block, LLC
Portland, Maine
James Sterling AIA
Architect
142 High Street
Portland, Maine

DOOR SCHEDULES

scale: 1/16" = 1' 0"

date: 20 May 2005