

Building Section D-D @ Congress Street Building
 1/4" = 1'-0"
 See A-1.7.1 for Roof Plan
 See A-7.1 for finish schedules / wall types

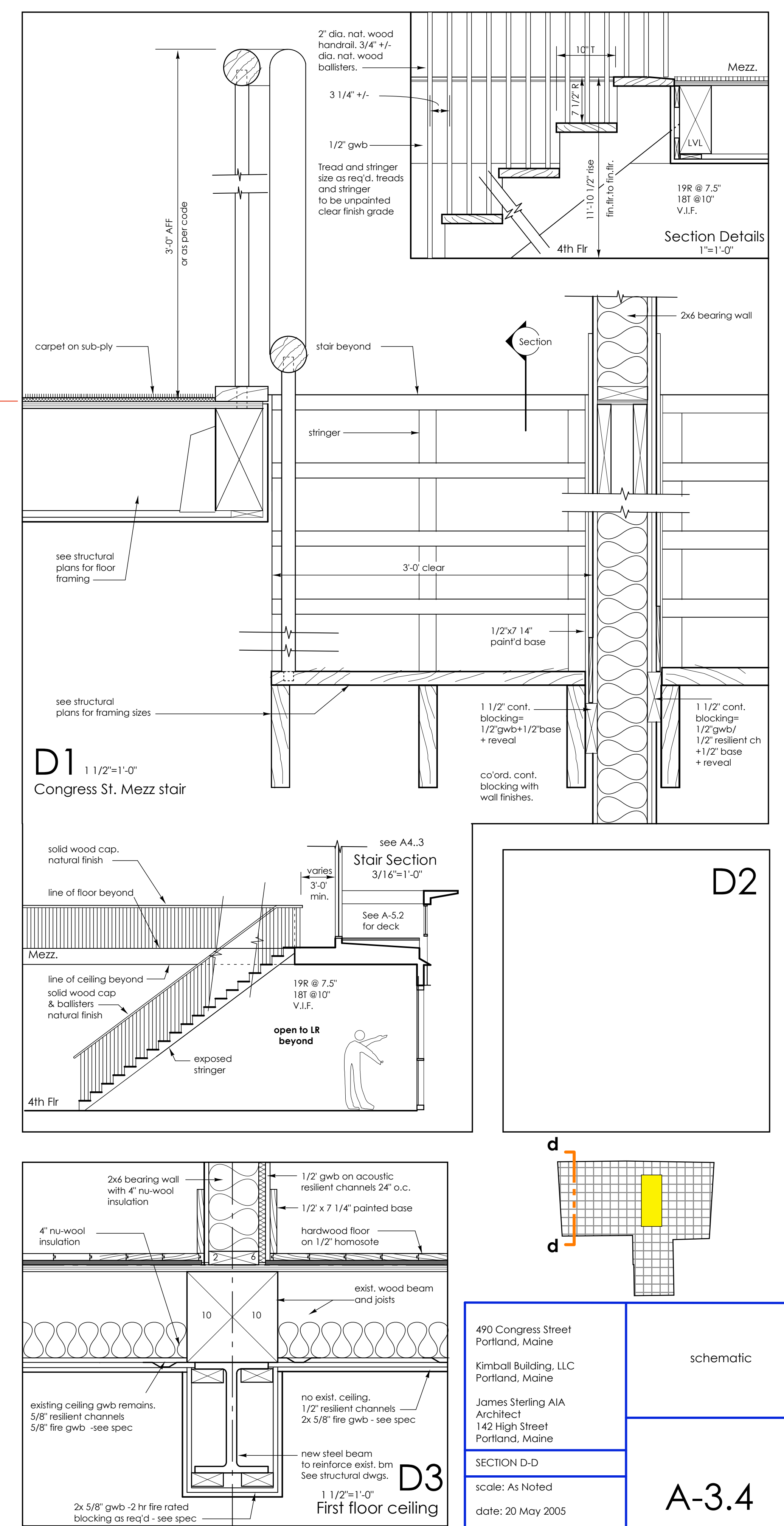

490 Congress Street
 Portland, Maine
 Kimball Building, LLC
 Portland, Maine
 James Sterling AIA
 Architect
 142 High Street
 Portland, Maine
 SECTION D-D
 scale: As Noted
 date: 20 May 2005

schematic
 A-3.4