

REMOVE 2 TREADS - PROVIDE FLAT 36" X 36" PLATFORM

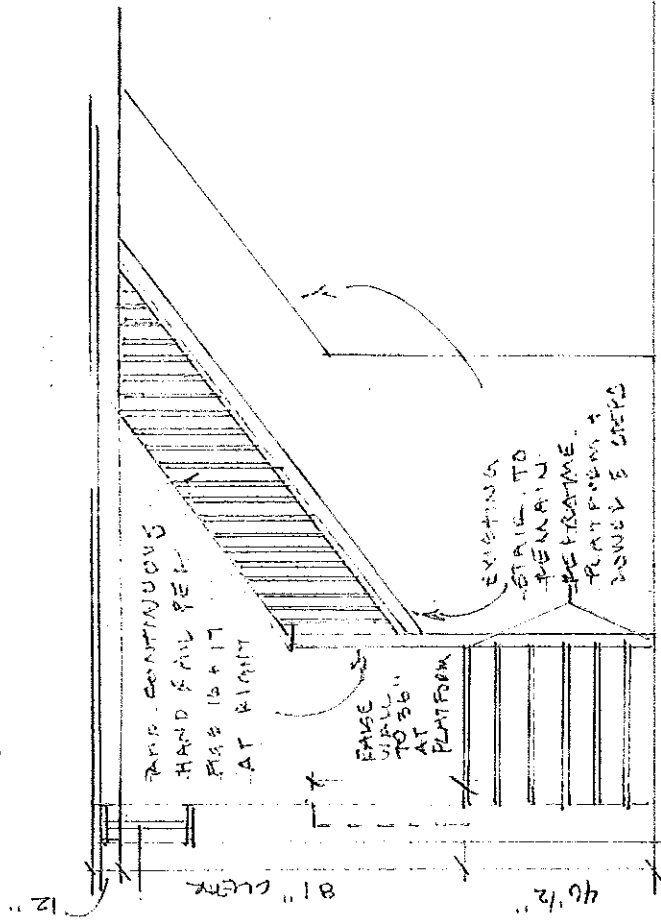
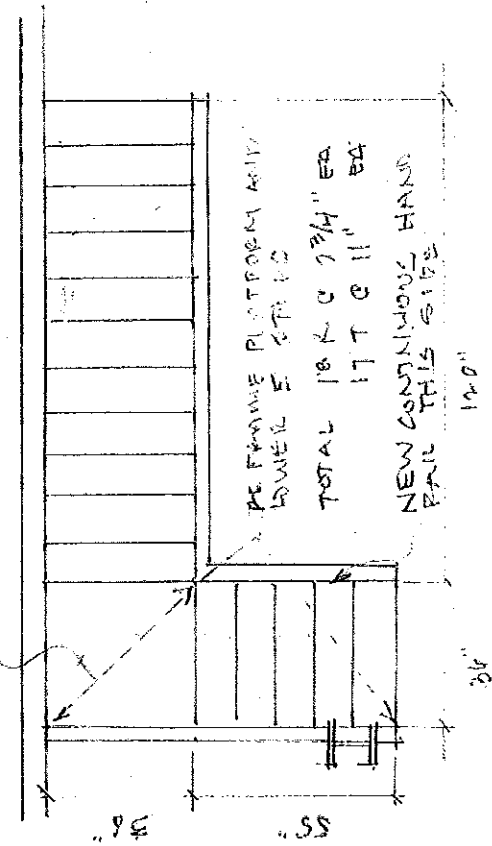

- MODIFY "NEW" (EXISTING) STAIR PER DRAWINGS TO COMPLY WITH REQUIREMENTS OF FIGURES 16 & 17
- EXISTING "NEW" STAIR WAS MISTAKENLY ADDED AFTER OCCUPANCY WITHOUT BUILDING PERMIT BY DWWSR.

FIG. 16

Guards

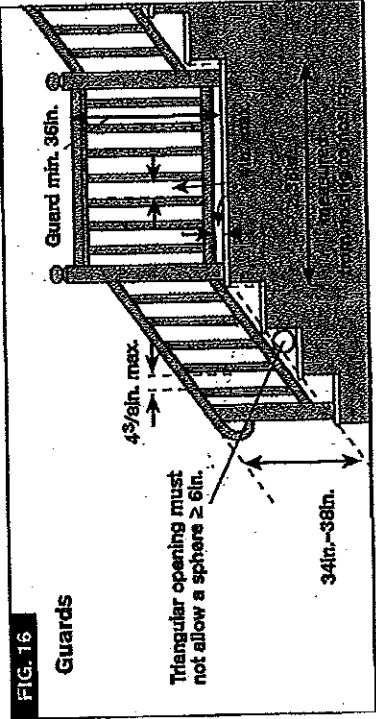

FIG. 17

Stair Profile

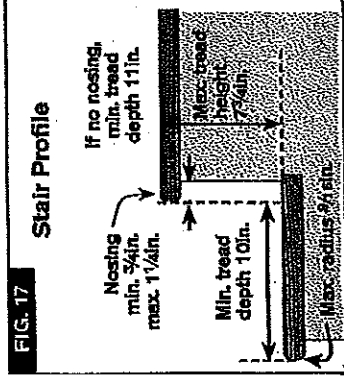
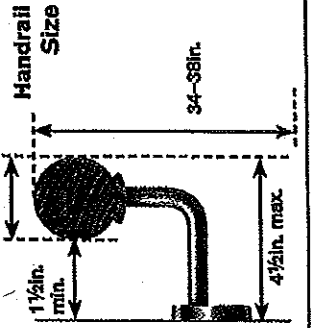

FIG. 18

Handrail Size



SEE ATTACHED PHOTOS OF EXISTING STAIRS

STAIR DETAIL

0 11 2 3 6  
SCALE 1/4" = 1'-0"  
1 AUGUST 2013