

LIFE SAFETY  
BASEMENT PLAN  
SCALE: 1/8" = 1'-0"

- NOTES:**
1. ALL EMERGENCY LIGHTS MUST BE POWERED BY BATTERY BACK-UP OR GENERATOR PER NFPA 101.
  2. HVAC PER NFPA 90A
  3. EMERGENCY LIGHTS TO AVERAGE 1 FOOTCANDLE AND .1 FOOTCANDLE MINIMUM.
  4. ALL FIRE WALL PENETRATIONS TO BE COMPLETELY SEALED TO MAINTAIN A 1 HR. RATING. ALL SMOKE-PROOF DOOR PENETRATIONS A FIRE WALL SHALL HAVE A 1 HR. DAMPER.
  5. ALL DOORS TO BE 3'-0" x 8'-8" MTL. (U.O.N) W/ METAL FRAME AND INSTALLED AS NOTED:
  6. ALL HANDRAILS TO BE +34" A.F.F. W/ 1-1/2" DIA (4" 1-1/2" FROM WALL IF APPLICABLE) W/ BALUSTERS LESS THAN 4" SPACE BETWEEN MAX. ON EA. SIDE OF ALL STAIRS AND RAMPS. EXTEND RAILS 12" BEYOND LIMITS OF RAMPS & TOP OF STAIRS & 23" BEYOND B.O. STAIRS. RETURN TO POST OR WALL, TYP.
  7. EXISTING BUILDING IS SPRINKLED. ADJUST ALL HEADS TO MATCH NEW CEILING HEIGHTS (PER NFPA 96)
  8. PROVIDE VOICE EVACUATION SYSTEMS PER NFPA 72 (BELOW NEW BALCONY)
- ABBREVIATIONS:**
- C.O = CASSED OPENING W/ 1x3 FLAT CASING W/ EASED EDGES
  - CL = DOOR CLOSER
  - MS = WEATHER STRIPPING SYSTEM
  - DL = ADA LEVER
  - R = RELOCATED
  - X = EXISTING TO REMAIN
- FIRE PROTECTION LEGEND**
- FE = FIRE EXTINGUISHER 10# ABC
  - EXIT LIGHT
  - STROBE ONLY WITH CANDELLA RATING AS NOTED
  - HORN STROBE WITH CANDELLA RATING AS NOTED
  - NOTED
  - DUAL EMERGENCY LIGHT
  - SINGLE EMERGENCY LIGHT
  - SMOKE DETECTOR (CEILING)
  - HEAT DETECTOR (CEILING)
  - COMBINATION LIGHT/EXHAUST FAN
  - FIRE ALARM MASTER CONTROL PANEL
  - PULL STATION
  - EXTERIOR EGRESS LIGHT
  - NOT AN EXIT SIGN W RAISED BRAILLE
  - WAN ACCESSIBLE
- NOTE:** STROBE OPTION TO HAVE COMMUNICATION RATING MEETING NFPA 72 TABLE 6-4.4.11(G) MOUNT AT +80" A.F.F. INCLUDE W/ VOICE EVACUATION SYSTEM.

**TOTAL OCCUPANCY**

BASEMENT POOL LOUNGE A	143	231
BASEMENT LOUNGE B	188	217
FIRST FLOOR MAN	217	175
FIRST FLOOR FRONT	175	66
GREEN ROOM	44	522
STAIRS	7	37
SECOND FLOOR CONFERENCE	30	37
STAFF + KITCHEN + BAND	25	274
<b>TOTAL</b>	<b>815</b>	

**FIRST FLOOR EGRESS**

STAFF + KITCHEN + BAND	23
FIRST FLOOR MAN	217
FIRST FLOOR FRONT	175
GREEN ROOM	66
STAIRS	44
<b>TOTAL</b>	<b>549</b>
CONGRESS STREET EGRESS	275
BROWN STREET EGRESS	274

LIFE SAFETY  
FIRST FLOOR PLAN  
SCALE: 1/8" = 1'-0"

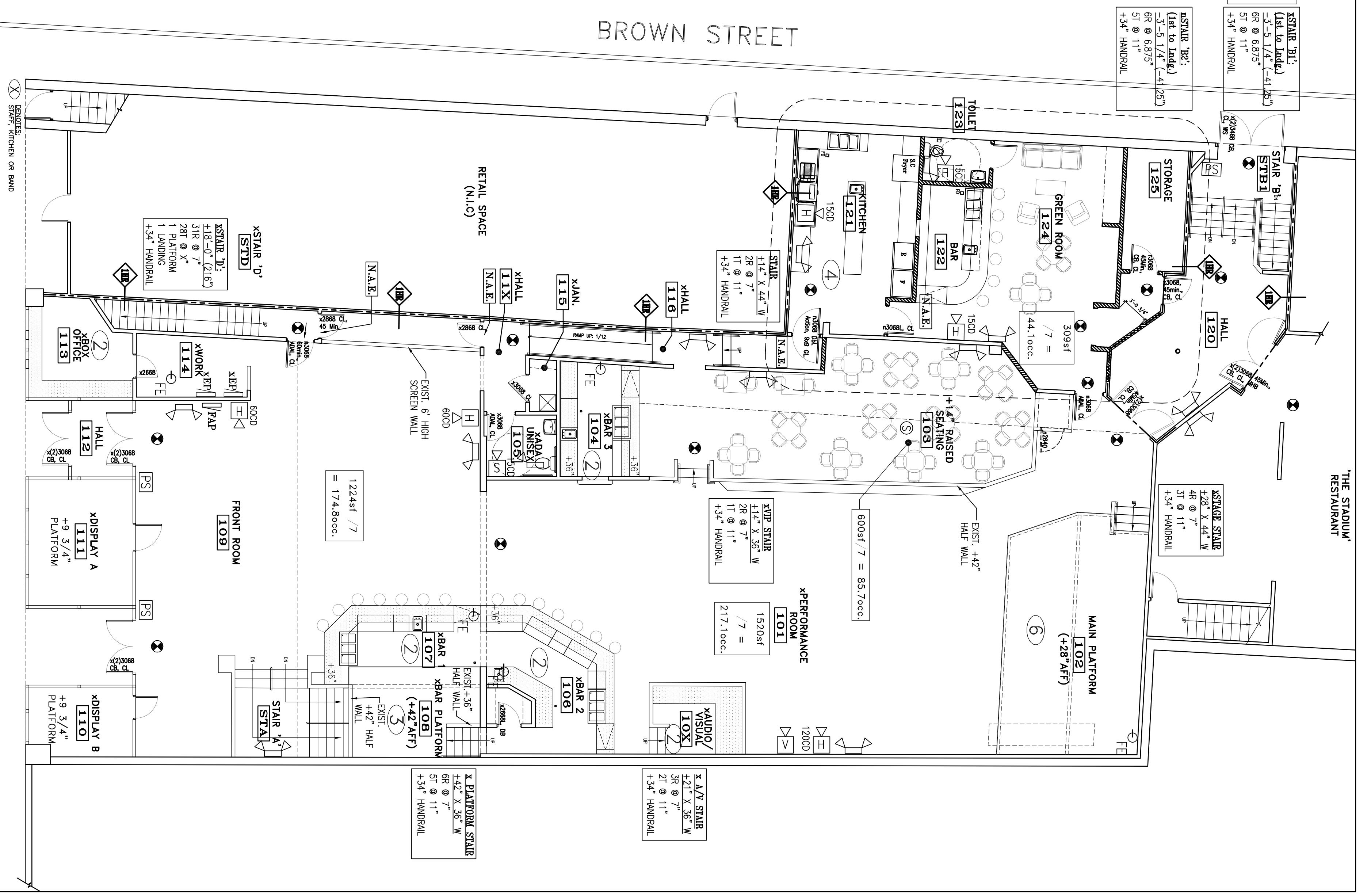

12-20-10

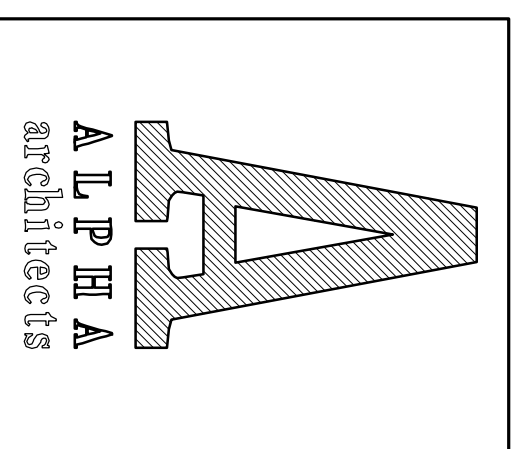

17 CHESTNUT STREET  
PORTLAND, ME 04101  
PHONE: 207.761.9500  
FAX: 207.761.9595  
design@alpharchitects.com

**© COPYRIGHT**  
Reuse or reproduction of the contents of this document is not permitted without the permission of ALPHA ARCHITECTS



**Port City Music Hall**  
**Kitchen Addition**  
504 Congress Street  
Portland, ME 04101

JOB: 10164

ISSUE DATE	
PRELIM.	12-01-10
Prop'd	+9 3/4"
CDS	-
REV. 1	-
REV. 2	-
PRINT	12-20-10

LIFE SAFETY  
BASEMENT &  
1ST FLOOR PLANS  
**LS-1**