



© 2014 RYAN SENATORE ARCHITECTURE

MEPS
510 CONGRESS STREET
PORTLAND, MAINE



RYAN SENATORE
ARCHITECTURE
565 CONGRESS STREET
SUITE 304
PORTLAND, MAINE 04101
207-650-6414
senatorearchitecture.com

CONSULTANTS:

REVISIONS:

DATE: OCTOBER 30, 2014

PROJECT No.

DRAWN BY: RRT / RJS

CHECKED BY: RJS

SCALE: AS NOTED

SHEET TITLE:
THERMOSTAT
REPLACEMENT
PLAN

A1-9

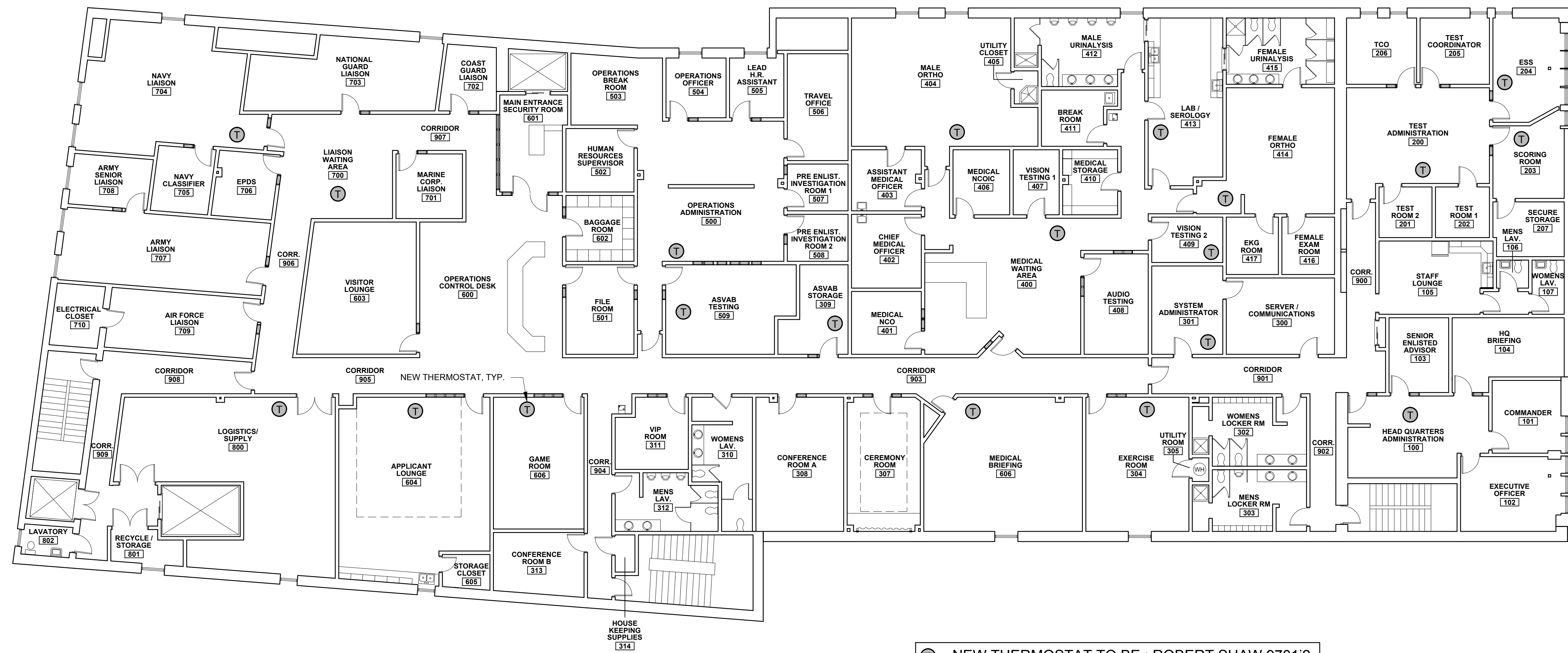

T = NEW THERMOSTAT TO BE : ROBERT SHAW 9701i2

1 THERMOSTAT REPLACEMENT PLAN
3/32" = 1'-0"

- THERMOSTAT NOTES
- 1.) PROVIDE ALL WIRING, BATTERIES AND CONNECTIONS AS REQUIRED FOR FULLY OPERATIONAL THERMOSTATS.
 - 2.) PROVIDE SET UP AND CALIBRATION WITH EXISTING MECHANICAL EQUIPMENT.
 - 3.) SET THERMOSTATS PER OWNER REQUEST. TRAIN OWNER IN OPERATION OF THERMOSTATS.