

© 2014 RYAN SENATORE ARCHITECTURE

MEPS  
510 CONGRESS STREET  
PORTLAND, MAINE

**RSA**  
RYAN SENATORE  
ARCHITECTURE  
565 CONGRESS STREET  
SUITE 304  
PORTLAND, MAINE 04101  
207-650-6414  
senatorearchitecture.com

CONSULTANTS:

REVISIONS:

DATE: OCTOBER 30, 2014

PROJECT No.

DRAWN BY: RRT / RJS

CHECKED BY: RJS

SCALE: AS NOTED

SHEET TITLE:  
OFFICE  
COMPLEX  
REFLECTED  
CEILING PLAN

A1-5

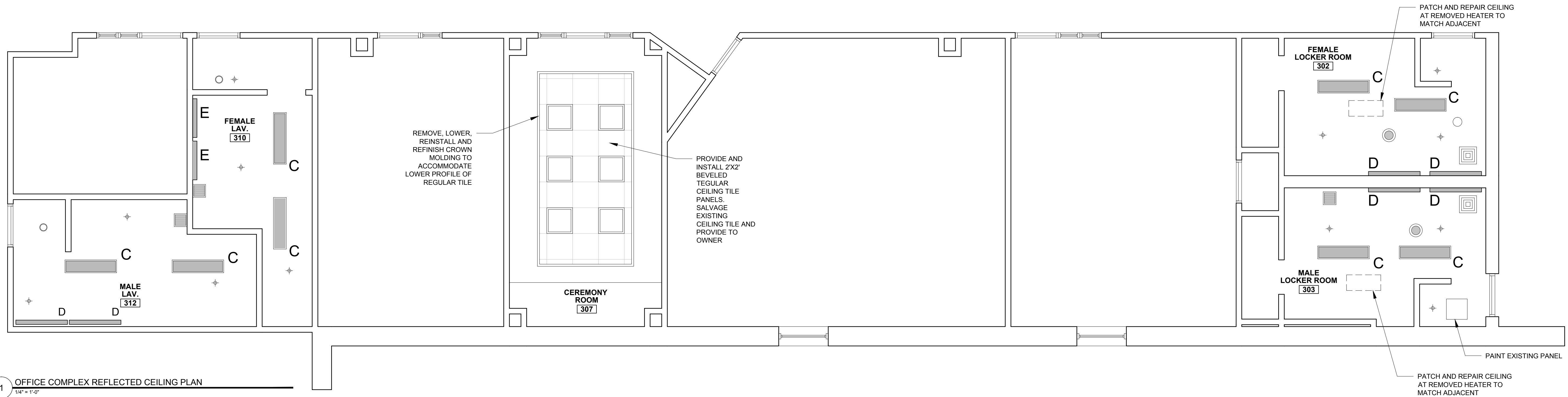

1 OFFICE COMPLEX REFLECTED CEILING PLAN  
1/4" = 1'-0"

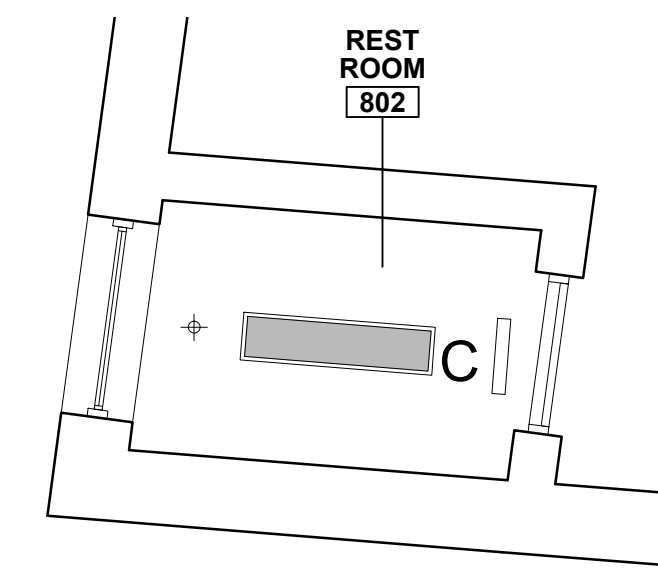

2 LAVATORY 802 REFLECTED CEILING PLAN  
1/4" = 1'-0"

REFLECTED CEILING PLAN NOTES

- 1) LIGHTING IS SHOWN FOR FIXTURE TYPE AND LOCATION PURPOSES ONLY. GENERAL CONTRACTOR IS TO PROVIDE STAMPED ELECTRICAL DRAWINGS FROM AN ELECTRICAL ENGINEER (DESIGN - BUILD) FORMAT FOR NEW AND RENOVATION ELECTRICAL WORK TO OBTAIN NECESSARY PERMITS. ALL ELECTRICAL AND ANY FIRE ALARM WORK REQUIRED IS TO BE DONE IN ACCORDANCE WITH THE MOST CURRENT CODES.
- 2) MECHANICAL GRILLES, VENTS AND LOUVERS ARE SHOWN FOR LOCATION PURPOSES ONLY. GENERAL CONTRACTOR IS TO PROVIDE STAMPED MECHANICAL DRAWINGS FROM AN ELECTRICAL ENGINEER (DESIGN - BUILD) FORMAT FOR NEW AND RENOVATION MECHANICAL WORK TO OBTAIN NECESSARY PERMITS. ALL MECHANICAL WORK REQUIRED IS TO BE DONE IN ACCORDANCE WITH THE MOST CURRENT CODES. GENERAL CONTRACTOR TO RELOCATE ALL ELEMENTS TO ENSURE A FULLY FUNCTIONAL MECHANICAL SYSTEM.
- 3) AT MODIFIED WALL LOCATIONS AND RELOCATED SPRINKLER HEADS AS INDICATED ON DRAWINGS. THE FIRE SPRINKLER SYSTEM SHALL BE MODIFIED AND ADJUSTED AS REQUIRED BY CODE. GENERAL CONTRACTOR IS TO PROVIDE STAMPED SPRINKLER DRAWINGS FROM A FIRE PROTECTION ENGINEER (DESIGN - BUILD) FORMAT FOR THE WORK TO OBTAIN NECESSARY PERMITS. ALL FIRE SPRINKLER SYSTEM WORK REQUIRED IS TO BE DONE IN ACCORDANCE WITH THE MOST CURRENT CODES.
- 4) AT LOCATIONS OF REPLACED CEILINGS, INSTALL NEW CEILING AT SAME HEIGHT ABOVE FINISHED FLOOR AS EXISTING CEILING
- 5) ALL CEILINGS TO BE CEILING (TYPE 1) UNLESS OTHERWISE NOTED
- 6) AT CEILINGS TO RECEIVE NEW GWB CEILING PROVIDE BLOCKING AND FRAMING FOR ALL NEW OR RELOCATED CEILING ELEMENTS PRIOR TO INSTALLATION OF GWB
- 7) AT CEILINGS INDICATED TO BE REPLACED ALL CEILING MOUNTED MECHANICAL GRILLES LOUVERS, ETC. ARE TO BE REPLACED WITH NEW GRILLES, LOUVERS, ETC. ALL OTHER MECHANICAL GRILLES AT CEILING THROUGHOUT THE FACILITY ARE TO BE CLEANED AND PAINTED.

LIGHT FIXTURE SCHEDULE

| SYMBOL | TAG | DESCRIPTION     | MANUFACTURER        | MODEL NUMBER  |
|--------|-----|-----------------|---------------------|---|
| ■      | A   | 2'X4' RECESSED  | H.E. WILLIAMS, INC. | HET-G-S24-232-A-EBSD2*OS*S50-UNV (4100K LAMPS - MATCH EXISTING) |
| ○      | B   | 4" RECESSED CAN | H.E. WILLIAMS, INC. | LED45-OS/30-840-CS-AC/AL-EDD*OS-120                             |
| ■      | C   | 1X4 SURFACE     | H.E. WILLIAMS, INC. | 11-4-232-F-A12125-EB2-UNV (3500K LAMPS)                         |
| —      | D   | WALL MOUNT      | H.E. WILLIAMS, INC. | WMA-4-232-AF-EB2-UNV (3500K LAMPS)                              |
| —      | E   | WALL MOUNT      | H.E. WILLIAMS, INC. | WMA-3-225-AF-EB2-UNV (3500K LAMPS)                              |
| —      | F   | WALL MOUNT      | H.E. WILLIAMS, INC. | WMA-2-217-AF-EB2-UNV (3500K LAMPS)                              |