

PLAN NOTES

- 1.) REMOVE AND REINSTALL ALL WALL MOUNTED ELEMENTS AS REQUIRED TO INSTALL NEW WALL COVERINGS, INCLUDING BUT NOT LIMITED TO (SINKS, ELECTRICAL COVER PLATES, FIRE ALARM DEVICE COVER PLATES (SHALL BE REINSTALLED IN ACCORDANCE WITH NFPA 72)), SHELVING, WALL HOOKS, ETC.)
- 2.) PREPARE ALL WALL AND FLOOR SURFACES TO RECEIVE NEW FINISHES PER FINISH MANUFACTURERS INSTALLATION INSTRUCTIONS. REMOVE AND REPLACE ALL DAMAGED FLOOR SHEATHING FOUND UPON REMOVAL OF EXISTING FLOORING
- 3.) FIRE STOPPING SHALL CONSIST OF UL LISTED ASSEMBLIES AND BE INSTALLED PER CODE
- 4.) NOTHING, INCLUDING T.V.'s SHALL OBSTRUCT FIRE AND LIFE SAFETY COMPONENTS

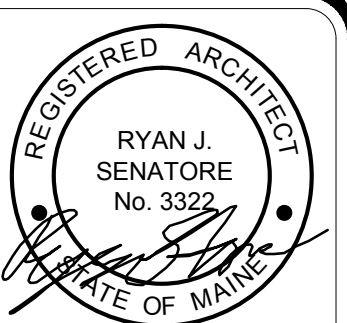

© 2014 RYAN SENATORE ARCHITECTURE

MEPS
510 CONGRESS STREET
PORTLAND, MAINE



RYAN SENATORE
ARCHITECTURE
565 CONGRESS STREET
SUITE 304
PORTLAND, MAINE 04101
207-650-6414
senatorearchitecture.com

CONSULTANTS:

REVISIONS:

DATE: OCTOBER 30, 2014

PROJECT No.

DRAWN BY: RRT / RJS

CHECKED BY: RJS

SCALE: AS NOTED

SHEET TITLE:
MEDICAL
FLOOR PLAN

A1-1

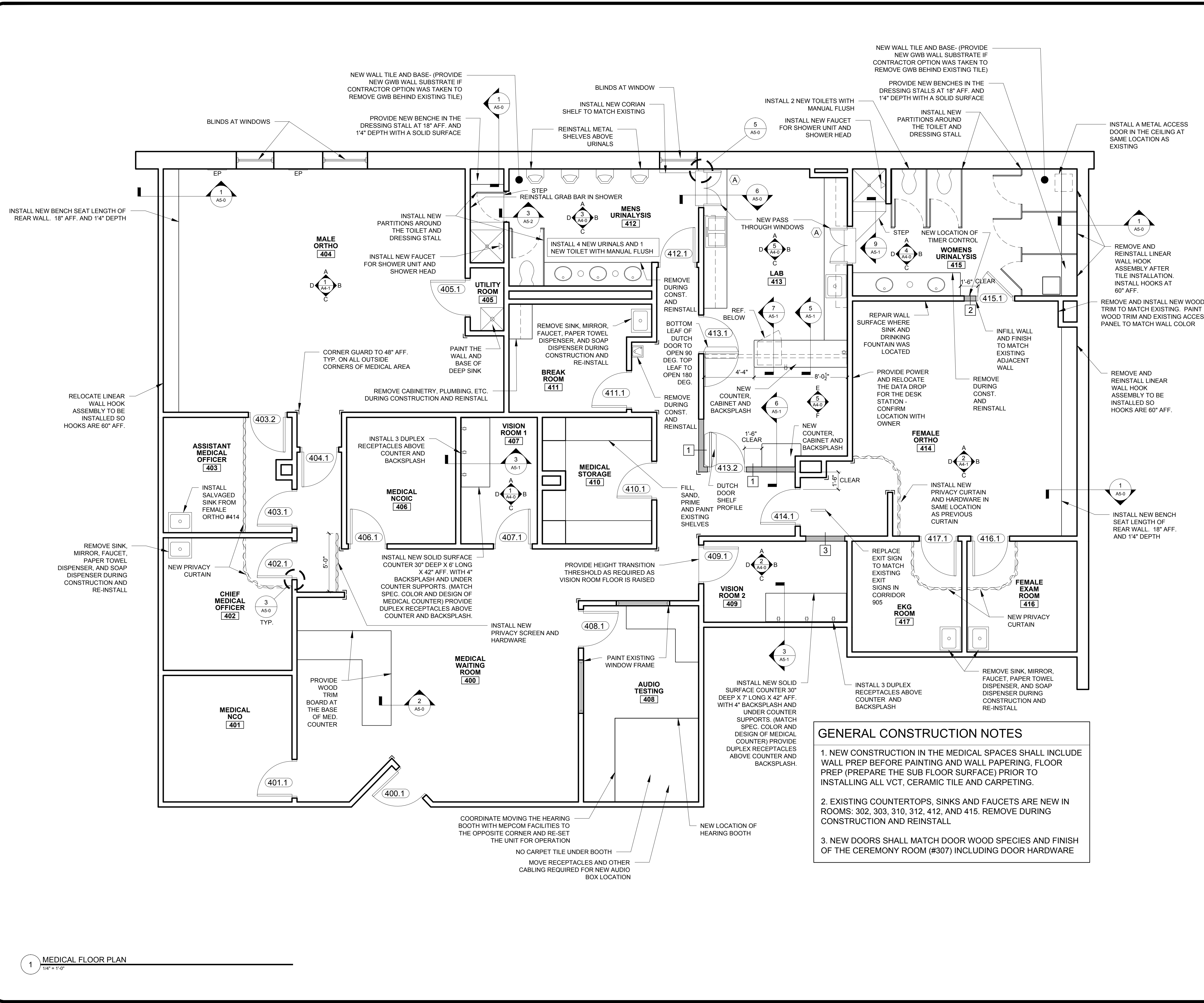

GENERAL CONSTRUCTION NOTES

1. NEW CONSTRUCTION IN THE MEDICAL SPACES SHALL INCLUDE WALL PREP BEFORE PAINTING AND WALL PAPERING, FLOOR PREP (PREPARE THE SUB FLOOR SURFACE) PRIOR TO INSTALLING ALL VCT, CERAMIC TILE AND CARPETING.
2. EXISTING COUNTERTOPS, SINKS AND FAUCETS ARE NEW IN ROOMS: 302, 303, 310, 312, 412, AND 415. REMOVE DURING CONSTRUCTION AND REINSTALL
3. NEW DOORS SHALL MATCH DOOR WOOD SPECIES AND FINISH OF THE CEREMONY ROOM (#307) INCLUDING DOOR HARDWARE