

© 2014 RYAN SENATORE ARCHITECTURE

MEPS
510 CONGRESS STREET
PORTLAND, MAINE



RYAN SENATORE
ARCHITECTURE
565 CONGRESS STREET
SUITE 304
PORTLAND, MAINE 04101
207-650-6414
senatorearchitecture.com

CONSULTANTS:

REVISIONS:

DATE: OCTOBER 30, 2014

PROJECT No.

DRAWN BY: RRT / RJS

CHECKED BY: RJS

SCALE: AS NOTED

SHEET TITLE:

MEPS
FLOOR PLAN

A1-0

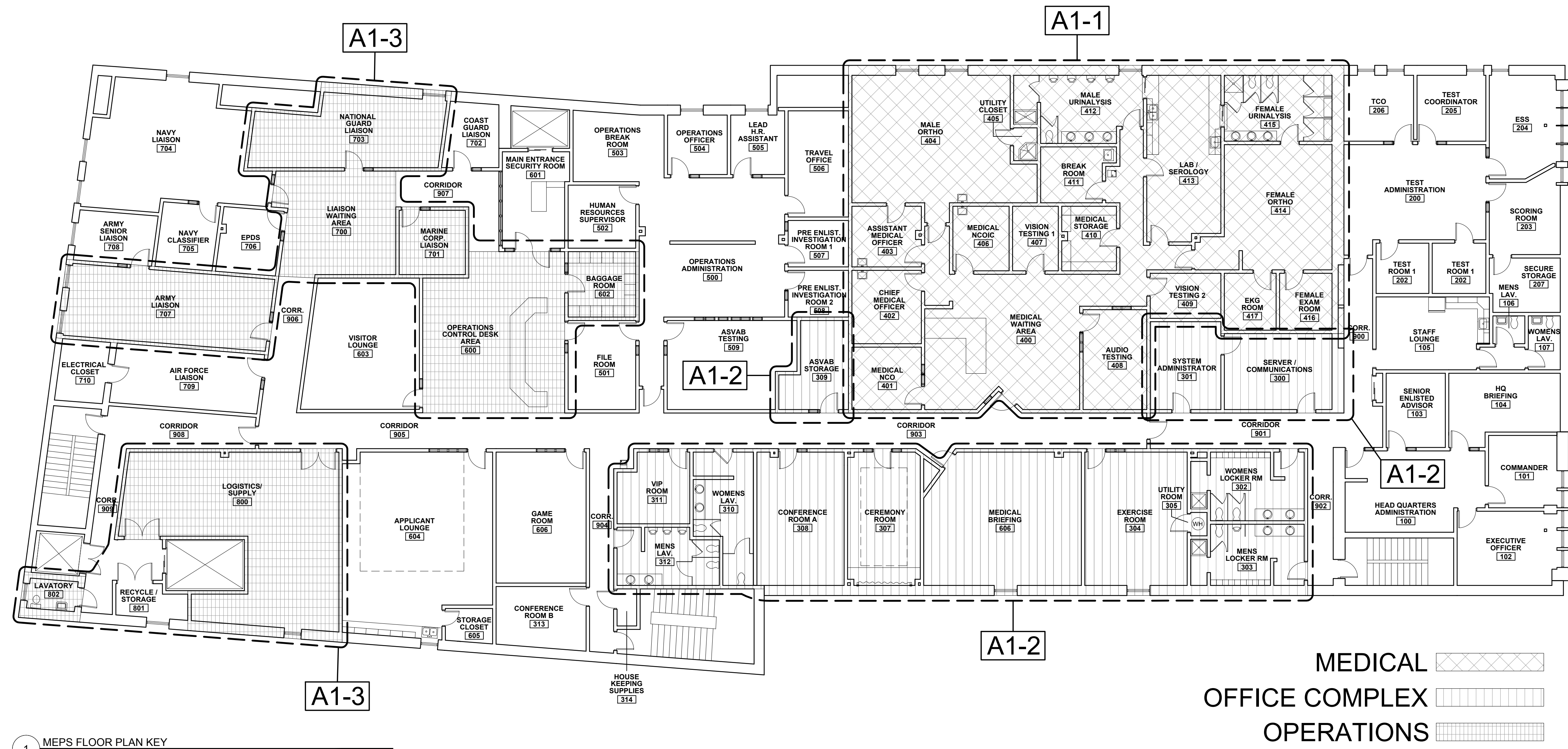

GENERAL CONSTRUCTION CHECK LIST

- | | |
|---|---|
| <p>1.) MANUAL FAUCETS TO BE INSTALLED IN MEDICAL SECTION INSTEAD OF AUTOMATIC FAUCETS.</p> <p>2.) URINAL AND COMMODES ARE ALL MANUAL FLUSH IN THE MALE AND FEMALE URINALYSIS.</p> <p>3.) ALL WINDOWS WITHIN THE MEDICAL AREA SHALL BE FURNISHED WITH EITHER BLINDS.</p> <p>4.) WALL BASE AND DOOR FRAMES ARE TO BE THE SAME COLOR UNLESS OTHERWISE NOTED.</p> <p>5.) ALL BATHROOM STALLS WILL HAVE DOORS</p> <p>6.) TV CABLE AND OUTLET DROPS ARE INSTALLED AT 72" AFF. IN THE DESIGNATED AREAS WHERE TV'S/BRACKETS ARE TO BE MOUNTED.</p> <p>7.) EACH DATA DROP WILL BE A QUADRUPLEX BOX ALLOWING ANY CONFIGURATION BETWEEN VOICE AND DATA..</p> <p>8.) INSTALL CORNER GUARDS THROUGHOUT HALLWAYS AND CORRIDORS.</p> <p>9.) VERIFY THAT WALL MOUNTED FIRE ALARMS, EMERGENCY STROBES, AND EXTINGUISHERS DO NOT OBSTRUCT AREAS WHERE WALL MOUNT TV'S WILL BE INSTALLED.</p> <p>10.) CLOTHES HANGERS IN THE MALE AND FEMALE ORTHO ROOMS ARE AT A MIN OF 60" HIGH OFF THE FLOOR</p> <p>11.) ENSURE ALL DOORFRAMES HAVE SILENCERS</p> | <p>12.) ENSURE DOOR STOPS ARE INSTALLED WHERE NECESSARY.</p> <p>13.) ENSURE ALL MISSING LOCK CORES ARE INSTALLED IN THE DOORS.</p> <p>14.) FOR ALL MILLWORK; CHECK TO SEE ALL CABINET DOORS AND DRAWERS HAVE BUMPERS AND THAT CABINET DOORS ARE HUNG STRAIGHT AND EVENLY SPACED, AND DRAWERS OPEN / CLOSE SMOOTHLY.</p> <p>15.) FOR ALL TRANSACTION COUNTERS, ADDRESS GAP (ON BOTH SIDES) BETWEEN UNDERSIDE OF COUNTER AND SUPPORTING PARTITION - CAULK OR ADD WOOD STRIP / MOLDING UNDERNEATH AS NECESSARY.</p> <p>16.) CHECK ALL LIGHT FIXTURES, SWITCHES AND FAUCETS FOR OPERATION.</p> <p>17.) VERIFY ALL CEILING EXHAUST FANS / COVERS ARE RECESSED INTO CEILING AND VERIFY SOUND LEVEL.</p> <p>18.) VERIFY THAT ALL MEDICAL ROOMS (WITH WASH BASINS), LOCKER ROOMS, AND RESTROOMS RECEIVE SOAP DISPENSERS, MIRRORS, AND PAPER TOWEL DISPENSERS WITH WASTE RECEPTACLES.</p> <p>19.) VERIFY THAT VINYL WALL-COVERING MATCHES THROUGHOUT.</p> <p>20.) GENERAL CONTRACTOR TO CLEAN UP THROUGHOUT AFTER CONSTRUCTION</p> |
|---|---|