

6. MINIMUM FIRE RESISTANCE REQUIREMENTS OF BUILDING ELEMENTS (IBC TABLES 601 & 602)

Structural Frame	1 hour
Load bearing exterior walls	2 hours
Load bearing interior walls	1 hour
Non-load bearing exterior walls (fire separation distance less than 30 ft.)	1 hour
Non-load bearing exterior walls (fire separation distance greater than 30 ft.)	0 hours
Floor construction	1 hour
Roof construction	1 hour
Shaft enclosures	2 hours
Exit enclosures	2 hours
Corridors	0 hours

7. MEANS OF EGRESS COMPONENTS

Exit access travel distance with automatic sprinkler system: 300 ft (IBC Table 1016.1) and NFPA 39.2.6.3
 Minimum number of exits required per floor: 2 (IBC Table 1021.1) and NFPA 39.2.4
 Number of exits provided per floor: (2) for Lower Flr. and (3) for others
 Spaces with (1) means of Egress allowed when occ. load less than 50 in Group B: IBC Table 1015.1
 Common path of travel in group B fully sprinklered buildings: 100 ft (IBC 1014.3) and NFPA 39.2.5.3.1
 An area of refuge is provided in each exit stairway on each floor level (7.2.12)

Component Description	Area Served = 1/2 total area	PHASE TWO Occupant Load**	Width Required	Width Provided
Corridors	6,152 sq ft	155 X 2' = 31"	31"	Min. 60"
Stair 001	6,152 sq ft	155 X 3' = 31"	31"	56"
Stair 002	6,152 sq ft	155 X 3' = 31"	31"	44"
Stair 003	893 sq ft	60 X 3' = 18"	18"	56"
Egress Door to Stair 001		155 x 2' = 31"	31"	36"
Egress Door to Stair 002		155 x 2' = 31"	31"	36"
Egress Door to Stair 003		60 x 2' = 12"	12"	36"

Calculations based on Tables 7.3.1.2 and 7.3.3.1

** Occ. load for Stair 001 & 002 calculated based on 1/4 Air Gallery load plus 1/2 all other Occupied areas. (200' x 11180' / 2) = 155' Stair 003 based on 1/2 total Gallery Occupied.

*NFPA 101, 7.2.2.2.1.1-(2) and Table 7.2.2.2.1.1(10) Existing Stairs, (36" min. allowed for existing)

GRAPHIC KEY:

- AREA OF RENOVATION
- 2-HOUR RATED EGRESS ENCLOSURE
- B** OCCUPANCY CLASSIFICATION
- NOTE: SEE SHEET G1.0 CODE SUMMARY
- 1-HOUR RATED WALL
- 2-HOUR RATED WALL
- TRAVEL DISTANCE
- EXIT SIGNS
- EMERGENCY LIGHTS
- EXIT/EMERGENCY COMBINATION LIGHTS

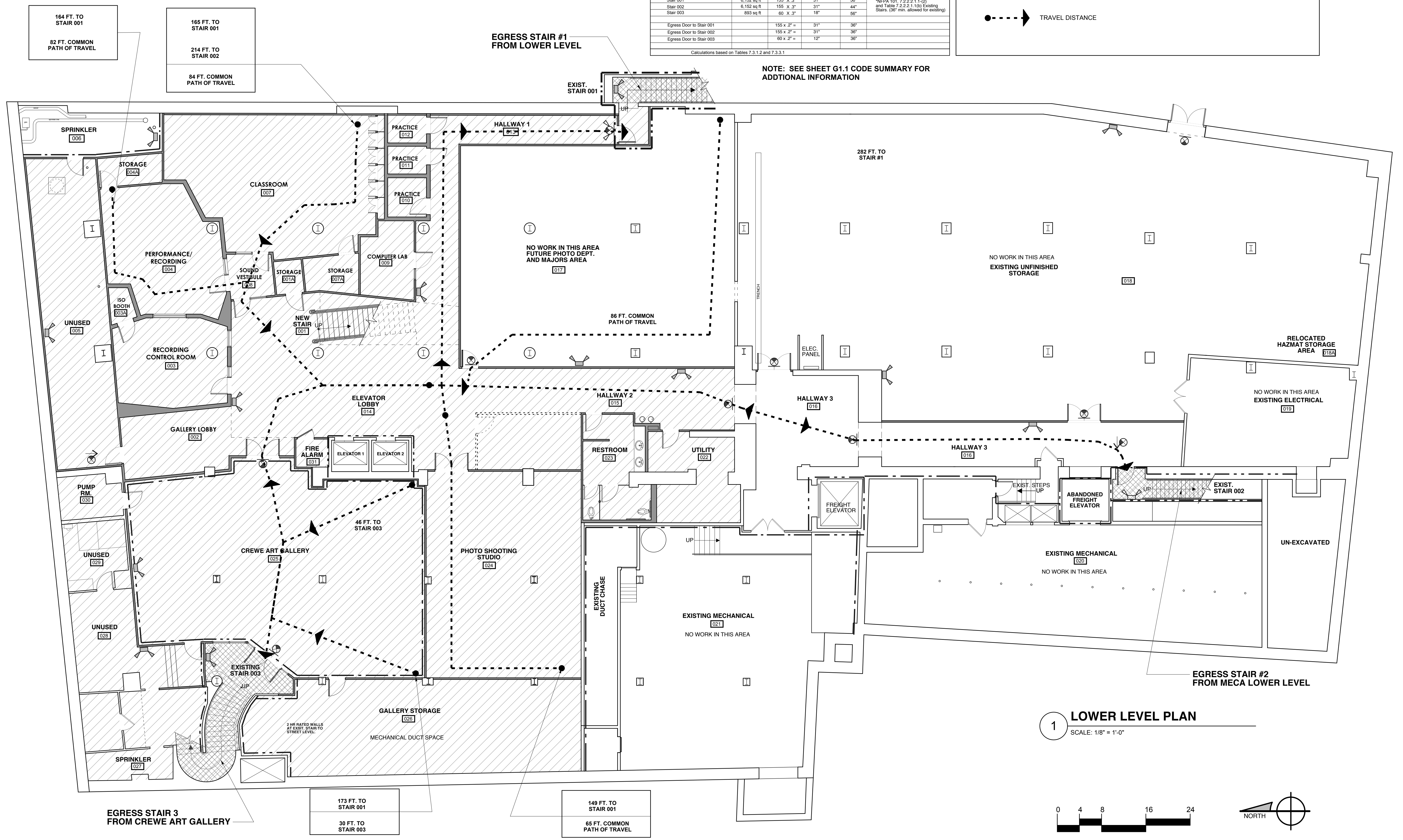

NOTE: SEE SHEET G1.1 CODE SUMMARY FOR ADDITIONAL INFORMATION

1 LOWER LEVEL PLAN
SCALE: 1/8" = 1'-0"



Copyright 2014 Richard I. Renner Architects

RRRA
Richard Renner | Architects
Portland, ME 04118
Sherborn, MA 01866
207.773.9699

LICENSED ARCHITECT
CHARLES YOUNG
4118
STATE OF MAINE

PERMIT SUBMITTAL
AUGUST 07, 2014

MAINE COLLEGE OF ART
Lower Level Renovations
PHASE I
522 Congress Street
Portland, Maine

Lower Level - Life Safety Plan
Drawn by: CY
File Name:
Scale: 1/8"=1'-0"
Project No. 2014-10.00
Date: 08.07.14
Revised:

MECA LOWER LEVEL Renovations
LS1.1