

N:\Projects\2014\14033 - Maine College of ART - Lower Level Phase-1\00 Drawing Files\14033E.dwg Aug 07, 2014 - 1:26pm

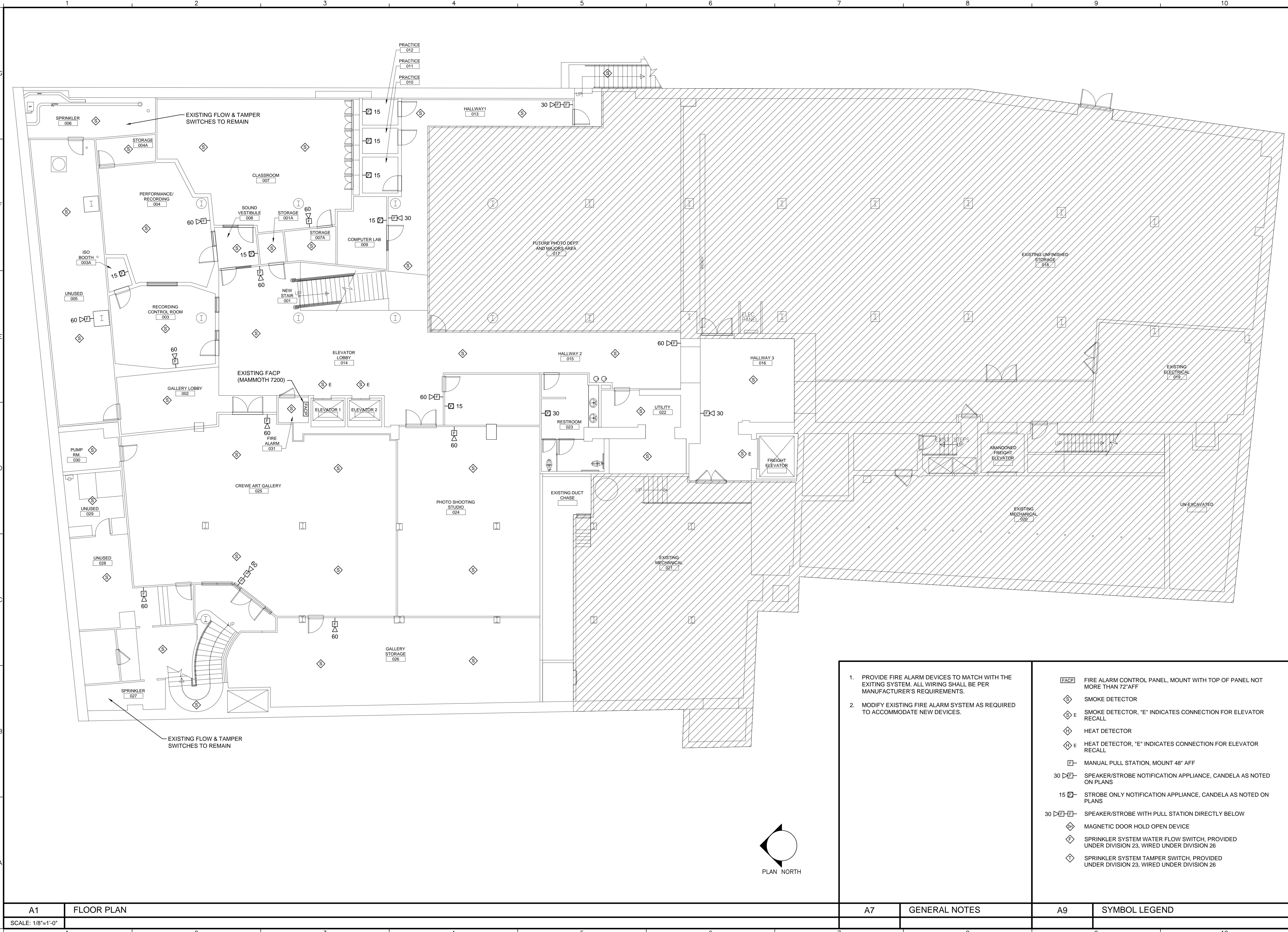

<p>1. PROVIDE FIRE ALARM DEVICES TO MATCH WITH THE EXISTING SYSTEM. ALL WIRING SHALL BE PER MANUFACTURER'S REQUIREMENTS.</p> <p>2. MODIFY EXISTING FIRE ALARM SYSTEM AS REQUIRED TO ACCOMMODATE NEW DEVICES.</p>	<table border="0"> <tr> <td>[FACP]</td> <td>FIRE ALARM CONTROL PANEL, MOUNT WITH TOP OF PANEL NOT MORE THAN 72" AFF</td> </tr> <tr> <td>◇</td> <td>SMOKE DETECTOR</td> </tr> <tr> <td>◇ E</td> <td>SMOKE DETECTOR, "E" INDICATES CONNECTION FOR ELEVATOR RECALL</td> </tr> <tr> <td>◇</td> <td>HEAT DETECTOR</td> </tr> <tr> <td>◇ E</td> <td>HEAT DETECTOR, "E" INDICATES CONNECTION FOR ELEVATOR RECALL</td> </tr> <tr> <td>[MPS]</td> <td>MANUAL PULL STATION, MOUNT 48" AFF</td> </tr> <tr> <td>30 [S]</td> <td>SPEAKER/STROBE NOTIFICATION APPLIANCE, CANDELA AS NOTED ON PLANS</td> </tr> <tr> <td>15 [S]</td> <td>STROBE ONLY NOTIFICATION APPLIANCE, CANDELA AS NOTED ON PLANS</td> </tr> <tr> <td>30 [S] [MPS]</td> <td>SPEAKER/STROBE WITH PULL STATION DIRECTLY BELOW</td> </tr> <tr> <td>◇</td> <td>MAGNETIC DOOR HOLD OPEN DEVICE</td> </tr> <tr> <td>◇</td> <td>SPRINKLER SYSTEM WATER FLOW SWITCH, PROVIDED UNDER DIVISION 23, WIRED UNDER DIVISION 26</td> </tr> <tr> <td>◇</td> <td>SPRINKLER SYSTEM TAMPER SWITCH, PROVIDED UNDER DIVISION 23, WIRED UNDER DIVISION 26</td> </tr> </table>	[FACP]	FIRE ALARM CONTROL PANEL, MOUNT WITH TOP OF PANEL NOT MORE THAN 72" AFF	◇	SMOKE DETECTOR	◇ E	SMOKE DETECTOR, "E" INDICATES CONNECTION FOR ELEVATOR RECALL	◇	HEAT DETECTOR	◇ E	HEAT DETECTOR, "E" INDICATES CONNECTION FOR ELEVATOR RECALL	[MPS]	MANUAL PULL STATION, MOUNT 48" AFF	30 [S]	SPEAKER/STROBE NOTIFICATION APPLIANCE, CANDELA AS NOTED ON PLANS	15 [S]	STROBE ONLY NOTIFICATION APPLIANCE, CANDELA AS NOTED ON PLANS	30 [S] [MPS]	SPEAKER/STROBE WITH PULL STATION DIRECTLY BELOW	◇	MAGNETIC DOOR HOLD OPEN DEVICE	◇	SPRINKLER SYSTEM WATER FLOW SWITCH, PROVIDED UNDER DIVISION 23, WIRED UNDER DIVISION 26	◇	SPRINKLER SYSTEM TAMPER SWITCH, PROVIDED UNDER DIVISION 23, WIRED UNDER DIVISION 26
[FACP]	FIRE ALARM CONTROL PANEL, MOUNT WITH TOP OF PANEL NOT MORE THAN 72" AFF																								
◇	SMOKE DETECTOR																								
◇ E	SMOKE DETECTOR, "E" INDICATES CONNECTION FOR ELEVATOR RECALL																								
◇	HEAT DETECTOR																								
◇ E	HEAT DETECTOR, "E" INDICATES CONNECTION FOR ELEVATOR RECALL																								
[MPS]	MANUAL PULL STATION, MOUNT 48" AFF																								
30 [S]	SPEAKER/STROBE NOTIFICATION APPLIANCE, CANDELA AS NOTED ON PLANS																								
15 [S]	STROBE ONLY NOTIFICATION APPLIANCE, CANDELA AS NOTED ON PLANS																								
30 [S] [MPS]	SPEAKER/STROBE WITH PULL STATION DIRECTLY BELOW																								
◇	MAGNETIC DOOR HOLD OPEN DEVICE																								
◇	SPRINKLER SYSTEM WATER FLOW SWITCH, PROVIDED UNDER DIVISION 23, WIRED UNDER DIVISION 26																								
◇	SPRINKLER SYSTEM TAMPER SWITCH, PROVIDED UNDER DIVISION 23, WIRED UNDER DIVISION 26																								

160 Veranda Street
Portland, Maine 04103
T: 207.221.2260
F: 207.221.2266
Web: www.allied-eng.com

Allied Engineering
Structural Mechanical Electrical Commissioning

REVISIONS	NUMBER	DATE	DESCRIPTION

Date: AUG 2014
Drawn By: GMC
Checked By: RN
Project Mgr: AD
Project No: 14033
Cad File: 14033E.dwg
Graphic Scale: 0

LOWER LEVEL FIRE ALARM PLAN

Maine College of ART
Lower Level- Phase 1
PORTLAND, MAINE

A1 FLOOR PLAN
SCALE: 1/8"=1'-0"

A7 GENERAL NOTES

A9 SYMBOL LEGEND

E-100

PERMIT SUBMITTAL ~ AUGUST 07, 2014