

- Electrical Legend:**
 All equipment to be wired to existing house panel. Nite lights, "nite" to be wired to existing nite light circuit.
- ☒ = 2x4 recess flourescent troffer
 - _A = Recess flourescent can It fixture on wall switch.
 - _{B/nite} = Recess flourescent can It fixture on nite It circuit.
 - ⊗ = Combination LED Exit light & emergency lights.
 - ⊕ = Duplex Receptacle.
 - ⊕_{GFI} = Duplex Receptacle (GFI)
 - ⊥ = Wall switch
 - ☒ = Fire Alarm Strobe only
 - ☒ = Fire Alarm Horn/Strobe
 - ⊙_E = Existing Smoke detector (elevator recall)

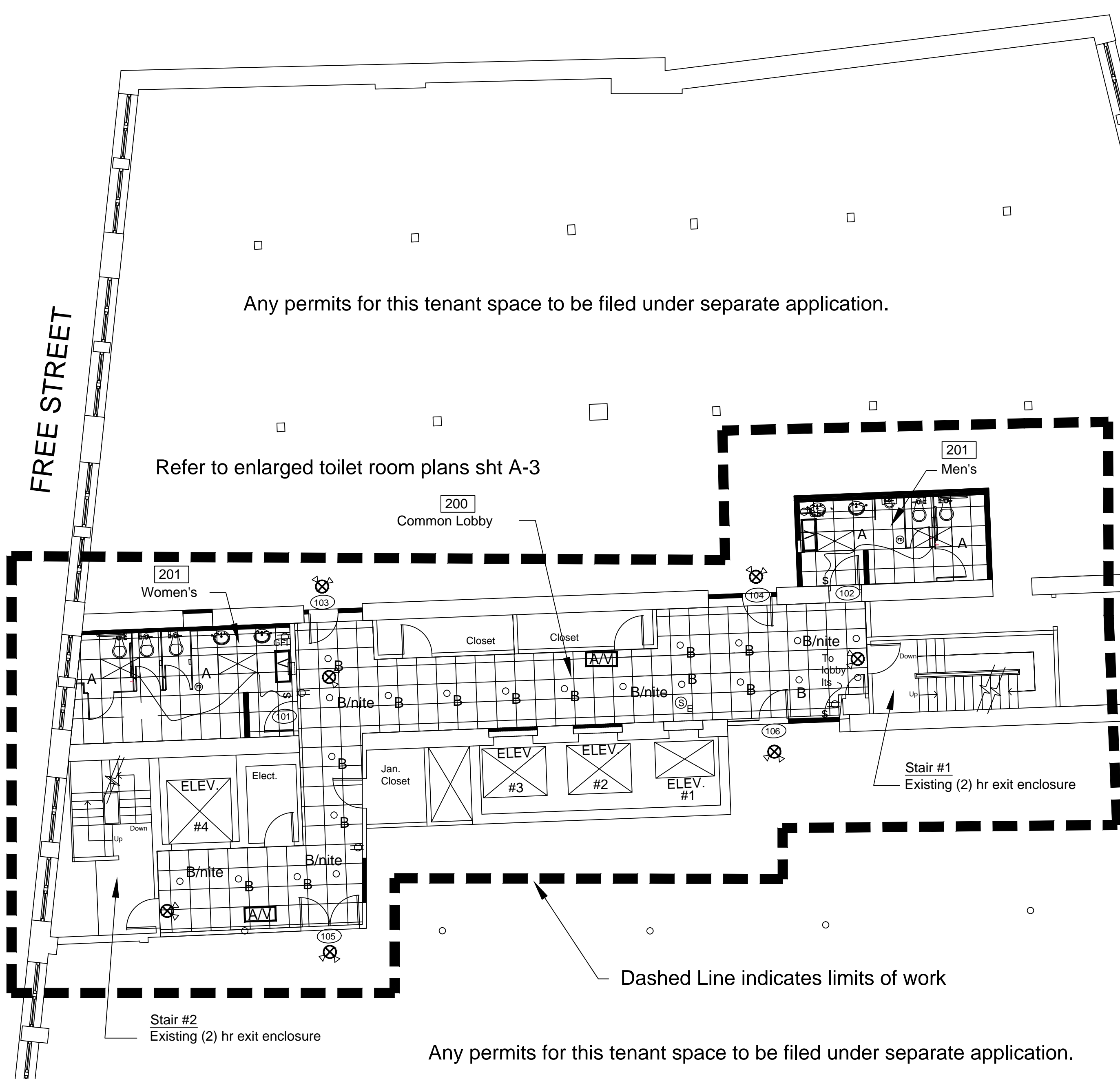

Any permits for this tenant space to be filed under separate application.

Refer to enlarged toilet room plans sht A-3

Any permits for this tenant space to be filed under separate application.

Dashed Line indicates limits of work

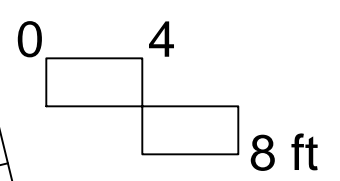

**562 Congress St.
 Portland, Maine**

**Electrical and Reflected
 Ceiling Plan**

Revisions:

E-1
 5/17/12
 Sht 5 of 6