

GENERAL NOTES:

1. THESE DRAWINGS ARE DIAGRAMMATIC. REFER TO THE ARCHITECTURAL DRAWINGS FOR EXACT DIMENSIONS.
2. INSTALLATION SHALL COMPLY WITH NEC, NFPA 72 AND ALL OTHER APPLICABLE CODES AS REQUIRED BY THE LOCAL AUTHORITY HAVING JURISDICTION.
3. WIRING DEPICTED ON THESE PLANS IS SCHEMATIC - ACTUAL WIRE LOCATIONS MAY DIFFER FROM THESE PLANS. WIRING SHALL BE PERFORMED AS ACTUAL BUILDING CONSTRUCTION CONDITIONS ALLOW AND TO MINIMIZE PENETRATIONS THROUGH AREA SEPARATION WALLS AND FIRE WALLS. THE USE OF A RACEWAY IS PERMITTED AS LONG AS NO 110V OR HIGHER VOLTAGE CABLES ARE IN THE SAME RACEWAY.
4. FIRE RATINGS SHALL BE MAINTAINED FOR ALL PENETRATIONS THROUGH FIRE-RATED CONSTRUCTION.
5. POWER FOR ALL FIRE ALARM PANELS AND FIRE ALARM POWER SUPPLIES MUST BE PROVIDED BY A DEDICATED AC BRANCH CIRCUIT.
6. POWER-LIMITED AND NONPOWER-LIMITED CIRCUIT WIRING MUST REMAIN SEPARATED IN CABINET. ALL POWER-LIMITED CIRCUIT WIRING MUST REMAIN AT LEAST 0.25" AWAY FROM ANY NONPOWER-LIMITED CIRCUIT WIRING. FURTHERMORE, ALL POWER-LIMITED AND NONPOWER-LIMITED CIRCUIT WIRING MUST ENTER AND EXIT THE CABINET THROUGH DIFFERENT KNOCK OUTS AND/OR SEPARATE CONDUITS.
7. WHEN UTILIZING CLASS "A" CIRCUITS, SEPARATE OUTGOING AND RETURN CONDUCTORS OF CLASS "A" CIRCUITS BY A MINIMUM OF 12" WHERE RUN VERTICALLY AND 48" WHERE RUN HORIZONTALLY.
8. WHEN UTILIZING SHIELDED CABLE TIE SHIELDS THROUGH AND INSULATE AT EACH JUNCTION BOX. INSULATE AND TAPE BACK AT END.
9. ALL FIRE ALARM CABLING SHALL BE ACCEPTABLE TO THE FIRE ALARM EQUIPMENT MANUFACTURER FOR THE INTENDED PURPOSE.
10. SMOKE DETECTORS SHALL NOT BE INSTALLED UNTIL AFTER CONSTRUCTION CLEAN-UP IS COMPLETED AND FINAL.
11. LOCATE SMOKE DETECTORS A MINIMUM OF THREE (3) FEET FROM MECHANICAL DIFFUSERS. WALL-MOUNTED SMOKE DETECTORS SHALL BE LOCATED A MINIMUM OF 4" AND A MAXIMUM OF 12" FROM CEILING. CEILING-MOUNTED SMOKE DETECTORS SHALL BE MOUNTED ON CEILINGS AND NOT ON THE BOTTOMS OF BEAMS OR JOISTS.
12. PROVIDE SYNCHRONIZATION OF ALL VISUAL NOTIFICATION APPLIANCE CIRCUITS. PROVIDE ALL REQUIRED SYNC MODULES. PROVIDE A MULTI-SYNC MODE SLAVE CONNECTION BETWEEN ALL SYNC MODULES.
13. VERIFY ALL FIELD SELECTABLE AUDIBILITY SETTINGS OF NOTIFICATION APPLIANCES WITH FIRE ALARM CONTRACTOR.
14. UPON COMPLETION OF THE FIRE ALARM SYSTEM INSTALLATION AND PROGRAMMING, THE INSTALLING CONTRACTOR SHALL PERFORM FINAL TESTING OF THE ENTIRE SYSTEM, PER ALL APPLICABLE CODES, AND SHALL COORDINATE AND PERFORM A FINAL FIRE ALARM SYSTEM INSPECTION.
15. PROVIDE OFF-SITE MONITORING AS REQUIRED BY THE INTERNATIONAL FIRE CODE, SECTION 907.15 AND THE LOCAL AUTHORITY HAVING JURISDICTION.
16. INSTALLING CONTRACTOR SHALL, PHYSICALLY, LABEL ALL INITIATING DEVICES AND NOTIFICATION APPLIANCE CIRCUIT END OF LINE (WHEN WIRING CLASS "B"). THESE LABELS SHALL BE IN PLACE PRIOR TO START-UP AND TESTING.

FIRE ALARM SYMBOL LEGEND		
NOTE: ALL SYMBOLS MAY NOT BE USED ON THIS PROJECT		
SYMBOL	DESCRIPTION	MOUNTING
[FCP]	FIRE ALARM CONTROL PANEL	WALL-TOP @ 66"
[FPS]	FIRE ALARM POWER SUPPLY	FIELD VERIFY
[FSA]	FIRE SYSTEM ANNUCIATOR	WALL-TOP @ 66"
[FSD]	FIRE/SMOKE DAMPER	BY OTHERS
⊙	SMOKE DETECTOR	CEILING
⊙-L	DUCT SMOKE DETECTOR	BY OTHERS
⊙	HEAT DETECTOR	CEILING
[EM]	ADDRESSABLE CONTROL MODULE	FIELD VERIFY
[MM]	ADDRESSABLE MONITOR MODULE	FIELD VERIFY
[P]	MANUAL PULL STATION	WALL-TOP @ 48"
[R]	CONTROL RELAY (MULTI-VOLTAGE)	FIELD VERIFY
[RM]	ADDRESSABLE RELAY MODULE	FIELD VERIFY
[M]	MAGNETIC DOOR HOLDER	FIELD VERIFY
[WFS]	WATER FLOW SWITCH	BY OTHERS
[VTS]	VALVE TAMPER SWITCH	BY OTHERS
[B]	BELL	BY OTHERS
[CS]	CEILING MOUNT STROBE	FIELD VERIFY
[CHS]	CEILING MOUNT HORN / STROBE	FIELD VERIFY
[CMS]	CEILING MOUNT SPEAKER / STROBE	FIELD VERIFY
[H]	HORN	WALL @ 10'-0"
[HS]	HORN / STROBE	WALL 80"-96"
[SS]	SPEAKER / STROBE	WALL 80"-96"
[SP]	SPEAKER	WALL @ 90"
[S]	STROBE	WALL 80"-96"
[KB]	KNOX BOX	FIELD VERIFY

ABBREVIATION	DESCRIPTION
E	EXISTING
G	WITH GUARD
P	PENDENT MOUNT
R	RESIDENTIAL (110V)
S	SOUNDER BASE
WP	WEATHER PROOF
EOL	END OF LINE RESISTOR
EOLR	END OF LINE RELAY
AWG	AMERICAN WIRE GAUGE
TWP	TWISTED PAIR
TWSP	TWISTED SHIELDED PAIR
FPLP	FIRE POWER LIMITED PLENUM
FPLR	FIRE POWER LIMITED RISER

SYMBOL	DESCRIPTION
[S]	STROBE CANDELA
[W]	WATTAGE
[G]	GAUGE
[D]	DEVICE ADDRESS
[M]	MODULE #
[L]	LOOP #
[1]	CONDUCTOR COUNT
[2]	WIRE SIZE
[3]	# OF CABLES (IF OMITTED ONLY 1 CABLE NEEDED)

FOURTH FLOOR FIRE ALARM PLAN
 SCALE: 1/8"=1'-0"
 PLAN NORTH

CUNNINGHAM
Security Systems
 10 Princes Point Road, Yarmouth, Maine 04096
 Office: 207.846.3350 • Fax: 207.846.6080

DIVERSIFIED COMMUNICATIONS
PORTLAND, MAINE 04101
FOURTH FLOOR FIRE ALARM PLAN

DRAWN	JPB UNICAD JOB #13175
CHECKED	WAYNE B. HAWES NICET IV 90496
DATE	4/10/2013
REVISION	0
SCALE	1/8"=1'-0"

shop drawings created by
 5784 W. 4900 St.
 Hallowell, ME 04801
 Office: 801.985.0410

UNICAD Inc.
 Fire Alarm Design & Drafting Services

REVISION	DESCRIPTION	DATE
0	ISSUED FOR REVIEW & APPROVAL	4/11/2013

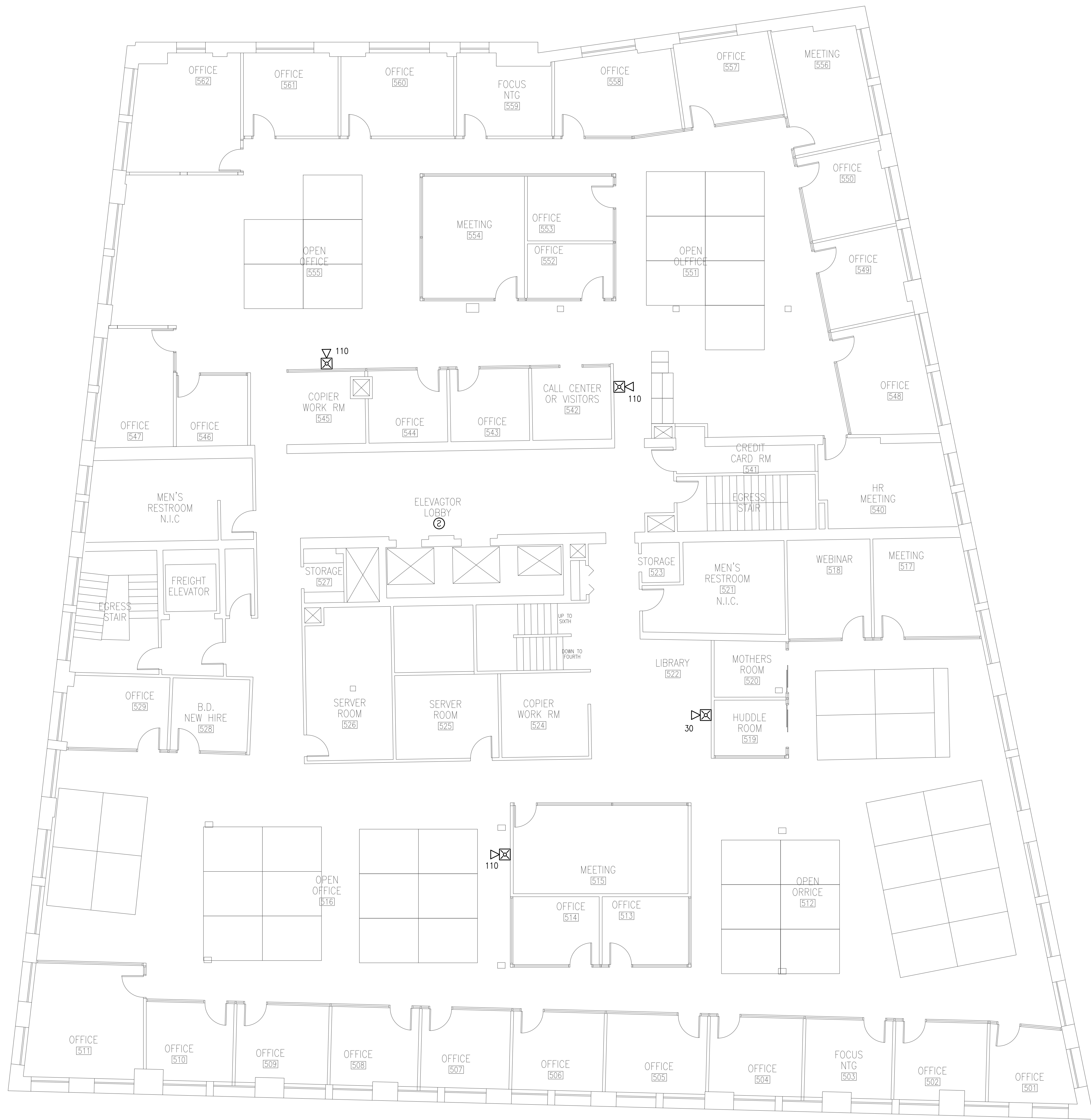

FIFTH FLOOR FIRE ALARM PLAN
 SCALE: 1/8"=1'-0"
 PLAN NORTH

REVISION	DESCRIPTION	DATE
0	ISSUED FOR REVIEW & APPROVAL	4/11/2013

CUNNINGHAM
Security Systems
 10 Princes Point Road, Yarmouth, Maine 04096
 Office: 207.846.3350 • Fax: 207.846.6080

DIVERSIFIED COMMUNICATIONS
PORTLAND, MAINE 04101
FIFTH FLOOR FIRE ALARM PLAN

DRAWN	JPB UNICAD JOB #13175
CHECKED	WAYNE B. HAWS NICET N 90496
DATE	4/10/2013
REVISION	0
SCALE	1/8"=1'-0"

Shop drawings created by:
 5794 W. 4900 St.
 Hesper, UT 84315
 Office: 801.985.0410
www.unicad.net

