

CEILING SCHEDULE						
Room	RM. #	Ceiling HT	Tile Size	Ceiling	ceiling grid	Notes
Reception Lobby	100	9-0	none	Gypsum Board	none	perimeter light cove
Zumba, Cardio, Yoga	106	9-4	24 x 24	ACT-1	CG-1	Verify window soffits
Stair #3	107	9-0	24 x 24	ACT-1	CG-1	
Reception	102/103	existing	24 x 24	ACT-1	CG-1	
Seth's Office	104	existing	24 x 24	ACT-2	CG-1	
Fitness Room	202	9-4	24 x 24	ACT-1	CG-1	
Men's Changing Room	203	9-0	24 x 24	Gypsum Board	none	moisture resistant gypsum board
Men's Showers	203	9-0	24 x 24	Gypsum Board	none	moisture resistant gypsum board
Women's Changing Room	204	9-0	24 x 24	Gypsum Board	none	moisture resistant gypsum board
Women's Showers	204	9-0	24 x 24	Gypsum Board	none	moisture resistant gypsum board
Lunch Room	207	9-4	24 x 24	ACT-1	CG-1	
Kitchenette	208	9-4	24 x 24	ACT-1	CG-1	
AV Storage	209	9-0	24 x 24	ACT-1	CG-1	
Storage	210	9-0	24 x 24	ACT-1	CG-1	
Electrical	211	9-0	none	Gypsum Board	none	1 hour rated
ACT-1: Ultima # 1941, 15/16" Bevelled Tegular edge, NRC 0.80, CAC35, LR 0.87, Articulation Class 170						
ACT-2: Ultima # 1951, 15/16" Bevelled Tegular edge, NRC 0.60, CAC40, LR 0.90						
CG-1: 15/16" USG DX, Intermediate Duty, flat white with 7/8"x7/8" flat white wall angle						

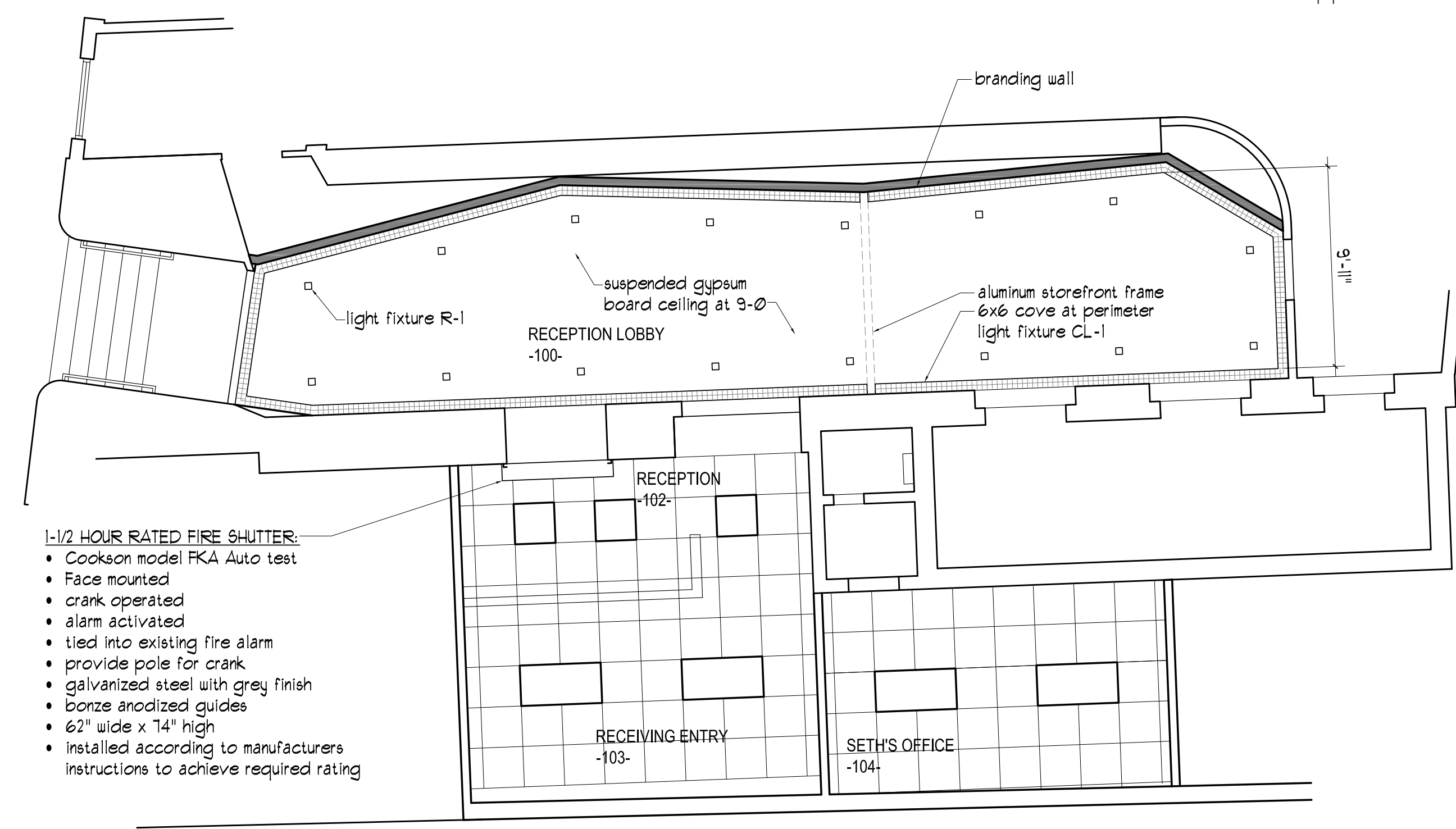

- 1-1/2 HOUR RATED FIRE SHUTTER:**
- Cookson model FKA Auto test
  - Face mounted
  - crank operated
  - alarm activated
  - tied into existing fire alarm
  - provide pole for crank
  - galvanized steel with grey finish
  - bronze anodized guides
  - 62" wide x 14" high
  - installed according to manufacturers instructions to achieve required rating

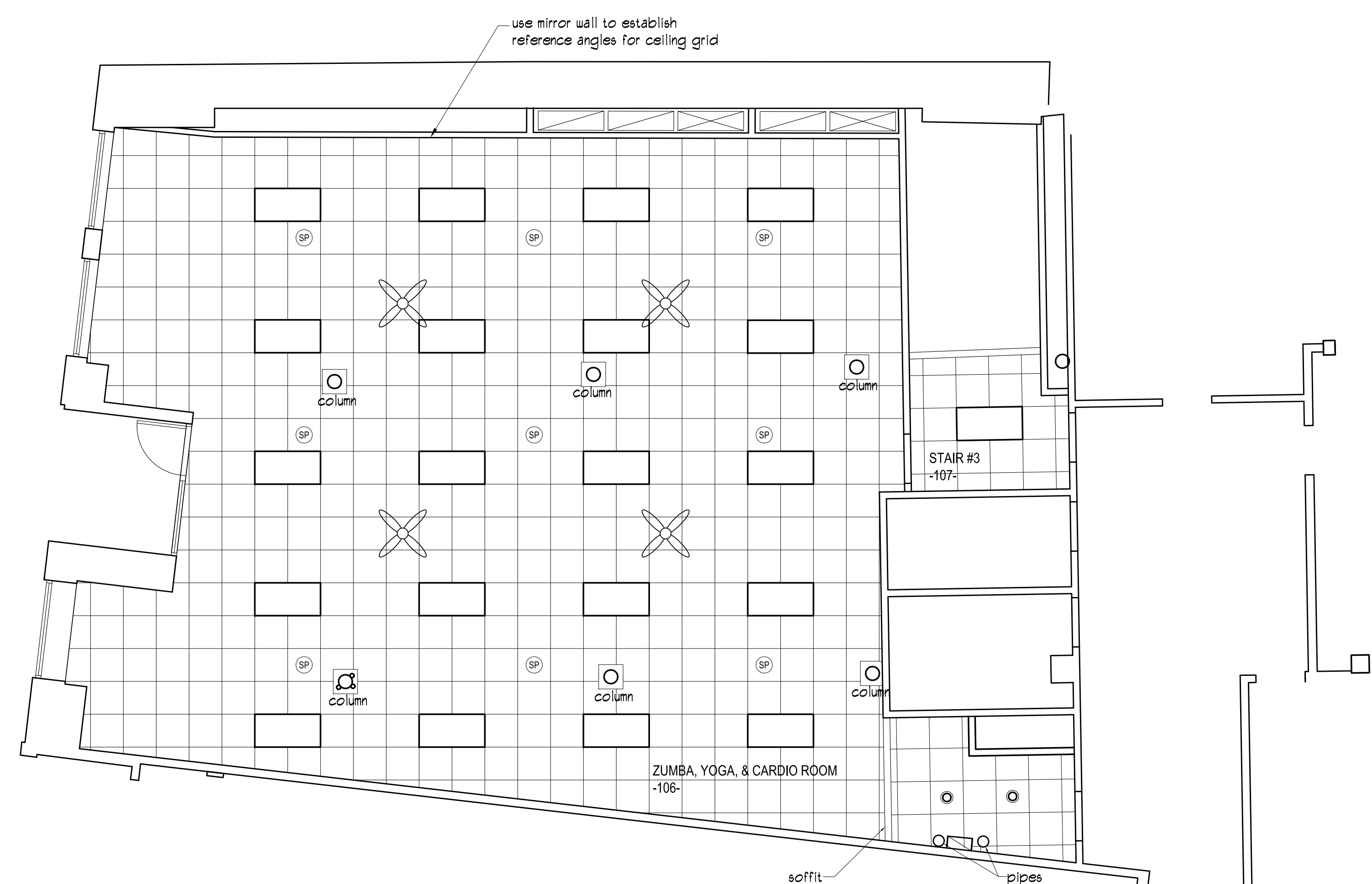
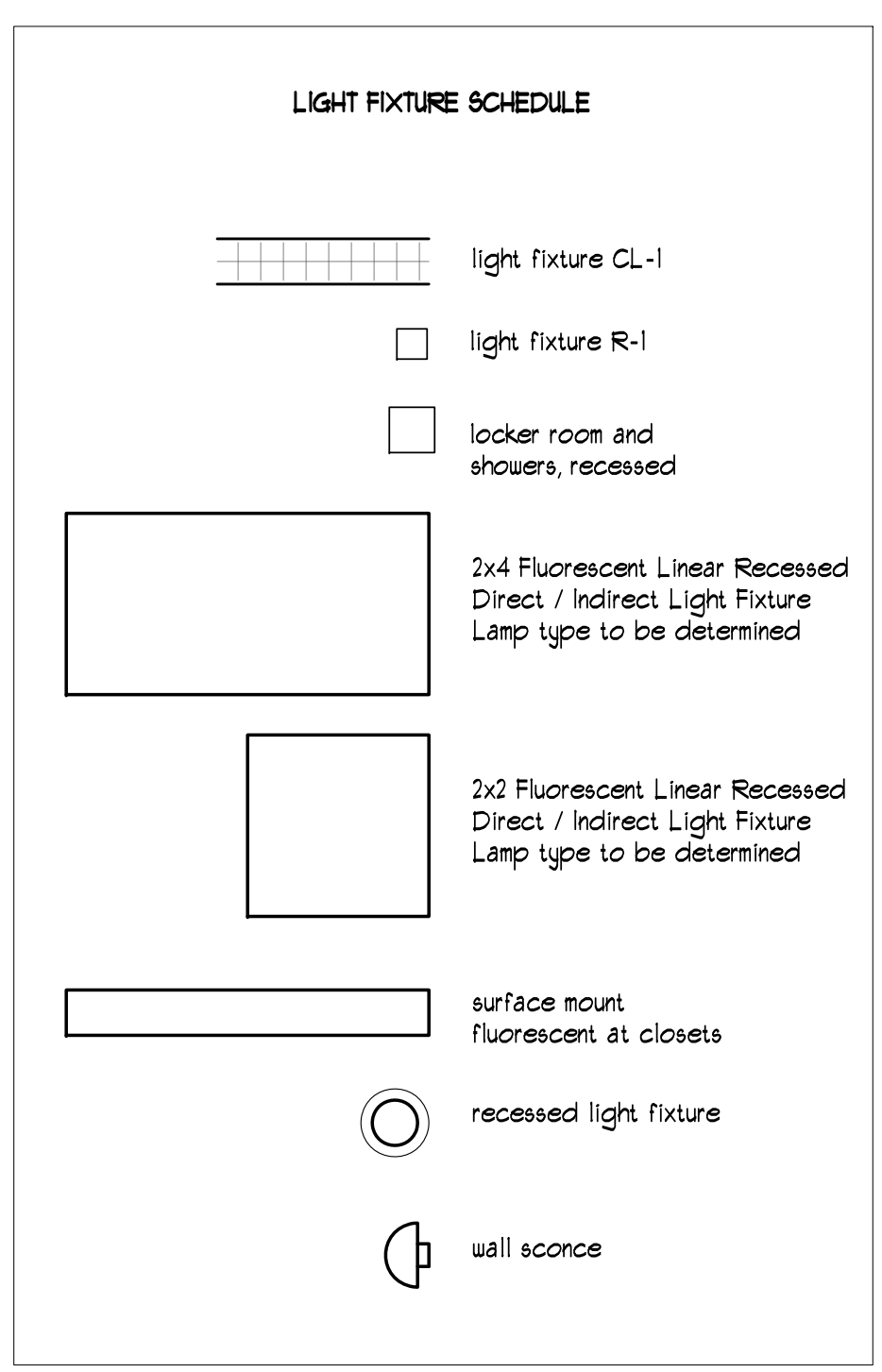

**I** First Floor Reflected Ceiling Plan  
3/16" = 1'-0"

